

three inches = one foot  
one and one half inch = one foot  
one inch = one foot  
three-quarters inch = one foot  
one-half inch = one foot  
three-eighths inch = one foot  
one-quarter inch = one foot  
one-eighth inch = one foot

1 2 3 4 5 6 7 8

A  
B  
C  
D  
E  
F

MARKER/CORK BOARD SCHEDULE:

- 1 not used
- 2 Cork board only - Rm. 201, 225, 226
- 3 White board only - Rm. 200C, 200E, 214, 215, 231

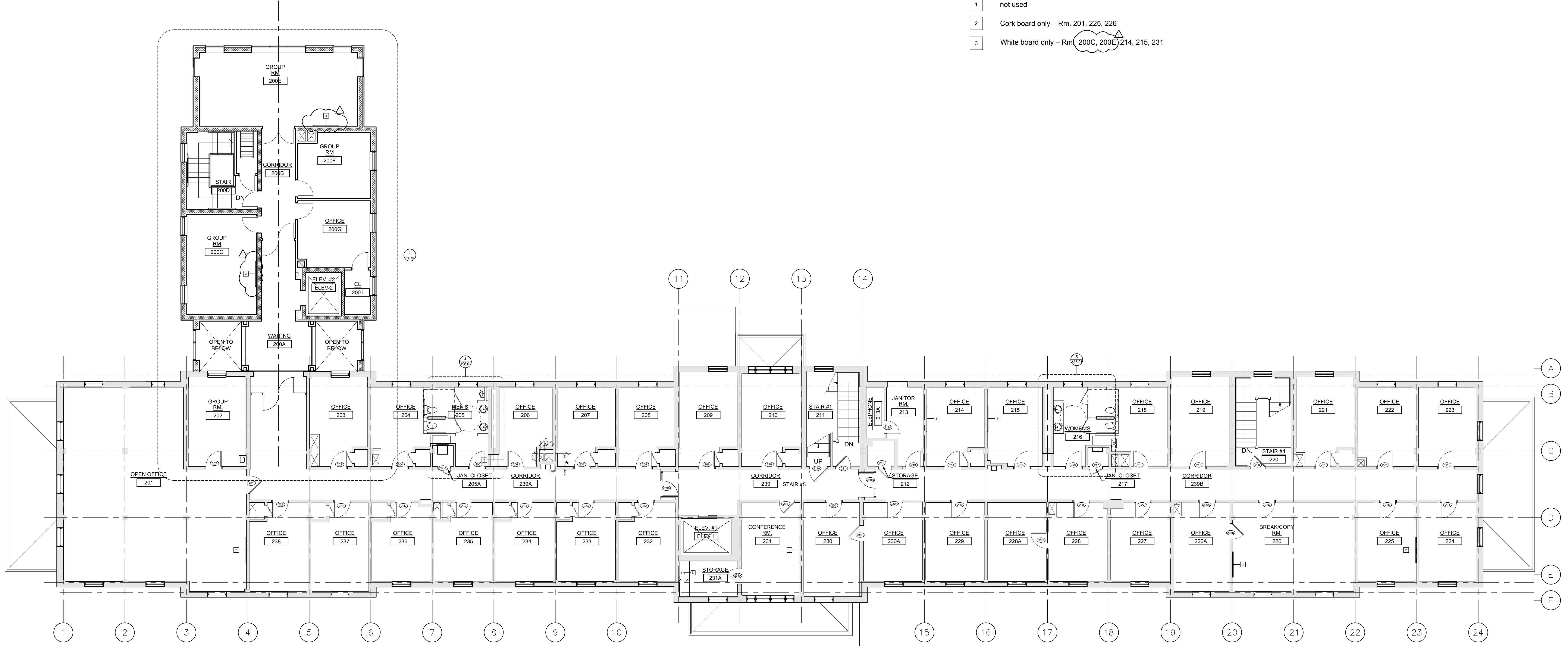

1 2ND FLOOR PLAN  
SCALE: 1/8"=1'-0"

FULLY SPRINKLERED

|                           |          |
|---------------------------|----------|
| Revisions:                | Date:    |
| ADDENDUM 01 (REF. RFI #1) | 06/19/13 |
|                           |          |
|                           |          |
|                           |          |
|                           |          |
|                           |          |
|                           |          |
|                           |          |
|                           |          |
|                           |          |

ARCHITECT/ENGINEERS:

A JOINT VENTURE

**TNF**  
3 EXECUTIVE COURT, UNIT 4  
SOUTH BARRINGTON, IL 60010

**PENZA BAILEY**  
ARCHITECTS  
401 WOODBOURNE AVE  
BALTIMORE, MD 21212

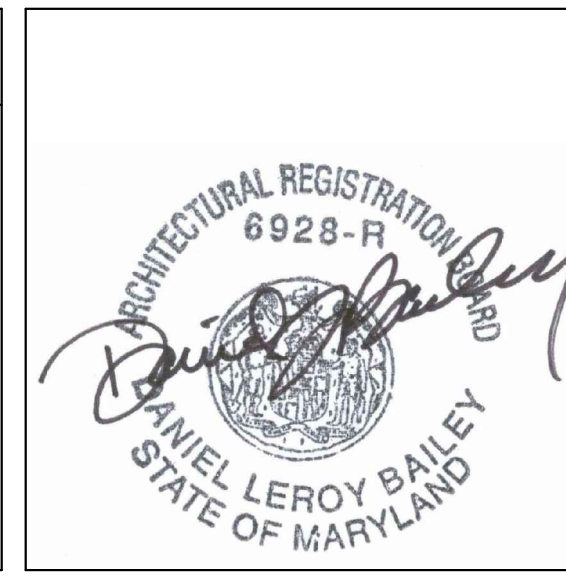

|                                 |
|---------------------------------|
| Approved:                       |
|                                 |
|                                 |
|                                 |
| Approved: Executive Leadership: |

|  |
|--|
| Approved: Chief, Facilities and Engineering:                           |
|  |
| Approved: Associate Chief for Maintenance And Operations, Perry Point: |
|  |
| Approved: Engineering Projects Supervisor:                             |
|  |
| Approved: Infection Control Officer:                                   |
|  |
| Approved: Mental Health Clinical Center Leadership:                    |

|  |
|--|
| Drawing Title:                               |
| SECOND FLOOR PLAN                            |
| Approved: Associate Director for Operations: |
|  |
| Approved: Director, Medical Center:          |

|  |              |          |        |
|--|--------------|----------|--------|
| Project Title:                           |              |          |        |
| EXPAND OIF / OEF AND BUILDING RENOVATION |              |          |        |
| Scale:                                   | Building No: | Checked: | Drawn: |
| AS NOTED                                 | 80H          | DM       | PB/KC  |
| Location:                                |              |          |        |
| VAMHCS PERRY POINT, MD 21902             |              |          |        |

|                |
|----------------|
| Date:          |
| APRIL 01, 2013 |
| Project No:    |
| 512-519        |
| DRAWING NO:    |
| AS1.21         |
| SHT. 14 OF 141 |

