

3 - THIRD FLOOR LEVEL / DIMENSIONAL PLAN
ONE 1/16" = ONE FOOT

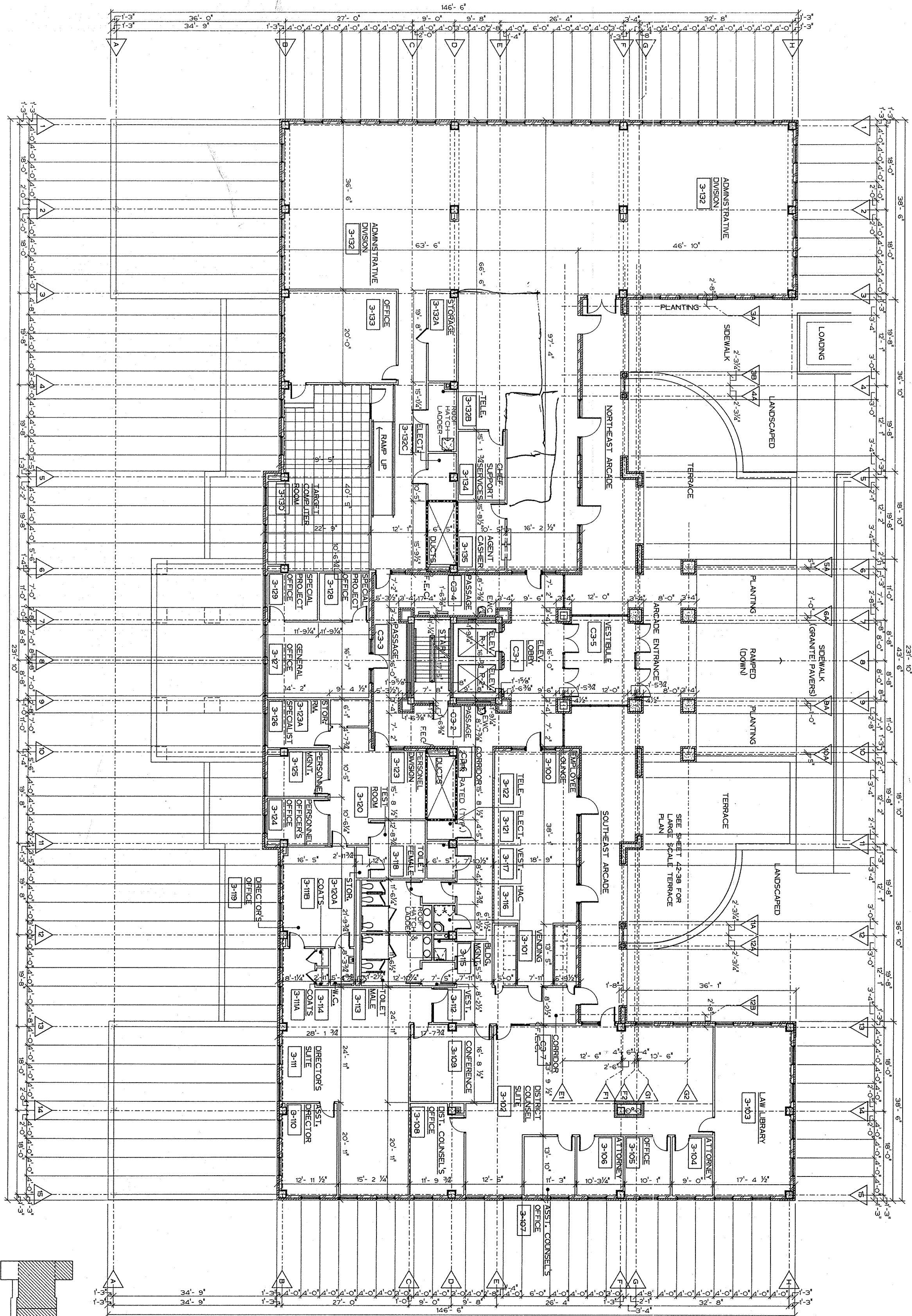

one eighth inch = one foot

one quarter inch = one foot

three eighths inch = one foot

one half inch = one foot

three quarters inch = one foot

one inch = one foot

one and one half inches = one foot

three inches = one foot

166 Commerce Street
P.O. Box 4834
Montgomery, Alabama 36104
205/635-5401

2WVR
Watson Watson Rutland / Architects Inc.

Approved and Project Manager
Charles Rutland

Project Title
**Third Floor Level
Dimensional Plan**

Project No.
322-002

Building Number
42

Location
WMAC Montgomery, AL

Date
27 JANUARY 92

DRAWING NO.
42-6

Office of Facilities
Department of Veterans Affairs