

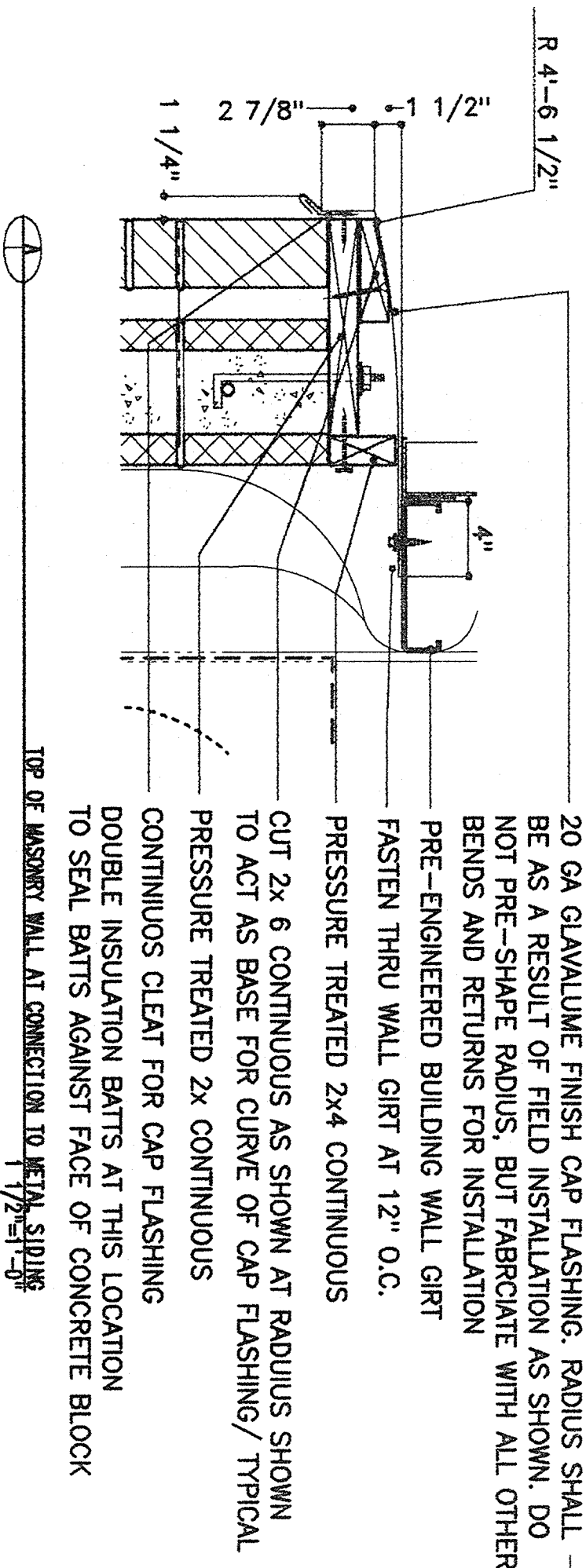

FLASHING SHAPE PRIOR TO INSTALLATION

CONTINUOUS CLIP FLASHING
(COUNTER FLASHING LEG),
INCLUDING RETURNS AT CORNERS

flashing shown is 2 times the size
of detail to left.



20 GA GALVALUME FINISH CAP FLASHING. RADIUS SHALL BE AS A RESULT OF FIELD INSTALLATION AS SHOWN. DO NOT PRE-SHAPE RADIUS, BUT FABRICATE WITH ALL OTHER BENDS AND RETURNS FOR INSTALLATION
PRE-ENGINEERED BUILDING WALL GIRT
FASTEN THRU WALL GIRT AT 12" O.C.
PRESSURE TREATED 2x4 CONTINUOUS
CUT 2x 6 CONTINUOUS AS SHOWN AT RADIUS SHOWN TO ACT AS BASE FOR CURVE OF CAP FLASHING/ TYPICAL
PRESSURE TREATED 2x CONTINUOUS
CONTINUOUS CLEAT FOR CAP FLASHING
DOUBLE INSULATION BATTS AT THIS LOCATION
TO SEAL BATTS AGAINST FACE OF CONCRETE BLOCK
TOP OF MASONRY WALL AT CONNECTION TO METAL SIDING
1 1/2"=1'-0"

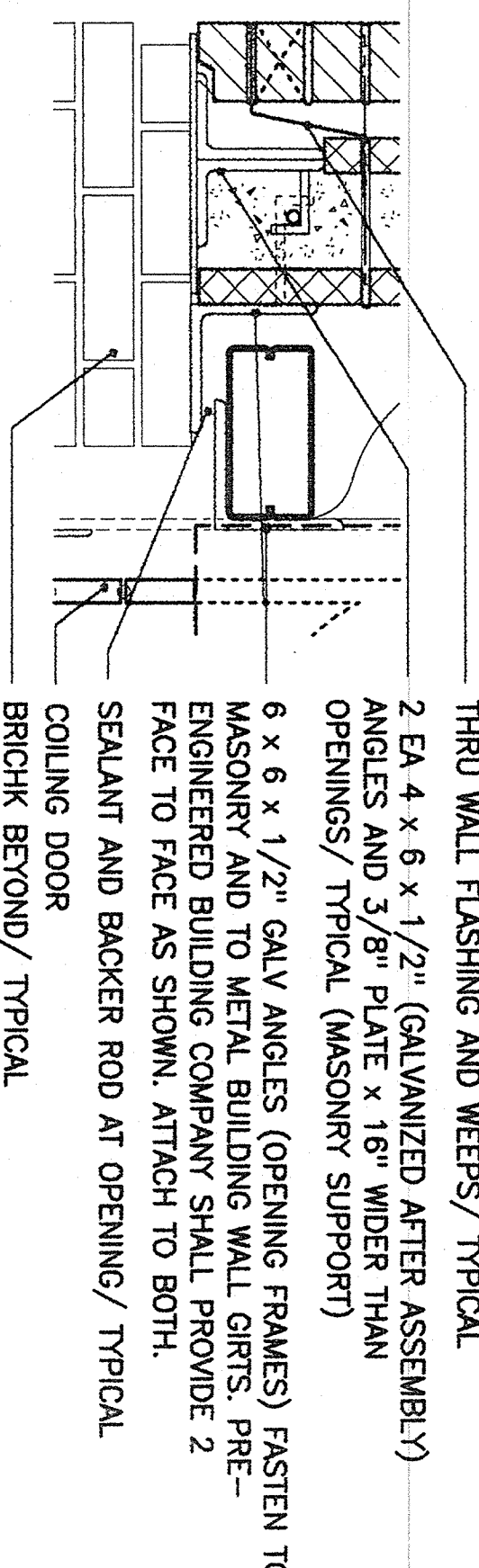

THRU WALL FLASHING AND WEEPS/ TYPICAL
2 EA 4 x 6 x 1/2" (GALVANIZED AFTER ASSEMBLY) ANGLES AND 3/8" PLATE x 16" WIDER THAN OPENINGS/ TYPICAL (MASONRY SUPPORT)
6 x 6 x 1/2" GALV ANGLES (OPENING FRAMES) FASTEN TO MASONRY AND TO METAL BUILDING WALL GIRTS. PRE-ENGINEERED BUILDING COMPANY SHALL PROVIDE 2 FACE TO FACE AS SHOWN. ATTACH TO BOTH.
SEALANT AND BACKER ROD AT OPENING/ TYPICAL
COILING DOOR
BRICK BEYOND/ TYPICAL

HEAD DETAIL AT OVERHEAD COILING DOOR AT MASONRY WALL
1 1/2"=1'-0"

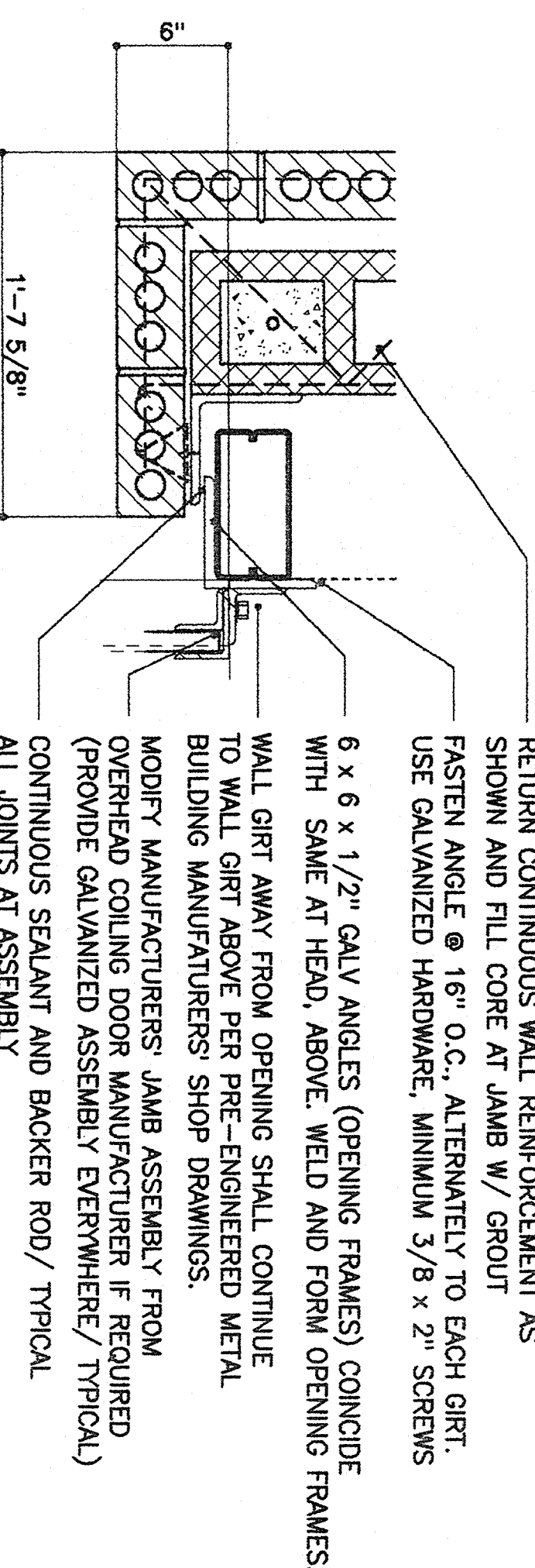

RETURN CONTINUOUS WALL REINFORCEMENT AS SHOWN AND FILL CORE AT JAMB W/ GROUT
FASTEN ANGLE @ 16" O.C., ALTERNATELY TO EACH GIRT. USE GALVANIZED HARDWARE, MINIMUM 3/8 x 2" SCREWS.
6 x 6 x 1/2" GALV ANGLES (OPENING FRAMES) COINCIDE WITH SAME AT HEAD, ABOVE, WELD AND FORM OPENING FRAMES.
WALL GIRT AWAY FROM OPENING SHALL CONTINUE TO WALL GIRT ABOVE PER PRE-ENGINEERED METAL BUILDING MANUFACTURERS' SHOP DRAWINGS.
MODIFY MANUFACTURERS' JAMB ASSEMBLY FROM OVERHEAD COILING DOOR MANUFACTURER IF REQUIRED (PROVIDE GALVANIZED ASSEMBLY EVERYWHERE/ TYPICAL)
CONTINUOUS SEALANT AND BACKER ROD/ TYPICAL
ALL JOINTS AT ASSEMBLY

JAMB DETAIL AT OVERHEAD COILING DOOR AT MASONRY WALL
1 1/2"=1'-0"

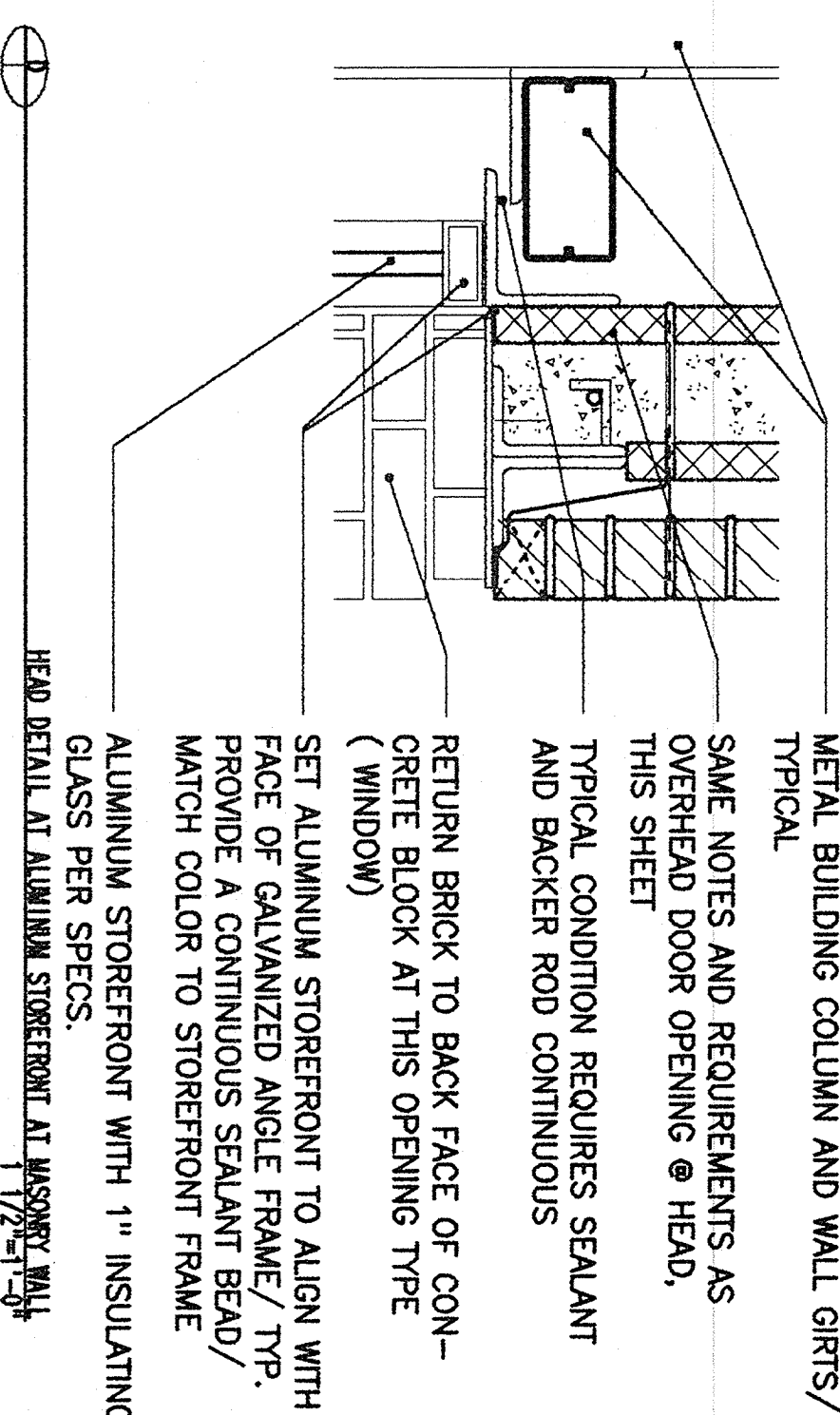

METAL BUILDING COLUMN AND WALL GIRTS/ TYPICAL
SAME NOTES AND REQUIREMENTS AS OVERHEAD DOOR OPENING @ HEAD, THIS SHEET
TYPICAL CONDITION REQUIRES SEALANT AND BACKER ROD CONTINUOUS
RETURN BRICK TO BACK FACE OF CON- CRETE BLOCK AT THIS OPENING TYPE (WINDOW)
SET ALUMINUM STOREFRONT TO ALIGN WITH FACE OF GALVANIZED ANGLE FRAME/ TYP. PROVIDE A CONTINUOUS SEALANT BEAD/ MATCH COLOR TO STOREFRONT FRAME
ALUMINUM STOREFRONT WITH 1" INSULATING GLASS PER SPECS.
HEAD DETAIL AT ALUMINUM STOREFRONT AT MASONRY WALL
1 1/2"=1'-0"

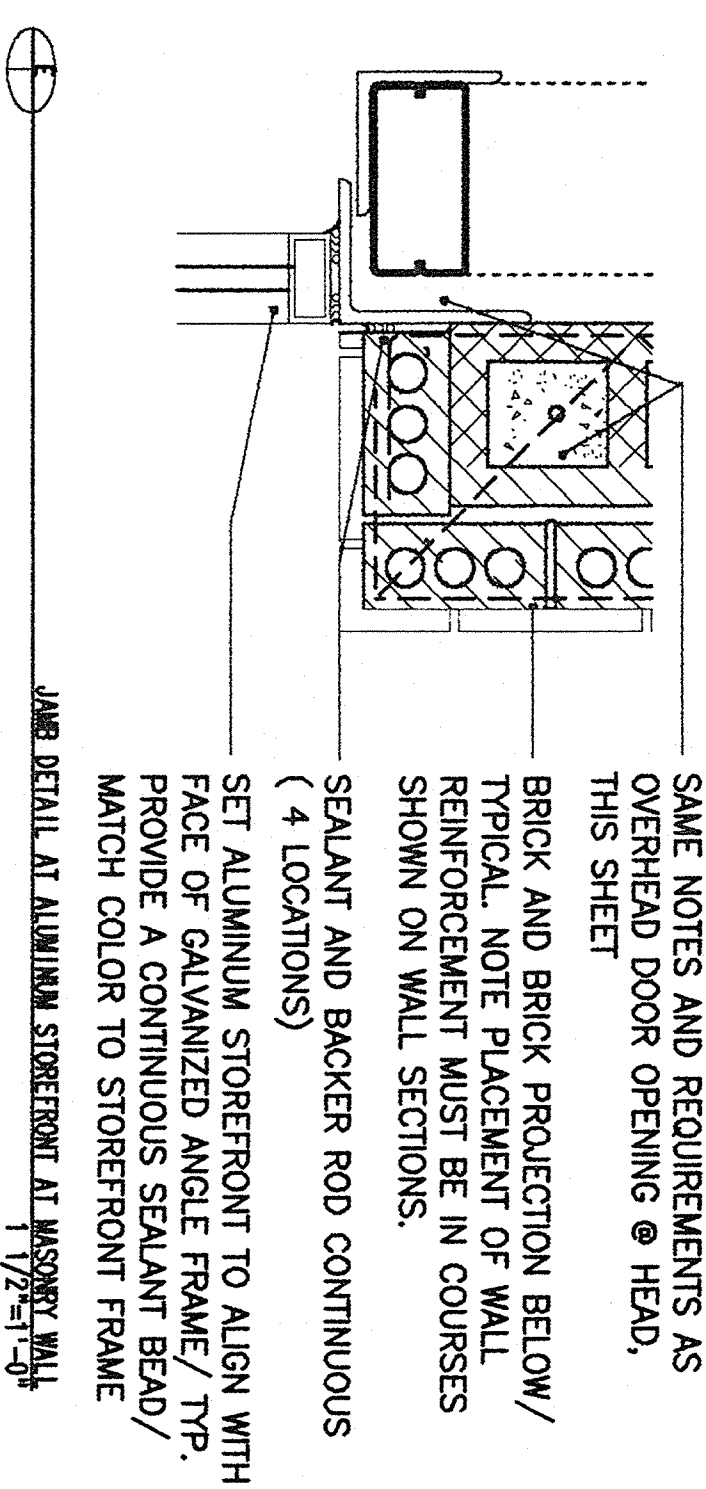

SEALANT AND BACKER ROD CONTINUOUS (4 LOCATIONS)
SET ALUMINUM STOREFRONT TO ALIGN WITH FACE OF GALVANIZED ANGLE FRAME/ TYP. PROVIDE A CONTINUOUS SEALANT BEAD/ MATCH COLOR TO STOREFRONT FRAME
JAMB DETAIL AT ALUMINUM STOREFRONT AT MASONRY WALL
1 1/2"=1'-0"

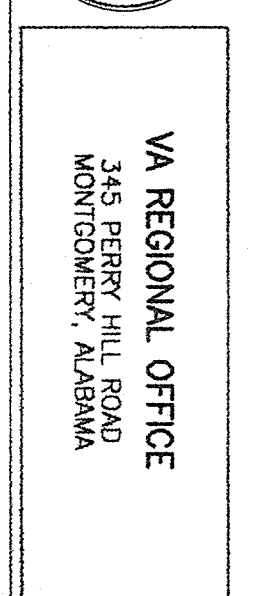
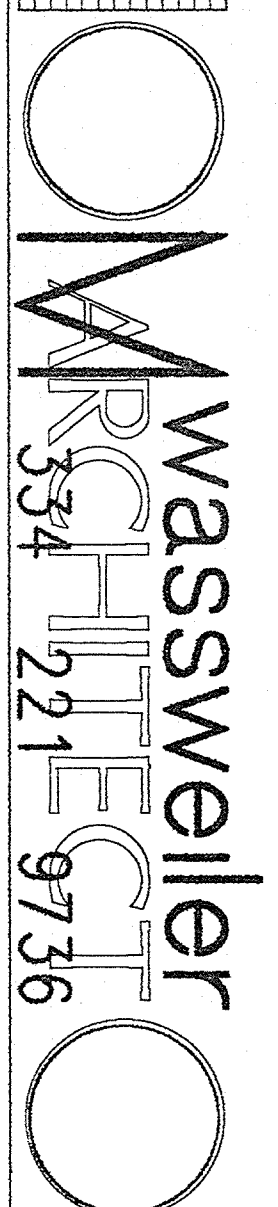
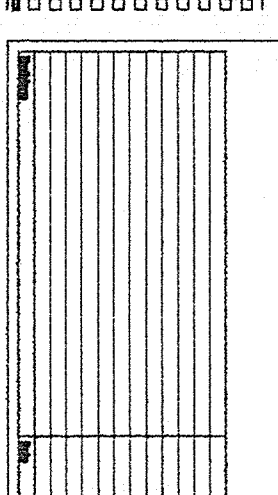
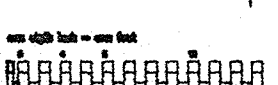

Project No.		Drawing No.	
MASONRY OPENING DETAILS		PREFABRICATE METAL STORAGE BUILDING	
Author	Checked	Designed	Drawn
WAW	WAW	WAW	WAW
Date: 1 Jan 2003		Scale: 3/2"=1'-0"	
Sheet: A-3.31		Total: 50	

