

DEMOLITION FLOOR PLAN

1. REMOVE PARTITION
2. REMOVE RAMP AND KNEE WALL
3. REMOVE SECTIONS OF ELEVATED PLATFORMS
4. REMOVE ELECTRICAL FROM PARTITION TO BE REMOVED, REWORK OR TERMINATE CIRCUITS AS REQUIRED
5. REMOVE SECTIONS OF CEILING FOR NEW WORK
6. REMOVE CUT PIECES OF CARPET TILE ON SIDES OF PARTITION

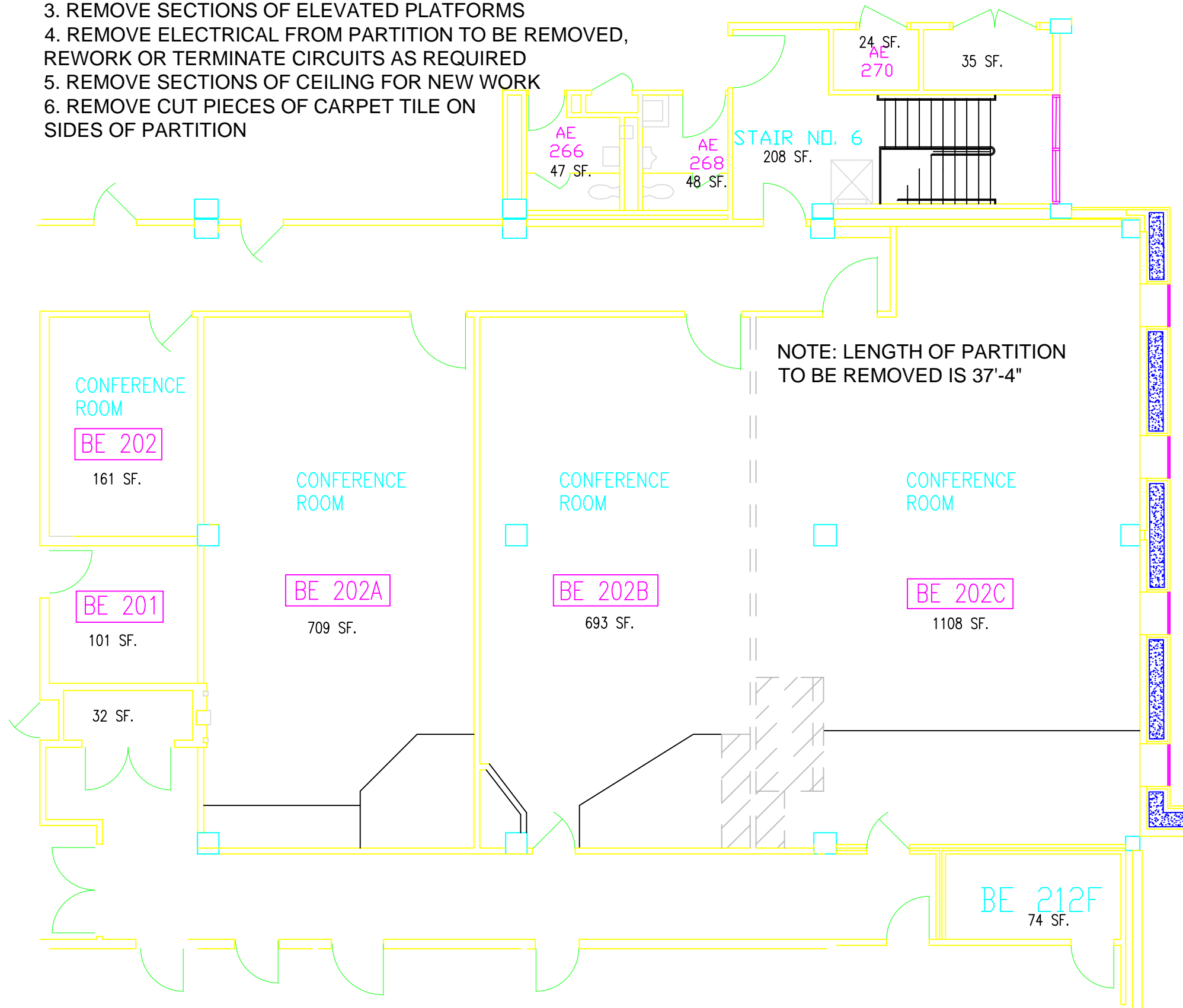

NEW FLOOR PLAN

1. MANUAL FOLDING PARTITION, 8 PANELS, 48" WIDTH, MODERFOLD ACOUSTI-SEAL 932 OR EQUAL
2. POCKET DOOR BY FOLDING PARTITION MANUFACTURER
3. METAL STUD AND DRYWALL POCKET ENCLOSURE TO DECK
4. SOUND Baffle TO UNDERSIDE OF DECK
5. ENCLOSE SIDES OF ELEVATED PLATFORMS
6. ADD TUBULAR STEEL RAILINGS AT EDGE
7. TIE BACK CEILING ON BOTH SIDES OF BAFFLE
8. PATCH BACK CARPET TILES, INCL. POCKET
9. PAINT FINISH ALL NEW UNFINISHED SURFACES

