

VETERANS ADMINISTRATION
WASHINGTON, D. C.

APPROVED *[Signature]*
ASSISTANT ADMINISTRATOR

[Signature]
DIRECTOR, TECHNICAL SERVICE

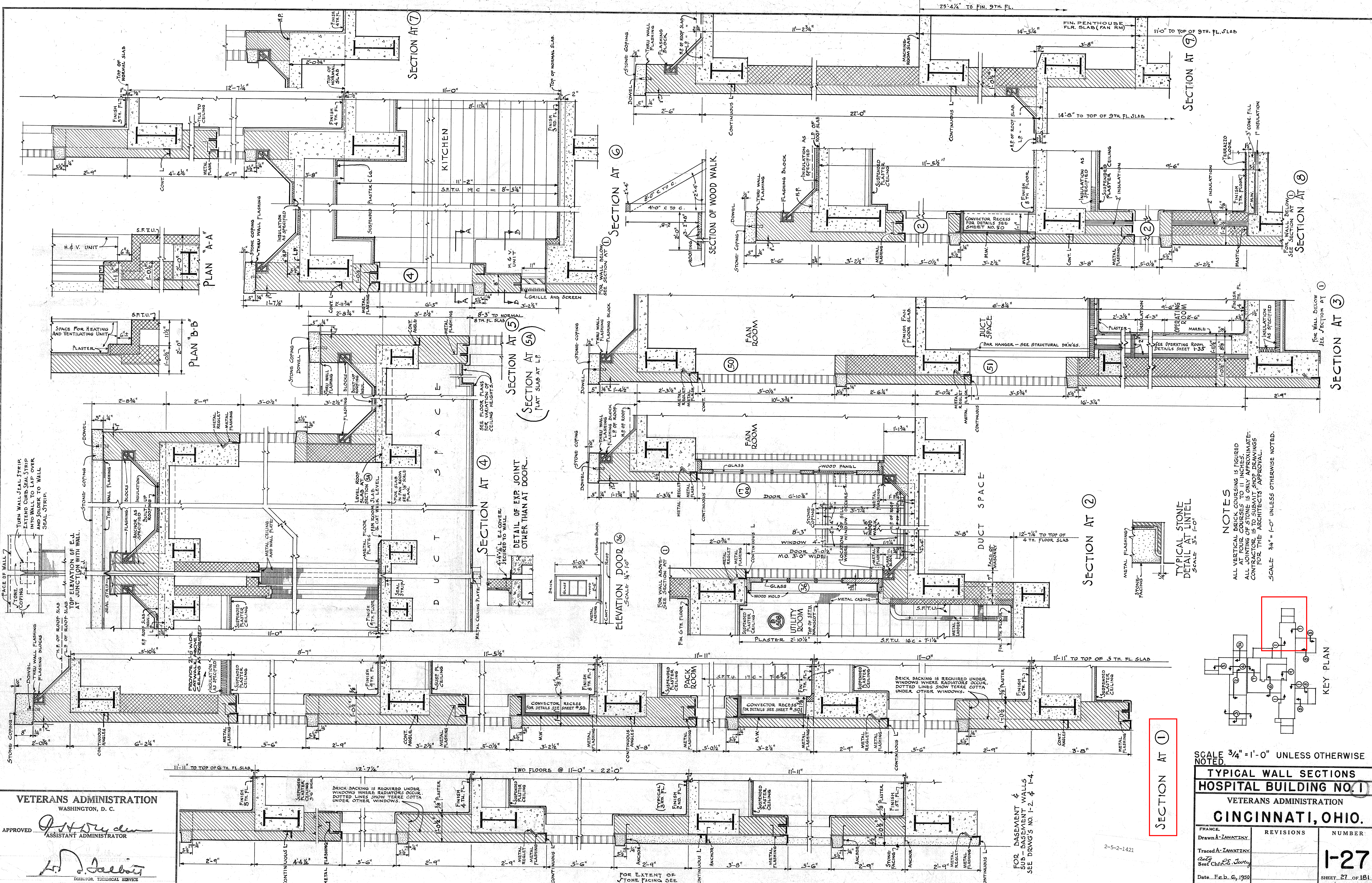

NOTES
ALL VERTICAL BRICK COURSES ARE FIGURED
ALL AT FOUR COURSES TO 11 INCHES
ALL JOINTS OF STONE IS ONLY APPROXIMATE;
CONTRACTOR IS TO SUBMIT SHOP DRAWINGS
FOR THE ARCHITECT'S APPROVAL.
SCALE 3/4" = 1'-0" UNLESS OTHERWISE NOTED.

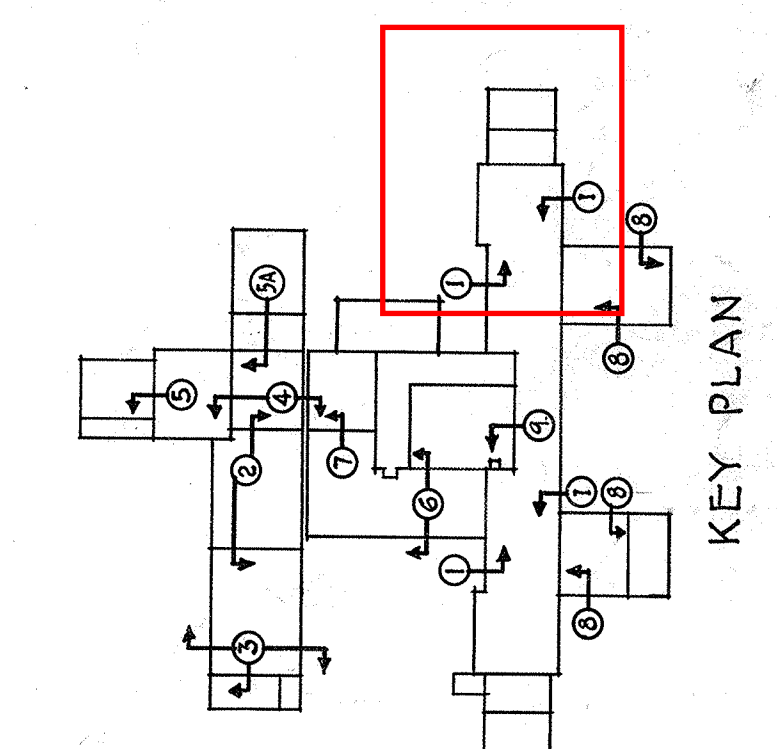

SCALE 3/4" = 1'-0" UNLESS OTHERWISE NOTED.		
TYPICAL WALL SECTIONS HOSPITAL BUILDING NO. 1 VETERANS ADMINISTRATION CINCINNATI, OHIO.		
FRANCE Drawn A. ZAWATSKY	REVISIONS	NUMBER
Traced A. ZAWATSKY atg Seal Chf. R. E. JURY		1-27
Date Feb. 6, 1920		SHEET 27 OF 181
Division Chief <i>[Signature]</i>		Proj. No. 2887

2-5-2-1421