

BUILDING 8  
(F2) MEZZANINE MECHANICAL PLAN — DEMOLITION  
SCALE: 1/8" = 1'-0" SEE PHASING NOTES

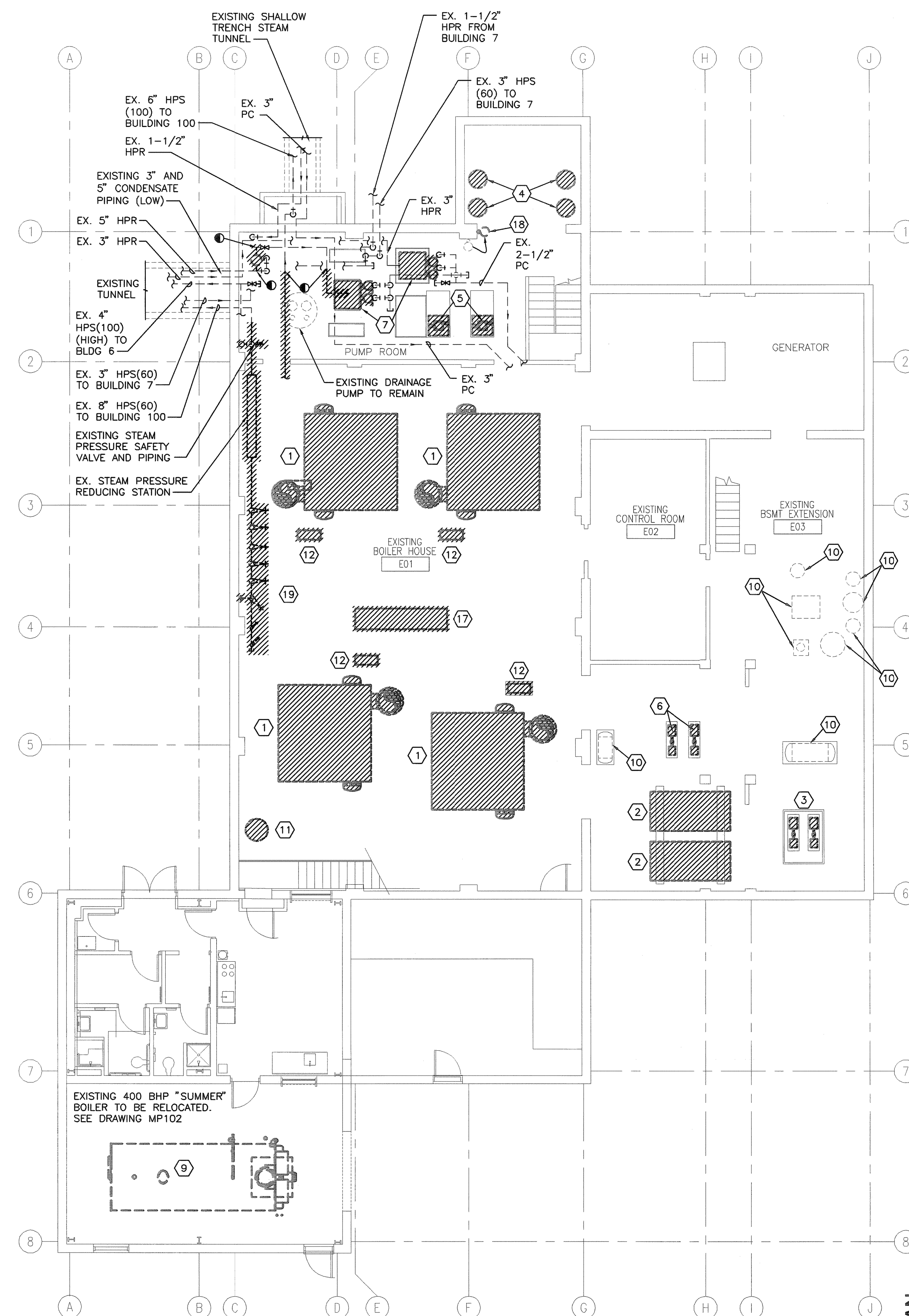

BUILDING 8  
BASEMENT MECHANICAL PLAN — DEMOLITION  
SCALE: 1/8" = 1'-0" SEE PHASING NOTES

#### GENERAL NOTES

- A. REFER TO DRAWING MP001 FOR TYPICAL SYMBOLS AND ABBREVIATIONS USED ON THIS DRAWING.
- B. AFTER RECEIVING A WRITTEN APPROVAL TO START WORK FROM THE VA COTR ALL EXISTING MECHANICAL SYSTEMS, AND EQUIPMENT IN BUILDING 8 SHALL BE DISCONNECTED AND REMOVED, UNLESS OTHERWISE DIRECTED.
- C. MECHANICAL CONTRACTOR TO FIELD SURVEY BUILDING 8 AND INCLUDE COST FOR MINOR RELOCATION OF EXISTING CONDENSATE AND PIPING TO ALLOW INSTALLATION OF NEW EQUIPMENT AND PIPING.
- D. EXISTING SYSTEM MUST REMAIN ACTIVE UNTIL A WRITTEN LETTER IS RECEIVED FROM THE COTR.
- E. ROOF PENETRATIONS OF ITEMS TO BE REMOVED SHALL BE CAPPED AND SEALED. COVER CAP WITH 3/4" X 1/4" INCH ARMAFLAK INSULATION AND ALUMINUM JACKET.
- F. WHEN DEMOLITION IS COMPLETE, ONLY THE MECHANICAL PIPING AND EQUIPMENT SHOWN ON SHEET MP-101 SHALL REMAIN FOR MECHANICAL STEAM SYSTEMS. REMOVE ALL HANGERS, SUPPORTS, ETC. THAT WILL NO LONGER BE IN SERVICE. EXISTING CONDENSATE PADS SHALL REMAIN.

DRAWING KEYNOTES 

1. EXISTING BOILER AND ALL ASSOCIATED PIPING AND CONTROLS WIRING SHALL BE REMOVED.
2. EXISTING CONDENSATE TANK AND ALL ASSOCIATED PIPING AND CONTROLS WIRING SHALL BE REMOVED.
3. EXISTING FUEL OIL PUMPS AND ALL ASSOCIATED PIPING AND CONTROLS WIRING SHALL BE REMOVED.
4. EXISTING CHEMICAL FEED TANKS AND ALL ASSOCIATED PIPING AND CONTROLS WIRING SHALL BE REMOVED.
5. EXISTING BOILER FEEDWATER PUMPS AND ALL ASSOCIATED PIPING AND CONTROLS WIRING SHALL BE REMOVED.
6. EXISTING CONDENSATE TRANSFER PUMPS AND ALL ASSOCIATED PIPING AND CONTROLS WIRING SHALL BE REMOVED.
7. EXISTING CONDENSATE PUMPS AND ALL ASSOCIATED PIPING AS SHOWN AND CONTROLS WIRING SHALL BE REPLACED.
8. EXISTING DEAERATOR AND ALL ASSOCIATED PIPING AND CONTROLS WIRING SHALL BE REMOVED.
9. EXISTING BOILER WITH STACK ECONOMIZER AND ALL ASSOCIATED PIPING AND CONTROLS WIRING SHALL BE RELOCATED. SEE MP102 FOR NEW LOCATION.
10. EQUIPMENT RELOCATED OR REMOVED UNDER PLUMBING CONTRACTOR. REFER TO DRAWING PL101.
11. EXISTING BLOWOFF TANKS AND ALL ASSOCIATED PIPING AND CONTROLS WIRING SHALL BE REMOVED.
12. EXISTING FLAME SAFEGUARD PANEL SHALL BE REMOVED.
13. EXISTING SATELLITE BOILER CONTROL PANEL AND ALL ASSOCIATED WIRING SHALL BE REMOVED.
14. EXISTING CHEMICAL TREATMENT FOR SUMMER BOILER AND ALL ASSOCIATED PIPING AND CONTROLS WIRING SHALL BE REMOVED.
15. EXISTING AIR COMPRESSOR.
16. EXISTING CONTINUOUS BLOWDOWN TANK AND ALL ASSOCIATED PIPING AND CONTROLS WIRING SHALL BE REMOVED.
17. EXISTING MAIN BOILER SYSTEM CONTROL PANEL AND ALL ASSOCIATED WIRING SHALL BE REMOVED.
18. EXISTING EYE WASH STATION TO BE RELOCATED SEE PLUMBING DRAWING PL101 FOR NEW LOCATION.
19. REMOVE EXISTING STEAM HEADER AND ALL ASSOCIATED VALVES, TRAPS, ETC.
20. REMOVE ALL EXISTING PIPING, CONDUNTS, HANGERS SUPPORTS, ETC., THAT WILL NO LONGER BE IN USE. VERIFY ALL ITEMS WITH COTR.

## PHASING NOTES

1. WHEN INSTRUCTED BY THE COTR, REPLACE THE TWO EXISTING STEAM CONDENSATE PUMPS AND NEW INLET AND OUTLET PIPING AND VALVES.
2. AFTER THE (2) NEW 500 BHP BOILERS HAVE BEEN INSTALLED AND ACCEPTED BY THE COTR, RELOCATE AND RECONDITION THE EXISTING 400 BHP WITH STACK ECONOMIZER "SUMMER" BOILER TO THE NEW BOILER BUILDING 21.
3. ALL REMAINING DEMOLITION WORK SHALL BE DONE AFTER (2) NEW 500 BHP BOILERS AND RELOCATED 400 BHP BOILER ARE INSTALLED IN BUILDING 21 AND ACCEPTED BY THE COTR.

[illegible]

Department of Veterans Affairs  
William Jennings Bryan Dorn  
VA Medical Center  
6439 Garners Ferry Road  
Columbia, SC 29209

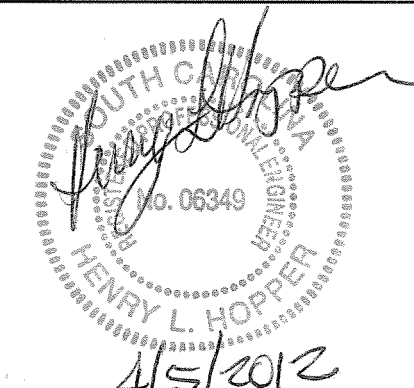

SEAL

Architect/Engineer Address



**Design & Management Solutions for the Built Environment**

8016 TOWER POINT DRIVE  
CHARLOTTE, NC 28227

P 704.814.1329  
F 704.321.0833

WWW.HSHPC.COM

COPYRIGHT © 2011 HARRELL SALLICK & HOPPER, PC  
HSH PROJECT # 11015

Recommended Approvals:	
1. MEDICAL DIRECTOR	6. OPERATIONS SERVICE LINE MANAGER
2. ASSOCIATE DIRECTOR	7. INFECTION CONTROL MANAGER
3. CHIEF OF STAFF	8. SAFETY MANAGER
4. ASSOC. DIRECTOR	9. GENERAL ENGINEER
5. SERVICE LINE MGRS.	10. COTR

Drawing Title	BUILDING 8 MECHANICAL PLAN - DEMOLITION
---------------	---

**\* BUILDING IS FULLY**

Project Title  
**REPLACE BOILER PLANT/  
COGEN/CHP**

Drawn	2000
-------	------

Building  
01

AutoCAD File Name	D
-------------------	---

PRIL 10, 2012

Project Number  
544-11-101

RAWING No.

MD101

