

three inches = one foot
one and one half inches = one foot
one inch = one foot
three quarters inch = one foot
three eighths inch = one foot
one quarter inch = one foot
one eighth inch = one foot
one eighth inch = one foot

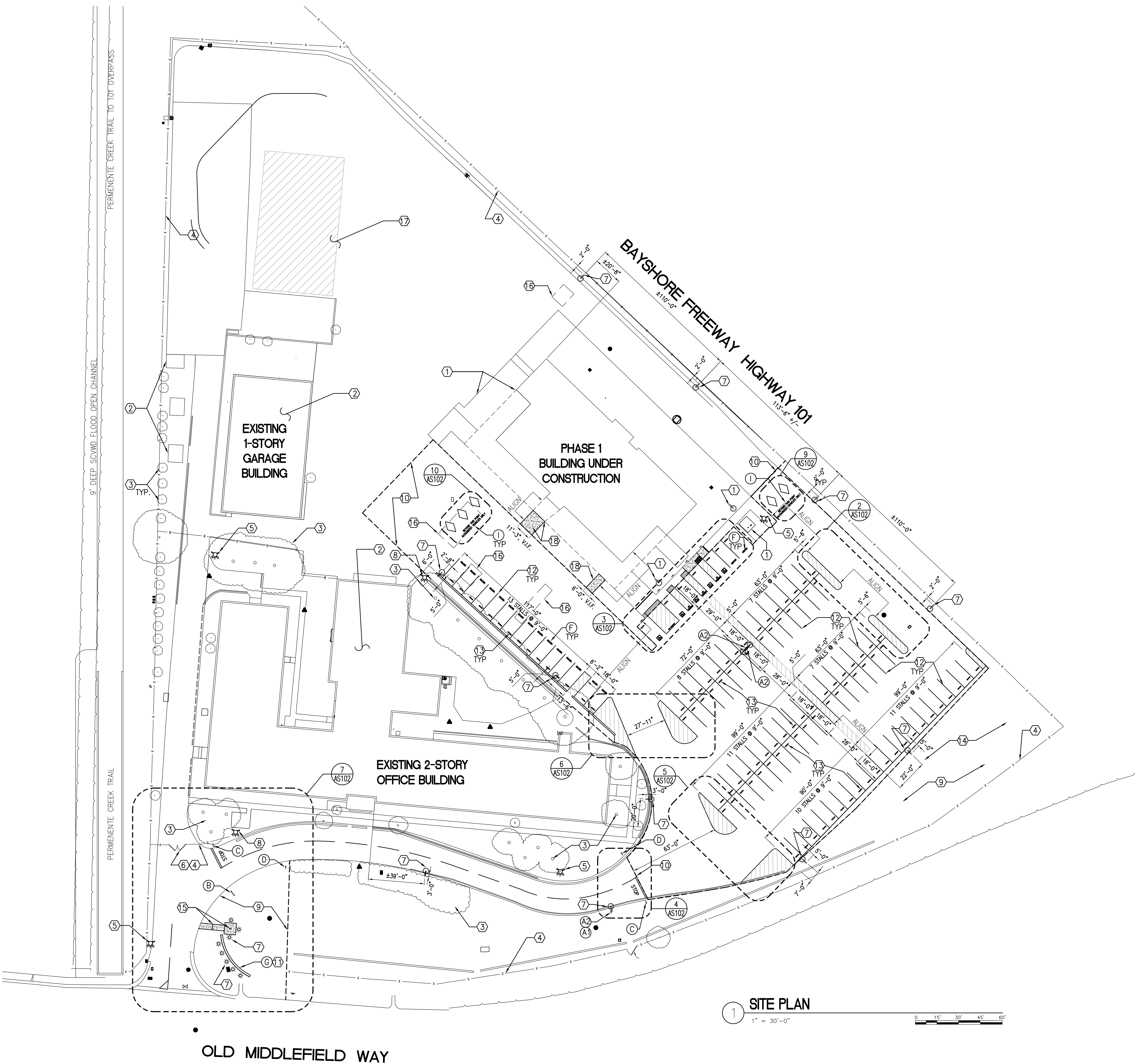

1 SITE PLAN
1" = 30'-0"

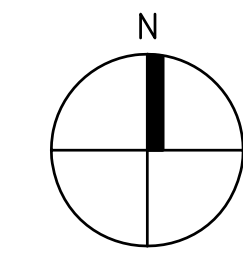

GENERAL NOTES

1. GENERAL CONTRACTOR SHALL COORDINATE WITH THE CONTRACTING OFFICER REPRESENTATIVE (COR) TO MAINTAIN CLEAR ACCESS FOR PHASE 1 BUILDING UNDER CONSTRUCTION.
2. REFER TO SHEET G1001 FOR ABBREVIATIONS, SYMBOLS & LEGEND.
3. SEE SIGN MESSAGE SCHEDULE DETAIL 2/AG101 FOR SIGN TYPE AND SIGN MESSAGE.
4. SEE SHEET AG101 FOR ASPHALT PAINT COLORS.
5. GENERAL CONTRACTOR SHALL POT HOLE SITE LOCATIONS AS REQUIRED AND FIELD VERIFY WITH THE CONTRACTING OFFICER REPRESENTATIVE (COR) PRIOR TO PROCEEDING WITH EXCAVATIONS.
6. FOR SITE BACKFILL USING ENGINEERED FILL, GENERAL CONTRACTOR SHALL RETAIN VA APPROVED 3RD PARTY GEOTECHNICAL ENGINEER FOR APPROVAL.
7. WHERE ASPHALT REPAIR IS NEEDED FOLLOWING UTILITY EXCAVATIONS OR OTHER DEMOLITION, PATCH ASPHALT TO MATCH ADJACENT SURFACE GRADES AND DEPTHS. SEE SIMILAR CIVIL DETAIL 4/CS100.

KEYED NOTES

- 1 EXISTING STRUCTURE TO REMAIN.
- 2 EXISTING TREES/SHRUBS TO REMAIN.
- 3 EXISTING CHAIN LINK FENCE TO REMAIN
- 4 EXISTING FIRE HYDRANT TO REMAIN
- 5 EXISTING CHAIN LINK GATE TO REMAIN.
- 6 SITE LIGHT. SEE ELECTRICAL DRAWINGS & SPECIFICATIONS.
- 7 RELOCATED FIRE HYDRANT PER CITY OF MOUNTAIN VIEW REQUIREMENTS, COORDINATE LOCATION WITH VA CONTRACTING OFFICER REPRESENTATIVE (COR).
- 8 LANDSCAPING & IRRIGATION SYSTEM, SEE LANDSCAPE DRAWINGS & SPECIFICATIONS.
- 9 SCOPE LIMITS OF EXISTING ASPHALT TO BE PATCHED, FILLED & PREPARED TO RECEIVE SEAL COAT. SEE SPECIFICATIONS.
- 10 STONE VENEERED MONUMENT SIGN & FOUNDATION. SEE DETAILS 1/AG102, 2/AG102, SHEET AG103 & SPECIFICATIONS.
- 11 PARKING STALL STRIPING, 4" WIDE PAINTED WHITE.
- 12 CONCRETE WHEEL STOPS. SEE DETAIL 5/AS103 & SPECIFICATIONS.
- 13 DRAINAGE CHANNEL, SEE CIVIL DRAWINGS.
- 14 FLAG POLE, CONCRETE WALK & PODIUM. SEE ENLARGED PLAN 2/AS102, DETAIL 12/AS103 AND SPECIFICATIONS.
- 15 FILL, COMPACT & PATCH ASPHALT PAVEMENT AT AREAS OF DEMOLITION OR REMOVAL TO MATCH ADJACENT GRADE & SURFACE. SEE GENERAL NOTES 6 & 7.
- 16 CONTRACTOR STAGING AREA. CONTRACTOR TO COORDINATE WITH THE CONTRACTING OFFICER REPRESENTATIVE (COR) PRIOR TO STAGING AND STORING MATERIALS.
- 17 CONCRETE WALK TO MATCH EXISTING BUILDING ENTRY PAVING FINISH AND ALIGNED W/EXISTING JOINTS AND/OR ENTRY WALK. SEE DETAILS 9&10/ AS103, SIM. REFER TO LANDSCAPE DRAWINGS FOR IRRIGATION MODIFICATIONS AS REQUIRED.

100% CONSTRUCTION DOCUMENTS

<div>100% CONSTRUCTION DOCUMENTS</div> <div>Revisions</div> <div>09/06/2013</div> <div>Date</div>		<div>Stamp and Signature</div> <div></div>		<div>ARCHITECT/ENGINEERS:</div> <div></div> <div>ENGINEERS ARCHITECTS</div> <div>ONE KAISER PLAZA SUITE 445</div> <div>OAKLAND CALIFORNIA 94612</div> <div>TEL 510.271.6701 FAX 510.271.6707</div> <div>THE KPA GROUP</div> <div>©THE KPA GROUP 2013</div> <div>KPA Project No. 552-11</div>		<div>Drawing Title</div> <div>SITE PLAN</div> <div>Approved Project Director</div> <div>VAPAHCS PLANNING AND ENGINEERING</div>		<div>Project Title</div> <div>MOUNTAIN VIEW PARKING LOT</div> <div>Location</div> <div>1776 OLD MIDDLEFIELD WAY, MOUNTAIN VIEW, CA</div> <div>Date</div> <div>09/06/2013</div> <div>Checked</div> <div>PWP</div> <div>Drawn</div> <div>KPA TEAM</div>		<div>Project Number</div> <div>640-381</div> <div>Building Number</div> <div>NA</div> <div>Drawing Number</div> <div>AS101</div> <div>Dwg. 10 of 16</div>		<div>Office of Construction and Facilities Management</div> <div></div>	
---	--	--	--	--	--	--	--	---	--	---	--	---	--