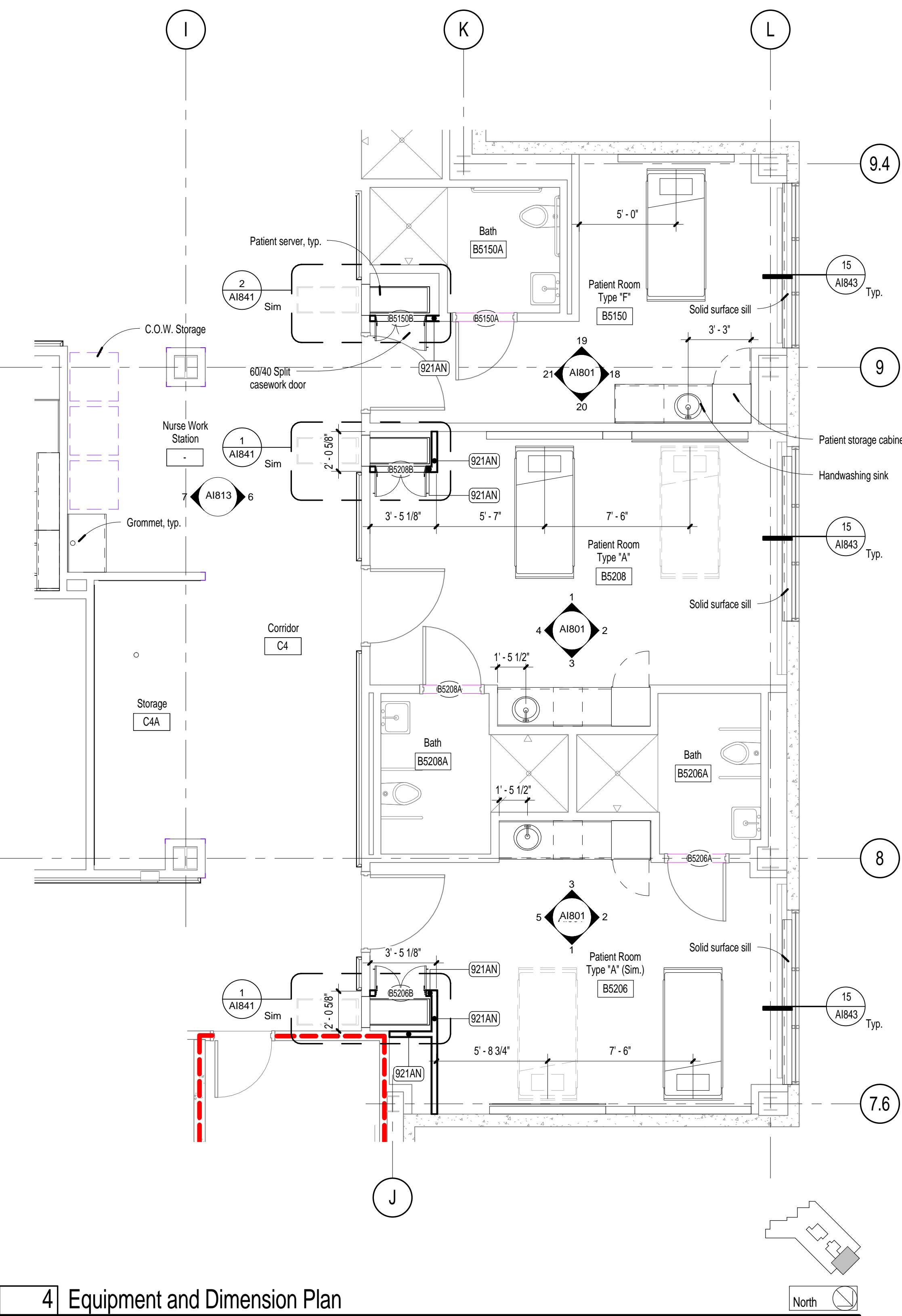

$1/4" = 1'-0"$

$$1/4'' = 1'-0''$$
[illegible]

5485 Reno Corporate Drive, Suite 100  
Reno, Nevada 89511-2262

P 775+332+6640  
F 775+332+6642

hkarchitects.com

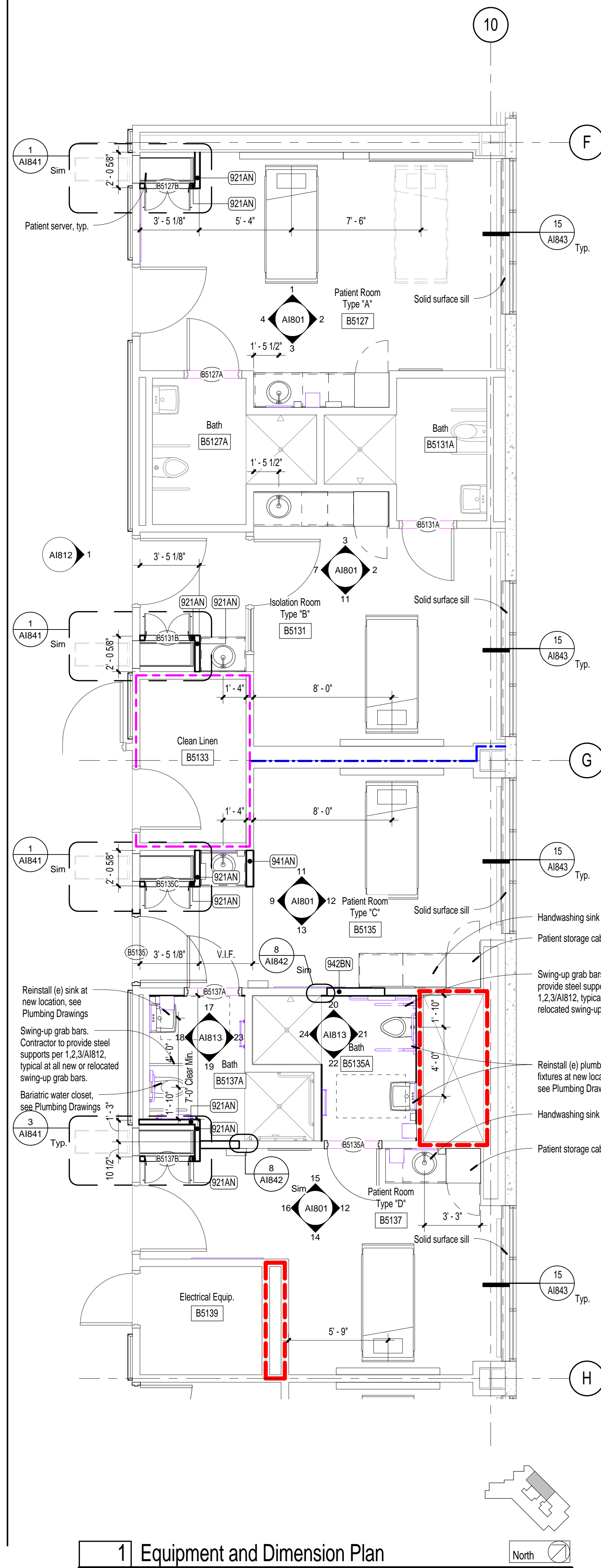
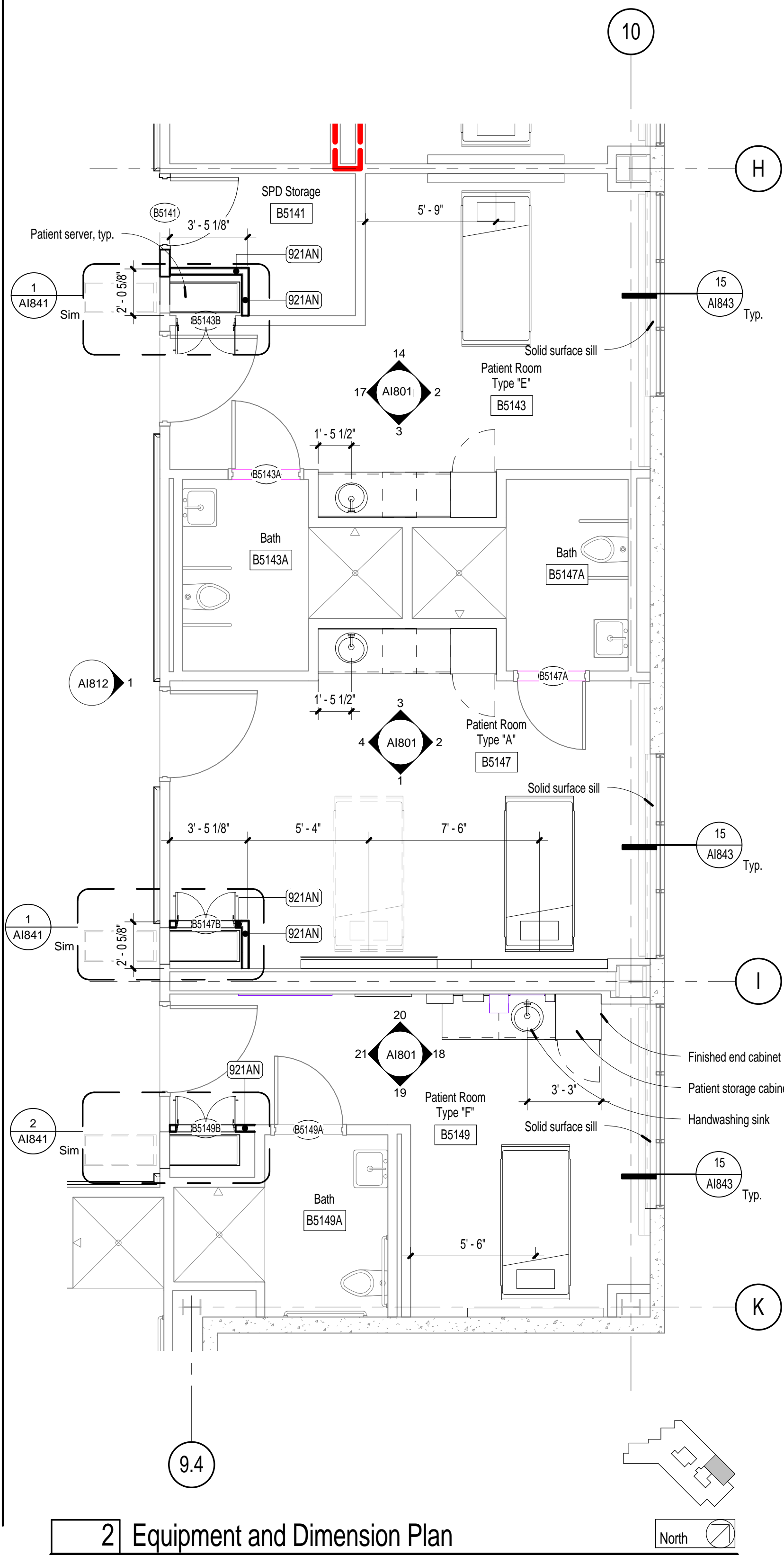
$$1/4^8 = 1'-0''$$

$$1/4^{\circ} = 1'-0''$$

$$1/4^8 = 1 \cdot 0^8$$