

## IMPORTANT NOTES

1. The ceiling minimum structure capacity must be able to support the load specified on the installation drawing.
2. Electrical power source outlet already available by the facility at a maximum distance of 3 meters from charging station.
3. Any obstructions such as vents, pipes, lights and sprinklers that could possibly be in the path of the ceiling lifts to be removed or relocated by the facility prior to installation.
4. Modifications of door headers by the facility.
5. Arjohuntleigh reserves the right to slightly modify the track layout if necessary.
6. See the "Agreed Conditions for the Installation of Ceiling Lifts" document included with this quote for important installation details.
7. Arjohuntleigh will not be held responsible for any damages, inconvenience, resulting from hitting any non visible conduits during our installation process.
8. Signed drawings are required prior to ordering and installation of ceiling lifts. This signature of each drawings confirms agreement of all the conditions listed above.

### GENERAL DRAWING APPROBATION









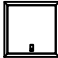
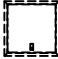
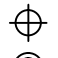

- Review of all 3 pages
- Total quantity of rooms 10
- Approbation of layout for each room
- Approbation of structure for each room

CUSTOMER

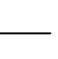
APPROVAL: \_\_\_\_\_

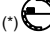
DATE: \_\_\_\_\_

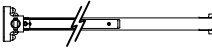
## Legend

(*) 	Light	×	Bracket
	Vent	⊗	Joint bracket
	Access trap required	●	Wall bracket
	Existing access trap	◆	Wall post side
	Sprinkler	▶	Wall post
	Smoke detector	└┐	"T" junction
	Electrical outlet		Gate
	Curtain track	(*) 	Turntable
	IV track		Exchanger
	Swivel pole	(*) 	Motor/Charger location

(\*) Symbol may vary depending of equipment type

Rev1-usaddsom02	09-MAY-2012
REVISION(S)	DATE(S) (D-M-Y)

## INSTALLATION DRAWING

## VA PALO ALTO

DISTRIBUTOR :

ARJOHUNTLEIGH

REPRESENTATIVE :

GEORGE JOHNSON

DATE (DD-MMM-YYYY) :

10-APR-2012

REFERENCE # :

QC-410122MS

PAGE :

1 / 3

**ARJOHUNTLEIGH**

- ALL HARDWARE INCLUDED.  
(ACCORDING TO STRUCTURE)

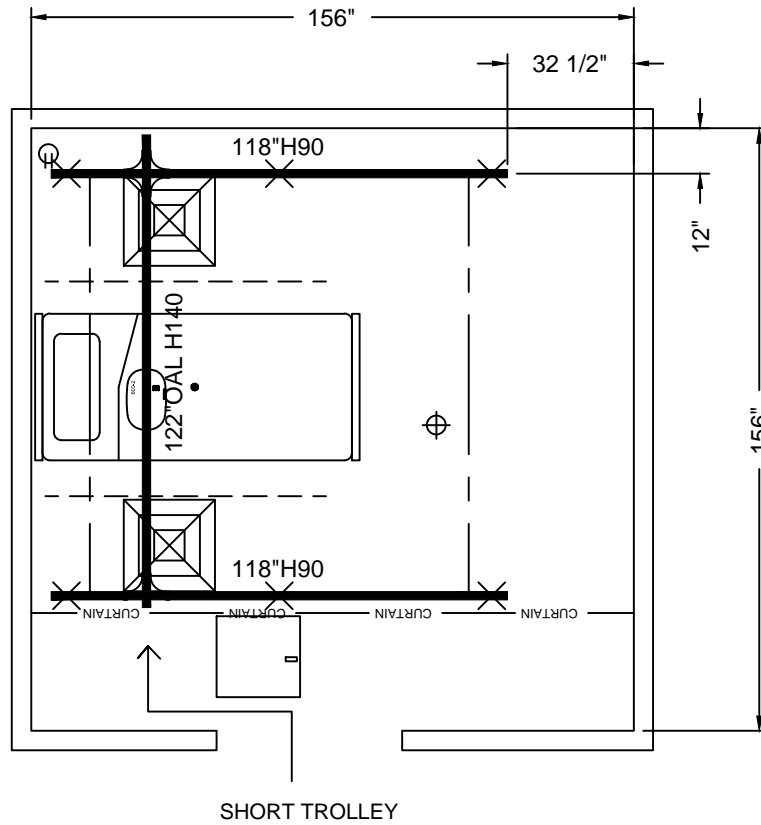

20.7 MPA [3000 PSI] MIN.

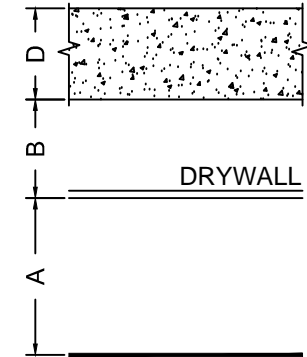

A=108"  
B=78"  
D=6 1/4"

QUANTITY OF ROOMS: **9**

LISTING OF ROOM NUMBER(S):  
4A121,123,127,129,155,157  
4C155,157  
2A155

**VA PALO ALTO**

SAFE WORKING LOAD BELOW LIFT: 600LBS [272KG]  
MINIMUM STRUCTURE CAPACITY: 750LBS [340KG]

Rev1-usaddsom02	09-MAY-2012
DATE CREATED (DD-MMM-YYYY) :	10-APR-2012

DRAWN BY : usaddsom02	SCALE : 1/4" = 1'
REFERENCE # : QC-410122MS	PAGE : 2 / 3

THIS LAYOUT HAS BEEN PREPARED WITH SUPPLIED DATA.  
VERIFICATIONS MUST BE DONE ON SITE.

NOTE: CUTTING OF RAILS ON SITE ONLY

- ALL HARDWARE INCLUDED.  
(ACCORDING TO STRUCTURE)

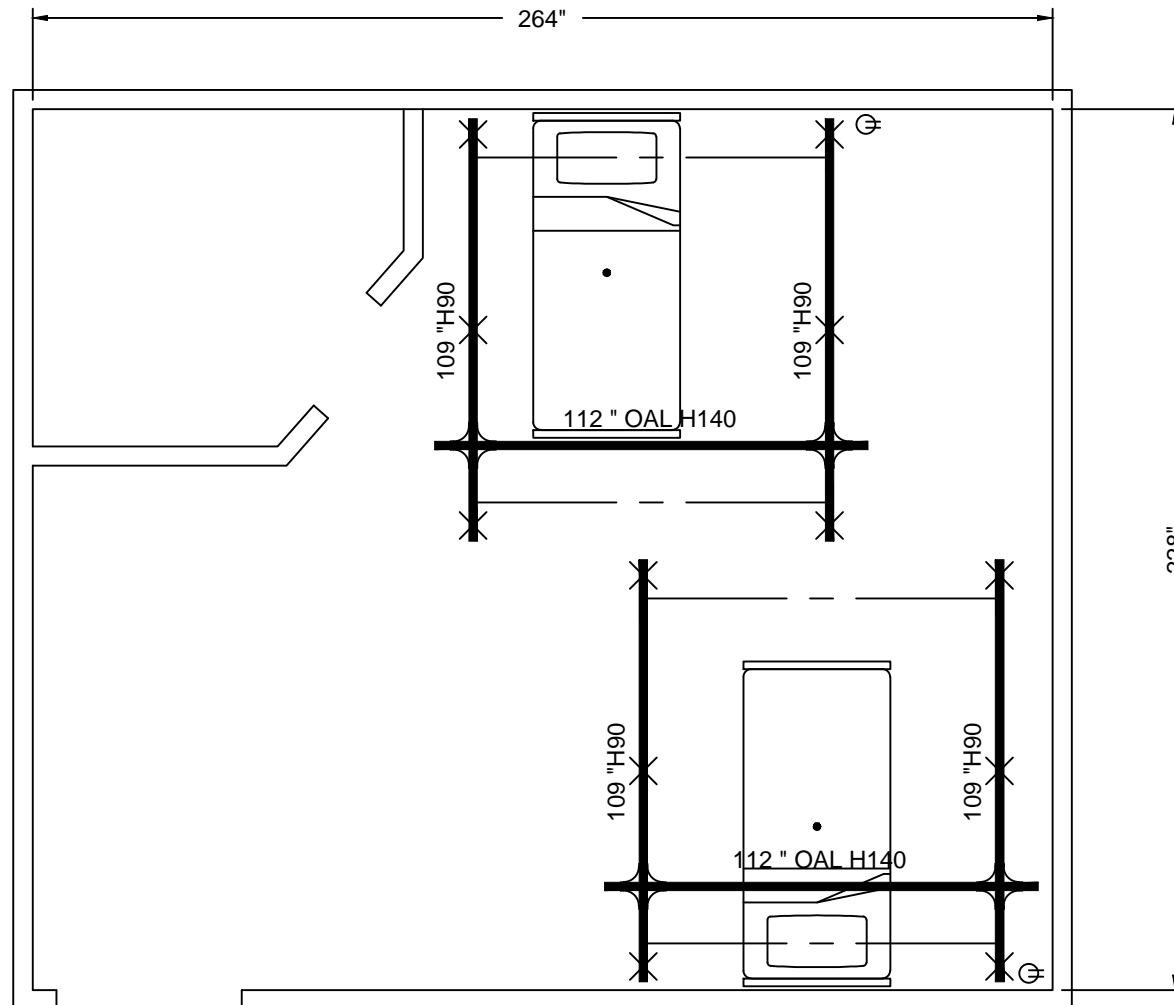

20.7 MPA [3000 PSI] MIN.

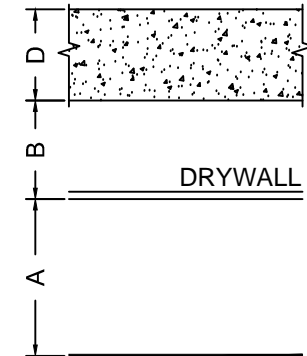

A=108"  
B=36"  
D=6 1/4"

QUANTITY OF ROOMS: 1

LISTING OF ROOM NUMBER(S):  
POLY TRAUMA 117

VA PALO ALTO

SAFE WORKING LOAD BELOW LIFT: 600LBS [272KG]  
MINIMUM STRUCTURE CAPACITY: 750LBS [340KG]

Rev1-usaddsom02	09-MAY-2012
DATE CREATED (DD-MMM-YYYY) :	10-APR-2012

DRAWN BY : usaddsom02	SCALE : 1/4" = 1'
REFERENCE # : QC-410122MS	PAGE : 3 / 3

THIS LAYOUT HAS BEEN PREPARED WITH SUPPLIED DATA.  
VERIFICATIONS MUST BE DONE ON SITE.

NOTE: CUTTING OF RAILS ON SITE ONLY