

## IMPORTANT NOTES

1. The ceiling minimum structure capacity must be able to support the load specified on the installation drawing.
2. Electrical power source outlet already available by the facility at a maximum distance of 3 meters from charging station.
3. Any obstructions such as vents, pipes, lights and sprinklers that could possibly be in the path of the ceiling lifts to be removed or relocated by the facility prior to installation.
4. Modifications of door headers by the facility.
5. Arjohuntleigh reserves the right to slightly modify the track layout if necessary.
6. See the "Agreed Conditions for the Installation of Ceiling Lifts" document included with this quote for important installation details.
7. Arjohuntleigh will not be held responsible for any damages, inconvenience, resulting from hitting any non visible conduits during our installation process.
8. Signed drawings are required prior to ordering and installation of ceiling lifts. This signature of each drawings confirms agreement of all the conditions listed above.

### GENERAL DRAWING APPROBATION















- Review of all 12 pages
- Total quantity of rooms 11
- Approbation of layout for each room
- Approbation of structure for each room

CUSTOMER

APPROVAL: \_\_\_\_\_

DATE: \_\_\_\_\_

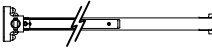
## Legend

(*) 	Light	×	Bracket
	Vent	⊗	Joint bracket
	Access trap required	●	Wall bracket
	Existing access trap	◆	Wall post side
	Sprinkler	▶	Wall post
	Smoke detector	└┐	"T" junction
	Electrical outlet		Gate
	Curtain track	(*) 	Turntable
	IV track		Exchanger
	Swivel pole	(*) 	Motor/Charger location

(\*) Symbol may vary depending of equipment type

Rev1-usaddsom02	15-NOV-2012
REVISION(S)	DATE(S) (D-M-Y)

## INSTALLATION DRAWING

## VA PALO ALTO

DISTRIBUTOR :	ARJOHUNTLEIGH	<b>ARJOHUNTLEIGH</b>
REPRESENTATIVE :	BILL ASHBROOK	
DATE (DD-MMM-YYYY) :	10-APR-2012	
REFERENCE # :	QC-410123MS	PAGE :
		1 / 12

- ALL HARDWARE INCLUDED.  
(ACCORDING TO STRUCTURE)

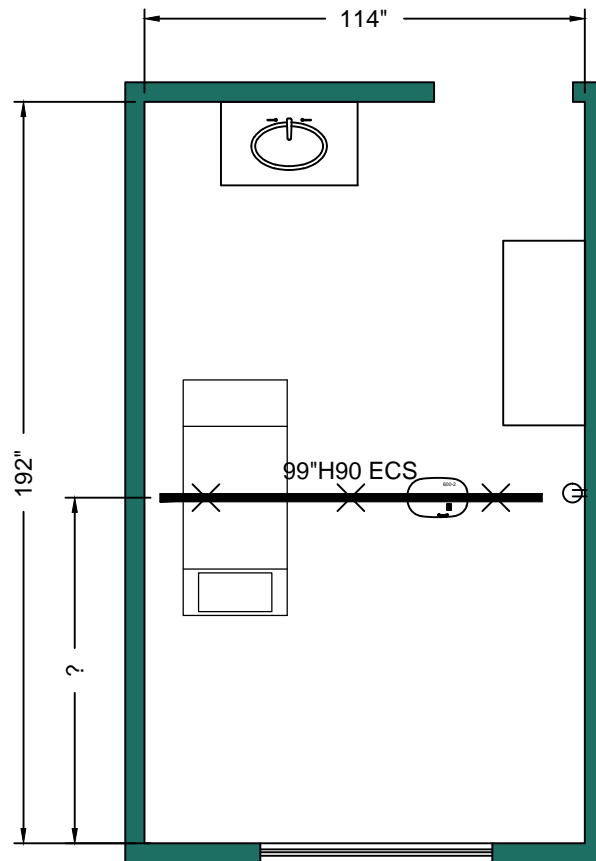

20.7 MPA [3000 PSI] MIN.

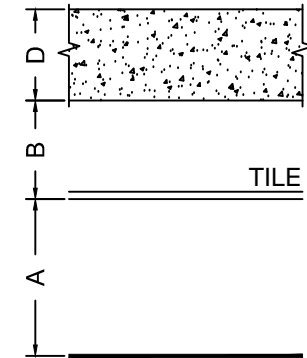

A=105"  
B=78"  
D=6 1/2"

QUANTITY OF ROOMS: 1

LISTING OF ROOM NUMBER(S):  
B-234

VA PALO ALTO

SAFE WORKING LOAD BELOW LIFT: 600LBS [272KG]

MINIMUM STRUCTURE CAPACITY: 750LBS [340KG]

Rev1-usaddsom02	15-NOV-2012
DATE CREATED (DD-MMM-YYYY) :	10-APR-2012

DRAWN BY : usaddsom02	SCALE : 1/4" = 1'
REFERENCE # : QC-410123MS	PAGE : 2 / 12

THIS LAYOUT HAS BEEN PREPARED WITH SUPPLIED DATA.  
VERIFICATIONS MUST BE DONE ON SITE.

NOTE: CUTTING OF RAILS ON SITE ONLY

- ALL HARDWARE INCLUDED.  
(ACCORDING TO STRUCTURE)

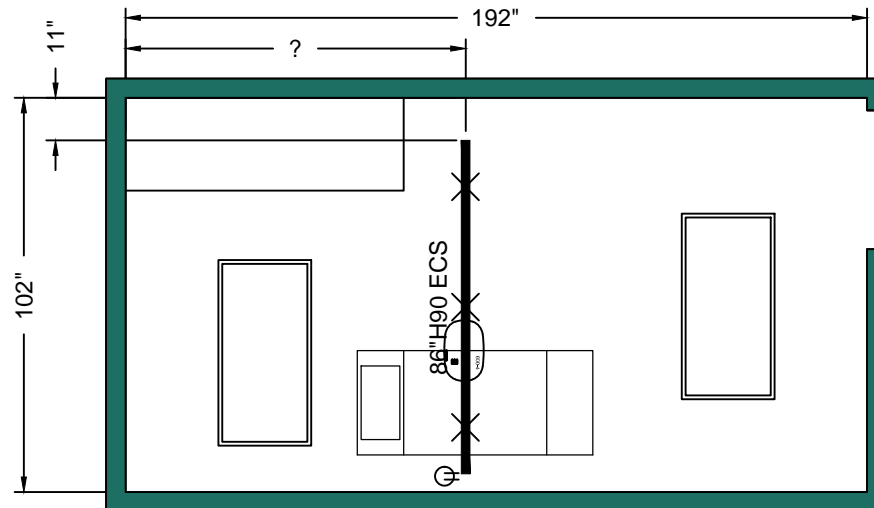

20.7 MPA [3000 PSI] MIN.

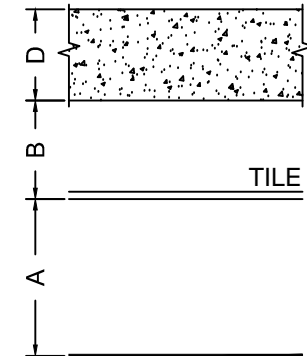

A=105"  
B=78"  
D=6 1/2"

QUANTITY OF ROOMS: **3**

LISTING OF ROOM NUMBER(S):  
B-237,C-256,C-274

**VA PALO ALTO**

SAFE WORKING LOAD BELOW LIFT: 600LBS [272KG]  
MINIMUM STRUCTURE CAPACITY: 750LBS [340KG]

Rev1-usaddsom02	15-NOV-2012
DATE CREATED (DD-MMM-YYYY) :	10-APR-2012

DRAWN BY : usaddsom02	SCALE : 1/4" = 1'
REFERENCE # : QC-410123MS	PAGE : 3 / 12

THIS LAYOUT HAS BEEN PREPARED WITH SUPPLIED DATA.  
VERIFICATIONS MUST BE DONE ON SITE.

NOTE: CUTTING OF RAILS ON SITE ONLY

- ALL HARDWARE INCLUDED.  
(ACCORDING TO STRUCTURE)

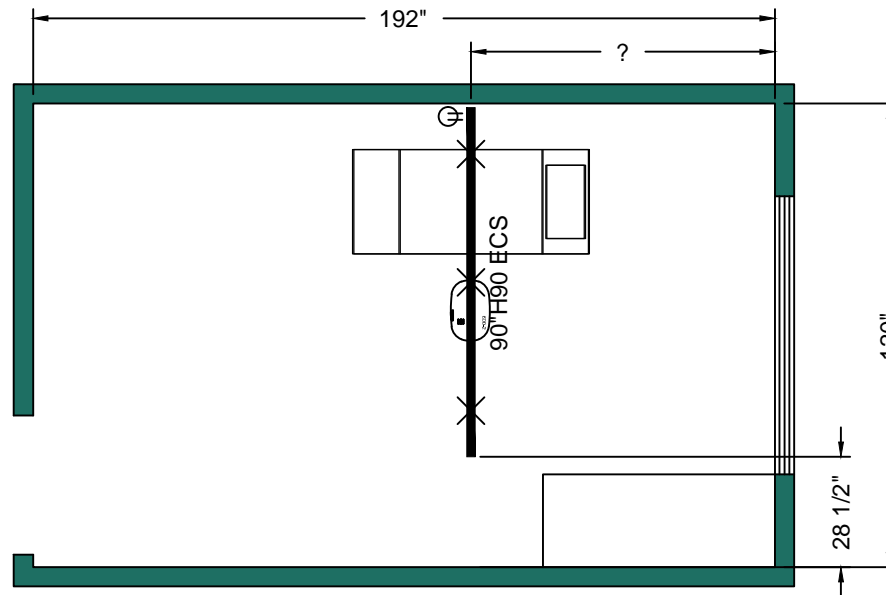

20.7 MPA [3000 PSI] MIN.

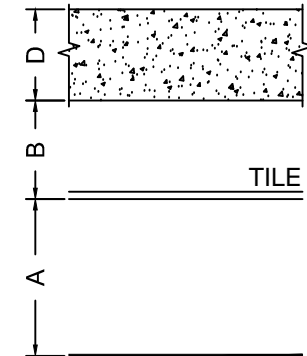

A=105"  
B=78"  
D=6 1/2"

QUANTITY OF ROOMS: 1

LISTING OF ROOM NUMBER(S):  
C-288

VA PALO ALTO

SAFE WORKING LOAD BELOW LIFT: 600LBS [272KG]

MINIMUM STRUCTURE CAPACITY: 750LBS [340KG]

Rev1-usaddsom02	15-NOV-2012
DATE CREATED (DD-MMM-YYYY) :	10-APR-2012

DRAWN BY : usaddsom02 SCALE : 1/4" = 1'

REFERENCE # : QC-410123MS PAGE : 4 / 12

THIS LAYOUT HAS BEEN PREPARED WITH SUPPLIED DATA.  
VERIFICATIONS MUST BE DONE ON SITE.

NOTE: CUTTING OF RAILS ON SITE ONLY

- ALL HARDWARE INCLUDED.  
(ACCORDING TO STRUCTURE)

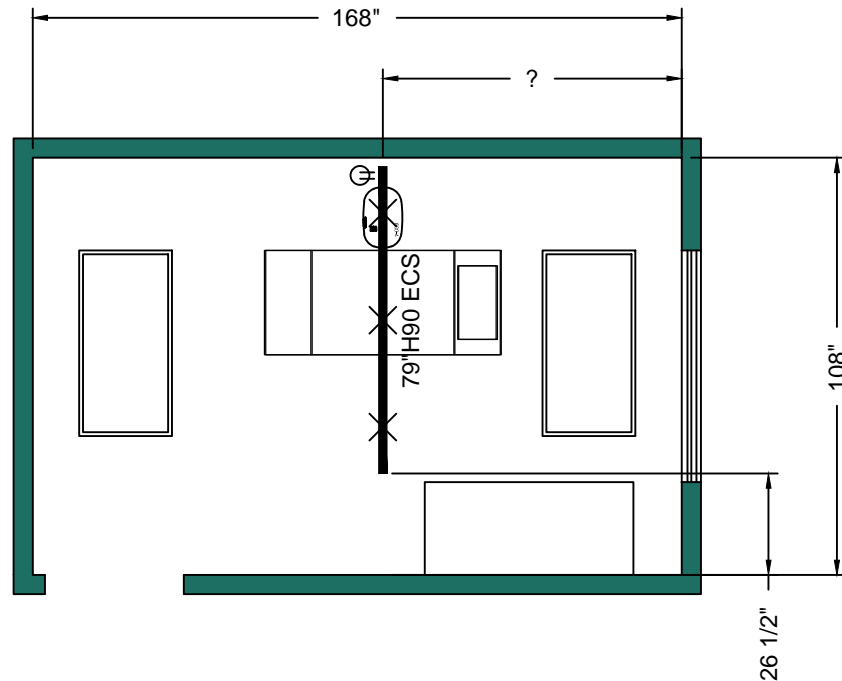

20.7 MPA [3000 PSI] MIN.

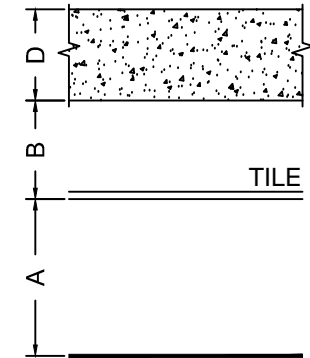

A=105"  
B=78"  
D=6 1/2"

QUANTITY OF ROOMS: 1

LISTING OF ROOM NUMBER(S):  
A-247G

VA PALO ALTO

SAFE WORKING LOAD BELOW LIFT: 600LBS [272KG]

MINIMUM STRUCTURE CAPACITY: 750LBS [340KG]

Rev1-usaddsom02	15-NOV-2012
DATE CREATED (DD-MMM-YYYY) :	10-APR-2012

DRAWN BY : usaddsom02 SCALE : 1/4" = 1'

REFERENCE # : QC-410123MS PAGE : 5 / 12

THIS LAYOUT HAS BEEN PREPARED WITH SUPPLIED DATA.  
VERIFICATIONS MUST BE DONE ON SITE.

NOTE: CUTTING OF RAILS ON SITE ONLY

- ALL HARDWARE INCLUDED.  
(ACCORDING TO STRUCTURE)

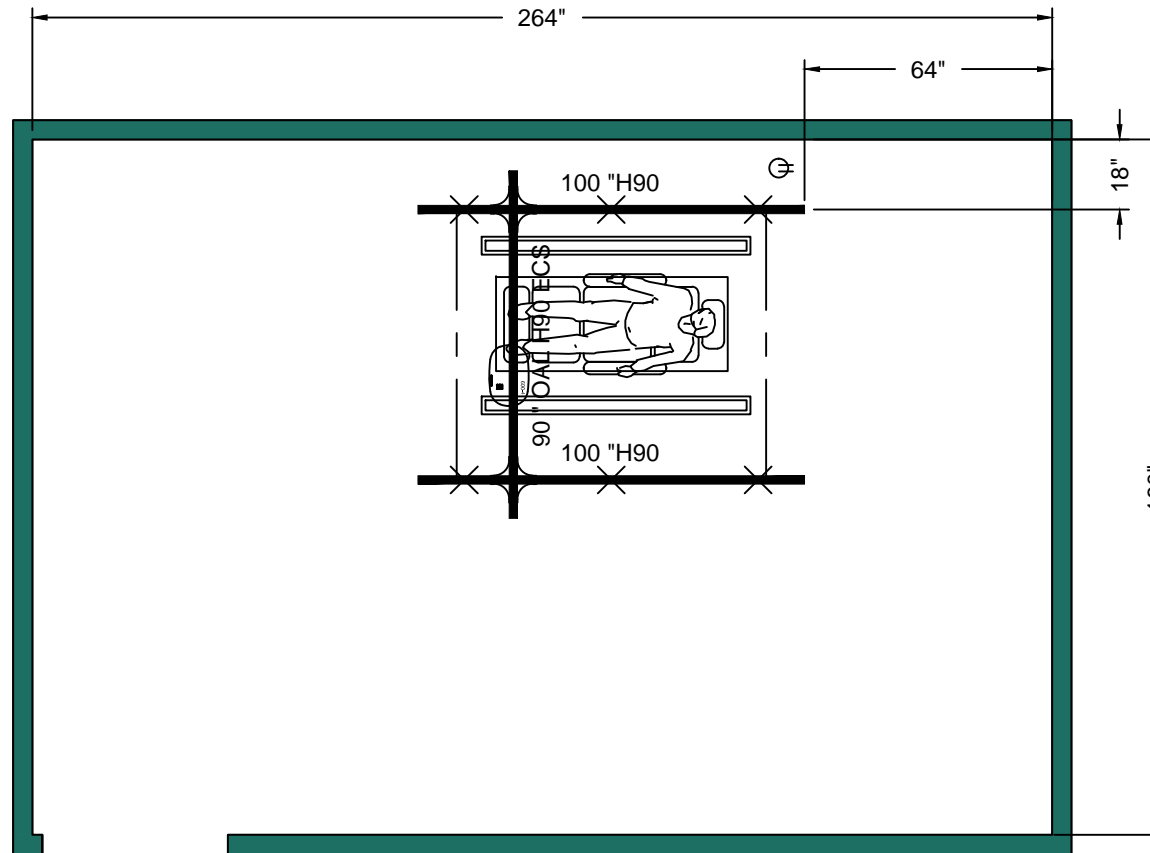

20.7 MPA [3000 PSI] MIN.

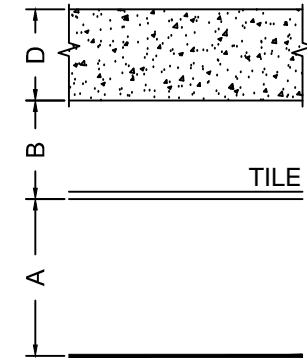

A=108"  
B=72"  
D=6 1/4"

QUANTITY OF ROOMS:	1
LISTING OF ROOM NUMBER(S):	E2-314

VA PALO ALTO

SAFE WORKING LOAD BELOW LIFT: 600LBS [272KG]  
MINIMUM STRUCTURE CAPACITY: 750LBS [340KG]

Rev1-usaddsom02	15-NOV-2012
DATE CREATED (DD-MMM-YYYY) :	10-APR-2012

DRAWN BY :	SCALE :
usaddsom02	1/4" = 1'
REFERENCE # :	PAGE :
QC-410123MS	6 / 12

THIS LAYOUT HAS BEEN PREPARED WITH SUPPLIED DATA.  
VERIFICATIONS MUST BE DONE ON SITE.

NOTE: CUTTING OF RAILS ON SITE ONLY

- ALL HARDWARE INCLUDED.  
(ACCORDING TO STRUCTURE)

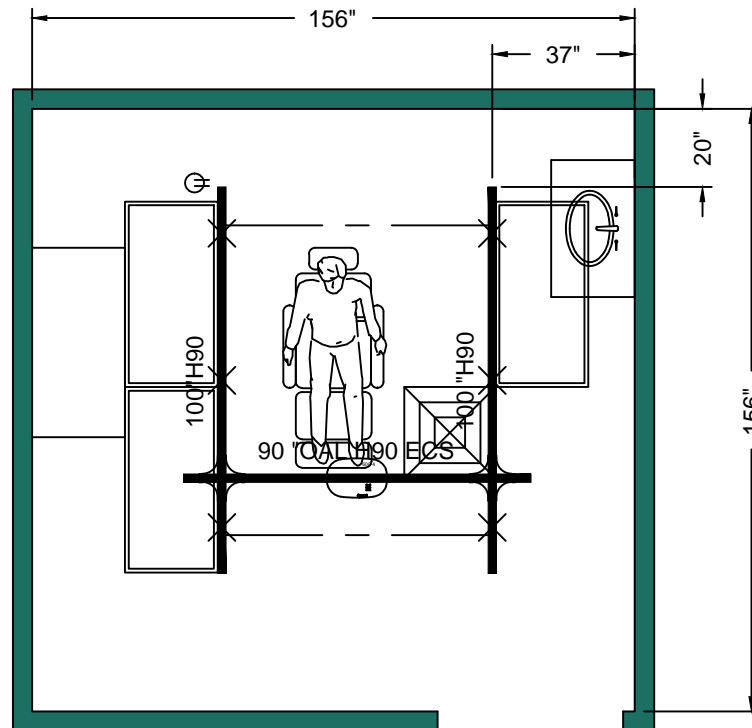

20.7 MPA [3000 PSI] MIN.

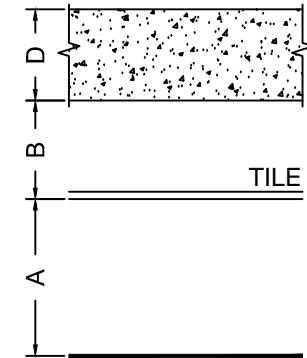

A=108"  
B=72"  
D=6 1/4"

QUANTITY OF ROOMS: 1

LISTING OF ROOM NUMBER(S):  
E2-319

VA PALO ALTO

SAFE WORKING LOAD BELOW LIFT: 600LBS [272KG]

MINIMUM STRUCTURE CAPACITY: 750LBS [340KG]

Rev1-usaddsom02	15-NOV-2012
DATE CREATED (DD-MMM-YYYY) :	10-APR-2012

DRAWN BY :	SCALE :
usaddsom02	1/4" = 1'
REFERENCE # :	PAGE :
QC-410123MS	7 / 12

THIS LAYOUT HAS BEEN PREPARED WITH SUPPLIED DATA.  
VERIFICATIONS MUST BE DONE ON SITE.

NOTE: CUTTING OF RAILS ON SITE ONLY

- ALL HARDWARE INCLUDED.  
(ACCORDING TO STRUCTURE)

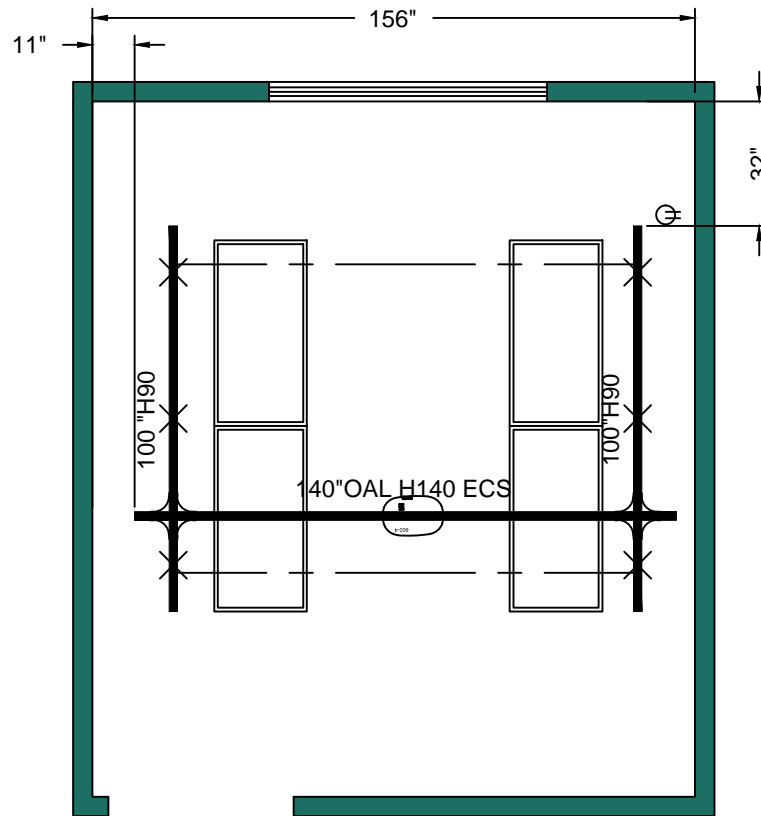

20.7 MPA [3000 PSI] MIN.

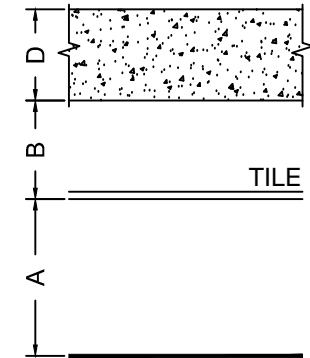

A=108"  
B=72"  
D=6 1/4"

QUANTITY OF ROOMS: 1

LISTING OF ROOM NUMBER(S):  
325E

VA PALO ALTO

SAFE WORKING LOAD BELOW LIFT: 600LBS [272KG]

MINIMUM STRUCTURE CAPACITY: 750LBS [340KG]

Rev1-usaddsom02	15-NOV-2012
DATE CREATED (DD-MMM-YYYY) :	10-APR-2012

DRAWN BY : usaddsom02	SCALE : 1/4" = 1'
REFERENCE # : QC-410123MS	PAGE : 8 / 12

THIS LAYOUT HAS BEEN PREPARED WITH SUPPLIED DATA.  
VERIFICATIONS MUST BE DONE ON SITE.

NOTE: CUTTING OF RAILS ON SITE ONLY



- ALL HARDWARE INCLUDED.  
(ACCORDING TO STRUCTURE)

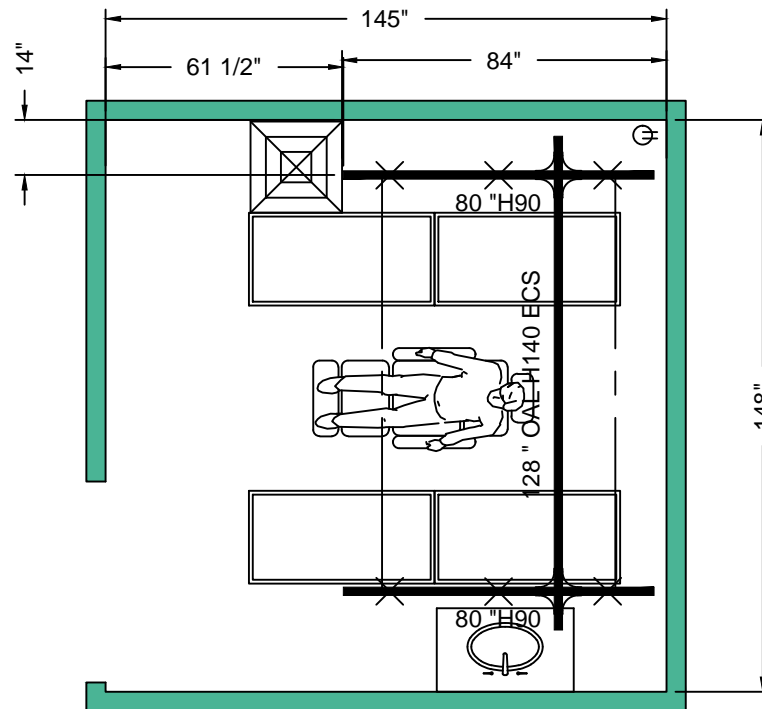

20.7 MPA [3000 PSI] MIN.

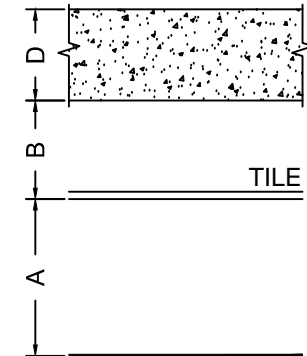

A=108"  
B=76"  
D=6 1/4"

NOTE: MOUNT TRAVERSING TRACK TO ONE SIDE OF BOTH EXAM LIGHTS; THE SIDE CLOSEST TO THE WINDOW.

QUANTITY OF ROOMS: 1

LISTING OF ROOM NUMBER(S):  
E2-323 BLDG 100

VA PALO ALTO

SAFE WORKING LOAD BELOW LIFT: 600LBS [272KG]

MINIMUM STRUCTURE CAPACITY: 750LBS [340KG]

Rev1-usaddsom02	15-NOV-2012
DATE CREATED (DD-MMM-YYYY) :	10-APR-2012

DRAWN BY :	SCALE :
usaddsom02	1/4" = 1'
REFERENCE # :	PAGE :
QC-410123MS	9 / 12

THIS LAYOUT HAS BEEN PREPARED WITH SUPPLIED DATA.  
VERIFICATIONS MUST BE DONE ON SITE.

NOTE: CUTTING OF RAILS ON SITE ONLY

- ALL HARDWARE INCLUDED.  
(ACCORDING TO STRUCTURE)

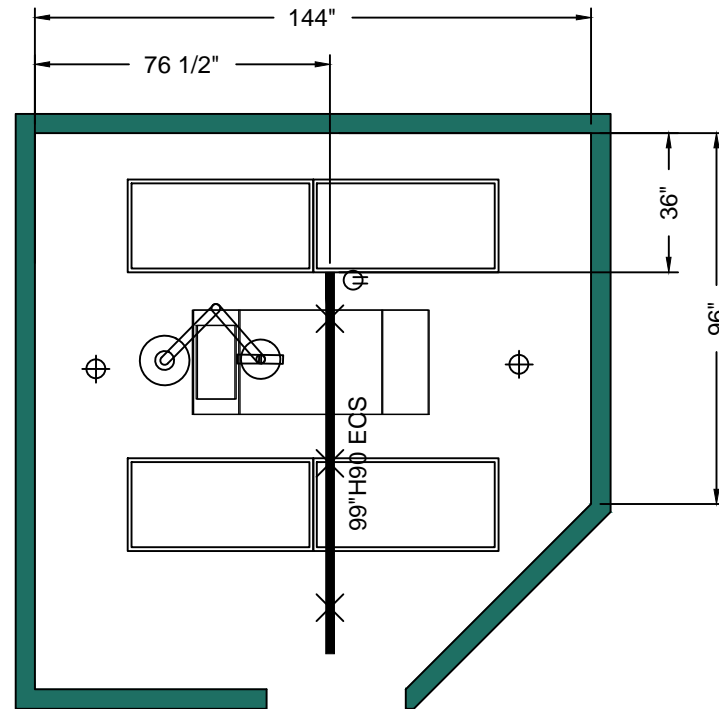

20.7 MPA [3000 PSI] MIN.

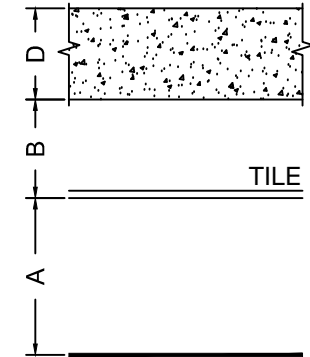

A=91"  
B=78"  
D=6 1/4"

QUANTITY OF ROOMS: 1

LISTING OF ROOM NUMBER(S):  
D1-238

VA PALO ALTO

SAFE WORKING LOAD BELOW LIFT: 600LBS [272KG]

MINIMUM STRUCTURE CAPACITY: 750LBS [340KG]

Rev1-usaddsom02	15-NOV-2012
DATE CREATED (DD-MMM-YYYY) :	10-APR-2012

DRAWN BY : usaddsom02 SCALE : 1/4" = 1'

REFERENCE # : QC-410123MS PAGE : 10 / 12

THIS LAYOUT HAS BEEN PREPARED WITH SUPPLIED DATA.  
VERIFICATIONS MUST BE DONE ON SITE.

NOTE: CUTTING OF RAILS ON SITE ONLY

CONCRETE SLAB

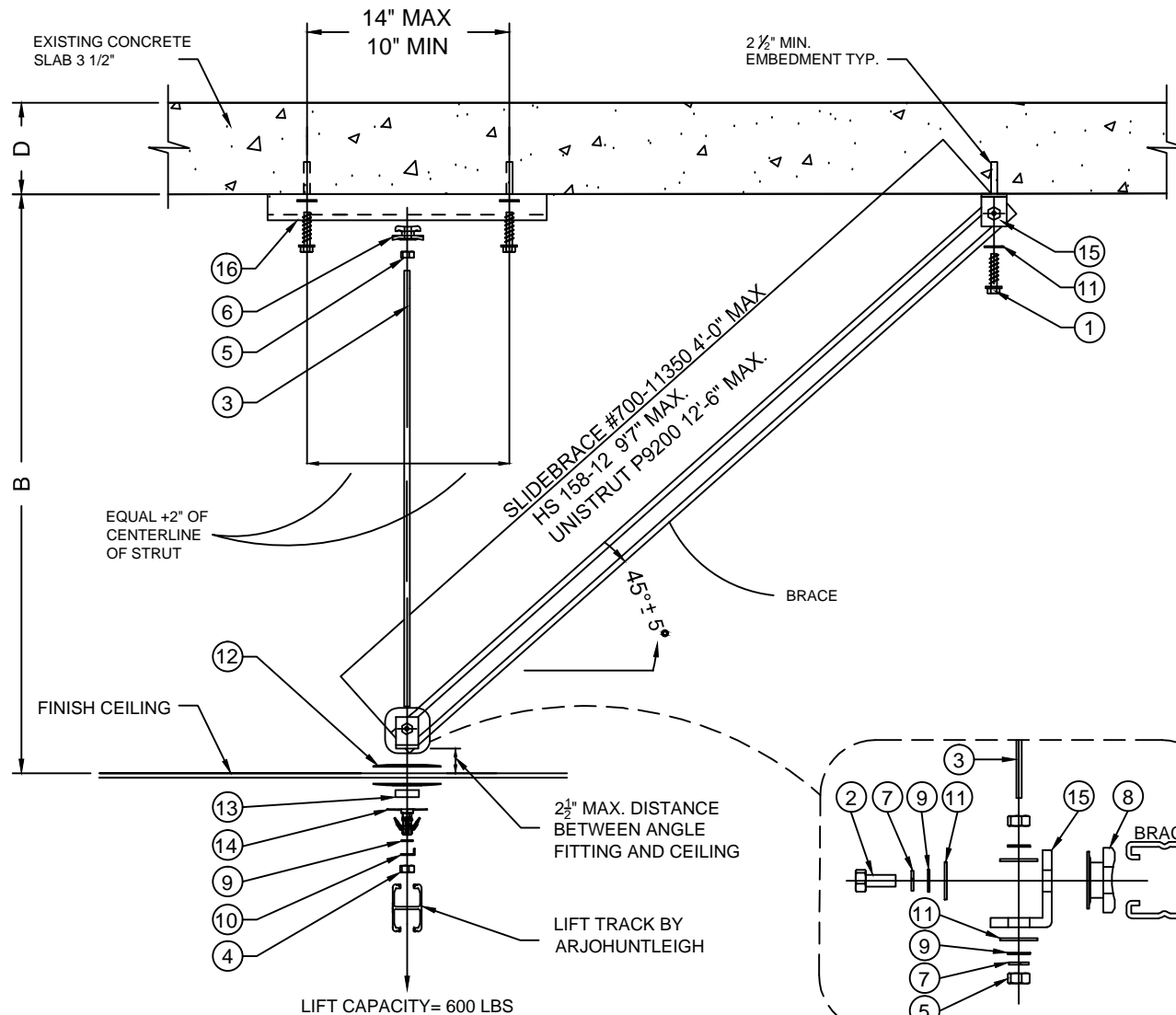

- ALL HARDWARE INCLUDED.  
(ACCORDING TO STRUCTURE)

Item #	Part #	Description	Qty
1	418058	HILTI KHEZ 3/8 X 3 1/2	3
2	000.00357	BOLT 3/8" - 16 X 1"	2
3	000.00394	THREADED ROD 3/8-16 X 10" ZINC	1
4	000.00402	LOCKNUT STOVER 3/8-16 ZINC	1
5	000.00405	NUT 3/8-16 ZINC	3
6	000.00424	HILTI STRUT SADDLE NUT 3/8-16	1
7	000.00425	LOCKWASHER 3/8"	3
8	000.00426	HILTI CHANNEL NUT 3/8-16	2
9	000.00430	FLAT WASHER M10 ZINC	5
10	000.00435	TAB WASHER M10	1
11	000.004875	FLAT WASHER M12	7
12	200.11140	CEILING PLATE ø100MM	2
13	200.11170	BRACKET SHIM 12mm	1
14	700.11100	TRACK BRACKET KWIKTRAK	1
15	P1068	UNISTRUT ANGLE	2
16	311492	1-5/8 x 10" SLOTTED CHANNEL	20"

QUANTITY OF ROOMS:	0
--------------------	---

**NOTE:**  
THE STRUCTURAL ENGINEER ON RECORD  
OF THE BUILDING IS RESPONSIBLE TO  
VERIFY THE ADEQUACY OF THE  
STRUCTURE TO SUPPORT THE LOAD.

VA PALO ALTO

SAFE WORKING LOAD BELOW LIFT: 600LBS [272KG]  
MINIMUM STRUCTURE CAPACITY: 750LBS [340KG]

"NOTE: ARJOHUNTLEIGH GUARANTEES THE STRUCTURAL INTEGRITY OF THE TOTAL LIFT SYSTEM DESIGN, INCLUDING TRACK BRACING, HANGERS, AND ALL CONNECTIONS TO THE BUILDING STRUCTURE. OUR DESIGN IS BASED ON THE REQUIREMENTS OF THE CURRENT INTERNATIONAL BUILDING CODE (IBC) AND THE SEISMIC LOADS OF THE REGION. THE FACILITY MUST VERIFY THE ADEQUACY OF THE BUILDING STRUCTURE TO SUPPORT THE LOADS IMPOSED BY THE LIFT SYSTEM."

Rev1-usaddsom02	15-NOV-2012
DATE CREATED (DD-MMM-YYYY) : 10-APR-2012	
DRAWN BY : usaddsom02	SCALE : N/A
REFERENCE # : QC-410123MS	PAGE : 11 / 12

# LATERAL BRACE REQUIREMENTS REV-3

- ALL HARDWARE INCLUDED.  
(ACCORDING TO STRUCTURE)

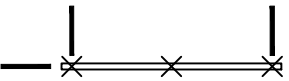

1 TRACK SECTION  
0 TRACK BRACKET JOINT  
3 LATERAL BRACES

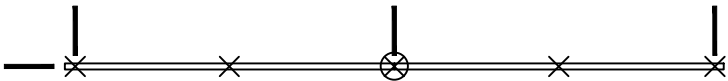

2 TRACKS SECTION  
1 TRACK BRACKET JOINT  
4 LATERAL BRACES

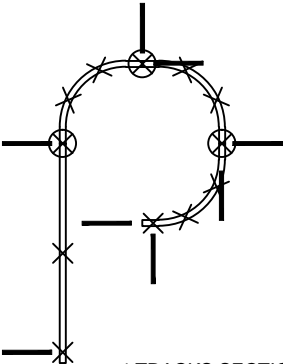

4 TRACKS SECTION  
3 TRACK BRACKETS JOINT  
9 LATERAL BRACES

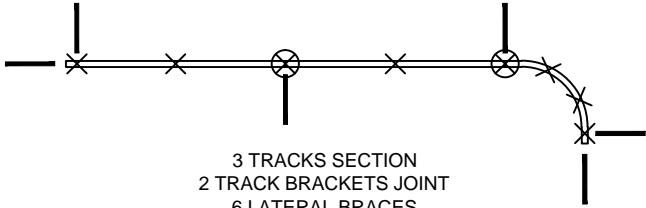

3 TRACKS SECTION  
2 TRACK BRACKETS JOINT  
6 LATERAL BRACES

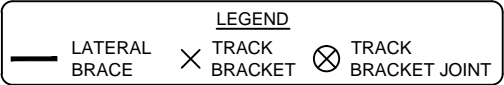

- MINIMUM 3 LATERAL BRACES.
- NUMBER OF LATERAL BRACE = (NUMBER OF TRACK BRACKET JOINT X 2) + 2.

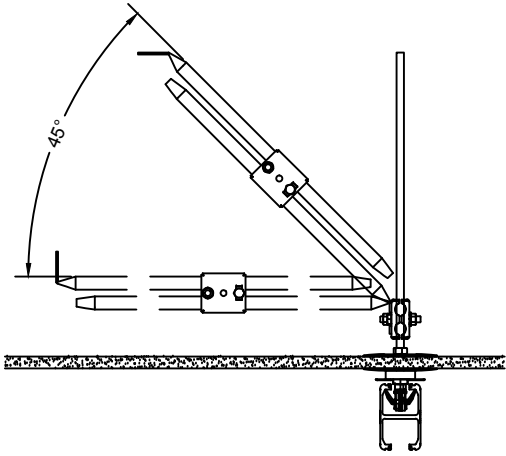

ACCEPTABLE ANGLE

## POSSIBLE ANCHOR LATERAL TO THE CEILING OR TO THE WALL

### WOOD JOIST

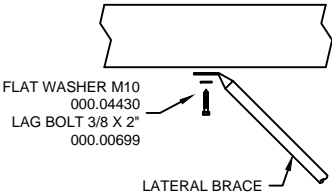

### STEEL

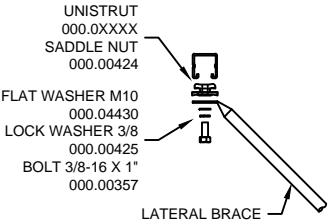

### CONCRETE

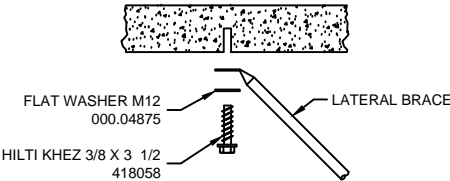

### HOLLOW CORE

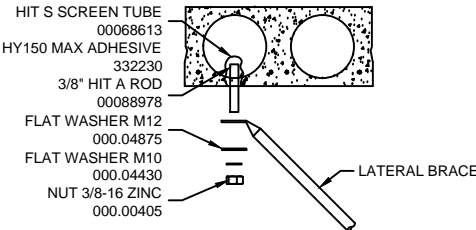

QUANTITY OF ROOMS: 0

**NOTE:**  
THE STRUCTURAL ENGINEER ON RECORD  
OF THE BUILDING IS RESPONSIBEL TO  
VERIFY THE ADEQUACY OF THE  
STRUCTURE TO SUPPORT THE LOAD.

VA PALO ALTO

SAFE WORKING LOAD BELOW LIFT: 600LBS [272KG]  
MINIMUM STRUCTURE CAPACITY: 750LBS [340KG]

Rev1-usaddsom02	15-NOV-2012
DATE CREATED (DD-MMM-YYYY) :	10-APR-2012
DRAWN BY : usaddsom02	SCALE : N/A
REFERENCE # : QC-410123MS	PAGE : 12 / 12