

1  
2  
3  
4  
5  
6  
7  
8  
9

A  
three inches = one foot

B  
one and one-half inches = one foot

C  
one inch = one foot

D  
three-quarters inch = one foot

E  
one-half inch = one foot

F  
three-eighths inch = one foot

G  
one-quarter inch = one foot

H  
one-eighth inch = one foot

**DRAWING NOTES:**  
A. NO WORK REQUIRED THIS AREA. SHEET INCLUDED FOR COMPLETENESS OF RECORD DRAWINGS.

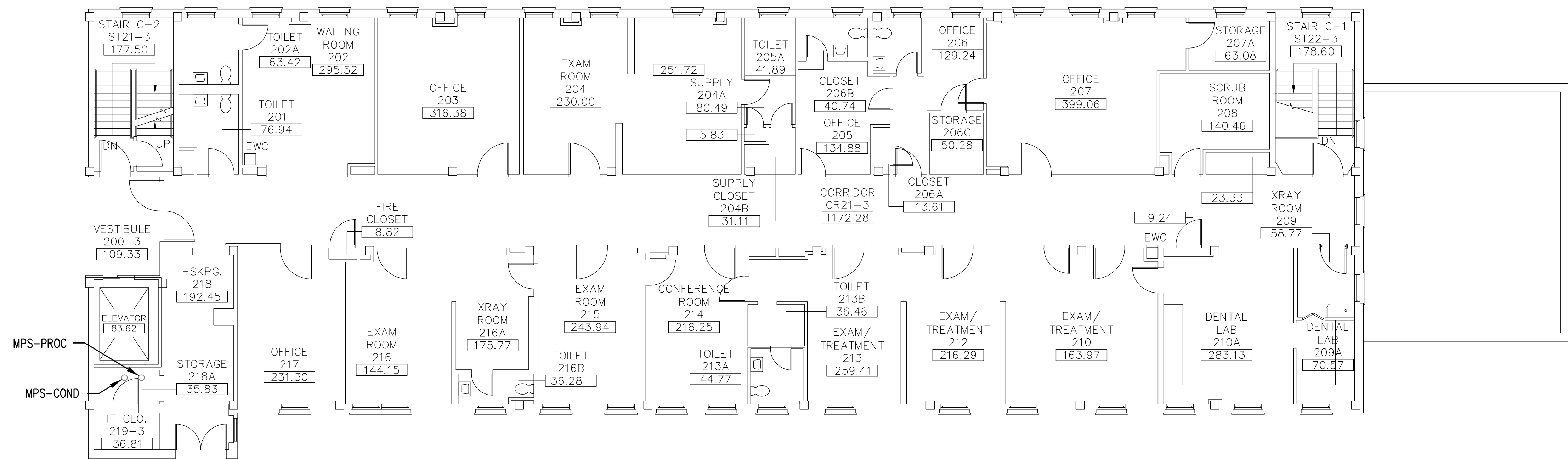

**BUILDING 3  
SECOND FLOOR PLAN**  
SCALE: 1/8" = 1'-0"

Revisions	Date

**AES**  
APPLIED ENGINEERING  
SOLUTIONS  
440 Martin Luther King, Jr. Blvd., Suite 401  
Macon, Georgia 31201  
(478) 314-1270  
www.aes-pe.com

**KEY PLAN**  
SCALE: NONE

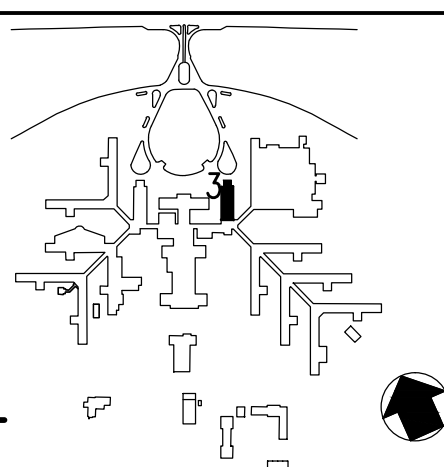

Drawing Title <b>SECOND FLOOR PLAN</b>		Project Title <b>STEAM AND CONDENSATE PIPING SYSTEM STUDY</b>		Date JUNE 22, 2012
Building Number <b>3</b>		Checked <b>PJC</b>	Drawn <b>JSW</b>	Project No. 557-10-109
FINAL SUBMITTAL		Location CARL VINSON VA MEDICAL CENTER DUBLIN, GEORGIA		Drawing No. <b>03-G-201</b> Dwg. 22 Of 87

**Veterans  
Administration**