

PBPu LEGEND

- 0 OXYGEN OUTLET
- A AIR OUTLET
- V VACUUM OUTLET
- E2 HOSPITAL GRADE DUPLEX RECEPTACLE NEMA 5-20R, NORMAL POWER, IVORY BODY
- E3 HOSPITAL GRADE DUPLEX RECEPTACLE NEMA 5-20R, EMERGENCY POWER, (CRITICAL BRANCH), RED BODY
- E6 GROUNDING RECEPTACLE, GREEN BODY
- S LOW VOLTAGE SWITCH (DIMMER) FOR LIGHT BOXES
- NC/CB NURSE CALL PATIENT STATION
- NCI NURSE CALL STRIKER BED COMMUNICATION INTERFACE OUTLET, 2-GANG BOX, (1)-GANG PLATE.
- FP FUTURE PROVISION
- PM PATIENT MONITOR - WALL MOUNT
- TL DATA/TELEPHONE OUTLET PROVISION - (4) JACKS
- CBP CIRCUIT BREAKER LOADCENTER, PROVIDED WITH PBPu. SQUARE D Q0116L25G SERIES 80A, 120V, 1PH, 2W+G, WITH (16)-Q08-VH PLUG-IN CIRCUIT BREAKERS.
- ETI ELAPSED TIME INDICATOR
- ET ELAPSED TIME INDICATOR CONTROL
- MO MONITOR OUTPUT PROVISION

SHEET NOTES:

- 1. SEVERAL PBPu ARRANGEMENTS ARE SHOWN BECAUSE ROOM LAYOUTS REQUIRE DIFFERENT PBPu DESIGNS. REFER TO ARCHITECTURAL PLANS FOR WHICH PBPu STYLE GOES IN A PARTICULAR ROOM.

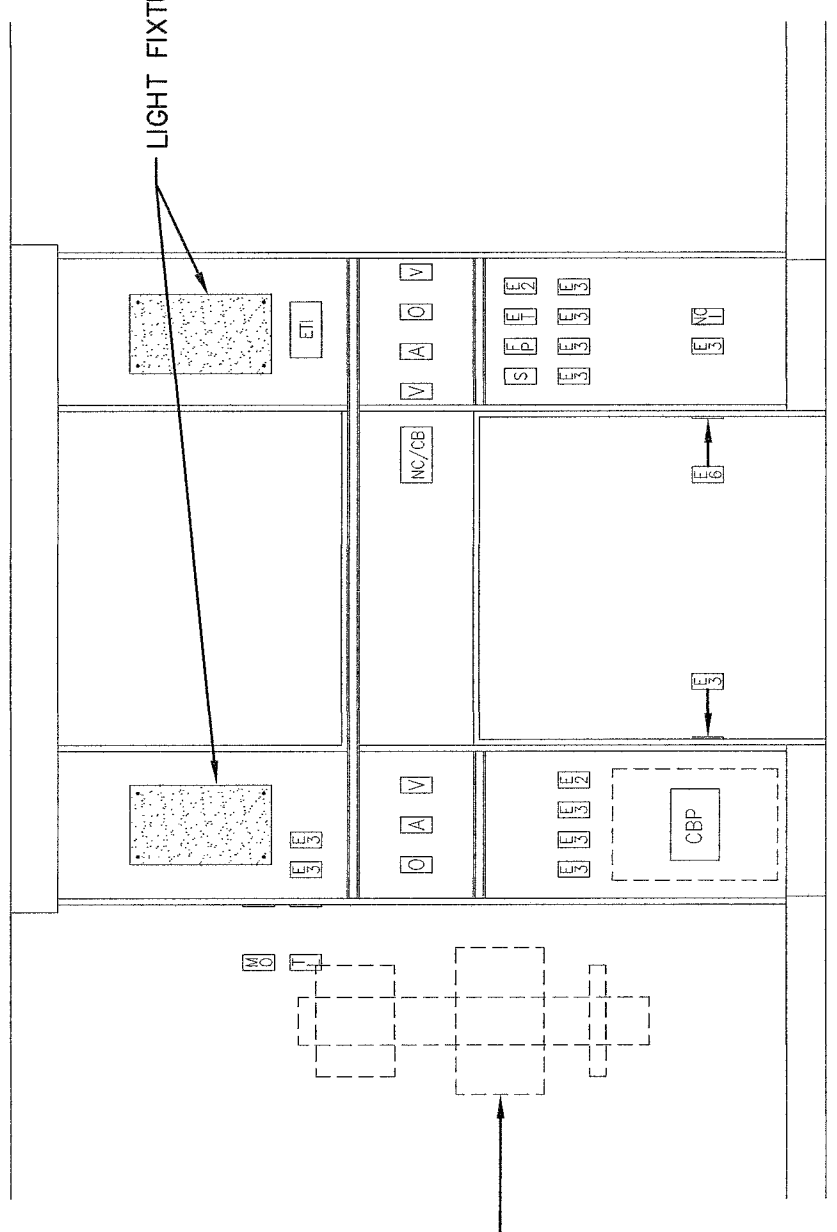

4 NEW PBPu ELEVATION
NO SCALE

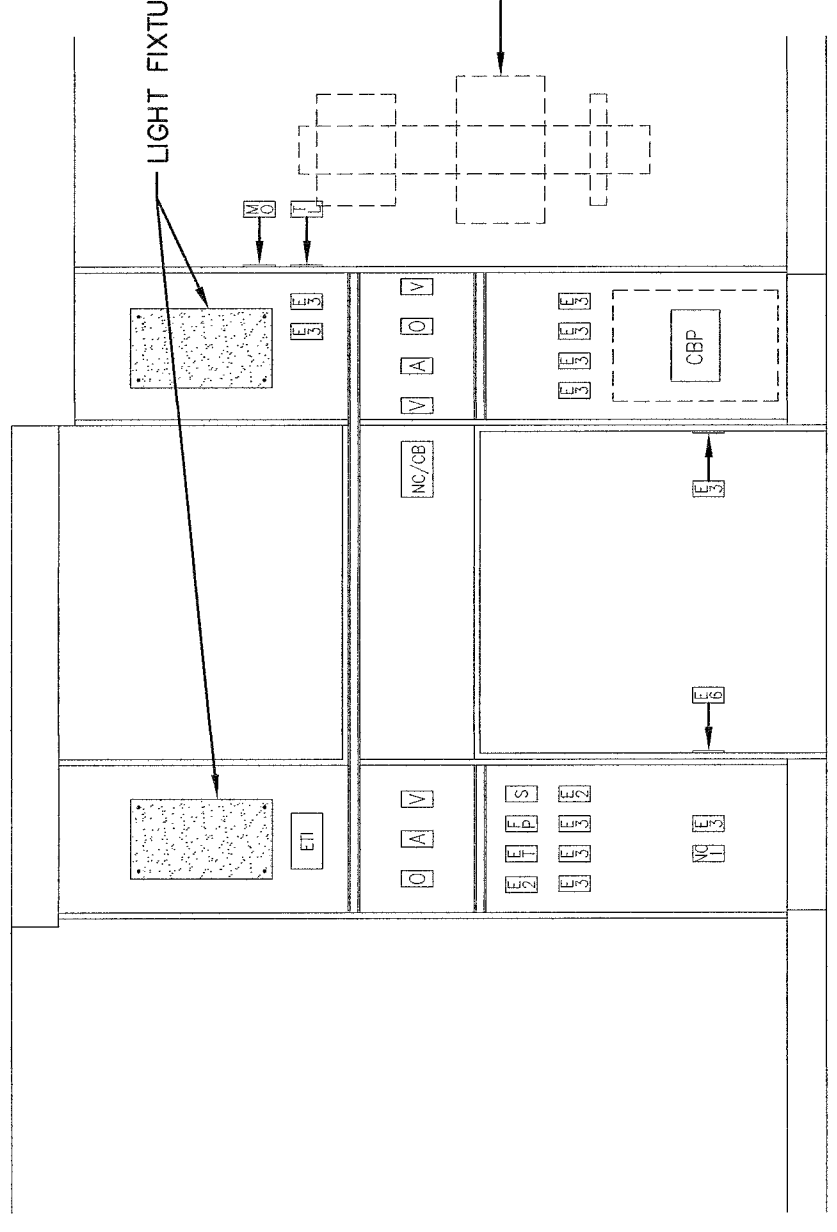

5 NEW PBPu ELEVATION
NO SCALE

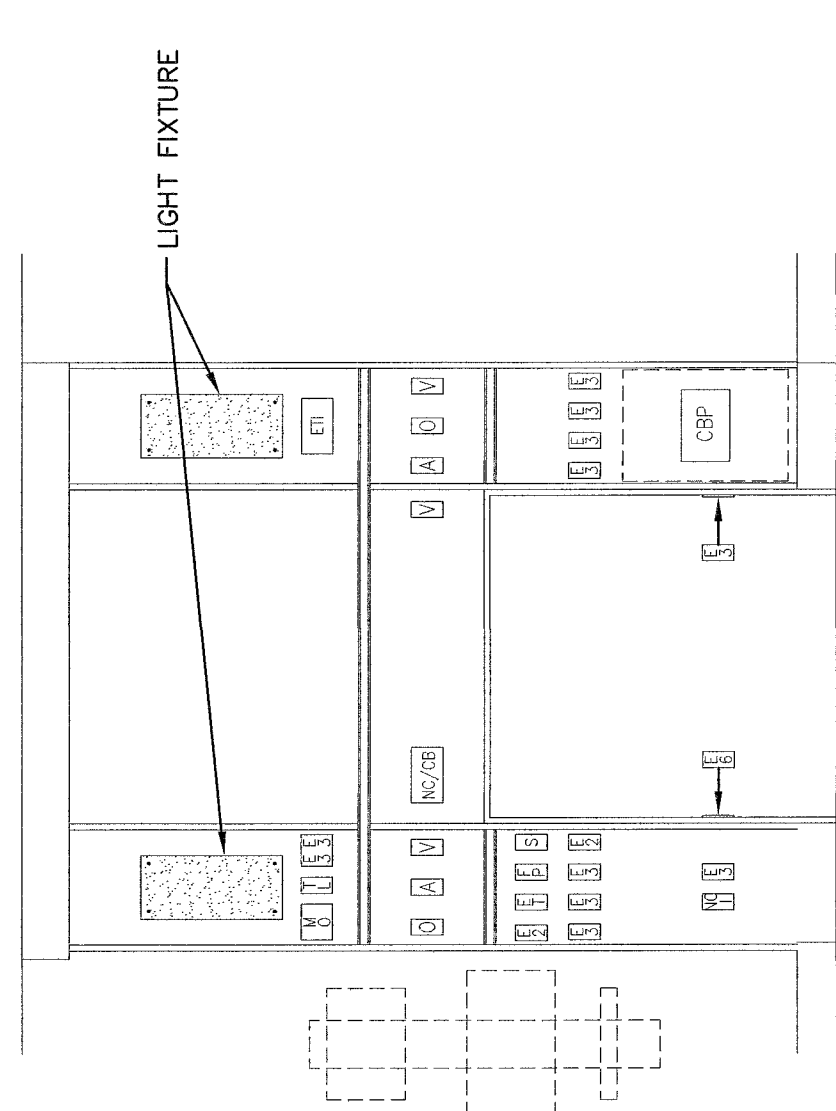

1 NEW PBPu ELEVATION
NO SCALE

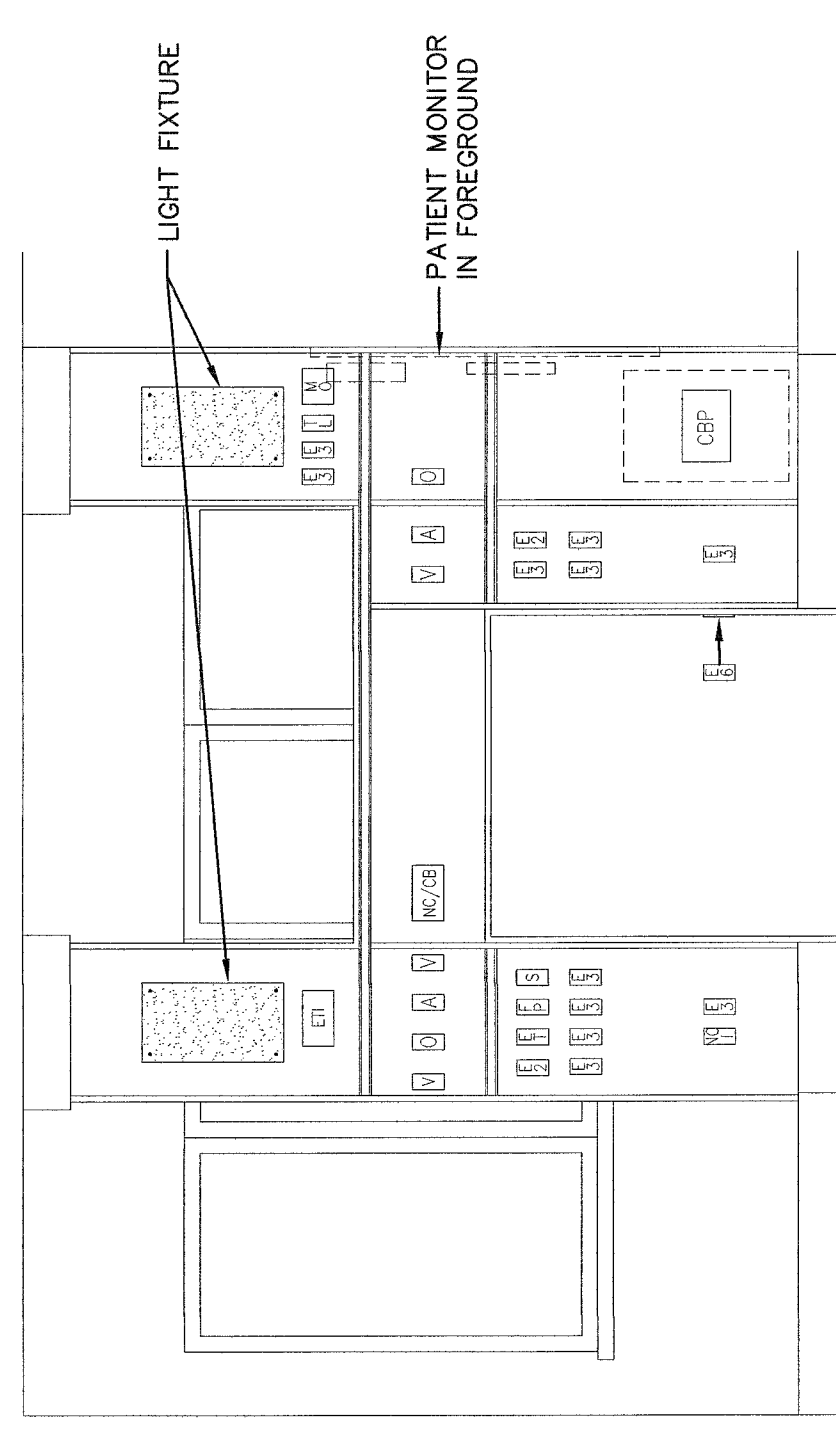

2 NEW PBPu ELEVATION
NO SCALE

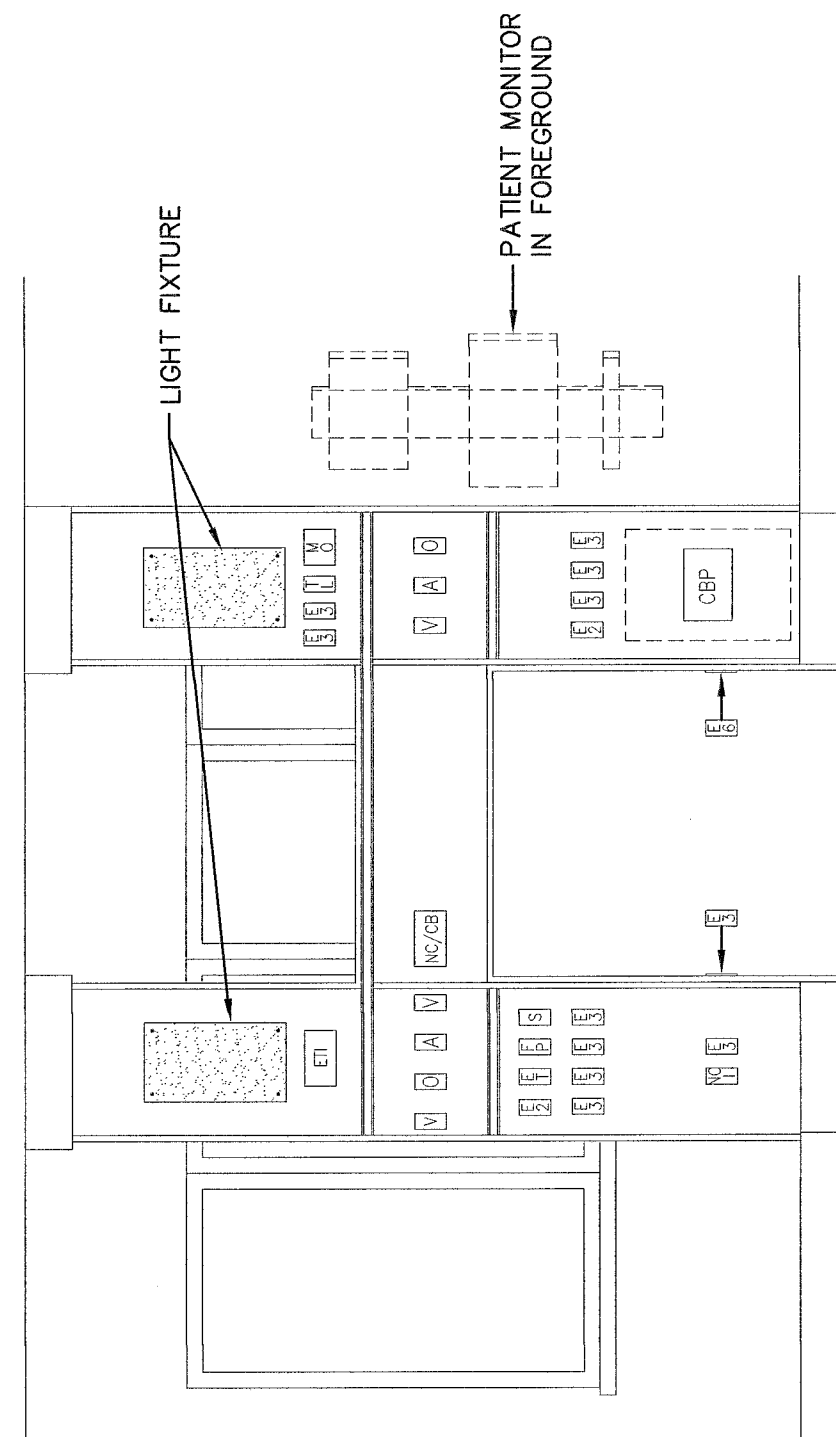

3 NEW PBPu ELEVATION
NO SCALE

6 NEW PBPu TYPICAL SCHEMATIC
NO SCALE

NOTE:
THIS DETAIL IS BASED ON THE PBPu DETAIL #3 ON THIS DRAWING. OTHER PBPu LAYOUTS SHALL BE SIMILAR.

ARCHITECTS/ENGINEERS/CONSULTANTS:

ARCHITECT:
SPUR DESIGN LLC
7700 North Hudson Ave., Suite 9
Oklahoma City, Oklahoma 73116

MEP ENGINEER:
Lee & Browne Consulting Engineers, Inc.
1207 S. Sheridan Road
Tulsa, Oklahoma 74112
OKLA. CH. REG. ELEC. 6115

HEALTHCARE CONSULTANT:
JUNK ARCHITECTS
802 Broadway, 5th Floor
Kansas City, Missouri 64105

PROJECT TITLE
ICU Headwall Relocation
Jack C. Montgomery VA Medical Center

PROJECT NUMBER
623-10-107
BUILDING NUMBER
53

DRAWING NUMBER
E103
30 of 38 Sheets

DATE
5/23/12

CHECKED
DRAWN

PROFESSIONAL ENGINEER
FRANK C. BOGDANSKI
17728
623-10-107
VA MEDICAL CENTER
KANSAS CITY, MISSOURI 64105
WWW.PENNSYLVANIA.COM

SPUR DESIGN
2200 NORTH HURON AVENUE
SUITE 9
OKLAHOMA CITY, OKLAHOMA 73116
WWW.SPURDESIGN.COM

VA FORM 08-6231