

**FIRE PROTECTION SYMBOLS FOR PARTITIONS:**

--- SMOKE BARRIER- 1 HR FIRE RESISTIVE RATING WITH 20 MIN. DOOR

--- 1-HOUR FIRE PARTITION - CLASS 'C' DOORS REQUIRED

**CONSTRUCTION TYPE: TYPE II (222)**

TOTALLY PROTECTED BY AN AUTOMATIC SPRINKLER SYSTEM.

NOTE: 1. NEW ADDITION AND RENOVATED AREAS ARE HEALTHCARE OCCUPANCIES.

2. CORRIDOR WALLS ARE TO BE SEALED TO UNDERSIDE OF DECK TO RESTRICT THE MOVEMENT OF SMOKE PER NFPA 101 (2000) PARA. 18.3.6.2.

**TYPICAL FIRE PROTECTION NOTES**

1. FIRESTOPPING LOCATIONS:

A. DUCT, CABLE, CONDUIT AND PIPING PENETRATIONS THROUGH ABOVE GRADE FLOOR SLABS AND THROUGH TIME-RATED PARTITIONS OR FIRE-WALLS.

B. OPENINGS BETWEEN WALLS AND CEILINGS OF TIME-RATED ASSEMBLIES.

C. PENETRATION OF VERTICAL SERVICE SHAFTS.

D. OPENINGS & PENETRATIONS IN ENCLOSURES WITH TIME-RATED FIRE DOORS.

2. SPRINKLERS SHALL BE QUICK RESPONSE TYPE.

3. ANY OPENING, VOID OR PENETRATION IN EXISTING PARTITIONS THAT ARE RECLASSIFIED AS EITHER A SMOKE OR FIRE BARRIER SHALL BE SEALED TO MAINTAIN RATING.

4. FIREPROOFING:

A. PROVIDE FIREPROOFING IN NEW 1 STORY ADDITION ON ALL STEEL DECK, BEAMS & COLUMNS IN A THICKNESS THAT PROVIDES A 1 HOUR FIRE RATING FOR ALL STRUCTURAL ASSEMBLIES ON FIRST FLOOR AND A 2 HOUR FIRE RATING FOR ALL STRUCTURAL ASSEMBLIES IN PIPE SPACE 57C. EXPOSED BEAMS AND COLUMNS IN THERAPY GYM 104 AND STAFF CHARTING 104J TO BE PAINTED WITH INTUMESCENT M TO PROVIDE A 1 HOUR FIRE RATING. STEEL DECK IN THERAPY GYM 104 AND STAFF CHARTING 104J TO BE COVERED WITH SPRAY FIREPROOFING SYSTEM TO PROVIDE A FIRE RATING. THIS AREA WILL BE EXPOSED, FIREPROOFING TO BE INSTALLED EVEN OVERSPRAY ON ADJACENT SURFACES.

5. RATED ASSEMBLY IDENTIFICATION:

A. GENERAL CONTRACTOR TO PROVIDE 6" HIGH STENCILED LETTERING PAINTED ABOVE CEILING ON ALL FIRE RATED & SMOKE RESTRICTING ASSEMBLIES LOCATED WITHIN THE PROJECT AREA. THIS STENCILED LETTERING SHALL BE IN A BRIGHT DAY GLOW ORANGE COLOR & SHALL BE LOCATED ON BOTH SIDES OF CROSS CORRIDOR DOOR IN CROSS CORRIDOR RATED ASSEMBLIES & SHALL BE PLACED ALONG BOTH SIDES OF THE RATED ASSEMBLY WALLS AT SPACING INTERVALS OF 12'-0", FOR WALLS SHORTER THAN 12'-0", PLACE ONE RATING STENCIL IN THE MIDDLE OF THE RATED WALL ASSEMBLY.

**RECORD DRAWING**  
12-1-10

THIS DRAWING IS THE PROPERTY OF BURKAVAGE DESIGN ASSOCIATES, LLC. IT IS TO BE USED ONLY FOR THE PROJECT AND SITE SPECIFICALLY IDENTIFIED HEREON. IT IS NOT TO BE REPRODUCED, COPIED, OR TRANSMITTED IN ANY FORM OR BY ANY MEANS, ELECTRONIC OR MECHANICAL, INCLUDING PHOTOCOPYING, RECORDING, OR BY ANY INFORMATION STORAGE AND RETRIEVAL SYSTEM, WITHOUT THE WRITTEN PERMISSION OF BURKAVAGE DESIGN ASSOCIATES, LLC. ANY VIOLATION OF THIS NOTICE SHALL BE SUBJECT TO LEGAL ACTION.

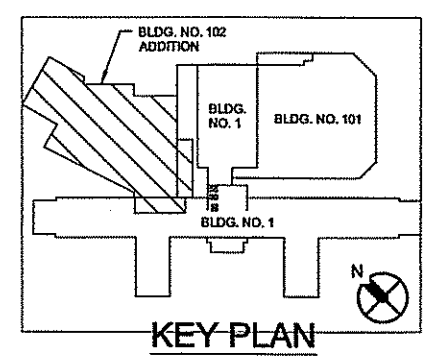

**FIRST FLOOR LIFE SAFETY PLAN**  
1/8" = 1'-0"

<b>REVISIONS</b>		<b>BURKAVAGE DESIGN ASSOCIATES, LLC</b>		<b>FIRST FLOOR LIFE SAFETY PLAN</b>		<b>CONSOLIDATE REHAB SERVICES</b>		<b>Department of Veterans Affairs</b>	
1. ADDENDUM 1		ARCHITECTURE ENGINEERING INTERIOR DESIGN		APPROVED: Anna Project Manager		Building Number 102		MAR. 31, 2009	
SYN. 1		200 ABBINGTON EXECUTIVE PARK CLARKS SUMMIT, PA 18411-2250		GENERAL EMAIL: email@burkavagedesign.com		Checked LABORANT		Project No. 595-CSI-001	
DESCRIPTION DATE BY		WEBSITE: www.burkavagedesign.com		Drawing Title		Drawn TOYE		Drawing No. 102-A22	
REVISED 4.22.09 T.J.L.		FAX: (570) 556-6549		Project No.		Location LEBANON, PENNSYLVANIA		Dwg 33 of 73	