

ATTACHMENT - B1 (PAGE 1)

SMOKE COMPARTMENT
AREA = ~10,180 SQFT



SMOKE COMPARTMENT
AREA = ~10,630 SQFT

B-203 - GA

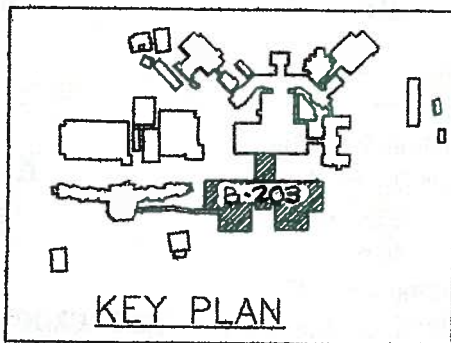

LEGEND

	1HR FRR CONSTRUCTION		NON-PATIENT SUITE
	2HR FRR CONSTRUCTION		NON-SLEEPING SUITE
	SMOKE BARRIER		SLEEPING SUITE
	HAZARDOUS AREA SMOKE RESISTIVE CONST.		

ATTACHMENT-B1 (PAGE 2)

← ROOM 825
FLOOR 8
GA-28







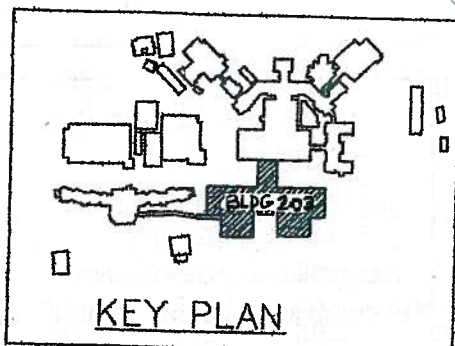

SMOKE COMPARTMENT
AREA = ~11,022 SQFT



SMOKE COMPARTMENT
AREA = ~9,833 SQFT



LEGEND

	1HR FRR CONSTRUCTION		NON-PATIENT SUITE
	2HR FRR CONSTRUCTION		NON-SLEEPING SUITE
	SMOKE BARRIER		SLEEPING SUITE
	HAZARDOUS AREA SMOKE RESISTIVE CONST.		





SMOKE AREA =

WORK AREA

SMOKE COMPARTMENT
AREA = ~10,979 SQFT

B-203
1B

LEGEND

	1HR FRR CONSTRUCTION		NON-PATIENT SUITE
	2HR FRR CONSTRUCTION		NON-SLEEPING SUITE
	SMOKE BARRIER		SLEEPING SUITE
	HAZARDOUS AREA SMOKE RESISTIVE CONST.		

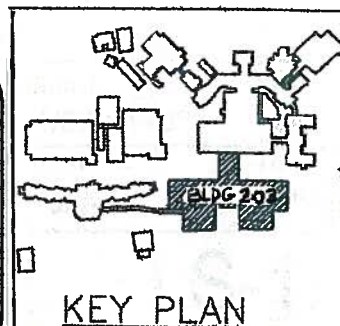

SMOKE DETECTOR



INFUSION RECEPTION
1B-42
B-203

ALL CALL PRODUCTS
MAY BE USED IN
THE HALL AREA.
Thank you

