

1
2
3
4
5
6
7
8

A
B
C
D
E

one-eighth inch = one foot
one-quarter inch = one foot
one-half inch = one foot
three-quarters inch = one foot
one inch = one foot

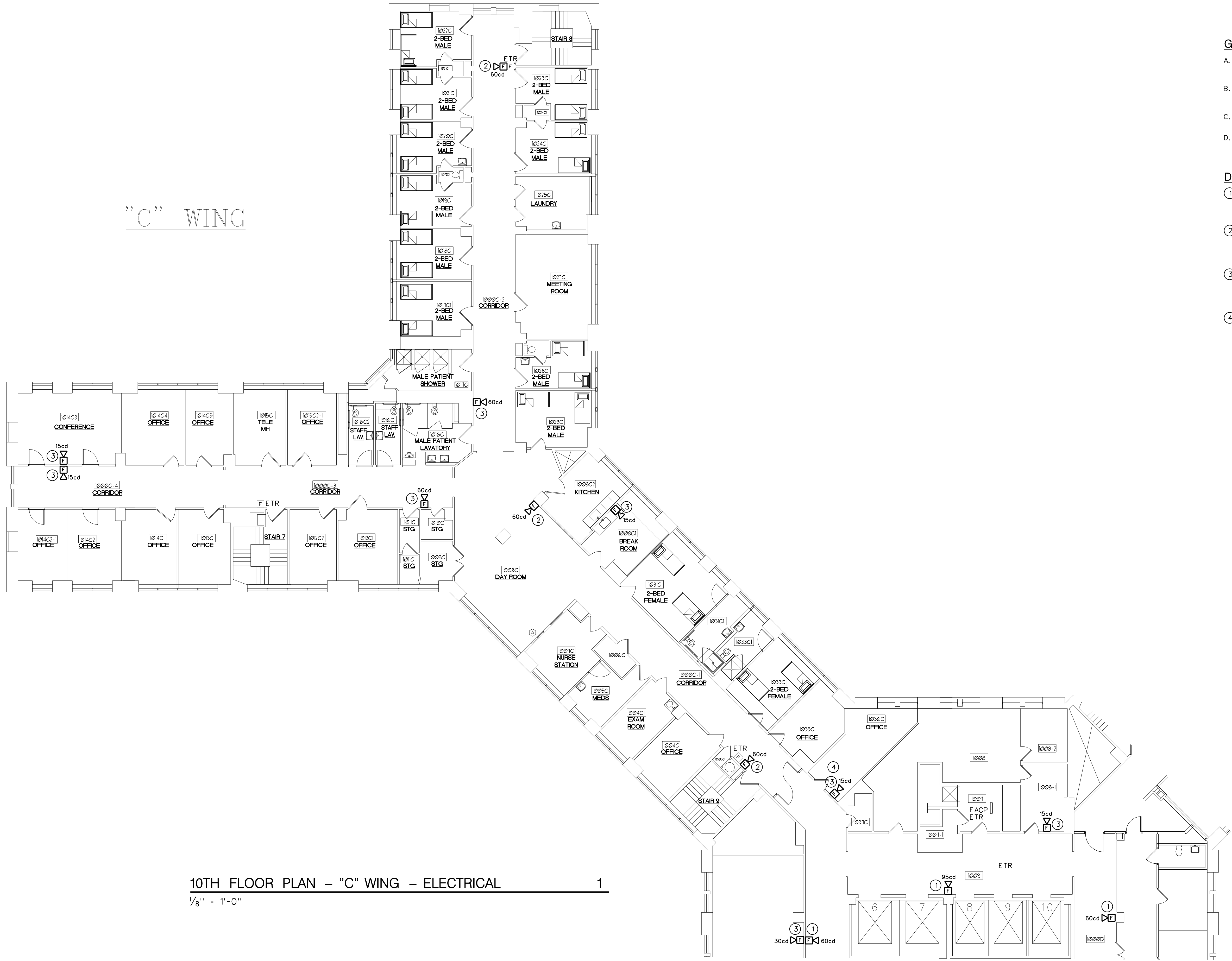

10TH FLOOR PLAN – "C" WING – ELECTRICAL 1
1/8" = 1'-0"

- GENERAL NOTES:**
- A. "ETR" ADJACENT TO A DEVICE, FIXTURE, OR PIECE OF EQUIPMENT INDICATES ITEM SHALL REMAIN. MAINTAIN EXISTING ELECTRICAL CONNECTIONS UNLESS OTHERWISE NOTED.
 - B. "ERL" ADJACENT TO A DEVICE, FIXTURE, OR PIECE OF EQUIPMENT INDICATES EXISTING ITEM SHALL BE RELOCATED, DISCONNECT AND REMOVE, REINSTALL AT NEW LOCATION AND RECONNECT ITEM AS REQUIRED.
 - C. "T" TAPPING OF FIRE ALARM SYSTEM WIRING IS NOT ALLOWED. SYSTEM WIRING MUST BE RUN IN SERIES WITH PREVIOUS DEVICE ON SYSTEM CIRCUIT.
 - D. CONTRACTOR IS RESPONSIBLE FOR ALL CUTTING AND PATCHING AT ALL WALL PENETRATIONS REQUIRED TO MOUNT NEW FIRE ALARM DEVICES. PATCH AND PAINT WALL TO MATCH EXISTING WALL CONDITIONS.

- DRAWING NOTES:**
- ① PROVIDE AUDIO/VISUAL FIRE ALARM NOTIFICATION APPLIANCE AND UTILIZE EXISTING •18AWG T.S.P. SYSTEM SIGNALLING CIRCUIT •3 CABLING MAINTAINED AFTER REMOVAL OF OLD DEVICE. PROVIDE (2)•12AWG SYSTEM CABLING FOR VISUAL SIGNAL IN EXISTING 1" CONDUIT. PROGRAM/TEST DEVICE TO ENSURE PROPER SYSTEM OPERATION. REFER TO RISER DIAGRAM ON E501 FOR MORE INFORMATION.
 - ② PROVIDE AUDIO/VISUAL FIRE ALARM NOTIFICATION APPLIANCE AND PROVIDE SYSTEM SIGNALLING CIRCUIT •3 CABLING TO DEVICE AS REQUIRED BY MANUFACTURER. PROVIDE (2)•12AWG SYSTEM CABLING FOR VISUAL SIGNAL AND •18AWG T.S.P. FOR AUDIO SIGNAL TO NEW AUDIO/VISUAL APPLIANCES IN EXISTING 1" CONDUIT. PROGRAM/TEST DEVICE TO ENSURE PROPER SYSTEM OPERATION. REFER TO RISER DIAGRAM ON E501 FOR MORE INFORMATION.
 - ③ PROVIDE AUDIO/VISUAL FIRE ALARM NOTIFICATION APPLIANCE AND PROVIDE SYSTEM SIGNALLING CIRCUIT •3 CABLING TO DEVICE AS REQUIRED BY MANUFACTURER. PROVIDE (2)•12AWG SYSTEM CABLING FOR VISUAL SIGNAL AND •18AWG T.S.P. FOR AUDIO SIGNAL TO NEW AUDIO/VISUAL APPLIANCES. PROVIDE 1" CONDUIT FOR ROUTING OF NEW SYSTEM CABLING. PROGRAM/TEST DEVICE TO ENSURE PROPER SYSTEM OPERATION. REFER TO RISER DIAGRAM ON E501 FOR MORE INFORMATION.
 - ④ THERE SHALL BE NO CEILING WORK DONE IN ROOM 1036C DUE TO RADIANT PIPING LOCATED ABOVE THE CEILING. ANY NECESSARY WIRING SHALL BE RUN IN WALL OR AS SURFACE RACEWAY.

	MANUAL PULL STATION
	AUDIBLE/VISUAL NOTIFICATION APPLIANCE
	AUDIBLE NOTIFICATION APPLIANCE
	SINGLE POLE SWITCH
	INDICATES NEW DEVICE OR EQUIPMENT
	INDICATES EXISTING DEVICE OR EQUIPMENT TO BE REMOVED
	REFERENCE TO DRAWING NOTE

NO HANGERS SHALL BE CONNECTED TO EXISTING CONCRETE BEAMS. ALL HANGERS SHALL BE SECURED FROM THE DECK.

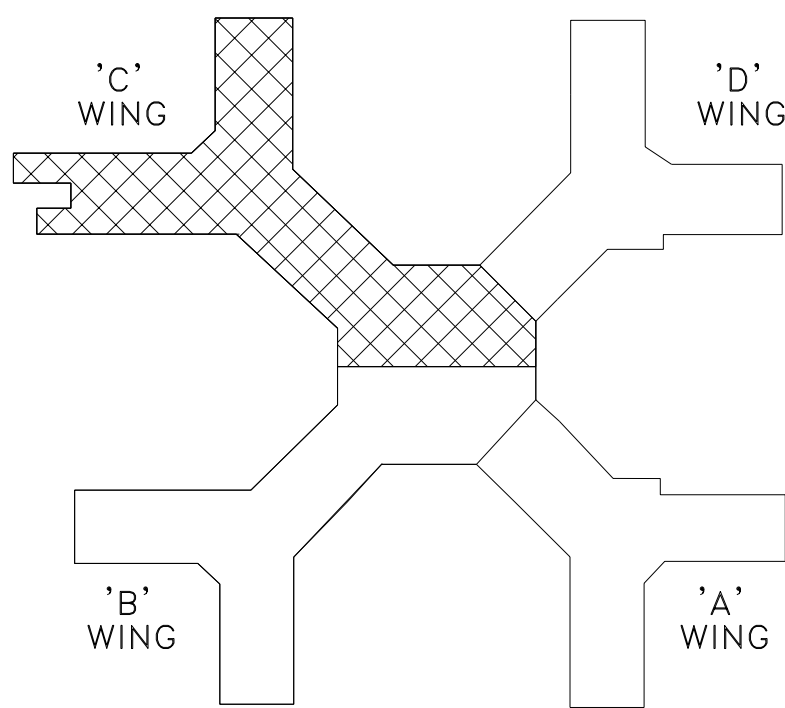

KEY PLAN
NO SCALE

ISSUE FOR BID Revisions		02/07/14 Date	VA WESTERN NEW YORK HEALTHCARE SYSTEM 3495 BAILEY AVENUE BUFFALO, NEW YORK 14215		CLINICAL ENGINEERING DATE ENGINEERING MANAGER DATE	INFECTION CONTROL DATE CARELINE MANAGER DATE	SAFETY OFFICER DATE CHIEF OF STAFF DATE	Drawing Title 10TH FLOOR PLAN – "C" WING	Project Title 10TH FLOOR FIRE ALARM UPDATES	Date FEBRUARY 7, 2014	Station No. 528	
								MEDICAL CENTER DIRECTOR DATE	Building Number 1	Checked CDW	Drawn JTR	
								ASSOCIATE MEDICAL CENTER DIRECTOR DATE	Location V.A.M.C. BUFFALO, NEW YORK		08-116-E102	