

# TOPOGRAPHIC SURVEY

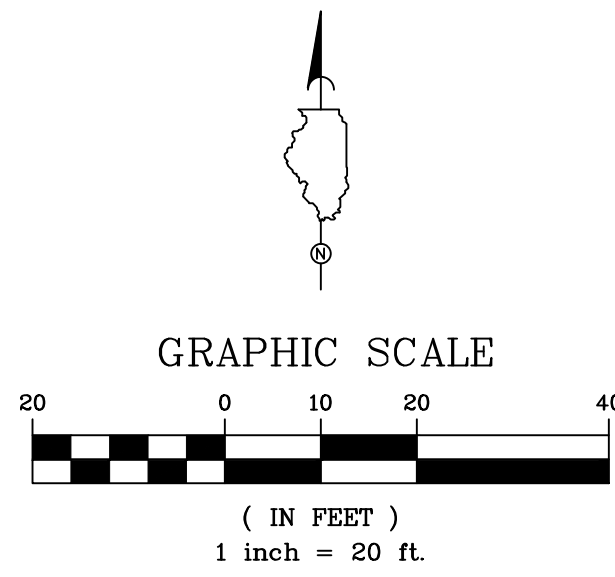

## LEGEND AND ABBREVIATIONS:

	BUILDING
	CONCRETE
	ASPHALT
	DEPRESSED CURB
	CHAIN LINK FENCE
	IRON FENCE
	WOOD FENCE
	GUARDRAIL
	FOUND PK NAIL
	FOUND REBAR
	SET MAG NAIL
	SET/FOUND CUT CROSS
	COMBINATION SEWER
	SANITARY SEWER
	STORM SEWER
	WATER LINE
	GAS LINE
	COMMUNICATION LINE
	SBC COMMUNICATION LINE
	TELEPHONE LINE
	OVERHEAD WIRE LINE
	UNDERGROUND ELECTRIC LINE
	BACK OF CURB ELEVATION
	FLOW LINE ELEVATION
	EDGE OF PAVEMENT ELEVATION
	FINISH FLOOR ELEVATION
	MANHOLE
	WATER MANHOLE
	ELECTRIC MANHOLE
	TELEPHONE MANHOLE
	CURB INLET
	CATCH BASIN
	AREA DRAIN
	POWER POLE W/GUY WIRE
	UTILITY POLE
	LIGHT POLE
	FIRE HYDRANT
	GAS VALVE
	GAS METER
	ELECTRIC METER
	BUFFALO BOX
	WATER VALVE
	TREE--DECIDUOUS
	TREE--EVERGREEN
	BUSH
	POST
	SIGN
	BOLLARD
	SPRINKLER
	CLEANOUT

STATE OF ILLINOIS  
COUNTY OF COOK

This is to certify that I, an Illinois Professional Land Surveyor, have surveyed the property described in the caption above, and that this Professional service conforms to the current Illinois Minimum Standards for a topographic survey.

Given under my hand and seal in Chicago, Illinois, this 23rd day of September, 2013.

THOMAS E. BAUMGARTNER, ILLINOIS LAND SURVEYOR NO. 3142  
LICENSE EXPIRATION 11-30-2014

Field work completed September 18, 2013.

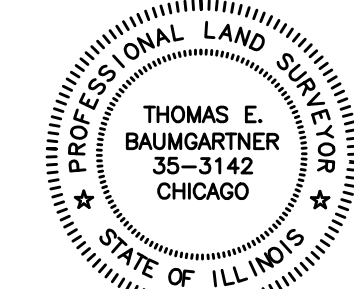

NOTE: TERRA ENGINEERING does not guarantee the accuracy of this survey unless it contains an original seal and signature.



**TERRA**  
ENGINEERING LTD.  
225 W. Ohio Street  
4th Floor  
Chicago, IL 60654  
TEL: (312) 467-0123  
FAX: (312) 467-0220  
www.terraengineering.com

Project Information  
PROJECT #: 13-217  
DRAWN BY: BM/KR  
DESIGN BY: TB  
CHECKED BY: TB

I FURTHER STATE that the accompanying plat is a scaled representation of the physical situation which I found in the field and shows the location of visible evidence of utilities which I found at the time of my survey of these premises, and underground based on supplied plans. No attempt has been made as part of this survey to excavate, uncover or expose those facilities to field check the existence, size, depth, condition, capacity or exact location of those facilities. For more information concerning those utilities, please contact the appropriate public agencies or utility company.

**CANNON**DESIGN

225 North Michigan Avenue, Suite 1100, Chicago, Illinois 60601 312.332.9600  
Baltimore Boston Buffalo Chicago Jacksonville Los Angeles New York  
St. Louis Vancouver Washington DC

Approved:

Chief, FMS:  
Chief of Projects:  
Chief of Safety:  
Chief of Staff:  
ED Director:  
Infection Control:



Drawing Title

VA HINES FUELING STATION

Approved: Chief of Engineering

Date

Approved: Director

Date

Project Title

E-85 FUEL STATION BUILDING 20  
**EDWARD HINES, JR.**  
**VA HOSPITAL**

Building Number & Floor  
BUILDING 20 - SITE PLAN

Checked

Drawn

Location 2100 S 5th Ave #111L  
Hines, IL 60141

Date

01/31/14

Project No.

VA 701-123-R-0103

DRAWING NO.

C0.2

DEPARTMENT OF  
VETERANS AFFAIRS

BM # 1 CARDNO MONUMENT NUMBER 329  
REBAR & CAP

Elevation = 622.571

BM # 2 CARDNO MONUMENT NUMBER 323  
REBAR & CAP

Elevation = 620.233

SITE BM # 3 MAG NAIL (NOTED ON PLAT)

Elevation = 621.32

SITE BM # 4 MAG NAIL (NOTED ON PLAT)

Elevation = 622.24

9		
8		
7		
6		
5		
4		
3		
2		
1	ISSUED FOR BID	1.31.14
Revisions		Date