

SOUND BOOTH INSTALLATION – AUDIOLOGY

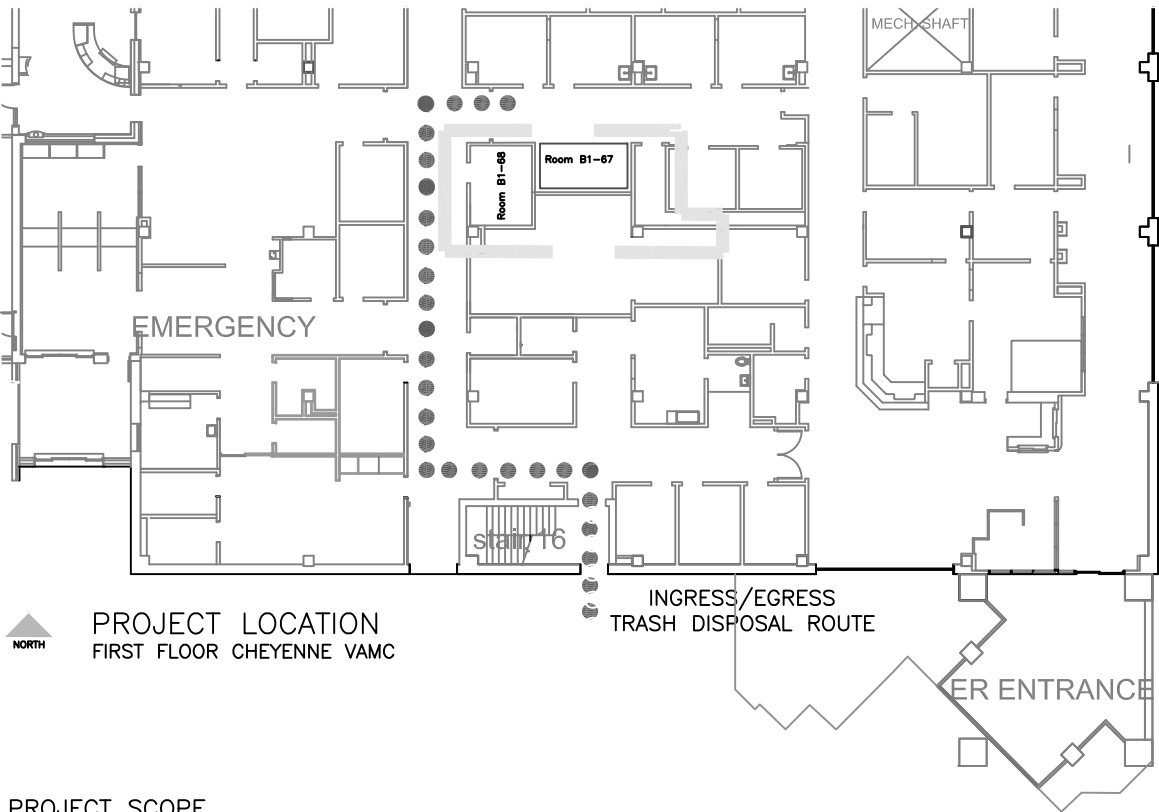

7. THE SITE AND BUILDING SHALL BE CLEANED DAILY. THE CONSTRUCTION PREMISES ARE TO BE BROOM CLEANED AND FINAL CLEANING SHALL INCLUDE WINDOW CLEANING.
8. CONTRACTOR TO BRING TO THE ATTENTION OF COR ALL DISCREPANCIES AS WORK PROGRESSES BEFORE PROCEEDING WITH WORK.
9. THE CONTRACTOR SHALL PROVIDE SUBMITTALS ON ALL ELEMENTS OF THE PROJECT AND THEY MUST BE APPROVED BY THE CO OR COR PRIOR TO ORDERING/INSTALLATION, ETC. IF THE CONTRACTOR PERFORMS ANY CONSTRUCTION ACTIVITY KNOWING IT INVOLVES A RECOGNIZED ERROR, INCONSISTENCY OR OMISSION IN THE CONTRACT DOCUMENTS WITHOUT SUCH NOTICE TO THE CO, THE CONTRACTOR SHALL ASSUME APPROPRIATE RESPONSIBILITY FOR SUCH PERFORMANCE AND SHALL BEAR AN APPROPRIATE AMOUNT OF THE ATTRIBUTED COSTS FOR CORRECTION.
10. DO NOT SCALE THE DRAWINGS. LAY OUT WORK FOLLOWING WRITTEN DIMENSIONS. IF WRITTEN DIMENSIONS ARE LACKING, NOTIFY THE COR AT ONCE. IF DISCREPANCIES OCCUR, CONTACT COR FOR RESOLUTION.
11. DIMENSIONS ARE GIVEN TO FACE OF FINISH UNLESS OTHERWISE NOTED ON THE DRAWINGS.
12. THE CONTRACTOR SHALL BE DEEMED TO HAVE INSPECTED THE SITE AND VERIFIED ACTUAL GRADES, ELEVATIONS, DIMENSIONS, AND DECLINATIONS AND THE TRUE CONDITIONS UNDER WHICH WORK IS TO BE PERFORMED. ANY DISCREPANCIES SHALL BE CALLED TO THE ATTENTION OF THE COR BEFORE PROCEEDING WITH THE WORK.
13. ALL CONDITIONS AFFECTING WORK PROGRESS AND CONFORMANCE TO PLANS AND SCOPE OF WORK SHALL BE VERIFIED BY THE CONTRACTOR PRIOR TO START OF WORK.
14. ANY SITE AND BUILDING AREAS UNAFFECTED BY THIS WORK SHALL BE PROTECTED FROM ANY DAMAGE CAUSED BY THIS WORK. ANY DAMAGE TO EXISTING STRUCTURES & BUILDING ELEMENTS SHALL BE REPAIRED AND CORRECTED BY THE CONTRACTOR AT NO ADDITIONAL EXPENSE TO THE GOVERNMENT.
15. ANY WASTE/REFUSE CAUSED BY THIS WORK SHALL BE REMOVED FROM THE PREMISES & DISPOSED OF BY THE CONTRACTOR IN A LEGAL MANNER AND CONSISTENT WITH THE GEMS REQUIREMENTS FOR THE PROJECT.
16. ALL HAZARDOUS MATERIALS DISPOSED OF SHALL HAVE WASTE TICKETS BROUGHT TO THE COR.
17. MATERIALS, ASSEMBLIES AND SYSTEMS SHOWN ARE NEW UNLESS OTHERWISE NOTED.
18. ALL NEW MATERIALS & EQUIPMENT SHALL BE INSTALLED PER MANUFACTURER’S RECOMMENDATIONS AND REQUIREMENTS FOR WARRANTIES.
19. CONTRACTOR IS REQUIRED TO COORDINATE AND ALLOW ACCESS TO OTHER PROJECTS BEING PERFORMED ON THE VA CAMPUS.
20. ALL WORK WILL BE PERFORMED MONDAY THROUGH FRIDAY, 7 AM TO 4:30 PM EXCEPT AS DEFINED IN THE PROJECT SCOPE. IT IS ANTICIPATED THAT THE MAJORITY OF THE WORK WILL HAVE MINIMAL IMPACT ON THE OPERATION OF THE MEDICAL CENTER. ANY POTENTIAL DISRUPTIONS TO ONGOING VAMC OPERATIONS SHALL BE COORDINATED 17 DAYS IN ADVANCE AND SHALL BE SUBJECT TO REVIEW AND APPROVAL BY THE COR. WORK SHALL BE SCHEDULED TO ALLOW FOR CONTINUOUS OPERATIONS OF ALL FACILITIES TO THE GREATEST EXTENT POSSIBLE.
21. CONTRACTOR PERSONNEL SHALL PRESENT A NEAT APPEARANCE & BE EASILY RECOGNIZED AS CONTRACTOR EMPLOYEES. CONTRACTORS ARE REQUIRED TO OBTAIN & WEAR CHEYENNE VAMC ID BADGES AT ALL TIMES WHEN ON VA PROPERTY. CONTRACTOR PERSONNEL WORKING ON SITE AT THE VA FACILITY SHALL CHECK IN & OUT DAILY WITH THE POLICE DISPATCH LOCATED IN THE MAIN HOSPITAL BUILDING TO RECEIVE SITE BADGES.
22. UNLESS THE PROJECT IS LOCATED AT A VACATED AREA OF THE HOSPITAL, THE CONTRACTOR SHALL PROVIDE THEIR OWN SANITARY FACILITIES.
23. ANY EXCAVATION WORK SHALL REQUIRE ORANGE CONSTRUCTION FENCING AROUND THE EXCAVATED ZONE.
24. CONTRACTOR SHALL PROVIDE THEIR OWN COMPANY SAFETY MANUAL TO THE VA SAFETY OFFICE A MINIMUM OF 1 WEEK IN ADVANCE OF THE NOTICE TO PROCEED FOR REVIEW & APPROVAL BY THE VA SAFETY OFFICER.
25. ALL PARKING OF VEHICLES WILL OCCUR ON PAVED AREAS OF THE SITE. COR TO DIRECT PARKING LOCATION.

ABBREVIATION INDEX

- ADJ. ADJACENT
EX. EXISTING
GY.BD. GYPSUM BOARD
INSUL. INSULATION
O.F.C.I. OWNER FURNISHED, CONTRACTOR INSTALLED
O.F.O.I. OWNER FURNISHED, OWNER INSTALLED
R.B. RUBBER BASE
REQMT’S REQUIREMENTS
TEMP. TEMPORARY
V.C.T. VINYL COMPSITION TILE

STRUCTURAL NOTES

CODES

1. IN ADDITION TO VA REQUIREMENTS, CONTRACTOR SHALL ADHERE TO NFPA 101, 2012 INTERNATIONAL BUILDING CODE, AND NFPA 70.

FRAMING

1. Terminology: Description of terms shall in accordance with ASTM C754, ASTM C11, ASTM C645–09, ASTM C841 and as specified.
2. Underside of Structure Overhead: In spaces where the steel structure is shown, the underside of the structure overhead shall be the underside of the floor or roof construction supported by the structural steel.
3. Submittals: Studs, minimum thickness 0.0150 inches, track : in accordance with ASTM C 645, flange size, 1 ¼ inch, slip type head joints: ASTM C645 top runner with 2 inch deep flange installed with studs friction fit into top runner.
4. Framed Openings: galvanized steel one piece header and jamb studs meeting requirements of ASTM C754.
5. All framing to be straight and true. Match adjacent existing wall thickness.
6. Provide 20 gauge metal strips in areas where blocking is required.

CEILING SUSPENSION SYSTEMS

1. Tie Wire: ASTM A641 Class 1 zinc coating, soft temper, 0.062 diameter wire.
2. Concrete Attachment: Post–installed expansion anchor capable of maintaining a load equal to 5 times that imposed by construction materials.
3. Grid system: Match existing.
4. Do not reuse ceiling wire.

ACCESSORIES

1. Provide 20 gauge strips for installation of wall mounted accessories including but not limited to casework, bulletin boards, and lockers.

INSTALLATION. FRAMED MEMBERS

1. Doors; Install two studs at each jamb. Install cripple studs at head adjacent to jamb stud with a minimum 1 1/2” clearance from jamb stud.
2. Extend jamb studs through suspension ceiling and attach at underside of overhead structure.
3. Fill all new walls with R–11 insulation to underside floor above.

DRAWING INDEX

- A.1 PROJECT LOCATION PLAN
A.2 PLAN
A.3 REFLECTED CEILING PLAN
SOUND BOOTH DRAWINGS 1–4

PROJECT SCOPE

THE SCOPE OF THIS PROJECT IS TO PROVIDE AN ENCLOSURE AND ALL NECESSARY UTILITY CONNECTIONS FOR A NEW VENDOR PROVIDED SOUND BOOTH. A NEW OFFICE ADJACENT TO THE SOUND BOOTH IS ALSO TO BE PROVIDED. CONTRACTOR SHALL COORDINATE WITH SOUND BOOTH VENDOR TO INSURE FULL OPERATION. VA FMS & CONTRACTING OFFICERS (CO) AND CONTRACTING OFFICERS REPRESENTATIVE (COR) SHALL BE IN DAILY CONTACT WITH THE CONTRACTOR. CONTRACTOR IS EXPECTED TO FILE DAILY REPORTS OF ALL WORK PERFORMED DURING THE DAY, TYPES/TIMES ON THE JOB OF ALL EMPLOYEES AND SUBCONTRACTORS. ALL CRASH RAILS & CEILING PANELS REMOVED SHALL BE RETURNED TO THE VA. ALL TEMPORARY PARTITIONS WHALL BE BUILT FOR THE

THE HOSPITAL WILL BE IN USE THROUGHOUT THE CONSTRUCTION PERIOD REQUIRING STRICT ADHERENCE TO INFECTION CONTROL AS DEFINED IN THE ICRA, AND IN THE "INFECTION CONTROL POLICY". THE CHEYENNE VAMC SITE ALSO REQUIRES ADHERENCE TO THE CHEYENNE VAMC "CONSTRUCTION CONTROL POLICY" INCLUDED IN THE STATEMENT OF WORK. ADDITIONALLY, ALL NOISY ACTIVITIES SHALL BE LIMITED TO AFTER 4:00 PM, MONDAY THROUGH FRIDAY AND ON WEEKENDS.

THE CONTRACCTOR(S) ARE REQUIRED TO VISIT THE SITE PRIOR TO BIDDING AT AN AGREED UPON TIME BETWEEN THE CO, AND THE COR. PRIOR TO THE START OF WORK IT IS THE CONTRACTORS RESPONSIBILITY TO BRING TO THE ATTENTION OF THE COR ANY DEFICIENCIES IN THE EXISTING CONDITIONS, MATERIALS, METHODS, PROCEDURES OR OTHER AREAS OF CONFLICT BETWEEN THE WORK REQUIRED AND THE CONTRACT DOCUMENTS.







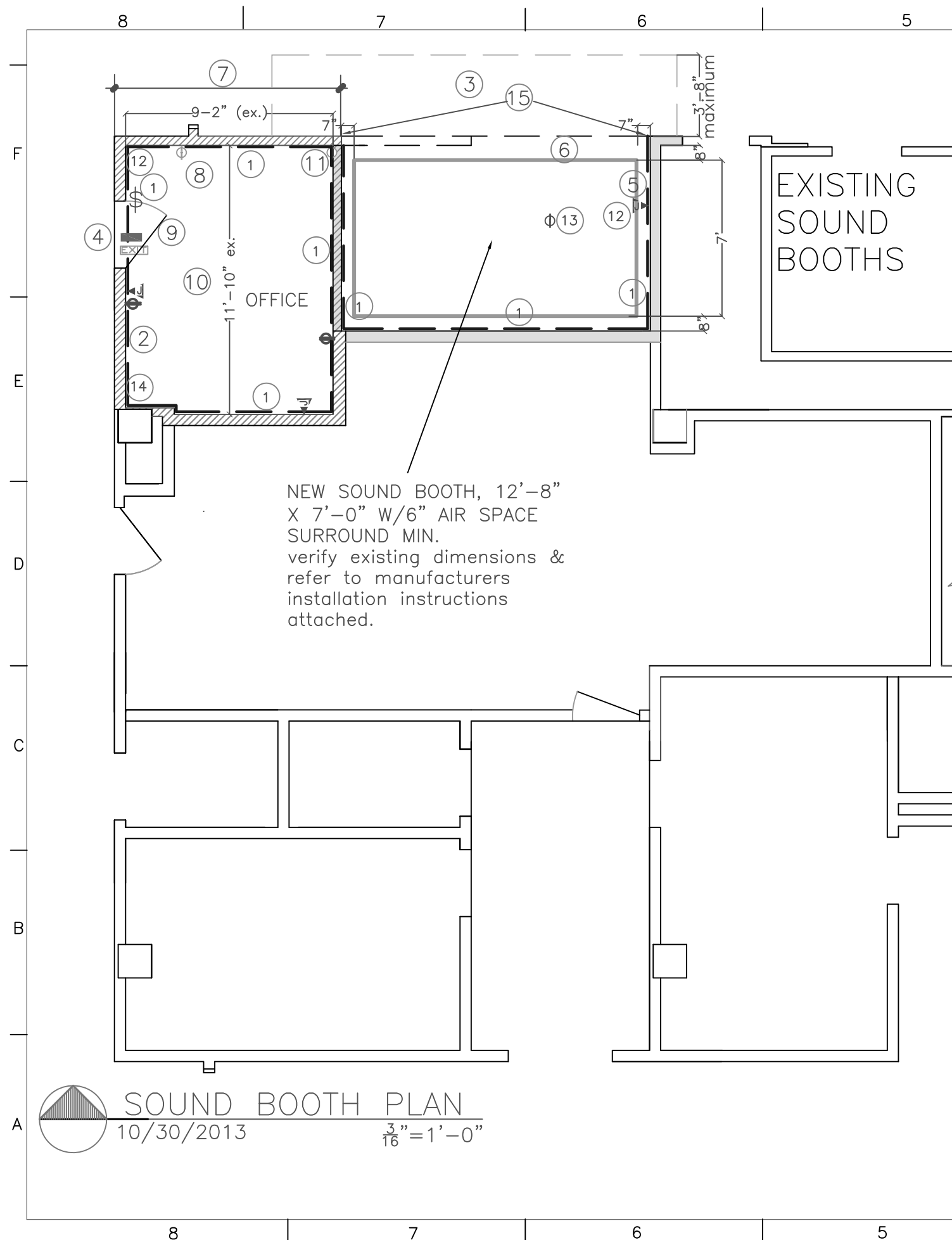

PROJECT NOTES

1. THE CONTRACTOR SHALL, WITHOUT ADDITIONAL EXPENSE TO THE GOVERNMENT, BE RESPONSIBLE FOR COMPLYING WITH ANY VETERANS ADMINISTRATION, FEDERAL, LOCAL REQUIREMENTS, REGULATIONS & CODES APPLICABLE TO THE PERFORMANCE OF THE WORK.
2. THESE NOTES ARE INTENDED AS A GUIDE TO THE CONSTRUCTION REQUIREMENTS ESTABLISHED FOR THIS PROJECT. NO CONTRACTOR SHOULD ATTEMPT TO DESIGN, BID, OR CONSTRUCT ANY PORTION OF THE WORK HEREIN WITHOUT FULL UNDERSTANDING OF THE DESIGN INTENT, HOSPITAL REQUIREMENTS AND APPLICABLE CODE REQUIREMENTS. THE CONTRACTOR SHOULD OBTAIN CLARIFICATION FROM THE CONTRACTING OFFICER (CO) OR THE CONTRACTING OFFICERS REPRESENTATIVE (COR) IF UNCERTAIN OF THE DESIGN OR INTENT. ALL FEATURES ARE NOT FULLY SHOWN ON THE CONTRACT DOCUMENTS OR IN THE SCOPE OF WORK.
3. THE DESIGN PRESENTED ON THESE DRAWINGS ESTABLISHES THE GENERAL REQUIREMENTS OF THIS PROJECT. IT DOES NOT PRESENT ALL DETAILS REQUIRE FOR CONSTRUCTION.
4. THE DRAWINGS INDICATE LOCATION, DIMENSIONS, AND TYPICAL DETAILS OF CONSTRUCTION. FEATURES OF CONSTRUCTION SHOWN ARE TYPICAL AND APPLY GENERALLY FOR SIMILAR CONDITIONS. THE DRAWINGS DO NOT ILLUSTRATE EVERY CONDITION. IN THE EVENT THAT CERTAIN FEATURES ARE NOT FULL SHOWN ON THE DRAWINGS OR CALLED OUT IN THE SPECIFICATIONS OR STATEMENT OF WORK, THEIR CONSTRUCTION SHALL BE (A) OF THE CHARACTER AS SHOWN FOR SIMILAR CONDITIONS, AND (B) IN ACCORDANCE WITH CONVENTIONAL PRACTICES OF THE INTERNATIONAL BUILDING CODE AND NFPA, OR (C) AS CLARIFIED BY THE CO AND THE COR PRIOR TO PERFORMING ANY WORK FOR RESOLUTION.
5. CONTRACTOR SHALL CORRELATE WORK AMONG SOUND BOOTH DRAWINGS AND VA DOCUMENTS. CONTRACTOR SHALL ALSO CORRELATE WORK BETWEEN DRAWINGS OF DIFFERENT SCALES WITH EACH DRAWING. IT IS THE EXPLICIT AND SPECIFIC RESPONSIBILITY OF THE CONTRACTOR TO EXAMINE THE CONTRACT DOCUMENTS AND SOUND BOOTH DRAWINGS IN THEIR ENTIRETY.
6. UNLESS SHOWN OTHERWISE, DETAILS SHOWN AS "TYPICAL" APPLY WHEREVER APPROPRIATE. SPECIFIC DETAILS TAKE PRECEDENCE OVER "TYPICAL" DETAILS. SPECIFIC NOTES ON DRAWINGS TAKE PRECEDENCE OVER GENERAL NOTES.

| | | | |
|--|--------------------------------|-----------------|-----|
| VA NO. 442–14–14S | | | REV |
| AUDIOLOGY SOUND BOOTH INSTALLATION CHEYENNE, WY. VAMC | | | |
| SCALE: 3/16"=1'-0" | SHEET PROJECT LOCATION PLAN | SHEET 1 OF 3 | |



LEGEND

-  EX. NEW WALLS TO UNDERSIDE FL. (12'-0"). INSULATE WALLS W/ R-11 INSULATION AND PROVIDE "QUIET ROCK 510" BY CERTAINTED TO UNDERSIDE OF FLOOR ABOVE. TEXTURE TO BE BE "CLASS 4" TO MATCH EXISTING FINISH & PAINT ONE COAT PRIMER AND TWO COATS FINISH PER PAINT NOTES.
-  EXIST WALLS, PROVIDE NEW QUIET ROCK TO AS SHOWN W/ BLUE LINE ONLY, PRIME AND PAINT W/ 2 COATS VA STANDARD WHITE.
-  EX. DATA TO REMAIN.  NEW DATA PER SPECIFICATIONS
-  EX. DUPLEX OUTLETS TO REMAIN.  NEW DUPLEX OUTLETS.
-  NEW STROBE
-  NEW EXIT SIGNAGE.  SWITCH

PLAN NOTES

- ① TEXTURE WALLS TO MATCH EXIST. CLASS IV FINISH. USE VA STANDARD SHERWIN WILLIAMS, "HARMONY" COLOR – ZURICH WHITE.
- ② ACCENT WALL FROM VA STANDARD PALETTE. VA TO SELECT COLOR.
- ③ DUSTPROOF PARTITIONS TO UNDERSIDE CEILING ABOVE. REMOVE AFTER ALL WORK IS COMPLETE. REFER TO INFECTION CONTROL PROCEDURES.
- ④ KEEP DOOR SHUT & COVERED W/10 MIL VISQUEEN UNTIL ALL WORK IS COMPLETE. REFER TO INFECTION CONTROL PROCEDURES.
- ⑤ VERIFY WITH MANUFACTURER EXACT LOCATION FOR DATA DROP INTO SOUND BOOTH.
- ⑥ NEW VCT FLOORING & RUBBER BASE. REMOVE EXIST FLOORING.
- ⑦ REPAINT ENTIRE WALL TO MATCH EXIST. VA COLOR.
- ⑧ EX. ELEC. J BOX. (EX.) CONDUIT FROM BOXES ON NORTH WALL. FEED OTHER PLUGS IN OFFICE ROOM FROM THIS J BOX & SOUND BOOTH PANEL #42B.
- ⑨ NEW EXIT SIGNAGE & ALARM HARDWARE. COORDINATE ALARM INSTALLATION W/ VA VENDOR, SIEMENS OR APPROVED VA VENDOR.
- ⑩ NEW CARPET & RUBBER BASE.
- ⑪ RELOCATE (E) OUTLET FROM BEHIND WALL, TO 12 INCHES FROM WALL.
- ⑫ WIRING FOR (2) NEW DATA OUTLETS (blue wire) IN CEILING ABOVE OFFICE.
- ⑬ PROVIDE (1) ONE DEDICATED 20 AMP CIRCUIT TO POWER THE 2 SIDES OF THE BOOTH. SPILT AND PROVIDE TWO JUNCTION BOXES ON THE ROOF, 1 EACH SIDE.
- ⑭ WIRING FOR (1) NEW DATA OUTLETS (blue wire) IN CEILING ABOVE OFFICE.
- ⑮ REMOVE EXISTING WALL. AFTER INSTALLATION OF BOOTH, PROVIDE FRAMING AROUND BOOTH TO MATCH EXISTING FRAMING AROUND EXISTING BOOTHS.

VA NO. 442-14-14S

AUDIOLOGY SOUND BOOTH INSTALLATION
CHEYENNE, WY. VAMC

SCALE:
3/16"=1'-0"

SHEET





PLAN

SHEET

2 OF 3



LEGEND

-  NEW CEILING GRID, VA STANDARD ARMSTRONG GEORGIAN #573 & GRID TO BE ARMSTRONG "PRELUDE", SQUARE LAY IN $1\frac{5}{16}$ " GRID.
-  EXIST. SPRINKLERS TO REMAIN
-  NEW SPRINKLERS TO BE PROVIDED INTO SOUND BOOTH. CORDINATE W/ SOUND BOOTH INSTALLER.
-  NEW ROOFTOP INTEGRATED VENTILATION FAN SUPPLIED AND INSTALLED BY VENDOR. CONNECT TO EXISTING HVAC SYSTEM WITH 6" FLEXIBLE DUCT.
-  EXISTING SUPPLY. CONNECT TO CEILING GRID FLUSH AT GRID EDGE.

GENERAL NOTES

- ① ALL WIRING TO BE PREFORMED IN CONDUIT PER VA REQUIRMENTS.
- ② INSTALL ALL CEILING GRID IN ACCORDANCE WITH MANUFACTURERS INSTRUCTIONS FOR SEISMIC ZONE C & COMPLIANT W/NFPA 70.300.11
- ③ DUSTPROOF PARTITIONS TO UNDERSIDE CEILING.
- ④ POWER TO LIGHTS TO BE INSTALLED PER VA FMS DIRECTION.
- ⑤ EXISTING CEILING GRID & TILES TO REMAIN

REFLECTED CEILING PLAN

10/30/2013

$\frac{3}{16}$ "=1'-0"

VA NO. 442-14-14S

REV

AUDIOLOGY SOUND BOOTH INSTALLATION
CHEYENNE, WY. VAMC

SCALE:
 $\frac{3}{16}$ "=1'-0"

SHEET

REFLECTED CEILING PLAN

SHEET

3 OF 3