

Department of Veterans Affairs

FORT BLISS NATIONAL CEMETERY

EL PASO, TEXAS

REPAIR ROSTRUM TURF AND DRAINAGE

SHEET INDEX:

- X - 101 TITLE SHEET
- X - 102 GENERAL NOTES
- L - 101 SITE PLAN
- L - 102 DEMOLITION PLAN
- L - 103 EXCAVATION PLAN
- L - 104 DRAINAGE PLAN
- L - 105 IRRIGATION PLAN
- L - 201 SECTIONS & DETAILS

[illegible]

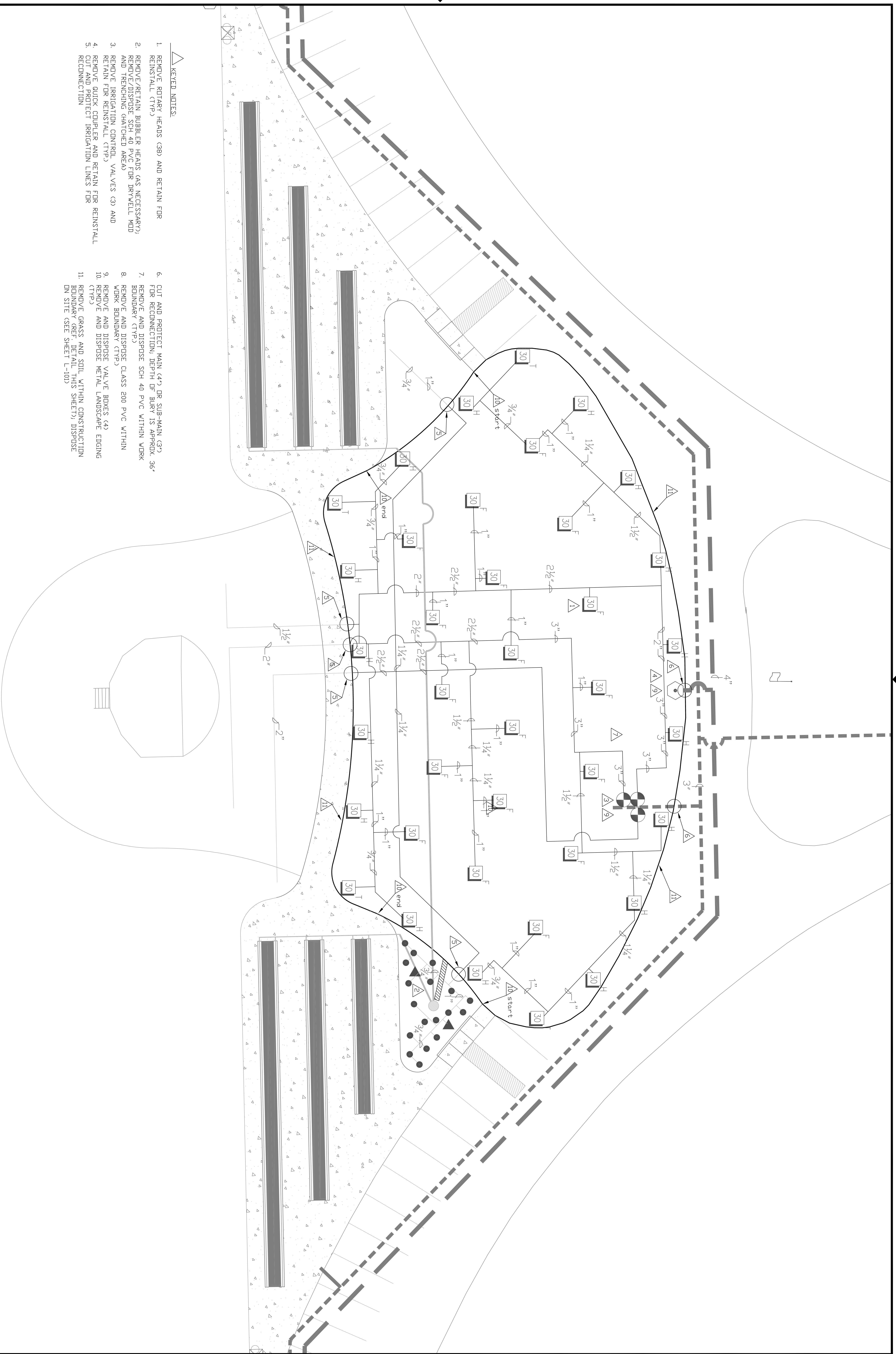
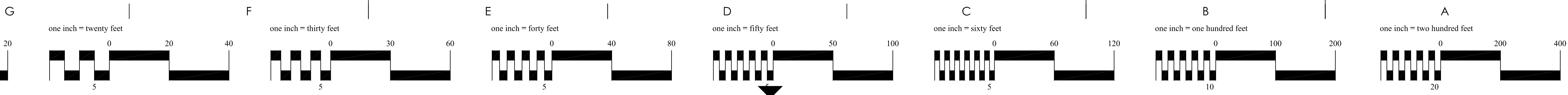

KEYED NOTES:

1. REMOVE ROTARY HEADS (38) AND RETAIN FOR REINSTALL (CTP)
2. REMOVE/RETAIN BUBBLER HEADS (AS NECESSARY); REMOVE/DISPOSE SCH 40 PVC FOR DRYWELL MOD AND TRENCHING (HATCHED AREA)
3. REMOVE IRRIGATION CONTROL VALVES (3) AND RETAIN FOR REINSTALL (CTP)
4. REMOVE QUICK COUPLER AND RETAIN FOR REINSTALL
5. CUT AND PROTECT IRRIGATION LINES FOR RECONNECTION
6. CUT AND PROTECT MAIN (44) OR SUB-MAIN (3) FOR RECONNECTION; DEPTH OF BURY IS APPROX. 36"
7. REMOVE AND DISPOSE SCH 40 PVC WITHIN WORK BOUNDARY (CTP)
8. REMOVE AND DISPOSE CLASS 200 PVC WITHIN WORK BOUNDARY (CTP)
9. REMOVE AND DISPOSE VALVE BOXES (4)
10. REMOVE AND DISPOSE METAL LANDSCAPE EDGING (CTP)
11. REMOVE GRASS AND SOIL WITHIN CONSTRUCTION BOUNDARY (REF. DETAIL THIS SHEET) DISPOSE ON SITE (SEE SHEET L-103)



NATIONAL
CEMETERY
ADMINISTRATION

Drawing Title
DEMOLITION PLAN

Project Title
**ROSTRUM TURF
& DRAINAGE**

Approved: Division Chief

Building Number
.....

Checked

Drawn
CRC

Approved: Service Director

Location
FORT BLISS NATIONAL CEMETERY

Date
1/23/2014

Project No.
886-14-202

DRAWING NO.
L-102

Dwg. 4 OF 8

