

three inches = one foot  
one and one half inches = one foot  
one inch = one foot  
three quarters inch = one foot  
one half inch = one foot  
three eighths inch = one foot  
one quarter inch = one foot  
one eighth inch = one foot

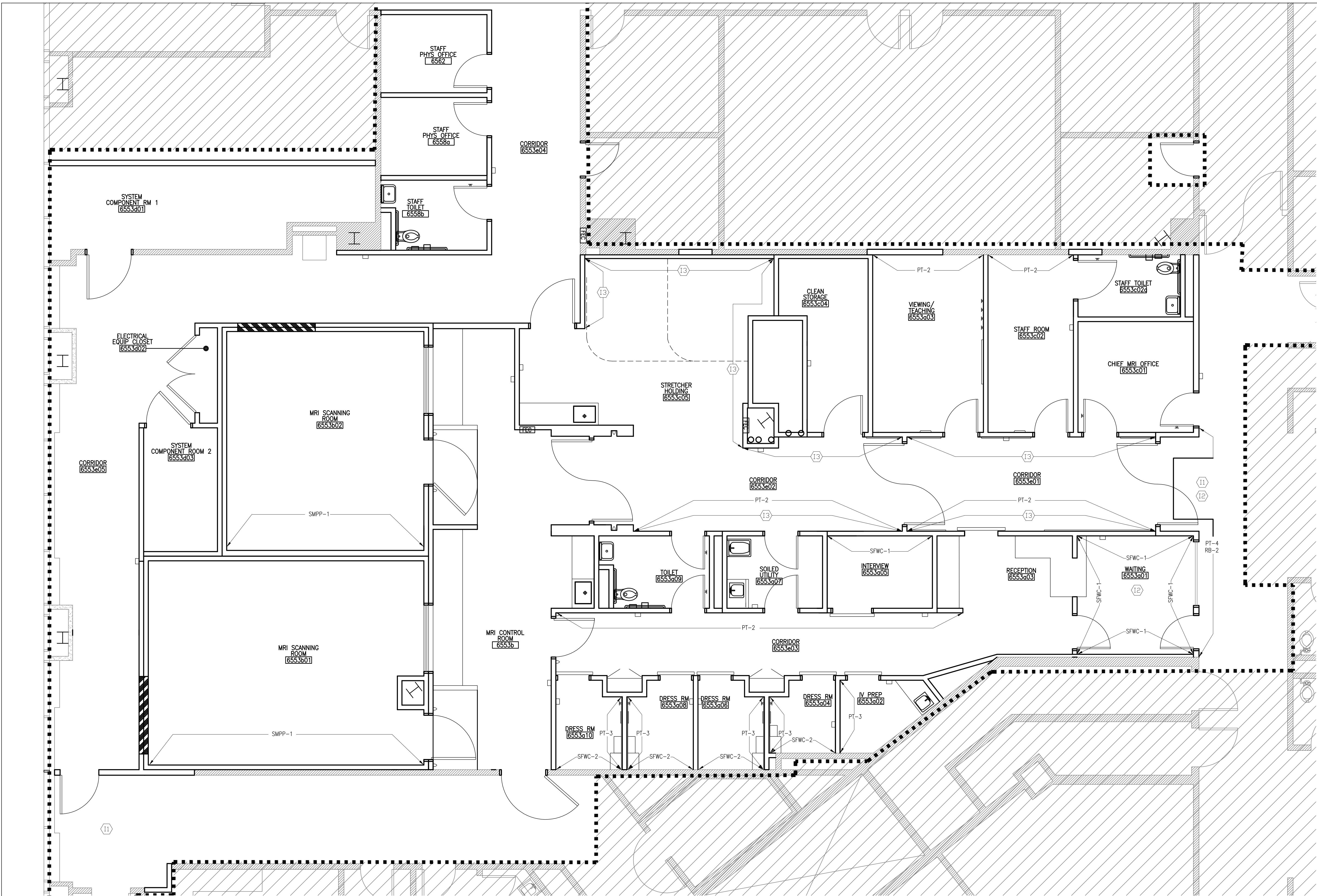

**F1 SIXTH FLOOR FINISH PLAN**  
1/4" = 1'-0" 0 1' 2' 4' NORTH

ROOM FINISH SCHEDULE

| ROOM NUMBER | ROOM NAME                   | FLOOR  | FINISHES |        |         | NOTES                                      |
|-------------|-----------------------------|--------|----------|--------|---------|--|
|             |                             |        | BASE     | WALLS  | CEILING |  |
| 6553001     | WAITING                     | LN*    | RB-1     | SFWC-1 | AMP-1   | *FLOOR PATTERN. SEE IN-107.00 FOR PATTERN. |
| 6553002     | IV PREP                     | LN-2   | RB-1     | PT-1   | AT-1    |  |
| 6553003     | RECEPTION                   | LN*    | RB-1     | PT-1   | AT-1    | *FLOOR PATTERN. SEE IN-107.00 FOR PATTERN. |
| 6553004     | DRESS RM                    | LN-2   | RB-1     | PT-1   | AT-1    | ACCENT PAINT AND WALLCOVERING              |
| 6553005     | INTERVIEW                   | LN-2   | RB-1     | PT-2   | AT-1    | ACCENT WALLCOVERING                        |
| 6553006     | DRESS RM                    | LN-2   | RB-1     | PT-1   | AT-1    | ACCENT PAINT AND WALLCOVERING              |
| 6553007     | SOILED UTILITY              | LN-2   | RB-1     | PT-1   | AT-1    |  |
| 6553008     | DRESS RM                    | LN-2   | RB-1     | PT-1   | AT-1    | ACCENT PAINT AND WALLCOVERING              |
| 6553009     | TOILET                      | CT-1   | CTB-1    | CT-2   | AT-1    |  |
| 6553010     | DRESS RM                    | LN-2   | RB-1     | PT-1   | AT-1    | ACCENT PAINT AND WALLCOVERING              |
| 6553011     | MRI CONTROL RM              | RSF*   | IN       | PT-1   | AT-1    | *FLOOR PATTERN. SEE IN-107.00 FOR PATTERN. |
| 6553001     | MRI SCANNING ROOM           | RSF-1  | IN       | PT-1   | AT-1    |  |
| 6553002     | MRI SCANNING ROOM           | RSF-1  | IN       | PT-1   | AT-1    |  |
| 6553001     | CHIEF MRI OFFICE            | LN*    | RB-1     | PT-1   | AT-1    | *FLOOR PATTERN. SEE IN-107.00 FOR PATTERN. |
| 6553002     | STAFF RM                    | LN*    | RB-1     | PT-1   | AT-1    |  |
| 6553002     | STAFF TOILET                | CT-1   | CTB-1    | CT-2   | AT-1    |  |
| 6553003     | VIEWING/TEACHING            | LN*    | RB-1     | PT-1   | AT-1    | *FLOOR PATTERN. SEE IN-107.00 FOR PATTERN. |
| 6553004     | CLEAN STORAGE               | LN-1   | RB-1     | PT-1   | AT-1    |  |
| 6553005     | STRETCHER HOLDING           | RSF-1  | IN       | PT-1   | AT-1    |  |
| 6553001     | SYSTEM COMPONENT RM 1       | CFS-ND | RB-1     | PT-1   | ---     |  |
| 6553002     | ELECTRICAL EQUIPMENT CLOSET | CFS-ND | RB-1     | PT-1   | ---     |  |
| 6553003     | SYSTEM COMPONENT RM 2       | CFS-ND | RB-1     | PT-1   | ---     |  |
| 6553001     | CORRIDOR                    | RSF*   | IN       | PT-1   | AT-1    | *FLOOR PATTERN. SEE IN-107.00 FOR PATTERN. |
| 6553002     | CORRIDOR                    | RSF*   | IN       | PT-1   | AT-1    | *FLOOR PATTERN. SEE IN-107.00 FOR PATTERN. |
| 6553003     | CORRIDOR                    | LN-1   | RB-1     | PT-1   | AT-1    |  |
| 6553004     | CORRIDOR                    | ETRF   | ETRF     | PT-1   | AT-1    |  |
| 6553005     | CORRIDOR                    | ETRF   | ETRF     | PT-1   | AT-1    |  |
| 6553006     | STAFF PHYS.                 | LN-1   | RB-1     | PT-1   | AT-1    |  |
| 6553007     | TOILET                      | CT-1   | CTB-1    | CT-2   | AT-1    |  |
| 6553008     | STAFF PHYS.                 | LN-1   | RB-1     | PT-1   | AT-1    |  |

NO FINISH  
ETRF EXISTING TO REMAIN FINISH  
FINISH KEY

|   |   |
|---|---|
| SECTION 06 20 00<br>PLAM-1 PLASTIC LAMINATE<br>MANUF: LAMIN-ART<br>PRODUCT: HPL<br>COLOR: SNOWCAP 2421-G<br>NOTE: GLOSS FINISH  | SECTION 09 72 33<br>FWP SYNTHETIC FIBER WALL COVERING<br>MANUF: CARNEGIE<br>PRODUCT: XOREL- NEXUS<br>COLOR: 6425-903 - UNBACKED<br>NOTE: TACKABLE                                 |
| SECTION 06 26 13<br>SMPP-1 SOLID MINERAL PROFILE PANELING<br>PROD: PROFILE PANEL<br>PATTERN: CARVE, CRYSTAL WHITE   | SFWC-1 SYNTHETIC FIBER WALL COVERING<br>MANUF: CARNEGIE<br>PRODUCT: XOREL- NEXUS<br>COLOR: 6425-903, PAPER BACKED   |
| SECTION 09 30 13<br>CT-1 PORCELAIN CERAMIC TILE<br>MANUF: CROSSVILLE<br>PRODUCT: MAIN STREET<br>COLOR: BISTRO BROWN<br>SIZE: 18"x18"  | SFWC-2 SYNTHETIC FIBER WALL COVERING<br>MANUF: CARNEGIE<br>PRODUCT: XOREL- SLIDE 6717<br>COLOR: W21   |
| CT-2 GLAZED CERAMIC TILE<br>MANUF: DALTILE<br>PRODUCT: RITTENHOUSE SQUARE<br>COLOR: BISCUIT (GLOSS)<br>SIZE: 3"x6"  | SECTION 09 91 00 PAINT<br>NOTE: SEE GENERAL NOTES FOR FINISH GLOSS LEVEL.   |
| CTB-1 PORCELAIN CERAMIC TILE<br>MANUF: CROSSVILLE<br>PRODUCT: MAIN STREET<br>COLOR: BISTRO BROWN<br>SIZE: 3"x6" COVE BASE   | PT-1 LATEX PAINT<br>MANUF: BENJAMIN MOORE<br>COLOR: SIMPLY WHITE OC-117   |
| SECTION 09 51 00<br>AT-1 ACOUSTICAL CEILING TILE<br>MANUF: ARMSTRONG<br>PRODUCT: HEALTHZONE ULTIMA 1935<br>SIZE: 24" X 24", SQUARE LAYIN<br>COLOR: WHITE<br>GRID: 15/16" PRELUDE EXPOSED GRID | PT-2 LATEX PAINT<br>MANUF: SHERMAN WILLIAMS<br>COLOR: BELVEDERE CREAM SW0067  |
| AMP-1 WOOD CEILING<br>MANUF: CEILING PLUS<br>PRODUCT:<br>COLOR: RED BIRCH<br>SIZE: 4" PLANKS  | PT-3 LATEX PAINT<br>MANUF: SHERMAN WILLIAMS<br>COLOR: HONEYCOMB SW6375  |
| SECTION 09 61 10<br>CFS-ND SEALED CONCRETE  | PT-4 LATEX PAINT<br>MANUF: SHERMAN WILLIAMS<br>COLOR: VIRTUAL TAUPES SW7039   |
| SECTION 09 65 13<br>RB-1 RUBBER BASE<br>MANUF: JOHNSONITE<br>PRODUCT: TRADITIONAL COVED BASE<br>COLOR: STEEL 179<br>HEIGHT: 4-INCHES<br>THICKNESS: 1/8-INCHES                                 | SECTION 10 21 23<br>CC-1 CUBICLE CURTAIN-OFICI<br>MANUF: MAHARAM<br>PATTERN: MODERATE 51149<br>COLOR: VAPOR: 002  |
| RB-2 RUBBER BASE<br>TO MATCH EXISTING ADJACENT  | SECTION 10 26 00<br>CG-1 FLUSH MOUNTED, FULL HEIGHT<br>CORNER GUARD 90 DEGREE<br>MANUF: CONSTRUCTION SPECIALTIES<br>PRODUCT: FSC-25N<br>SIZE: 3" LEG<br>FINISH: 933 MISSION WHITE |
| SECTION 09 65 16<br>IN 4" INTEGRAL BASE TO MATCH ADJACENT FLOOR   | CG-2 FLUSH MOUNTED, FULL HEIGHT<br>CORNER GUARD END CAP<br>MANUF: CONSTRUCTION SPECIALTIES<br>PRODUCT: FSC-25N<br>SIZE: END CAP<br>FINISH: 933 MISSION WHITE                      |
| RSF-1 RESILIENT SHEET<br>MANUF: NORA<br>PRODUCT: SENTICA<br>COLOR: CASHMERE<br>THICKNESS: 3MM   | SSF-2 SOLID SURFACE FABRICATION<br>MANUF: DUPONT<br>PRODUCT: CORIAN<br>COLOR: RICE PAPER, 1/4" THICK  |
| RSF-2 RESILIENT SHEET<br>MANUF: NORA<br>PRODUCT: SENTICA<br>COLOR: OLD OAK<br>THICKNESS: 3MM  | SECTION 10 28 00<br>GL-3 MIRROR<br>SEE SPECIFICATIONS   |
| RSF-3 RESILIENT SHEET<br>MANUF: NORA<br>PRODUCT: SENTICA<br>COLOR: HAYRIDE<br>THICKNESS: 3MM  | SECTION 12 36 00<br>SSF-1 SOLID SURFACE FABRICATION<br>MANUF: DUPONT<br>PRODUCT: CORIAN<br>COLOR: RICE PAPER, 1/2" THICK  |
| LN-1 LINOLEUM SHEET FLOORING<br>MANUF: FORBO<br>PRODUCT: REAL<br>COLOR: 3246 SHIKE  | QSF-1 QUARTZ SURFACE FABRICATION<br>MANUF: DUPONT<br>PRODUCT: ZODIAQ<br>COLOR: POPPY SEED   |
| LN-2 LINOLEUM SHEET FLOORING<br>MANUF: FORBO<br>PRODUCT: MARMOLEUM REAL<br>COLOR: 3568 DELTA LACE   |   |
| LN-3 LINOLEUM SHEET FLOORING<br>MANUF: FORBO<br>PRODUCT: MARMOLEUM FRESCO<br>COLOR: 3846 NATURAL CORN   |   |

GENERAL NOTES

1. PAINT FINISH ON WALLS SHALL BE EGGSHELL. PAINT FINISH ON DOORS SHALL BE SEMI-GLOSS.
2. REFER TO ELEVATIONS ON AE206 FOR ADDITIONAL INFORMATION ON EXTENTS OF FINISHES.
3. MANUF AND PRODUCT SHOWN FOR DESIGN INTENT AND CONTRACTOR COORDINATION ONLY.

KEYNOTES

- (11) PROVIDE NEW FINISHES AT AREAS OF DEMOLITION TO MATCH EXISTING.
- (12) REFER TO RCP FOR EXTENT OF WOOD CEILING PANELS.
- (13) SOLID SURFACE (SSF-2) WAINSCOT FROM FINISHED FLOOR 36" AFF. CLEAR SEALANT AT JOINT AT TOP OF PANEL.

KEY PLAN:

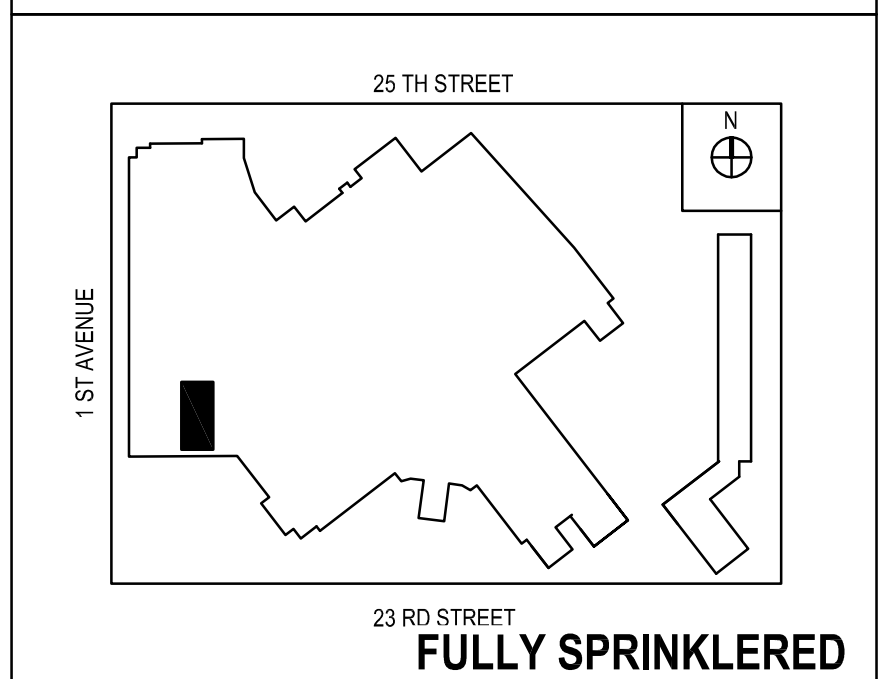

FULLY SPRINKLERED

|  |  |   |      |  |  |  |  |  |  |                               |  |  |  |
|--|--|---|------|--|--|--|--|--|--|-------------------------------|--|--|--|
| CONSULTANTS:   |  | Daniel L. Lutz<br>036266                                  | Date | ARCHITECT/ENGINEERS:   |  | Drawing Title<br>SIXTH FLOOR FINISH PLAN |  | Project Title<br>DEPARTMENT OF VETERANS AFFAIRS<br>MRI REPLACEMENT |  | Project Number<br>197-840     |  | Office of<br>Construction and Facilities<br>Management |  |
|  |  |   |      | Henningson, Durham & Richardson, Architecture and Engineering, P.C.<br>500 Seventh Avenue, 11th Floor, New York, NY 10018 . 212-904-1212 |  | Approved: Project Director               |  | Location<br>NEW YORK CITY, NEW YORK                                |  | Building Number<br>BUILDING-6 |  |  |  |
| REVISION 1<br>ISSUE FOR CONSTRUCTION<br>ISSUE FOR REVIEW<br>DD2 SUBMISSION<br>Revisions: |  | 4/8/2014<br>1/24/2014<br>12/16/2013<br>11/16/2013<br>Date |      |  |  |  |  | Date<br>Nov 8, 2013  |  | Checked<br>W.NATHANS          |  | Drawing Number<br>IN106                                |  |
|  |  |   |      |  |  |  |  |  |  | Drawn<br>B.SCHALLER           |  | U.S. Department of Veterans Affairs                    |  |