

three inches = one foot  
one and one half inches = one foot  
one inch = one foot  
three quarters inch = one foot  
one half inch = one foot  
one quarter inch = one foot  
three eighths inch = one foot  
one eighth inch = one foot  
one sixteenth inch = one foot

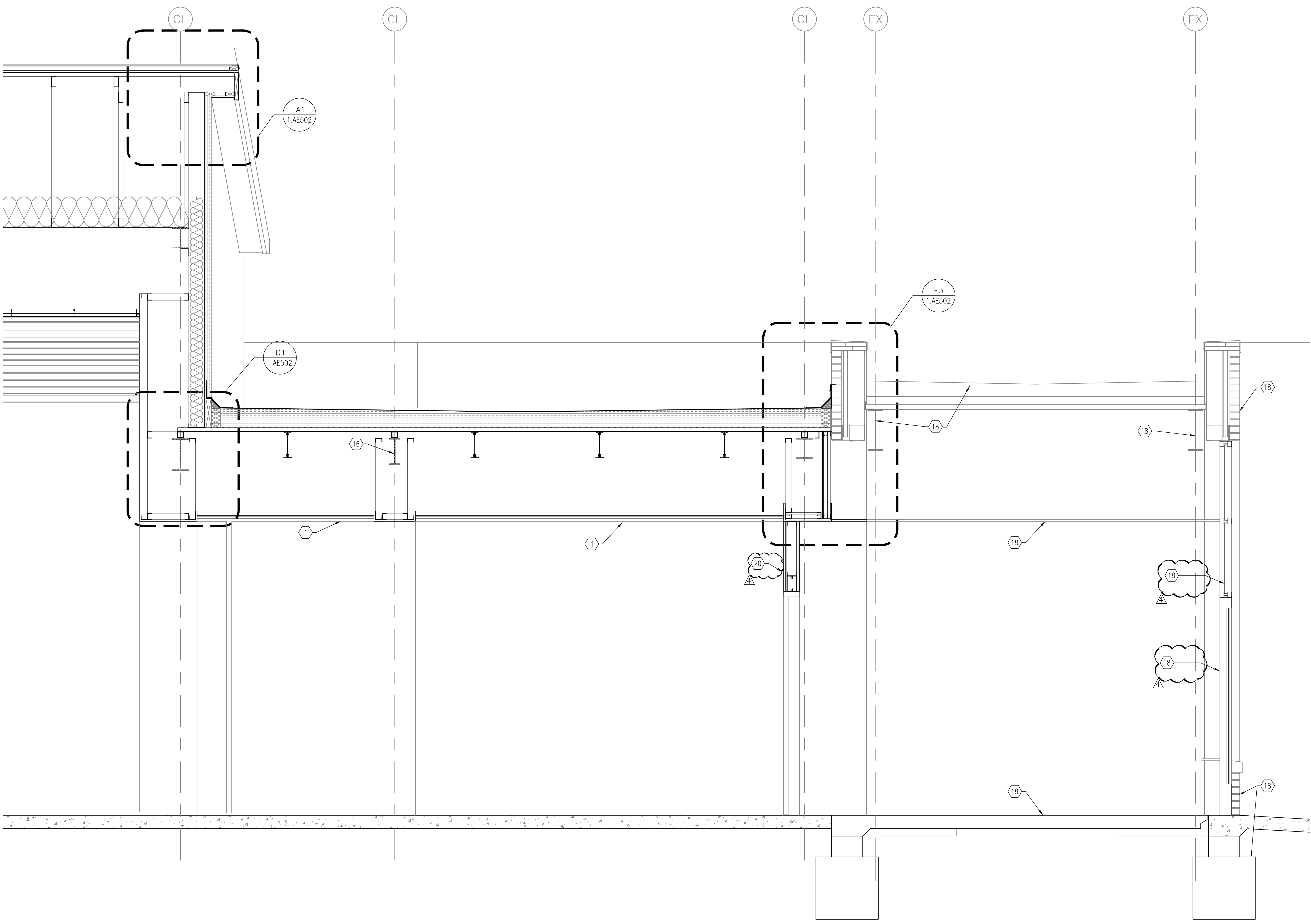

FI SURGERY VESTIBULE SECTION  
3/4"=1'-0"

- NOTES**
- REFER TO 1.AE001 FOR ARCHITECTURAL SYMBOLS AND ABBREVIATIONS.
  - REFER TO MECHANICAL, ELECTRICAL, AND PLUMBING SHEETS FOR SPECIFIC DEMOLITION NOTES FOR OTHER THAN GENERAL DEMOLITION.
  - REFER TO 1.ID101 FOR FINISH PLAN.
  - REFER TO 1.ID601 FOR FINISH SCHEDULE AND LEGEND.
  - REFER TO 1.AE101 FOR NEW WORK PLAN.
  - REFER TO 1.AI501 FOR WALL PROTECTION INFORMATION.
  - COORDINATE WORK WITH OTHER TRADES.
- KEYNOTES**
- 5/8" TYPE-X GYP BOARD.
  - ALUMINUM GUTTER.
  - TREATED WOOD BLOCKING
  - 4" FACE BRICK TO MATCH NEW HOSPITAL.
  - CAST STONE SILL.
  - GROUND FACE BLOCK.
  - BUILDING WRAP STYLE VAPOR BARRIER.
  - R-5 FOAM INSULATION FOIL FACED EXTERIOR SHEATHING.
  - 6" BATT INSULATION R-19 MIN.
  - STEEL JOIST; REFER TO STRUCTURAL DWGS. FOR DETAILS.
  - ASPHALT SHINGLE ROOF OVER 15# FELT, (2) LAYERS OF 1/2" SHEATHING WITH 1x2 VERTICAL PURLINS BETWEEN @ 16" O.C., & 22GA 1.5B METAL DECK.
  - HVAC DUCTS; REFER TO MECHANICAL DWGS. FOR DETAILS.
  - WOOD LOOK GRILL CEILING PANEL SYSTEM.
  - ALUMINUM ENTRY DOOR; REFER TO 1.AI601 FOR DOOR SCHEDULE.
  - THERMALLY BROKE ALUMINUM WINDOW FRAME W/ 1" INSULATED GLASS; SEE WINDOW ELEVATIONS FOR DETAILS.
  - STRUCTURAL MEMBER; REFER TO STRUCTURAL DWGS. FOR DETAILS.
  - AUTOMATED WINDOW SCREENS FOR CLERESTORY WINDOWS.
  - EXISTING BUILDING CONSTRUCTION TO REMAIN.
  - INSTALL 5/8" GYP BOARD ON 3-5/8" METAL STUDS IN EXISTING DEMOLISHED WINDOW FRAME.
  - INSTALL 2 HOUR RATED SHAFT WALL WITH 2-1/2" CH STUDS.
  - RECESSED WALK OFF MAT. SEE DETAIL B6/1.1D501
  - RIGID ROOF INSULATION. R-30 MIN.
  - 2 PIECE ADJUSTABLE MASONRY ANCHORS @ 16" O.C., EACH WAY.
  - BRICK VENTS @ 40" O.C. MAX.
  - PRE-MANUFACTURED RIDGE VENT-CONTINUOUS
  - CONCRETE FOOTING AND FOUNDATIONS. REFER TO STRUCTURAL DWGS. FOR DETAILS.
  - 12" BATT INSULATION. R-30 MIN.
  - INSULATION BAFFLE
  - 1/2" FIRE TREATED OSB
  - METAL DECK. REFER TO STRUCTURAL DWGS. FOR DETAILS.
  - FLASHING WITH WEEPS @ 16" O.C. MAX.
  - UNDER SLAB RIGID INSULATION. 3'-0" WIDE, R-7 MIN.
  - CONCRETE FLOOR SLAB ON 4" GRANULAR FILL OVER VAPOR BARRIER.
  - RIGID ROOF INSULATION WITH TAPERED INSULATION.
  - SINGLE PLY ROOF MEMBRANE.
  - RIGID INSULATION R-20 MINIMUM.
  - METAL STUD ROOF TRUSSES, SEE STRUCTURAL DWGS. FOR DETAILS.
  - TAPERED INSULATION.
  - EXISTING WALL CONSTRUCTION.
  - 2" LINEAR DIFFUSER.
  - EXTERIOR GYPBOARD WITH EIFS COATING.
  - TAPERED WOOD PANEL CEILING SYSTEM. SEE RCP FOR DETAILS.
  - COMPOSITE METAL PANEL

FULLY SPRINKLERED  
BID DOCUMENTS 08-23-2013

Revision		01-10-14	CONSULTANTS:		ARCHITECT/ENGINEERS:	<div><div>PARADIGM</div><div>ENGINEERS AND CONSTRUCTORS</div></div> <div>200 Envoy Circle #201, Louisville KY 40299 - PH: 502.339.8511 - www.paradigmusa.com</div>	<div><div>COMMONWEALTH OF PENNSYLVANIA</div><div>REGISTERED PROFESSIONAL</div><div>BLAINE VAN GANSBEKE</div><div>ENGINEER</div><div>No. PE079636</div></div>	Drawing Title:		Project Number:		Office of Construction and Facilities Management
Revision		03-18-14						BUILDING AND WALL SECTIONS		595-11-125		
Revision		04-02-14						Approved Project Director		Building Number:		
Revision		04-04-14								1		
							Location: LEBANON VAMC		Drawing Number:		1AE305	
					700 SOUTH LINCOLN AVE, LEBANON PA 17042-7829							
Revisions		Date					Date:		Checked:	Drawn:		
							06-28-2013		BYG	FW		