

1 SITE DEMOLITION AND EROSION CONTROL PLAN

CSHQ C.W. MOORE PLAZA
250 S. 5TH ST. BOISE, ID 83702
(208) 343-4635 FAX (208) 343-1658
<http://www.cshq.com>



DEPARTMENT OF VETERANS AFFAIRS

ONE EIGHTH INCH = ONE FOOT
ONE QUARTER INCH = ONE FOOT
THREE EIGHTHS INCH = ONE FOOT
ONE HALF INCH = ONE FOOT
THREE QUARTERS INCH = ONE FOOT
ONE INCH = ONE FOOT
ONE AND ONE HALF INCHES = ONE FOOT
THREE INCHES = ONE FOOT

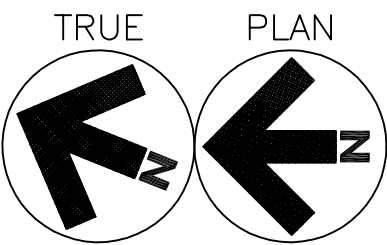
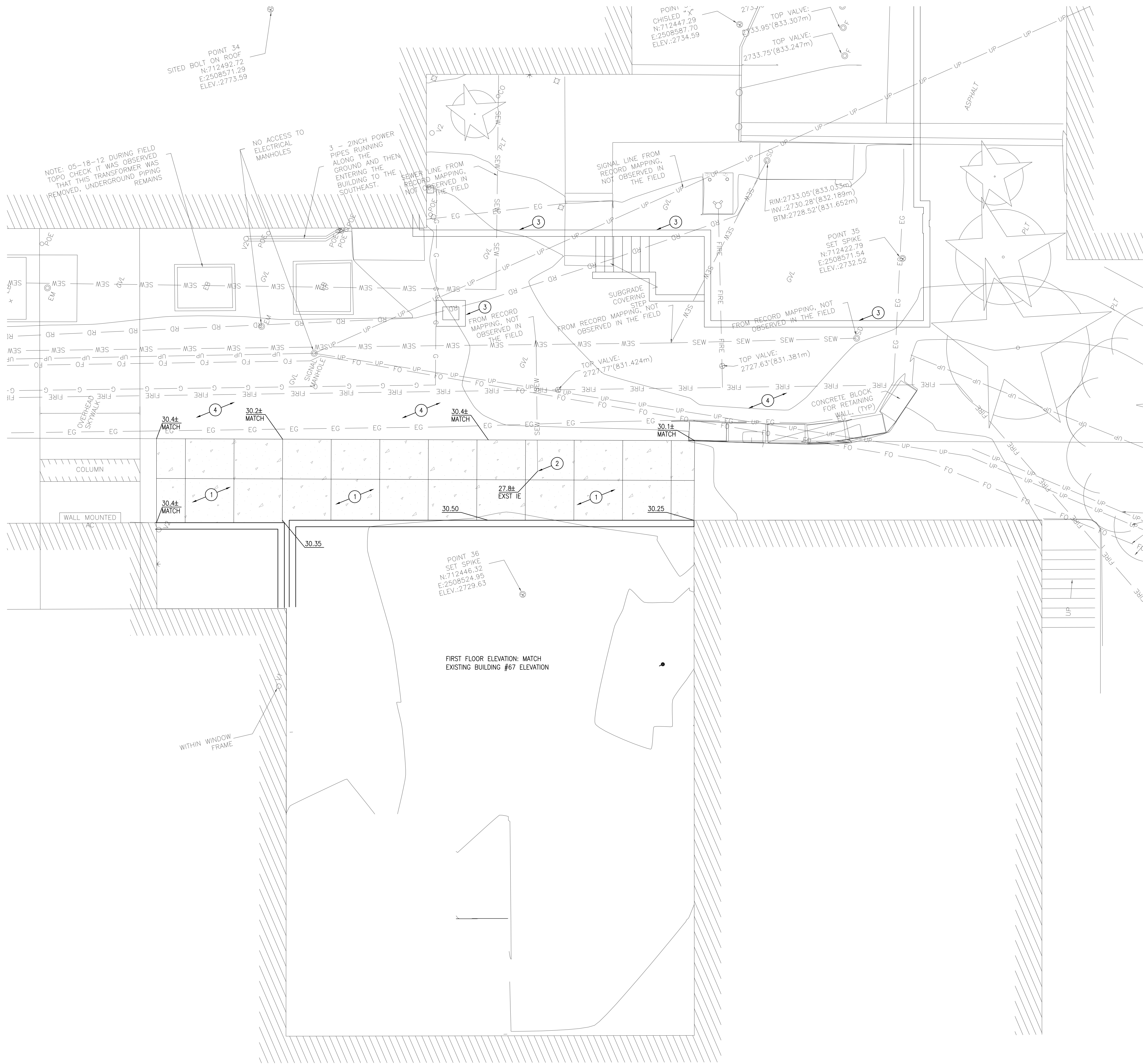

1 GRADING AND DRAINAGE PLAN

SCALE: 1" = 5'

GENERAL NOTES:

- FOR GENERAL LEGEND AND ABBREVIATIONS RE: SDC2.0.
- ALL MATERIAL AND WORK SHALL COMPLY WITH THE GEOTECHNICAL ENGINEERING REPORT OF VAMC BUILDING 67 EXPANSION, 500 WEST FORT STREET, BOISE, IDAHO BY MATERIALS TESTING & INSPECTION, SEALED ON JUNE 7, 2012, MTL FILE NUMBER B120465G, AND ALL ADDENDUMS TO THIS REPORT.
- CONCRETE SIDEWALKS SHALL HAVE 3500 PSI (28 DAY STRENGTH) WITH 5%-7% AIR ENTRAINED CONCRETE.
- COMPACTION SHALL COMPLY WITH THE GEOTECHNICAL REPORT.
- SIDEWALK SLOPES SHALL NOT EXCEED 3% IN THE DIRECTION OF TRAVEL WITHOUT HANDRAILS. CROSS SLOPE SHALL NOT EXCEED 2% IN ANY INSTANCE.
- ADD 2700 TO SPOT ELEVATIONS FOR TRUE ELEVATION.

SHEET NOTES:

- 4" CONCRETE SIDEWALK PER ISPCW SD-709, RE: GENERAL NOTE E.
- CONNECT BUILDING ROOF DRAIN TO EXISTING STUB. FIELD VERIFY DEPTH AND COORDINATE WITH PLUMBING CONTRACTOR TO PROVIDE APPROPRIATE INVERT FROM BUILDING.
- BUILDING 65 EXPANSION SHOWN AS DESIGNED BY OTHERS.
- REPLACE ALL FINISHED SURFACES, LANDSCAPE AREAS, AND IRRIGATION COMPONENTS IMPACTED BY NEW CONSTRUCTION BACK TO ORIGINAL CONDITION. REPLACEMENT AREA VARIES DUE TO CONSTRUCTION ACTIVITY AND LIMIT OF CONSTRUCTION ACTIVITIES. COORDINATE WITH COTR.

LEGEND:

CONCRETE SIDEWALK

REVISIONS	DATE

CSHQ

C.W. MOORE PLAZA
250 S. 5TH ST. BOISE, ID 83702
(208) 343-4635 FAX (208) 343-1858
http://www.cshqa.com

JEFF T. WARD, P.E.
C.W. MOORE PLAZA
250 S. 5TH ST
BOISE, IDAHO
PHONE: 208-343-4635 FAX: 208-343-1858
THESE DRAWINGS AND SPECIFICATIONS, AS INSTRUMENTS OF SERVICE, ARE AND SHALL REMAIN THE PROPERTY OF THE ARCHITECT. ENGINEER WHETHER THE PROJECT FOR WHICH THEY ARE MADE IS EXECUTED OR NOT. THESE DRAWINGS AND SPECIFICATIONS SHALL NOT BE USED BY ANY PERSON OR ENTITY ON OTHER PROJECTS, FOR ADDITIONS TO THIS PROJECT, OR COMPLETION OF THIS PROJECT WHEN PHASED WITHOUT THE WRITTEN CONSENT OF CSHQA OR ITS AFFILIATES. Copyright © 2013

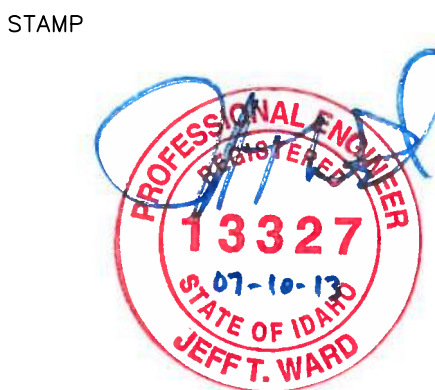

CAD FILE NAME:
531-320_C2.0.DWG
XREF FILE NAME:
531-320_30X42TLBK.DWG
531-320_XSITEBASE.DWG
531-320_XSITESURV.DWG

DRAWING TITLE	
GRADING AND DRAINAGE PLAN	
APPROVED: CHIEF OF FACILITY MANAGEMENT SERVICE	
APPROVED: MEDICAL CENTER DIRECTOR	

PROJECT TITLE	
BOISE VAMC BUILDING 67 EXPANSION	
BUILDING NUMBER	CHECKED
67	JTW
DRAWN	JTW
LOCATION	
VAMC BOISE, IDAHO	

DATE
07/12/2013
PROJECT NO.
531-320
DRAWING NO.
C2.0
DWG 09 OF 191

