

[illegible]

0 KEY PLAN - BLDG. 1 THIRD FLOOR  
SCALE: N.T.S.

--	--
--	--
--	--
--	--
--	--
--	--
QUANTIFIED RADIATOR PANEL ABATEMENT	2014/04/29
100% FINAL DESIGN	2014/04/04
Revisions:	Date

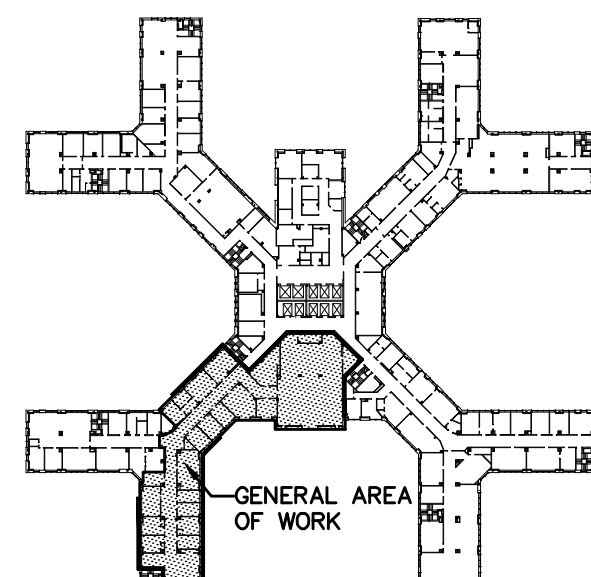

**Engineering and  
Land Surveying, P.C.**

1533 Crescent Road - Clifton Park, NY 12065



**HA2F**  
CONSULTANTS IN ENGINEERING  
1 VAN PATTEN DR., CLIFTON PARK, N.Y.  
12065 (518) 877-8566

 Department of  
Veterans Affairs