

180 E. BROADWAY BLVD  
TUCSON, AZ 85701  
520-624-3342 P  
520-624-3047 F  
WWW.AVIARDESIGN.COM

[illegible]

REVISIONS	
NO.	DATE DESCRIPTION
REV1	
REV2	
REV3	
REV4	
REV5	
REV6	

**CLIENT:**  
VA CENTRAL CALIFORNIA HEALTH CARE SYSTEM

**PROJECT:**  
MENTAL HEALTH 1

**NOTE: ALL MEASUREMENTS ARE SUBJECT TO VERIFICATION BY THE CONTRACTOR. NOTIFY AVIAR DESIGN IN THE EVENT OF DISCREPANCIES. ALL PLANS, DRAWINGS AND SPECIFICATIONS ARE THE PROPERTY OF AVIAR DESIGN, AND MAY NOT BE REPRODUCED WITHOUT THE WRITTEN CONSENT OF AVIAR DESIGN.**

PROJECT NUMBER:14-002  
CREATED ON DATE:1-Apr-14  
PLOTTED DATE: 3-Apr-14  
SCALE: AS NOTED  
DRAWN BY: SME  
CHECKED BY:

1 OF 3

SCALE: 1/4" = 1'-0"

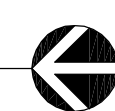

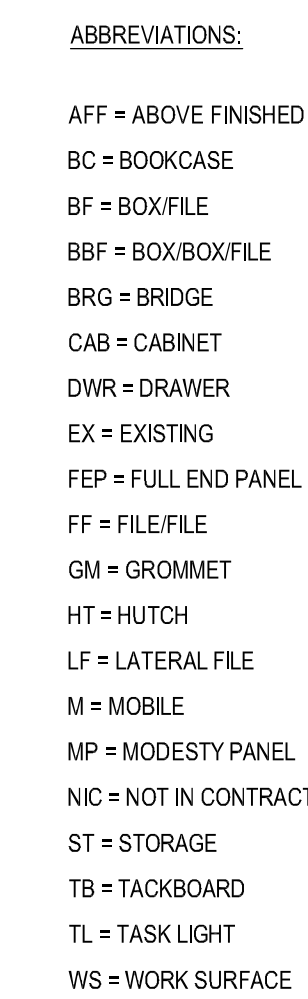

**GENERAL NOTES:**

1. IT IS THE RESPONSIBILITY OF THE INSTALLER TO FOLLOW ALL MANUFACTURER'S INSTALLATION GUIDELINES.
2. FOR ALL WALL-MOUNTED ITEMS IT IS THE RESPONSIBILITY OF THE INSTALLER TO ENSURE THAT ALL ITEMS ARE SECURELY FASTENED TO THE WALL STUDS.
3. ALL WORKSURFACES TO BE MOUNTED AT 29" AFF UNLESS OTHERWISE NOTED.
4. ALL OVERHEAD STORAGE UNITS TO BE MOUNTED AT 50" AFF TO BOTTOM UNLESS OTHERWISE NOTED.
5. INSTALL WORKSURFACE FLAT BRACKETS AS REQUIRED FOR A CORRECT AND SAFE INSTALLATION.
6. FOR PANELS OR PANEL SIDE WITHOUT AN DUPLEX OR DATA SYMBOLS, THERE SHALL BE NO CUT OUTS IN BASE TRIM.

[illegible]

REVISIONS	
NO.	DATE DESCRIPTION
REV1	
REV2	
REV3	
REV4	
REV5	
REV6	

CLIENT: VA CENTRAL CALIFORNIA HEALTH CARE SYSTEM  
PROJECT: MENTAL HEALTH 1

**NOTE: ALL MEASUREMENTS ARE SUBJECT TO VERIFICATION BY THE CONTRACTOR. NOTIFY AVIAR DESIGN IN THE EVENT OF DISCREPANCIES. ALL PLANS, DRAWINGS AND SPECIFICATIONS ARE THE PROPERTY OF AVIAR DESIGN, AND MAY NOT BE REPRODUCED WITHOUT THE WRITTEN CONSENT OF AVIAR DESIGN.**

PROJECT NUMBER:14-002  
CREATED ON DATE:1-Apr-14  
PLOTTED DATE: 3-Apr-14  
SCALE: AS NOTED  
DRAWN BY: SME  
CHECKED BY:

**2 OF 3**

SCALE: 1/4" = 1'-0"





180 E. BROADWAY BLVD.  
TUCSON, AZ 85701  
520-624-3342 P  
520-624-3047 F  
WWW.AVIARDESIGN.COM

APPROVED		NAME							

REVISIONS	NO.	DATE	DESCRIPTION						
	REV1								
	REV2								
	REV3								
	REV4								
	REV5								
	REV6								
	REV7								

CLIENT: VA CENTRAL CALIFORNIA HEALTH CARE SYSTEM  
PROJECT: MENTAL HEALTH 1

NOTE: ALL MEASUREMENTS ARE SUBJECT TO VERIFICATION BY THE CONTRACTOR. NOTIFY AVIAR DESIGN IN THE EVENT OF DISCREPANCIES. ALL PLANS, DRAWINGS AND SPECIFICATIONS ARE THE PROPERTY OF AVIAR DESIGN, AND MAY NOT BE REPRODUCED WITHOUT THE WRITTEN CONSENT OF AVIAR DESIGN.

PROJECT NUMBER:14-002

CREATED ON DATE:1-Apr-14

PLOTTED DATE: 3-Apr-14

SCALE: AS NOTED

DRAWN BY: SME

CHECKED BY:

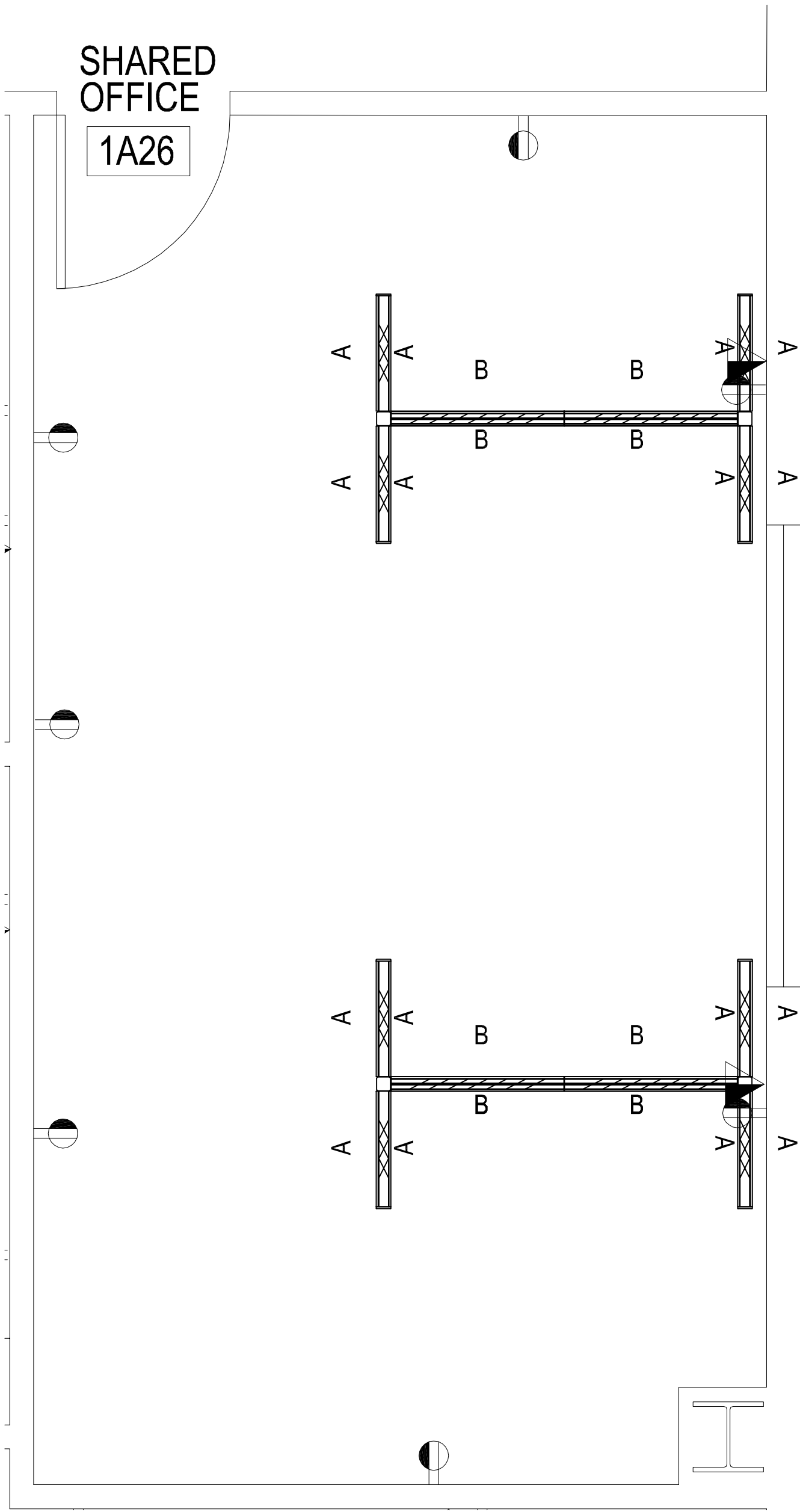

PANEL PLAN  
SCALE: 1/2" = 1'-0"

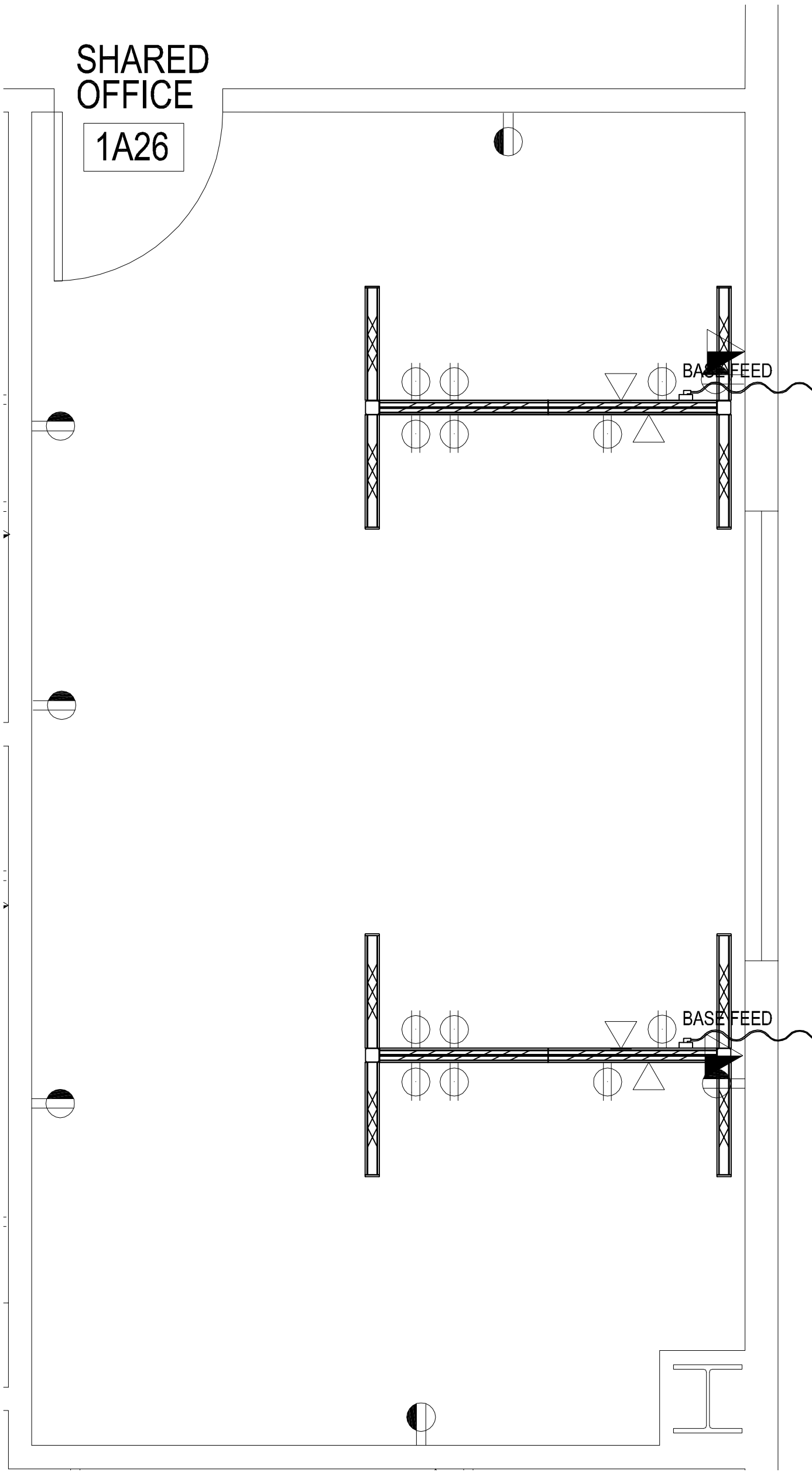

PANEL ELECTRICAL PLAN  
SCALE: 1/2" = 1'-0"

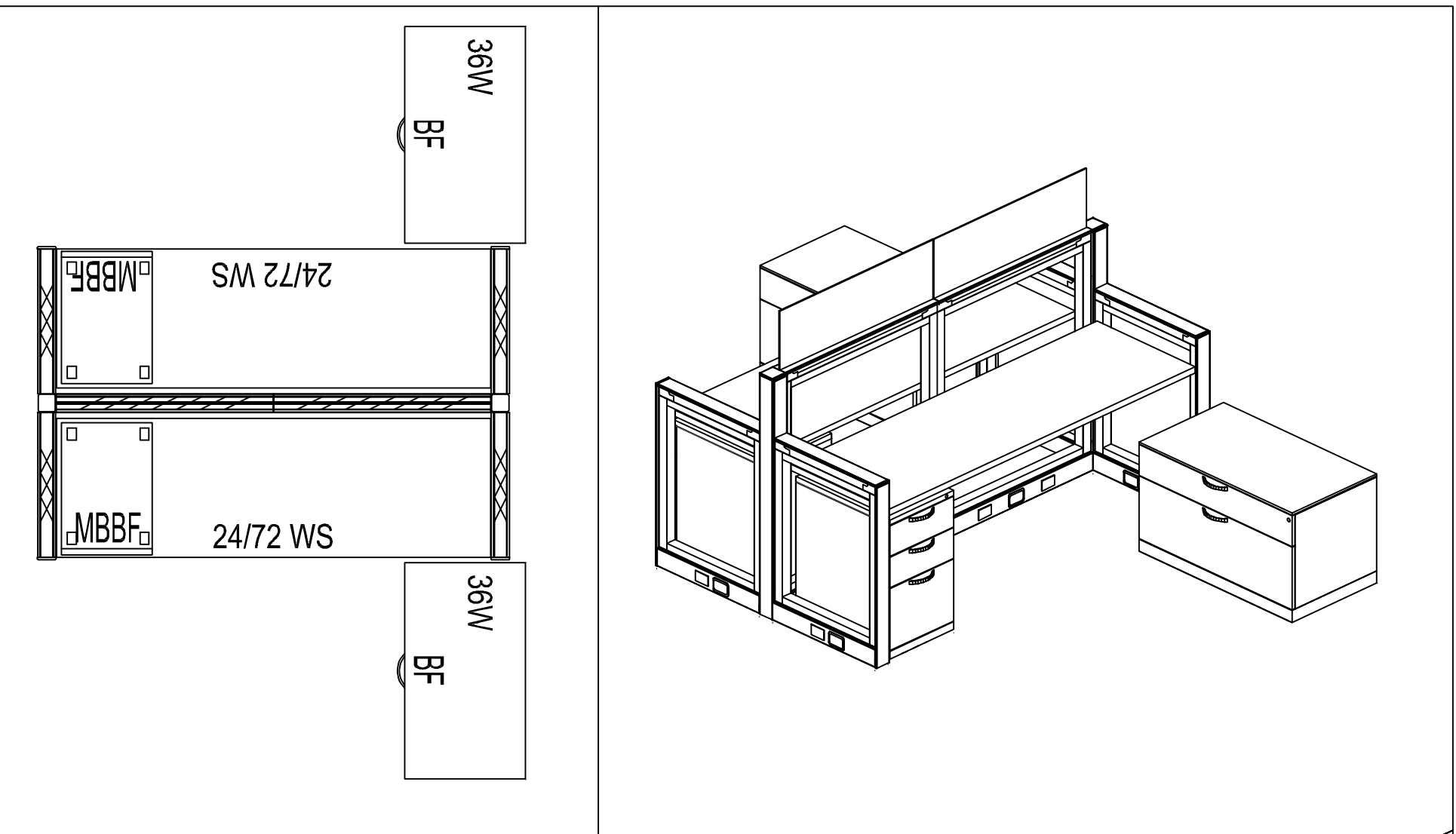

TYPICAL 03  
SCALE: 1/2" = 1'-0"

PANEL FRAMES SHOWN FOR REFERENCE ONLY. SEE  
PANEL PLAN / ELEVATIONS FOR EXACT CONFIGURATION.

ABBREVIATIONS:

AFF = ABOVE FINISHED FLOOR  
BC = BOOKCASE  
BF = BOX/FILE  
BBF = BOX/BOX/FILE  
BRG = BRIDGE  
CAB = CABINET  
DWR = DRAWER  
EX = EXISTING  
FEP = FULL END PANEL  
FF = FILE/FILE  
GM = GROMMET  
HT = HUTCH  
LF = LATERAL FILE  
M = MOBILE  
MP = MODESTY PANEL  
NIC = NOT IN CONTRACT  
ST = STORAGE  
TB = TACKBOARD  
TL = TASK LIGHT  
WS = WORK SURFACE

GENERAL NOTES:

- IT IS THE RESPONSIBILITY OF THE INSTALLER TO FOLLOW ALL MANUFACTURER'S INSTALLATION GUIDELINES.
- FOR ALL WALL MOUNTED ITEMS, IT IS THE RESPONSIBILITY OF THE INSTALLER TO ENSURE THAT ALL ITEMS ARE SECURELY FASTENED TO THE WALL STUDS.
- ALL WORKSURFACES TO BE MOUNTED AT 29" AFF UNLESS OTHERWISE NOTED.
- ALL OVERHEAD STORAGE UNITS TO BE MOUNTED AT 50" AFF TO BOTTOM UNLESS OTHERWISE NOTED.
- INSTALL WORKSURFACE FLAT BRACKETS AS REQUIRED FOR A CORRECT AND SAFE INSTALLATION.
- FOR PANELS OR PANEL SIDE WITHOUT ANY DUPLEX OR DATA SYMBOLS, THERE SHALL BE NO CUT OUTS IN BASE TRIM.

PANEL SYMBOLS:

BASE POWER AND DATA  
BELT LINE TILE POWER AND DATA  
TOP TILE POWER  
PANEL ELEVATION TYPE  
PANEL WIDTH / PANEL POWER  
PANEL ELEVATION TYPE

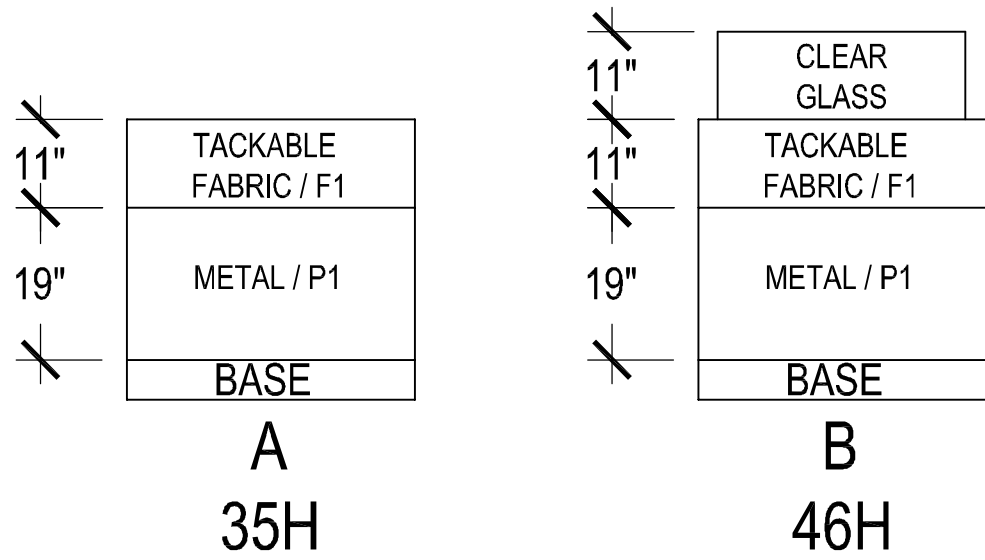

PANEL ELEVATIONS  
SCALE: 1/2" = 1'-0"