

FIRE CODE INFORMATION

APPLICABLE CODE: NFPA 101 LIFE SAFETY CODE, 2009 EDITION

CONSTRUCTION TYPE I: FULLY SPRINKLERED

OCCUPANCY TYPE: BUSINESS (CHAPTER 38)

REQUIRED FIRE RESISTANCE RATINGS:
COLUMN: 3 HOURS
FLOOR BEAM: 2 HOURS
ROOF BEAM: 2 HOURS
FLOOR-CEILING: 2 HOURS
ROOF-CEILING: 2 HOURS
EXIT CORRIDORS: NO FIRE RATING, SELF-LATCHING DOORS ARE REQUIRED. WALLS AND CEILING SHALL BE CONSTRUCTED TO RESIST PASSAGE OF SMOKE

RATED WALLS WALLS: 2 HOURS; 1 HOURS AROUND STORAGE ROOMS IN EXCESS OF 100 SQFT

SHAFTS: 2 HOURS

FIRE PROTECTION LEGEND

- FW-2W-2 2 HOUR FIRE WALL
- FW-1W-1 1 HOUR FIRE WALL
- SR SR SMOKE RESISTANT
- FEC FIRE EXTINGUISHER
- LIMITS OF CONSTRUCTION
- ← EXIT

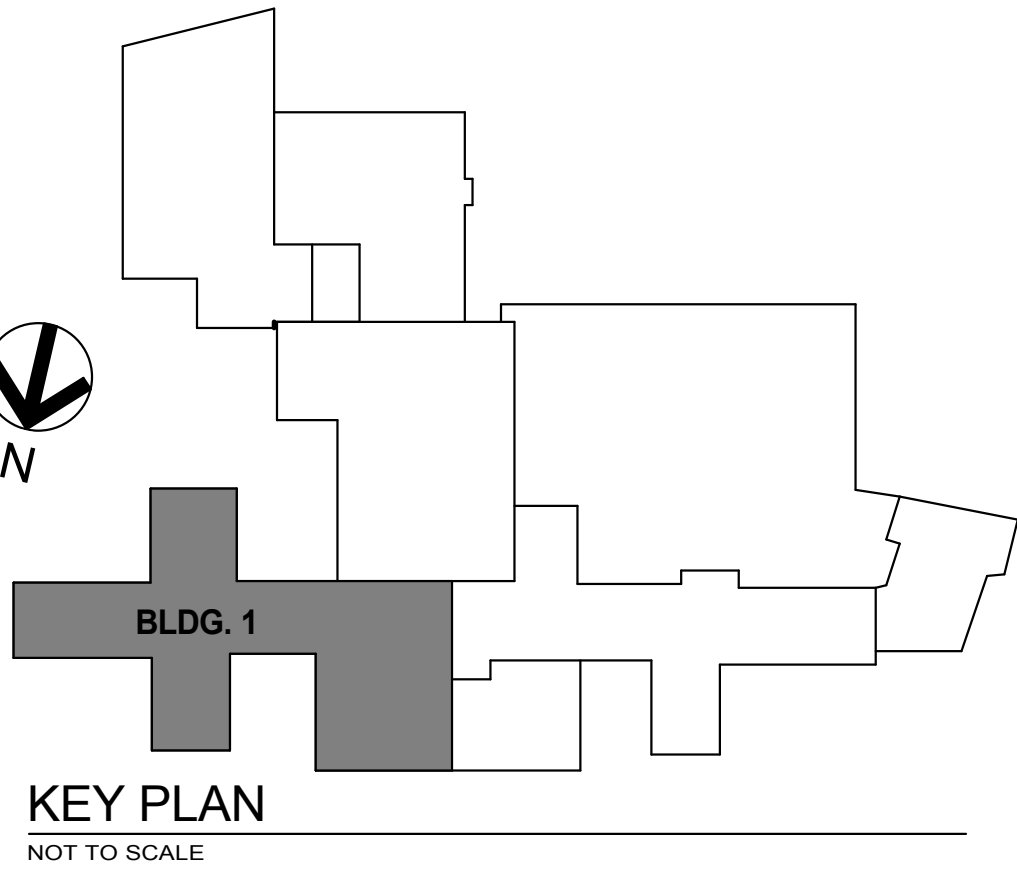

1-B

Veterans Administration

Project Title: RENOVATE AND EXPAND SPACE FOR PATIENT SUPPORT AREAS		Date: 12-17-2012 CONSTRUCTION DOCUMENTS	
Building Number: 1	Checked: EAS	Project No.: DVA# 636-311 S-H# 110240-0	Drawing No.: 1-B-FC1
Location: Enter address under Management tab - Project Settings - Project Information - Project Address		Dwg. 1 of 2	

Drawing Title: FIRE CODE PLAN	
Approved: Division Chief	Approved: Service Director

SHIVEHATTERY
ARCHITECTURE+ENGINEERING
2834 Northgate Drive | Iowa City, Iowa 52245
319.354.5040 | fax 319.354.6921 | shive-hattery.com
Iowa | Illinois | Missouri

FIRE CODE PLAN
1/8" = 1'-0"

Revisions	Date