

PLOT DATE: 5/13/2014 2:02 PM P:\984 VA Ambulatory Surgery Improvements\DWGS\984.00_VAMC-BHM-A413-WALL SECTIONS.dwg

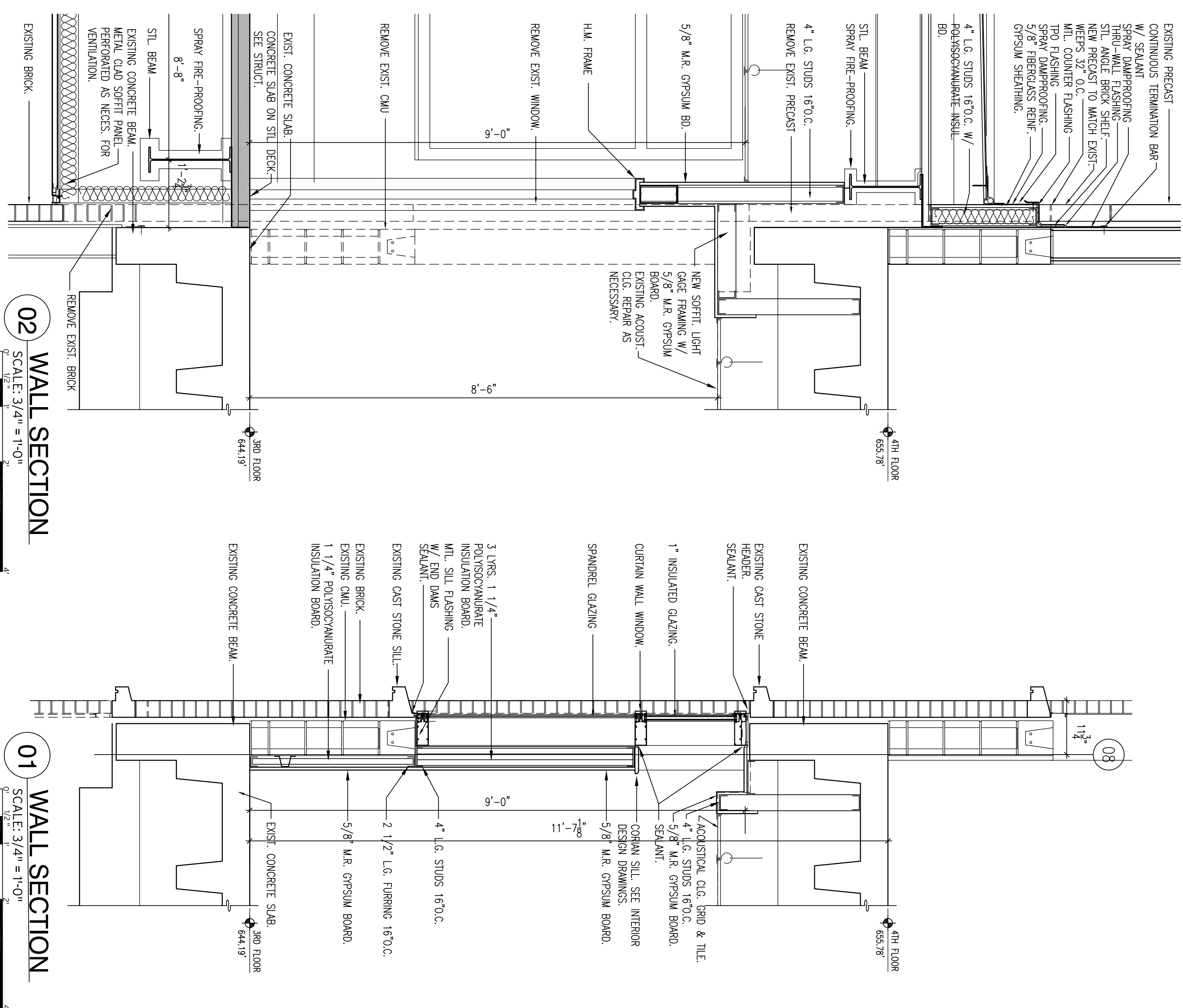

CONSULTING ENGINEERS:

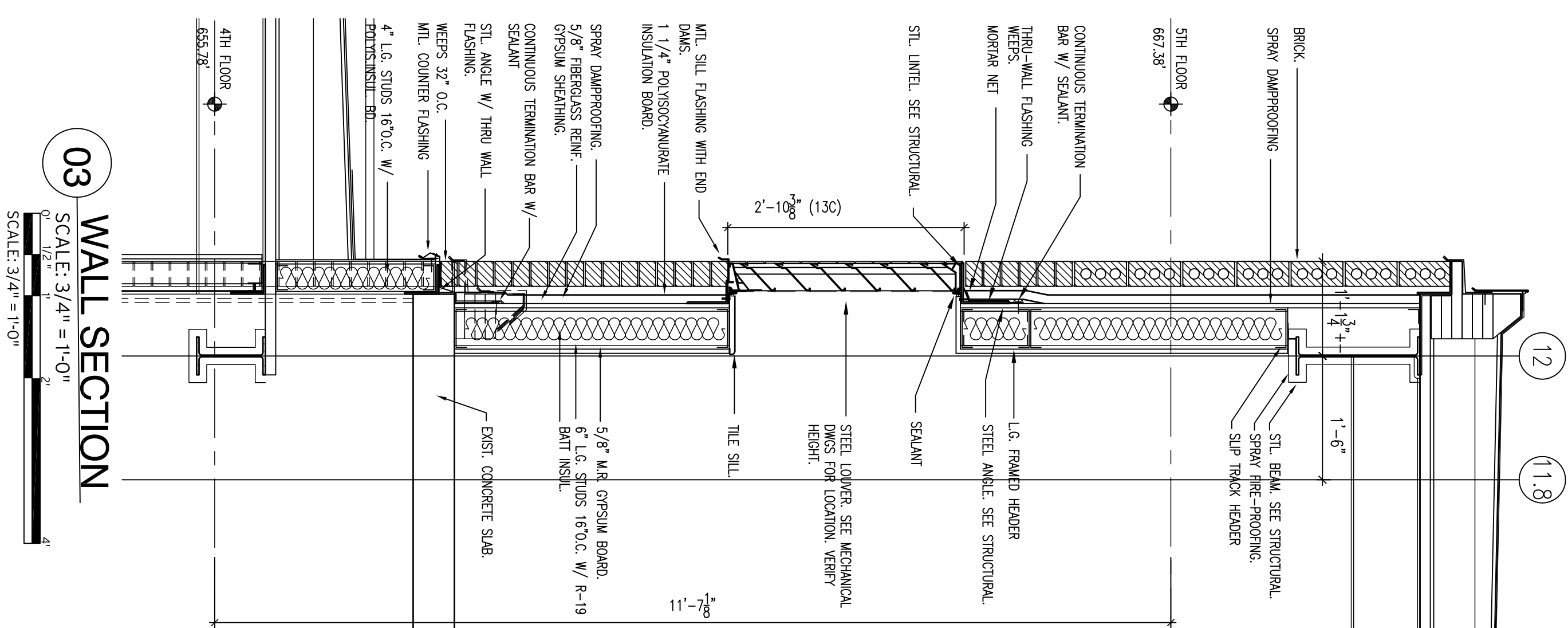
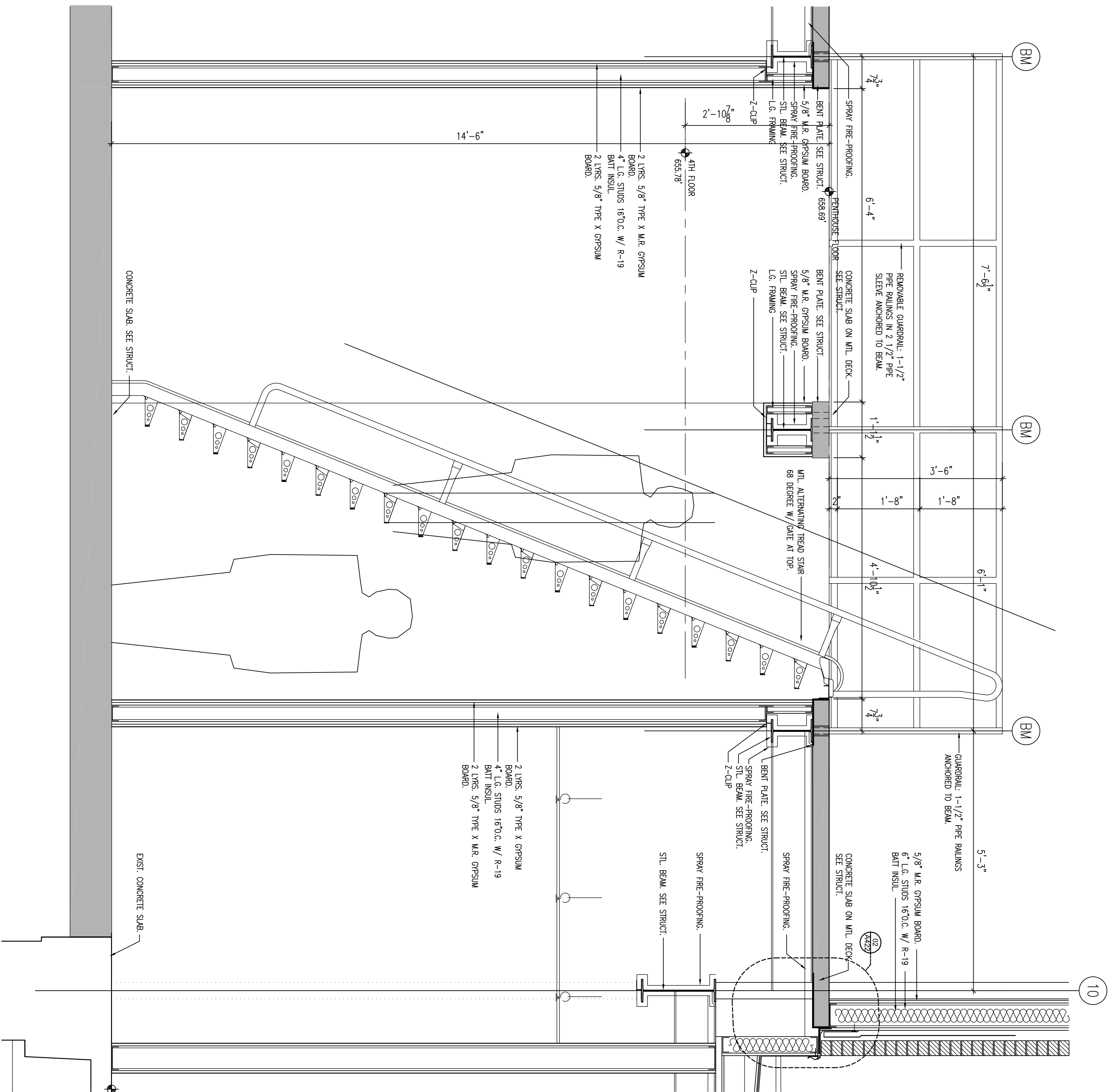

LBYPD, Inc.
Civil and Structural Engineers
716 South 30th Street
Birmingham, AL 35233
Main (205) 251-4500
Fax (205) 324-4181

ARCHITECT:

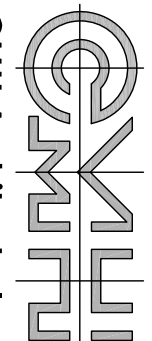

CMH Architects, Inc.
1800 International Park Drive, Suite 300
Birmingham, AL 35243
(205) 969-2696 • TEL
(205) 969-3930 • FAX
www.cmharch.com
Copyright © 2011 CMH Architects, Inc.

PROJECT MANAGEMENT:



1100 Laurel Lane Montgomery, Alabama 36106 Telephone: 334.300.4599

Drawing Title

WALL SECTIONS

Approved: Project Director
James Zellander

Project Title
A/E AMBULATORY SURGERYProject Number
521-328

Drawing Number

DWg. 053 of

**Office of
Construction
and Facilities
Management**

 **Department of
Veterans Affairs**

CONSTRUCTION DOCUMENTS - 100% FINALS FULLY SPRINKLERED