

C1 BASEMENT PHASING AND ICRA PLAN
1/16" = 1'-0"

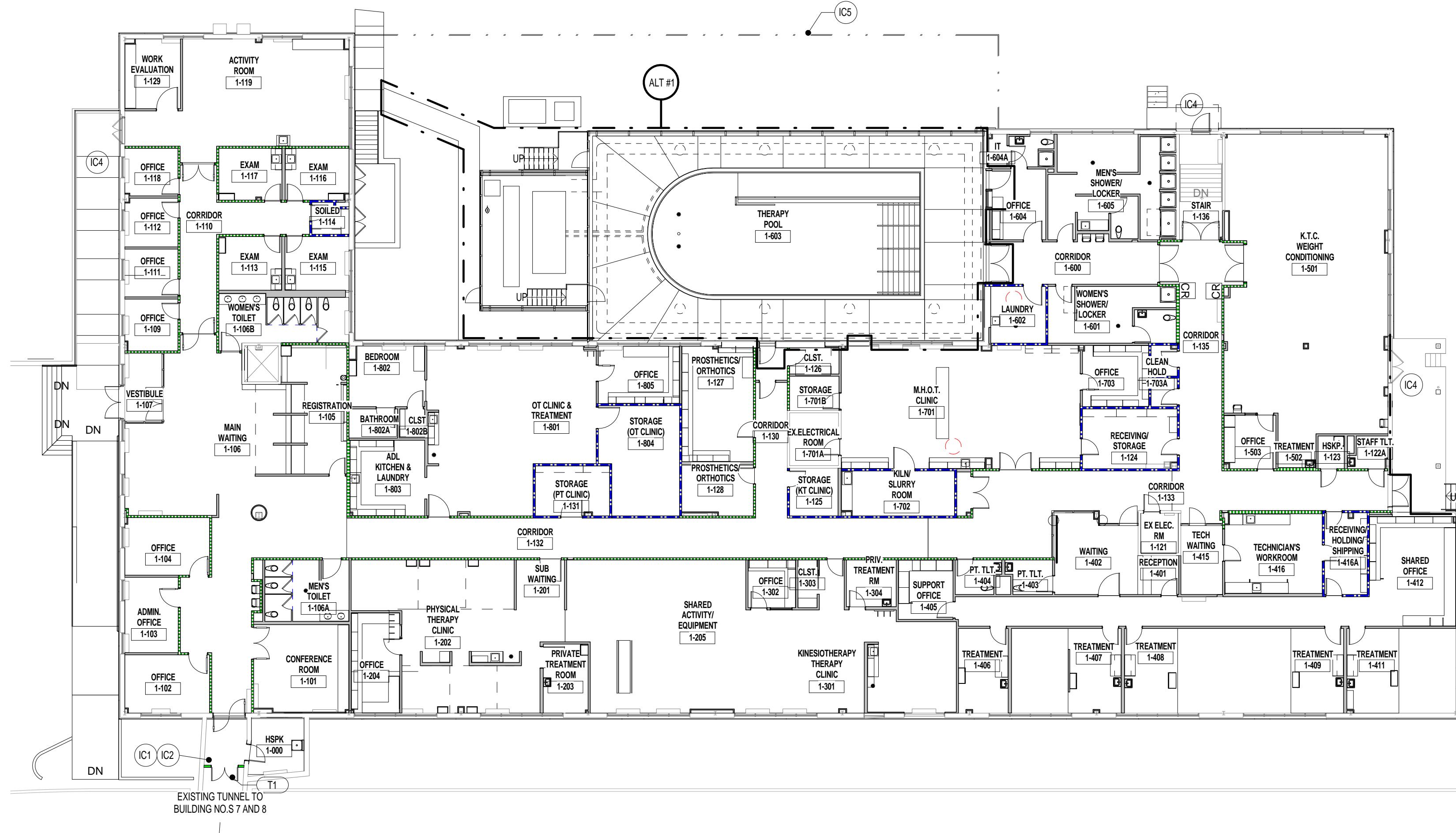

F1 FIRST FLOOR PHASING, ICRA AND ALTERNATES PLAN
1/16" = 1'-0"

ICRA GENERAL NOTES

1. PROVIDE INFECTION CONTROL PRECAUTIONS / CONTAINMENT SYSTEM AS REQUIRED BY HOSPITAL INFECTION CONTROL REPRESENTATIVE FOR ALL AREAS OUTSIDE THE LIMIT OF WORK.

ICRA AND PHASING KEYNOTES

- (IC1) PROVIDE TEMPORARY CONSTRUCTION INFECTION VESTIBULE PER PARTITION TYPE SEE SHEET AE621. PARTITION TO EXTEND TO UNDERSIDE OF DECK.
- (IC2) PROVIDE TEMPORARY DOOR WITH GASKETING TO PREVENT THE MOVEMENT OF DUST.
- (IC3) NOT USED.
- (IC4) CLOSE AND LOCK DOOR TO PREVENT THE MOVEMENT OF DUST.
- (IC5) PROVIDE METAL CHAINLINK FENCE AND GATE TO CONTAIN CONSTRUCTION ZONE. MOUNT VA SIGNAGE REQUIREMENTS PER DETAILS F00801 AND F40001. REFER TO CIVIL DRAWINGS FOR MORE INFORMATION.

ALTERNATES

- ALT #1: Add Alternate #1: Construction and fit out of therapy pool, mechanical area (1-606), pool enclosure (1-603), associated roofing, specialty equipment housed within the pool area, doors 600B, 603, 604B, and sublight 604 are all alternate.
- Mechanical sheets: MH111, MH401, MH503, MH504, MP101, MP111 (all mechanical work related to therapy pool).
- Plumbing sheets: PP101, PP111, PP112, PP113, PP301, PP302 (all plumbing work related to therapy pool).
- Electrical sheets: ED101, E-102, E-103, E-104, E-105, E-601, E-603, E-604 and FA102 (all electrical work related to therapy pool).
- Base bid to include demolition of mechanical unit, slab, and fence (DB), demolition of concrete ramp and canopy (D2, D7, D11), demolition of exterior door near column G4 and subsequent infill of exterior wall.

INFECTION CONTROL RISK MITIGATION RECOMMENDATIONS MATRIX OF PRECAUTIONS FOR CONSTRUCTION AND RENOVATION

Type of Construction / Project Activity Table	
TYPE A	Inspection and Non-Invasive Activities Includes, but is not limited to: <ul style="list-style-type: none">removal of ceiling tiles for visual inspection limited to 1 tile to 50 square feetpainting (but not sanding), wall coveringelectrical trim work, minor plumbing, and activities which do not generate dust or require cutting of walls or access to ceilings other than for visual inspection
TYPE B	Small scale, short duration activities which create minimal dust Includes, but is not limited to: <ul style="list-style-type: none">installation of telephone and computer cablingaccess to chase spacescutting of walls or ceiling where dust migration can be controlled
TYPE C	Work that generates a moderate to high level of dust or requires demolition or removal of any fixed building components or assemblies Includes, but is not limited to: <ul style="list-style-type: none">sanding of walls for painting or wall coveringremoval of floor coverings, ceiling tiles and caseworknew wall constructionminor duct work or electrical work above ceilingsmajor cabling activitiesany activity which cannot be completed within a single work shift
TYPE D	Major demolition and construction projects Includes, but is not limited to: <ul style="list-style-type: none">activities which require consecutive work shiftsrequires heavy demolition or removal of a complete ceiling systemnew construction

Patient Risk Group Table

Group 1 Low Risk	Group 2 Medium Risk	Group 3 High Risk	Group 4 Highest Risk
Office areas (non-clinical)	Cardiology Endocrinology Endoscopy - GI Physical Therapy Radiology/MRI Nuclear Medicine Respiratory Care (except bronchospasm area) Catheters Outpatient areas- clinics and offices (exception: transplant and oncology)	Emergency Room Post Anesthesia Care Units Labor and Delivery Pediatrics Admission/Discharge area Laboratories Pharmacy Inpatient units (not otherwise specified) at all A/E/N locations	All Operating Rooms including Labor and Delivery Anesthesia and Pump areas Central Equipment/Sterile Supply Cardiac Catheterization and Angiography Areas Interventional Radiology Radiation Oncology All Intensive Care Units Neonatal Nurseries, including NICU Dialysis Unit Oncology - inpatient & outpatient Transplant - inpatient & outpatient Pharmacy Administration Negative Pressure Isolation Rooms/areas (including bronchoscopy areas)

Infection Control Matrix - Class of Precautions: Construction Project by Patient Risk

Patient Risk Group	TYPE A	TYPE B	TYPE C	TYPE D
LOW Risk Group 1	I	II	II	III/IV
MEDIUM Risk Group 2	I	II	III	IV
HIGH Risk Group 3	I	III	III/IV	IV
HIGHEST Risk Group 4	III	III/IV	III/IV	IV

Note: Infection Control approval will be required when the Construction Activity and Risk Level indicate that Class III or Class IV control procedures are necessary.

It is the Contractor's Responsibility to provide the following Infection Control Precautions depending upon the Area Class Designation

	During Construction Project	Upon Completion of Project
CLASS I	1. Execute work by methods to minimize raising dust from construction operations. 2. Immediately replace a ceiling tile displaced for visual inspection.	1. Wipe surfaces to remove dust.
CLASS II	1. Includes all activities required by Class I 2. Provide active means to prevent airborne dust from dispersing into atmosphere. 3. Water mist work surfaces to control dust while cutting. 4. Seal unused doors with duct tape. 5. Stock off and seal air vents. 6. Replace adhesive walk-off mats at entrance and exit of work area. Replace used mats in accordance with manufacturer's recommendations. 7. Remove or isolate HVAC system in areas where work is being done to prevent contamination of dust system.	1. Wipe work surfaces with disinfectant. 2. Contain construction waste before transport in tightly covered containers. 3. Wet mop and/or vacuum work areas with HEPA filtered vacuum before leaving work areas. 4. Remove isolation of HVAC system in areas where work is being performed.
CLASS III	1. Includes all activities required by Class II 2. Obtain Infection Control Permit from Hospital Safety Officer or Facilities Management Maintenance and Engineering department before construction begins. 3. Remove or isolate HVAC system in areas where work is being done to prevent contamination of dust system. 4. Complete all critical barriers before construction begins or implement control cube method. 5. Maintain negative air pressure within work site utilizing HEPA-equipped air filtration units. 6. Contain construction waste before transport in tightly covered containers. 7. Cover transport receptacles or carts. Tape covers. 8. Wet mop and/or vacuum with HEPA filtered vacuum before leaving work areas. 9. Remove isolation of HVAC system in areas where work is being performed.	1. Remove barrier materials carefully to minimize spreading of dirt and debris associated with construction. 2. Contain construction waste before transport in tightly covered containers. 3. Cover transport receptacles or carts. Tape covering. 4. Wet mop with disinfectant after barriers are removed. 5. Wet mop with disinfectant after barriers are removed. 6. Remove isolation of HVAC system in areas where work is being performed.
CLASS IV	1. Includes all activities required by Class III 2. Obtain Infection Control Permit from Hospital Safety Officer or Facilities Management Maintenance and Engineering department before construction begins. 3. Isolate HVAC system in areas where work is being done to prevent contamination of dust system. 4. Complete all critical barriers or implement control cube method before construction begins. 5. Maintain negative air pressure within work site utilizing HEPA equipped air filtration units. 6. Seal holes, pipes, conduits, and purchases appropriately. 7. Construct anteroom and require all personnel to pass through this room so they can be vacuumed using a HEPA vacuum cleaner before leaving work site or they can wear doth or paper coveralls that is removed each time they leave the work site. 8. All personnel entering work site are required to wear shoe covers. Shoe covers must be changed each time the worker exits the work area. 9. Place adhesive walk-off mats at entrance to work areas within anteroom. 10. Replace per manufacturer's recommendations. Do not remove barriers from work area until completed project is inspected each by the Hospital Safety Officer, Facilities Management Maintenance and Engineering Department and thoroughly cleaned by the Hospital Environmental Services Department or their contracted Environmental Services Company. Contain construction waste before transport in tightly covered containers. 11. Cover transport receptacles or carts. Tape covering. 12. Vacuum work areas with HEPA filtered vacuums. 13. Wet mop with disinfectant after barriers are removed. 14. Remove isolation of HVAC system in areas where work is being performed.	1. Remove barrier materials carefully to minimize spreading of dirt and debris associated with construction. 2. Contain construction waste before transport in tightly covered containers. 3. Cover transport receptacles or carts. Tape covering. 4. Vacuum work areas with HEPA filtered vacuums. 5. Wet mop with disinfectant after barriers are removed. 6. Remove or isolate HVAC system in areas where work is being performed.

NOTE: SEE SHEET AE-002 FOR ALTERNATES
FULLY SPRINKLERED
ISSUED FOR BID

CONSULTANTS:

Project Manager BRAY MOONEY CONSULTING 410 E. 21 STREET CHESTER, PA. 19013 Tel: (610) 872-3716	Architect ARRAY HEALTHCARE CONSULTING SOLUTIONS 2520 RENAISSANCE BLVD., SUITE 110 KING OF PRUSSIA, PA. 19406 Tel: (610) 270-0599	Structural Engineer WZG, STRUCTURAL ENGINEERS P.O. BOX 24 40 LITTLE ROAD ZIEGLERVILLE, PA. 19482 Tel: (610) 287-5194	MEP/FP Engineer APOGEE CONSULTING GROUP 7330 CHAPEL HILL ROAD, SUITE 202 RALEIGH, NC. 27606 Tel: (919) 859-7420	Civil Engineer GUIDON DESIGN 2453 N DELAWARE STREET INDIANAPOLIS, IN 46205 Tel: (317) 800-6388	Fire Protection Consultant HARRINGTON GROUP 7508 E. INDEPENDENCE BLVD., SUITE 116 CHARLOTTE, NC. 28227 Tel: (704) 531-5077	Cost Estimator BRAY MOONEY CONSULTING 410 E. 21 STREET CHESTER, PA. 19013 Tel: (610) 872-3716	Aquatic Consultant ATLANTIC AQUATIC ENGINEERING 1823 DEEP RUN ROAD PIPERSVILLE, PA. 18447 Tel: (215) 788-0409	Associate Architects W. COOK ARCHITECTS 1251 ROMANVILLE ROAD COATESVILLE, PA. 19320 Tel: (610) 383-4460
---	---	--	--	---	---	--	--	--

PROJECT MANAGER:

Project Number 3627	Scale As indicated
Bray Mooney Consulting	

Drawing Title

FIRST FLOOR PHASING, ICRA AND ALTERNATES PLAN
Approved: Project Director

Project Title

Location		
1400 Black Horse Hill, Coatesville		
Date	Checked	Drawn
1/22/2014	TN	

VA Project Number

542-CSI-203
Building Number 69
Drawing Number AE002
Dwg. 15 of 86

Office of
Facilities
Management

