

A  
three inches = one foot  
1  
0  
6  
B  
one and one half inches = one foot  
2  
0  
6  
C  
one inch = one foot  
2  
0  
6  
D  
three quarters inch = one foot  
4  
0  
6  
E  
one half inch = one foot  
4  
0  
6  
F  
three eighths inch = one foot  
8  
0  
6  
G  
one quarter inch = one foot  
16  
0  
6  
H  
one eighth inch = one foot  
15  
0  
6

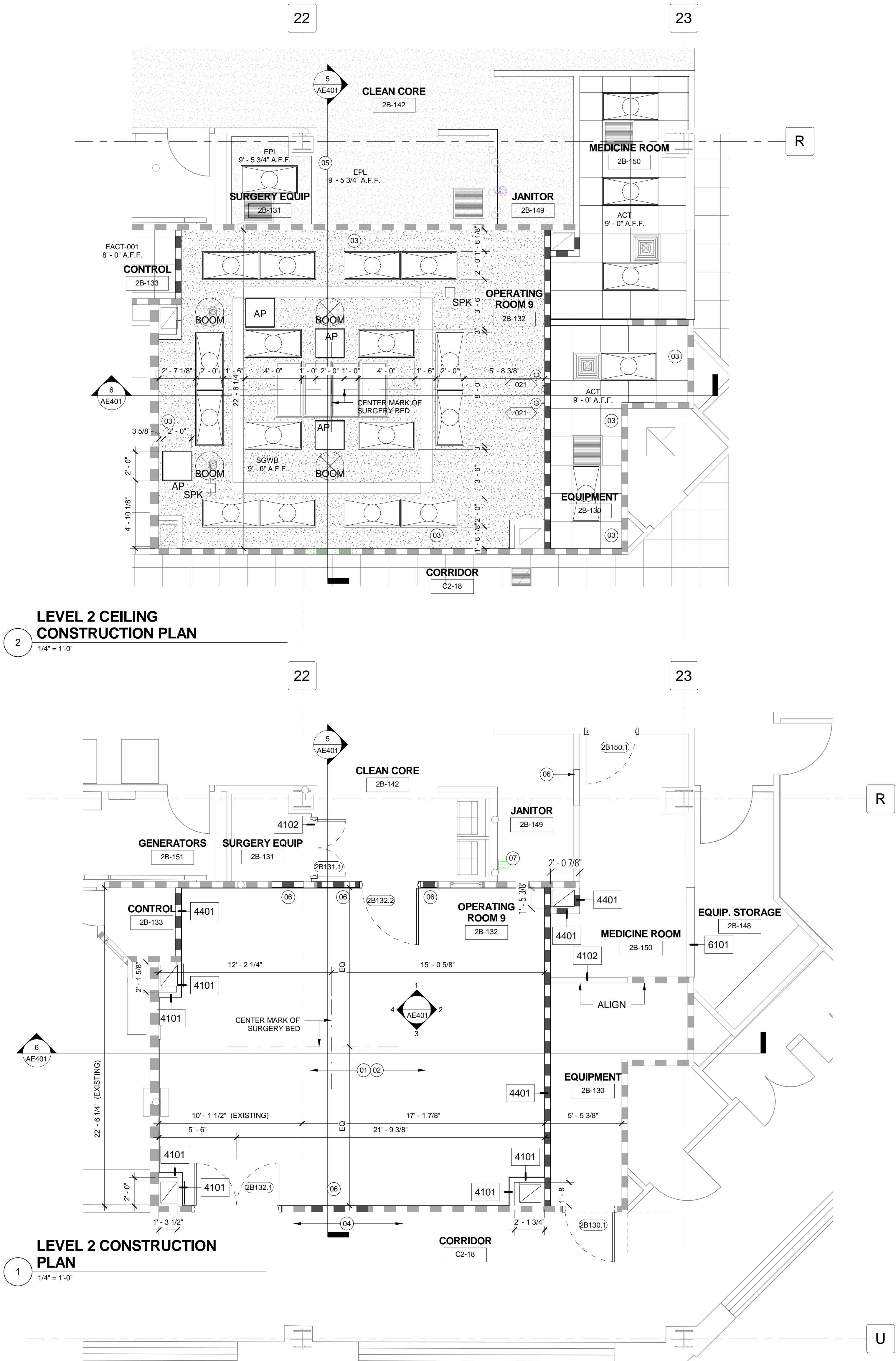

GENERAL PLAN NOTES

1. UNLESS NOTED OTHERWISE, ALL WORK SHOWN IS FURNISHED AND INSTALLED BY CONTRACTOR.
2. UNLESS NOTED OTHERWISE, DIMENSIONS ARE TO FINISHED FACE OF PARTITIONS (EXCLUDING APPLIED FINISHES SUCH AS TILE) AND TO COLUMN CENTER LINES.
3. REFER TO SHEET QH101 FOR MEDICAL EQUIPMENT LAYOUT AND PROCUREMENT REQUIREMENTS.
4. IN NEW GYPSUM WALL BOARD PARTITIONS, PROVIDE CONTROL JOINTS AT 30'-0" O.C. MAX.
5. PROVIDE BLOCKING IN WALL FOR WALL MOUNTED EQUIPMENT SUCH AS MONITORS, TOILET ACCESSORIES, EQUIPMENT, AND WALL PROTECTION BUMPERS AND GUARDS.
6. PROTECT AND MAINTAIN EXISTING FIRE STOPPING AND APPLIED FIREPROOFING. RESTORE WHERE DAMAGED OR REMOVED AS PART OF WORK TO MATCH EXISTING RATING.
7. REFER TO MECHANICAL, PLUMBING AND ELECTRICAL DRAWINGS FOR ADDITIONAL WORK.

CONSTRUCTION PLAN NOTES

- 01 REPAIR PLASTER (AND LEAD SHIELDING) AT DEMOLISHED PARTITION(S)
- 02 REPAIR PLASTER (AND LEAD SHIELDING) AT DEMOLISHED EQUIPMENT
- 03 REPAIR AND EXTEND PLASTER AND WALL FRAMING TO NEW CEILING LINE
- 04 INSTALL NEW WALL PROTECTION BUMPERS AND HANDRAILS TO MATCH EXISTING WHERE GAPS OCCUR
- 05 NEW PARTITION TO EXTEND TO EXISTING PLASTER CEILING AND TERMINATE WITH SEALANT JOINT BOTH SIDES
- 06 INFILL EXISTING OPENING TO MATCH SURROUNDING ADJACENT PARTITIONS (INCLUDING LEAD SHIELDING - IF APPLICABLE)
- 07 REPAIR FLOORING TO MATCH EXISTING AFTER REMOVAL OF JANITOR SINK

RCP LEGEND

- SUPPLY DIFFUSER
- LINEAR SUPPLY DIFFUSER
- RETURN DIFFUSER
- EXHAUST DIFFUSER
- SUSPENDED EQUIPMENT / LIGHT BOOM
- RECESSED LIGHT FIXTURE
- CEILING ACCESS PANEL
- CEILING MOUNTED SPEAKER
- WALL MOUNTED CLOCK

FLOOR PLAN PARTITION LEGEND

- EXISTING PARTITION TO REMAIN
- EXISTING LEAD SHIELDED PARTITION TO REMAIN
- EXISTING ELEMENT TO BE DEMOLISHED
- NEW UNRATED PARTITION
- NEW LEAD SHIELDED PARTITION

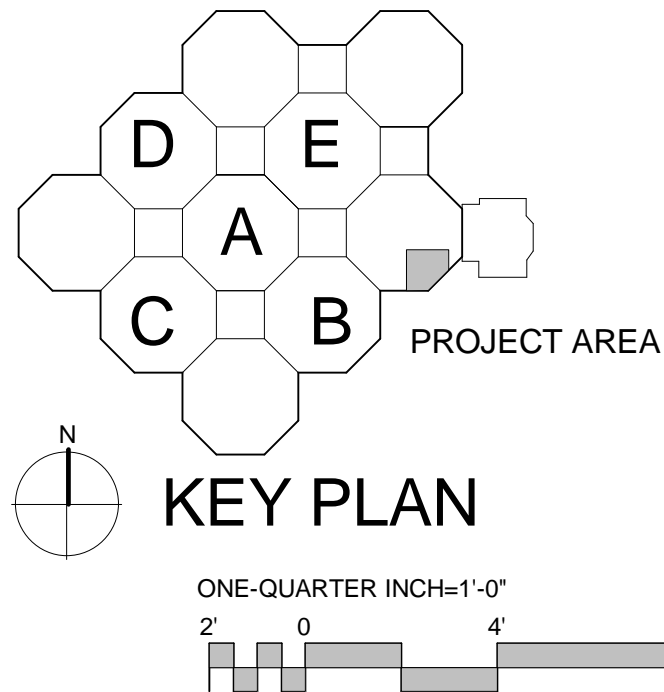

CONSTRUCTION DOCUMENTS SUBMISSION  
FULLY SPRINKLERED

|                                  |  |   |  |  |  |  |  |                                     |  |  |  |
|----------------------------------|--|---|--|--|--|--|--|-------------------------------------|--|--|--|
| CONSULTANTS:                     |  | ARCHITECT/ENGINEERS:  |  | Drawing Title<br><b>LEVEL 2 CONSTRUCTION PLANS</b> |  | Project Title<br><b>CONVERT OR 9-10</b>  |  | Project Number<br><b>598-13-101</b> |  | CENTRAL ARKANSAS<br>VETERANS AFFAIRS<br>HEALTHCARE<br>SYSTEM |  |
|                                  |  |   |  | Approved: Project Director                         |  | Location<br><b>JOHN L. McCLELLAN MEMORIAL VETERANS<br/>HOSPITAL, LITTLE ROCK, ARKANSAS</b> |  | Building Number<br><b>1</b>         |  | Dwg. 6 of 19   |  |
| 1 ADDENDUM #1<br>Revisions: Date |  | BES<br>DESIGN/BUILD<br>BES DESIGN/BUILD, LLC<br>766 Middle St. Fairhope, AL 36532<br>Phone: 251.990.5778<br>Fax: 251.990.3716 |  | Date<br><b>10-30-2013</b>                          |  | Drawn<br><b>BUSH</b>   |  | Checked<br><b>WHITESIDE</b>         |  | Department of<br>Veterans Affairs                            |  |