

<div><div><div></div></div><div>ADD CORRIDOR 09-17 TO PROJECT</div></div> <div>Revisions</div>	WBJ	6-13-14																
			Approved: Patient Safety Nurse				Approved: Energy Engineer				Approved: Safety Manager				Approved: Service Chief			
			Approved: Chief of Police				Approved: Infection Control Officer				Approved: Chief of Staff							
			Approved: Chief of Mental Health Service				Approved: GEMS Coordinator				Approved: Associate Director							

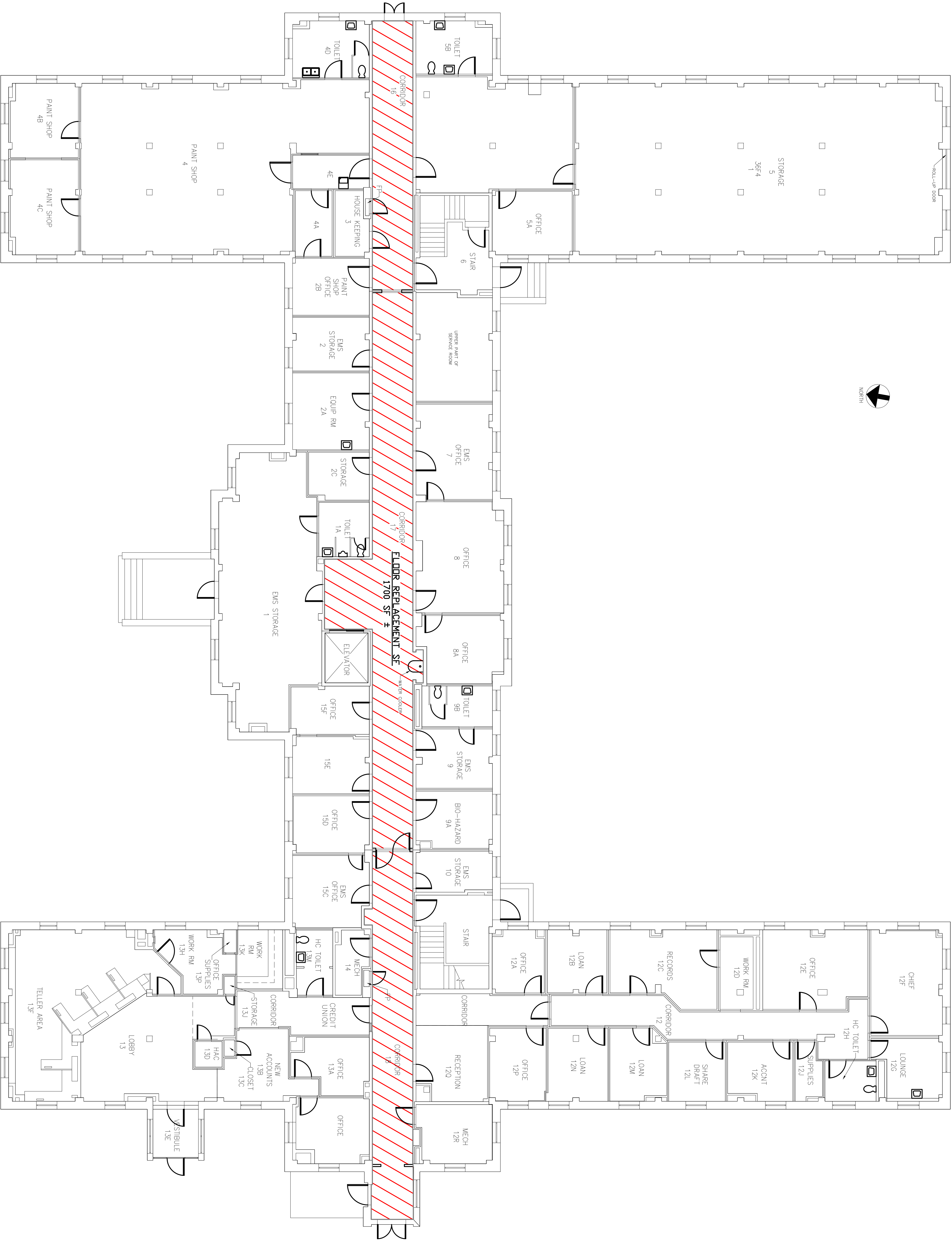

BUILDING 77 BASEMENT FLOOR
NO SCALE

9A

175

ROOM NUMBER
SQUARE FOOTAGE ±

EXISTING TO REMAIN.

VOT TILE TO BE REMOVED AND REPLACED WITH CONCRETE FINISHING PRODUCT. FLOOR AREA TO BE REPLACED, 1700 SF±.

- FLOORING NOTES:**
- AD-1 CONTRACTOR SHALL DEMO VOT/TILE/SETTING BED. CONTRACTOR SHALL RESURFACE FLOOR SURFACE WITH A CEMENTITIOUS FLOOR LEVELING COMPOUND THAT MEETS ALL REQUIREMENTS FOR NEW CONCRETE FLOOR COATING PRODUCT. CONTRACTOR SHALL PROVIDE/INSTALL ALL NEW FLOOR COATING MATERIALS THAT SHALL BE A CEMENTITIOUS URETHANE SYSTEM PRODUCT.
 - AF-1 CONTRACTOR SHALL HAVE TO PERFORM ALL WORK AFTER NORMAL BUSINESS HOURS AND ON WEEKENDS .
 - AF-2 CONTRACTOR SHALL REPAIR (MATCHING EXISTING) SPLAYED FLOOR/WALL BASE AFTER VOT TILE REMOVAL.
 - AF-3 CONTRACTOR SHALL BE RESPONSIBLE FOR FIELD MEASUREMENT OF ALL FLOOR SURFACES TO BE RENOVATED.

- GENERAL FLOORING NOTES:**
- 1. CONTRACTOR SHALL PROVIDE ANY ADDITIONAL CEMENTITIOUS LEVELING MATERIAL REQUIRED IN ORDER TO GRADUALLY (FAN OUT SLOPE FOR ADA COMPLIANCE) ADJUST NEW FLOORING TO EXISTING GRADE OF ALL FLOOR VAULT ACCESS COVERS, CLEANOUTS ETC..
 - 2. FLOORING NOTES ABOVE REFER TO ALL HATCHED AREAS.
 - 3. INDICATED SQ FOOTAGES ARE ROUNDED TO THE NEXT HIGHEST 100 SF.
 - 4. BUILD 77 IS TO BE INCLUDED IN PROJECT.