

	1	2	3	4	5	6	7	8	9
--	---	---	---	---	---	---	---	---	---

Figure 1 consists of 12 diagrams, each showing a 6-foot scale (represented by a horizontal line with tick marks) and a corresponding 16-foot scale (represented by a horizontal line with tick marks). The diagrams are labeled with the number of 1-foot increments used to construct the 16-foot scale: 1, 2, 3, 4, 5, 6, 7, 8, 9, 10, 11, and 12. The diagrams show that the 16-foot scale is constructed by repeating the 1-foot increments of the 6-foot scale. For example, the first diagram shows a 6-foot scale divided into 6 one-foot increments, and a 16-foot scale divided into 16 one-foot increments. The second diagram shows a 6-foot scale divided into 6 one-foot increments, and a 16-foot scale divided into 16 one-foot increments, with the 16-foot scale being constructed by repeating the 1-foot increments of the 6-foot scale. The diagrams illustrate that the 16-foot scale is constructed by repeating the 1-foot increments of the 6-foot scale, and that the 16-foot scale is constructed by repeating the 1-foot increments of the 6-foot scale.

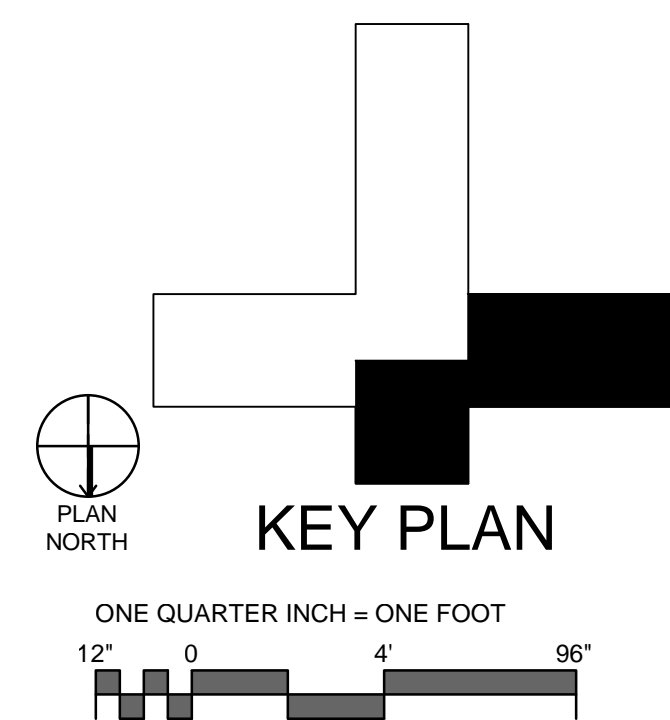

OFFICE OF
CONSTRUCTION AND
FACILITIES
MANAGEMENT

 Department of
Veterans AffairsCONSULTANTS:

ARCHITECT/ENGINEERS:

BES DESIGN/BUILD, LLC
766 Middle St, Fairhope, AL 36532
Phone: 251.990.5778
Fax: 251.990.3716

Drawing Title	ENLARGED EQUIPMENT PLANS
---------------	---------------------------------

Approved: Project Director

Project Title	INPATIENT PSYCHIATRY AND SUBSTANCE ABUSE
---------------	---

Location	W.J. BRYAN DORN VAMC; COLUMBIA, SC
----------	------------------------------------

Project Number	544-13-101
Building Number	100

Drawing Number

Dwg 30 of 51