

EQUIPMENT SCHEDULE				
ITEM NO.	TYPE	LOCATION	DIMENSIONS	MANUFACTURER & MODEL NO.
1	WARMING CABINET		79 18"H x 30 3/4"D x 34 1/8" W	AMSCO EQUIP. DWG. NO. 413726-641
2	FLASH STERILIZER		74 10"H x 30 3/4"D x 36" W	STERIS EQUIP. DWG. NO. 38752-643
3	SURGICAL TABLE	OPERATING ROOMS 1 & 2 ENDO. PROCEDURE 1 & 2	44"H MAX. x 21 5/8" D x 75 1/16" W	STERIS 3085SP
4	SUPPLY COLUMN	OPERATING ROOMS 1 & 2		STERIS
5	SUPPLY HEAD	OPERATING ROOMS 1 & 2		STERIS
6	SURGICAL LIGHT	OPERATING ROOMS 1 & 2		STERIS
7	SURGICAL LIGHT w/ SUPPLY COLUMN	ENDO. PROCEDURE 1 & 2		STERIS
8	X-RAY VIEW BOX			TECHLINE TR402
9	PACS SYSTEM	OPERATING ROOMS 1 & 2 ENDO. PROCEDURE 1 & 2		
10	VENTILATED SCOPE CABINET			CUSTOM
11	COUNTERTOP ICE MACHINE	NOURISHMENT	PROHBT. INSTRUCTIONAL AND CONTROL SIGN	SCOTSMAN MDTS25
12	PYXIS	MEDS		
13	WASTE MANAGEMENT DOCKING STATION	SOILED UTILITY	22"H x 20"D x 25"W	STRYKER 700-3
14	SCRUB EXCHANGE SYSTEM	MEN'S LOCKER/ WOMEN'S LOCKER	78"H x 16 5/8" x 52"W	SCRUBEX MM RECEIVEDISPENDER
15	SUPPLY HEAD	ENDO. PROCEDURE 1		STERIS

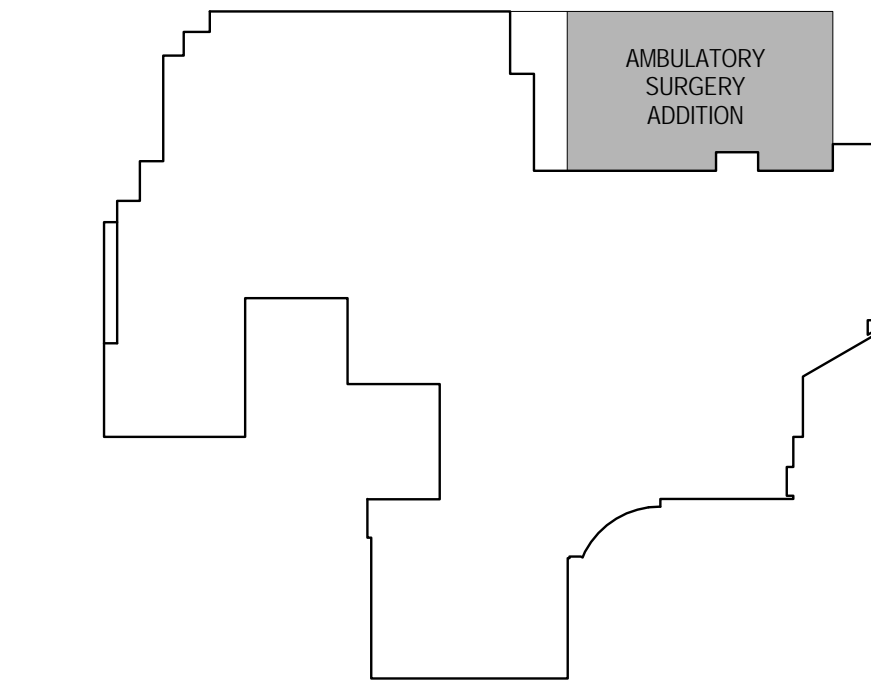
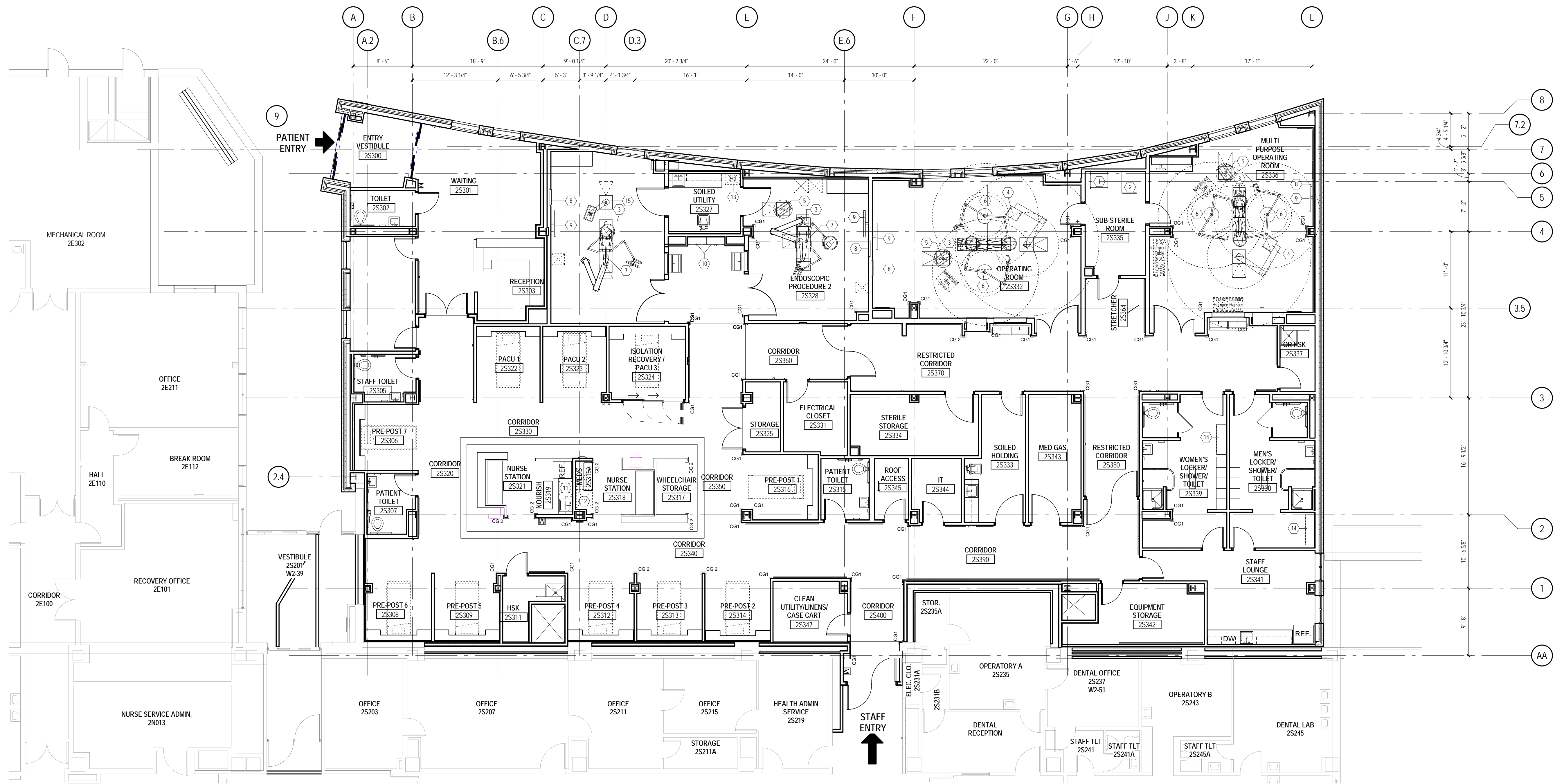

FINAL DRAWING SUBMISSION (100%)  
FULLY SPRINKLERED

CONSULTANTS:		Drawing Title Partial Second Floor Equipment Plan & Schedule		Project Title AMBULATORY SURGERY ADDITION REDESIGN		Project Number		Office of Construction and Facilities Management Department of Veterans Affairs	
		Approved: Project Director		Location VAMC 135 EAST 38th STREET, ERIE PENNSYLVANIA, 16504		Building Number			
				Date 12 MAR 20		Drawing Number			
Revisions:						Checked		Dwg. 16 of 86	
Date						Drawn			