

one and one half inches = one foot
one inch = one foot
three quarters inch = one foot
one half inch = one foot
three eighths inch = one foot
one quarter inch = one foot
one eighth inch = one foot

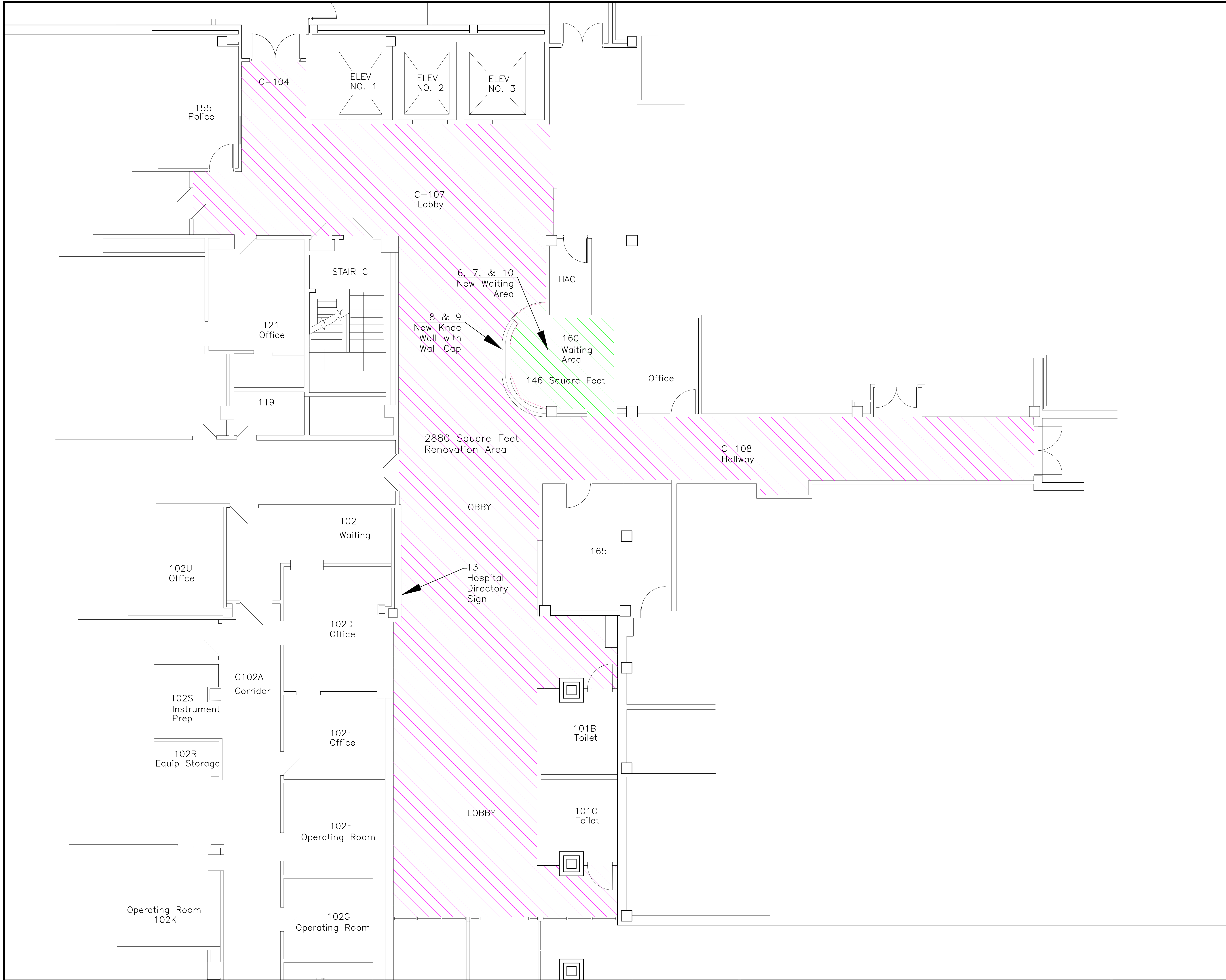

Renovation Notes
1. Replace Floor Tile — Color Palette Provided, Contractor to Provide Samples, 2723 S.F.
2. Replace Vinyl Base, Approx. 475”
3. New Ceiling Tiles — Color Palette Provided, Contractor to Provide Samples 2880 S.F.
4. Replace Ceiling Air Diffusers and Vent Returns
5. New Concealed Escutcheons for Fire Sprinklers
6. New Waiting Area to Replace Operator Booth
7. Carpet Tiles For New Waiting Area — Color Palette Provided, Contractor to Provide Sample, Approx. 146 S.F.
8. Waiting Area Surrounded By Knee Wall Following Same Footprint As Operator Booth, Stud & Drywall Const. Approx. 20’ of New Wall
9. Propose Wall Cap and Provide Sample
10. Data & T.V. Cables to be Installed in Waiting Area
11. Replace Lighting With H.E. Mix of Can Lights and Fluorescent Lights, Contractor to Provide Design Proposal
12. Wall Finishes to be Selected by VA to Complement Existing Color Palette Approx. 353’ of Wall
13. Hospital Directory Sign For Entryway
14. Secure All Loose Cabling in Ceiling
Scale: 3/16” = 1’0”

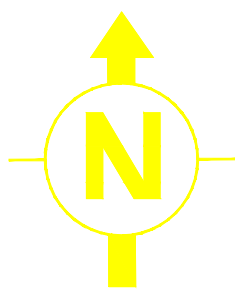

CONSULTANTS:		ARCHITECT/ENGINEERS:		Drawing Title	Project Title	Project Number	Office of Construction and Facilities Management Department of Veterans Affairs	
				Lobby Remodel	Lobby Renovation			
				Approved Project Director	Location FT. HARRISON, HELENA, MT	Building Number 154		
					Date May 2014	Checked Nathan Jones		
Revisions						Dwg. of		
Date								