

SUPPORT STAINLESS STEEL EXHAUST DUCTWORK INDEPENDENTLY FROM ARCHITECTURAL SOFFIT AS PER SMACNA REQUIREMENTS AND DUCT SUPPORT SPECIFICATIONS

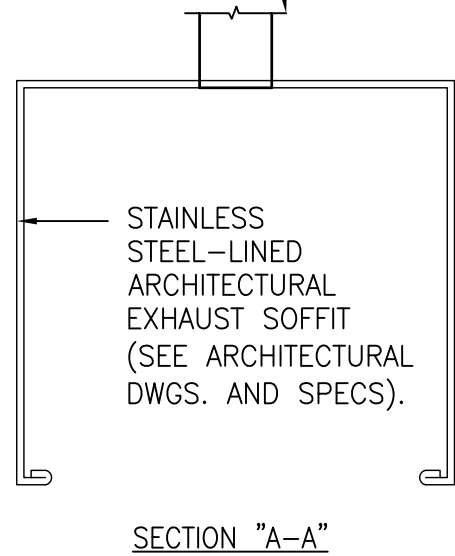
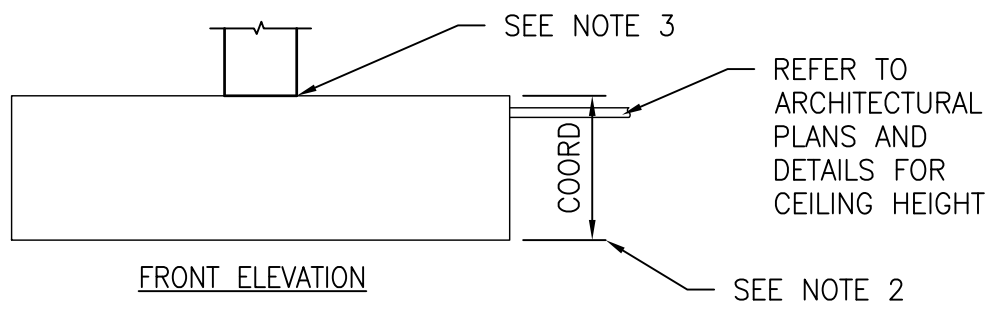

NOTES:

1. INTERNAL LINING OF SOFFIT AND EXHAUST DUCTWORK SHALL BE STAINLESS STEEL. SEE SPECIFICATIONS. FOR SOFFIT SIZE & LOCATION SEE ARCHITECTURAL. FOR EXHAUST DUCT SIZE AND CONNECTIONS SEE HVAC FLOOR PLAN.
2. SOFFIT EXTENSIONS DOWN FROM FINISHED ROOM CEILING HEIGHT SHALL BE COORDINATED WITH ARCHITECTURAL REFLECTED CEILING PLAN AND PROCESS EQUIPMENT HEIGHT/DOORS/EQUIPMENT CLEARANCE REQUIREMENTS. INTENT OF SOFFIT IS TO CREATE A HIGH SPACE/AREA TO CAPTURE MOIST AIR/VAPORS RISING FROM PROCESS EQUIPMENT/EQUIPMENT OPENINGS.
3. EXHAUST DUCT CONNECTION TO TOP OF SOFFIT SHALL BE WELDED/SEALED AIR AND WATER TIGHT. DUCT OPENING SHALL INCLUDE STAINLESS STEEL WIRE MESH WELDED INTO DUCT AT TOP OPENING OF THE SOFFIT. COORDINATE DUCT CONNECTION AND SOFFIT OPENING LOCATION WITH ALL SUPPORT AND CONSTRUCTION REQUIREMENTS FOR THE SOFFIT AND DUCTWORK.

DUCT CONNECTION TO ARCHITECTURAL EXHAUST SOFFIT

5

NTS

M5.02