

Site Requirements | MEDIVATORS®
ADVANTAGE® PLUS
Reprocessing System



MODEL 2.0

MEDIVATORS® is a registered trademark.

MEDIVATORS ADVANTAGE® is a trademark of MEDIVATORS Inc.

Windows and Windows XP are registered trademarks of Microsoft Corporation.

50097-420 Rev F

© 2013, MEDIVATORS Inc.

All rights reserved. This publication is protected by copyright. Copying, disclosure to others, or the use of this publication is prohibited without the express written consent of MEDIVATORS.

MEDIVATORS reserves the right to make changes in the specifications shown herein without notice or obligation. Contact your MEDIVATORS representative or MEDIVATORS customer service for more information.

SITE REQUIREMENTS

The purpose of this section is to provide the customer with requirements that need to be met to ensure the ADVANTAGE® Plus will be properly installed.

Applicable Documents

- ADVANTAGE Plus Endoscope List and Operator ID Form (PN 50092-380)
- ADVANTAGE Plus User Manual (PN 50097-429)

It is the responsibility of the customer to meet these requirements to ensure proper installation of the ADVANTAGE Plus.

The ADVANTAGE Plus will be delivered on a pallet along with multiple boxes. It is important to keep all the boxes received with the ADVANTAGE Plus together.

It is the responsibility of the customer to provide qualified personnel to provide the connections for the ADVANTAGE Plus to the building supply (Water, Electrical, Drain, Air and Network/Internet) during the installation process.

Any deviation from these specifications may cause operational issues that would not be covered by the Warranty.

Water Supply

- Potable water is the minimum standard.
- The water supply must be connected to a thermostatic mixing valve set to provide an on-demand water temperature of $35^{\circ}\text{C} \pm 2^{\circ}\text{C}$ ($95^{\circ}\text{F} \pm 4^{\circ}\text{F}$). One mixing valve per reprocessor recommended.
- The mixing valve must be accessible and located near the prefilter to aid in adjustment. The mixing valve should include a thermometer followed by a bypass valve to a drain.
- The incoming waterline must be a minimum of 1/2" ID providing a flow rate of 1.32 GPM and a water pressure of 35 to 87 psi.
- Ensure water hardness is less than 12 gpg (200 ppm) for optimal performance.
- The pre-filter assembly is wall mounted and has the dimensions of 26" H x 38" W x 6"D. The incoming water connection to the pre-filter assembly is 1/2" NPT on the right hand side. All fittings and hoses for the output of the pre-filter assembly are included.
- A shut-off valve must be installed before the pre-filtration system. It is important that the valve be mounted within reach of the operator.

The MEDIVATORS® endoscope reprocessors do not require backflow protection for the incoming water supply, nor is a backflow protection device installed in the reprocessor.

If building or plumbing codes require backflow protection, then please consult your local codes, standards and/or guidelines, for applicable requirements.

Drain

- A drain system capable of draining 3.17 GPM, less than 18" from the floor and vented will ensure the proper operation of the ADVANTAGE Plus. The supplied drain line has a 1" ID.

Air Supply

- The ADVANTAGE Plus system includes an air compressor that requires a dedicated 120 VAC NEMA 5-15 outlet.
- If the ADVANTAGE Plus model purchased did not include the air compressor, the system may utilize house compressed air (dry, oil free) which must meet these required air pressure specifications: 58 to 125 PSI with a minimum flow volume of 1.5 CFM, maximum particle size is 5 microns, maximum dew point is 7°C (45°F), maximum oil concentration is 5 mg/m^3 .
- A 1/4" ID flexible air hose (EPDM, braided, 150 psi minimum) is required to connect the ADVANTAGE Plus to the house air. This is not supplied with the ADVANTAGE Plus. The hose connects to a barbed fitting on the back of the ADVANTAGE Plus.

Electrical Supply

- 120 VAC \pm 10%, single phase, 60 Hz, 15 Amps
- A GFI protected outlet (NEMA 5-15R) should be located within the operator's reach.
- The ADVANTAGE® Plus can operate uninterrupted with power losses up to 0.5 seconds. Power losses greater than 0.5 seconds without proper shutdown may produce system alarms and system shutdown.
- A UPS with a minimum rating of 1500 VA/865 watts is highly recommended. The role of the UPS is to solely protect the computer and will allow the ADVANTAGE Plus to operate for a short period of time without power allowing for an orderly shut down of the computer in the event of a power outage.

Ventilation

It is the Customer's Responsibility to ensure the room is in compliance with this requirement. This is not a requirement of the ADVANTAGE Plus but of the chemicals that are used for disinfection.

- It is a health and safety requirement to have a minimum of 10 air changes per hour in the room. During cycle operation and the chemical heating process, chemical vapor may be produced. The air exchange will minimize staff exposure to chemical vapors.
- A 4" flexible duct may be connected from the back of the ADVANTAGE Plus to the facility's exhaust system to aid in fume extraction.
- The ADVANTAGE Plus may also be supplied with an active vapor management system to aid in chemical vapor management. Please refer to the purchase order to determine the correct configuration of the ADVANTAGE Plus.

Dimensions

- The ADVANTAGE Plus physical dimensions are 62" H x 49" W x 31" D, weight 400 lbs.
- If the optional air compressor is installed, the ADVANTAGE Plus will need an additional 11" at the back of the unit. Alternately, the compressor may be installed remotely (in an adjacent room, closet, wall space).
- Space is required on either side of the unit (approximately a combined 12") for easy access to the internal components. If this is not available, the ADVANTAGE Plus contains a base with casters allowing the system to be moved. There should be adequate room for the ADVANTAGE Plus to be moved for access to accommodate maintenance.

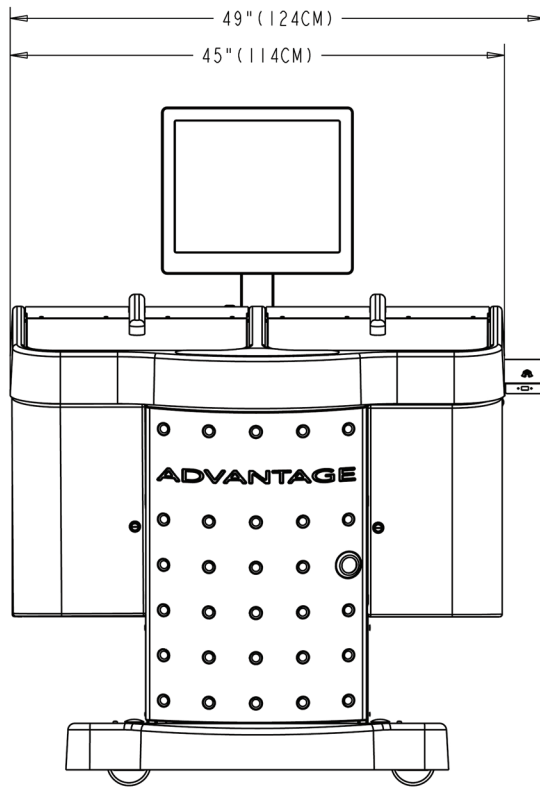

Figure 1. Front Dimensions

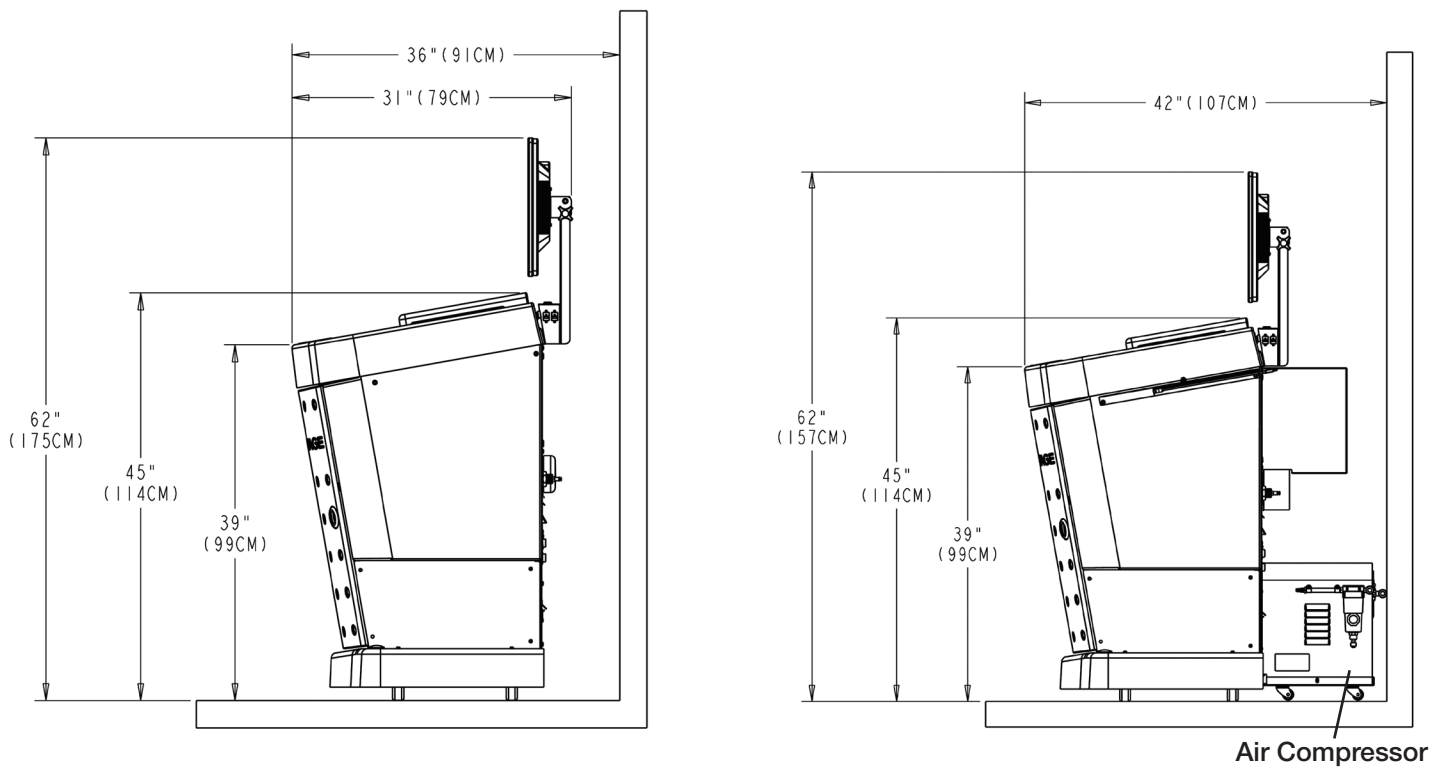

Figure 2. Side Dimensions & Clearance

Endoscope & User Information

- To ensure a smooth and trouble-free installation, the customer must supply a complete list of users and endoscopes that will be reprocessed in the ADVANTAGE® Plus.
- Fill out the ADVANTAGE Plus Endoscope List & Operator ID form (PN 50092-380).

Network/Remote Access

- The ADVANTAGE Plus is equipped with a PC based computer running Windows XP (SP3) which will allow full networking along with the capability of remote diagnostics.
- To allow for remote diagnostics an internet connection is required. This is highly recommended.

This checklist should be utilized to ensure the installation site meets the required specifications. If all specifications are met, the site is suitable for the installation and use of the MEDIVATORS® ADVANTAGE Plus Automated Endoscope Reprocessor.

SITE REQUIREMENTS

Water Supply	Potable water is the minimum standard.	
	Minimum flow rate of 1.32 GPM with a pressure of 35 to 87 PSI	
	Water Temperature 35°C ± 2°C (95°F ± 4°F), on-demand supplied by a thermostatic mixing valve. One mixing valve per reprocessor recommended.	
	The mixing valve must be accessible	
	Hardness, less than 12 gpg (200 ppm)	
	Pre-filter wall space 26" H x 38" W x 6" D	
Drain	3.17 GPM, less than 18" from the floor, vented	
Air Supply	Included air compressor, 120 VAC, adds 11" to depth of unit	
	House compressed air requirements: (dry/oil free) 58 to 125 PSI, minimum flow volume of 1.5 CFM, maximum particle size is 5 microns, maximum dew point is 7°C (45°F), maximum oil concentration is 5 mg/m ³	
Electrical Supply	120 VAC ± 10%, single phase, 60 Hz, 15 Amps	
	NEMA 5-15R outlet GFI protected, accessible by user	
Ventilation	10 to 12 room air exchanges per hour	
	Optional ventilation system available, 120 VAC, adds 7" to the depth	
Unit Dimensions	62" H X 49" W X 31" D, 400 lbs.	
	Add 12" of open space to the total width to aid with service access	
Endoscope List	ADVANTAGE® Endoscope List & Operator ID form (50092-380) completed	
Remote Access	Internet connection (recommended)	

By signing below Customer acknowledges that (1) Customer reviewed these Site Requirements for the MEDIVATORS® Reprocessor(s) listed on the face of this document; (2) Customer is solely responsible for meeting each of the specifications and requirements set forth in these Site Requirements to ensure proper installation and performance of the reprocessor(s); (3) Customer is able to meet each of these specifications and requirements; and (4) the failure of Customer to comply with these Site Requirements and any deviation from the specifications set forth herein may compromise the functionality of the reprocessor(s) and/or may cause operational issues, which will not be covered by the MEDIVATORS warranty and are hereby disclaimed by MEDIVATORS.

Facility Representative _____ Title _____

Signature _____ Date _____ Email _____



Manufactured in the USA by:

MEDIVATORS Inc. Headquarters 
14605 28th Avenue North
Minneapolis, MN 55447 USA
Toll Free: +1.800.444.4729

MEDIVATORS BV 
Sourethweg 11
6422PC Heerlen
The Netherlands
Tel: +31.45.5.471.471

MEDIVATORS Asia/Pacific Pte Ltd
1A International Business Park
#05-01 Singapore 609933
Tel: +65.6227.9698

MEDIVATORS Beijing Representative Office
Room 708, 7th Floor Kaiheng Center, Block B
No. 2 Chaoyangmennei Street
Dongcheng District, Beijing China 100010
Tel: +8610.6567.8446

www.medivators.com