

three inches = one foot
one and one-half inches = one foot
one inch = one foot
three-quarters inch = one foot
one-half inch = one foot
three-eighths inch = one foot
one-quarter inch = one foot
one-eighth inch = one foot

GENERAL NOTES

- A REFER TO SHEET M001 FOR LEGEND, ABBREVIATIONS AND ADDITIONAL GENERAL NOTES.
- B PROVIDE TEMPORARY PARTITION WITHIN APPROVED ROOMS, AROUND IMMEDIATE AREA OF CONSTRUCTION CONSISTING OF FLAME RETARDANT PLASTIC, TEMPORARY BARRIERS AND CONSTRUCTION AREAS SHALL MEET ALL REQUIREMENTS FOR VA INFECTION CONTROL CLASS III CONSTRUCTION PROJECTS.
- C PROVIDE AND MAINTAIN NEGATIVE AIR PRESSURE AT ALL CONSTRUCTION, WITHIN TEMPORARY PARTITIONS.
- D COORDINATE PHASE COMPLETION AND START-UP WITH REQUIREMENTS AS SET FORTH BY THE VA PROJECT ENGINEER TO MAINTAIN DAILY OPERATIONS TO NEAR AS NORMAL AS POSSIBLE.
- E COORDINATE LOCATION OF JOB DUMPSTER WITH THE VA PROJECT ENGINEER SO AS TO DISRUPT DAILY OPERATIONS AS LITTLE AS POSSIBLE.
- F EXISTING HVAC, SPRINKLERS, WATER SUPPLY, ELECTRICAL, VOICE/DATA, FIRE ALARM, ETC. SHALL BE MAINTAINED THROUGHOUT, DURING EACH PHASE OF CONSTRUCTION. SUPPORT AND PROTECT ALL LINES DURING EACH PHASE OF CONSTRUCTION.
- G EXISTING POWER MUST BE MAINTAINED THROUGHOUT, DURING EACH PHASE OF CONSTRUCTION. COORDINATE PHASING WITH ELECTRICAL CONTRACTOR. COORDINATE POWER TURNOVER WITH REQUIREMENTS AS DICTATED BY THE VA PROJECT ENGINEER.
- H COORDINATE SEQUENCE CONSTRUCTION WITH THE VA PROJECT ENGINEER SO THAT ONLY ONE HALF OF ANY CORRIDOR IN USE IS OBSTRUCTED AT ANY POINT IN TIME.
- I AT THE END OF EACH PHASE ALL WORK SHALL BE COMPLETE AND READY TO BE TURNED OVER TO THE VA FOR IMMEDIATE USE.
- J EACH PHASE SHALL TAKE NO LONGER THAN 2 DAYS TO COMPLETE. 2 PHASES SHALL BE COMPLETED PER WEEK.
- K ALL WORK SHALL TAKE PLACE BETWEEN JUNE 1 AND SEPTEMBER 1.
- L HEATING HOT WATER SYSTEM SHALL BE DRAINED AT THE BEGINNING OF PHASE 1 AND REFILLED UPON COMPLETION OF PHASE 8. REFER TO SPECIFICATION SECTION 23.25.00 FOR REQUIRED CHEMICAL TREATMENT.

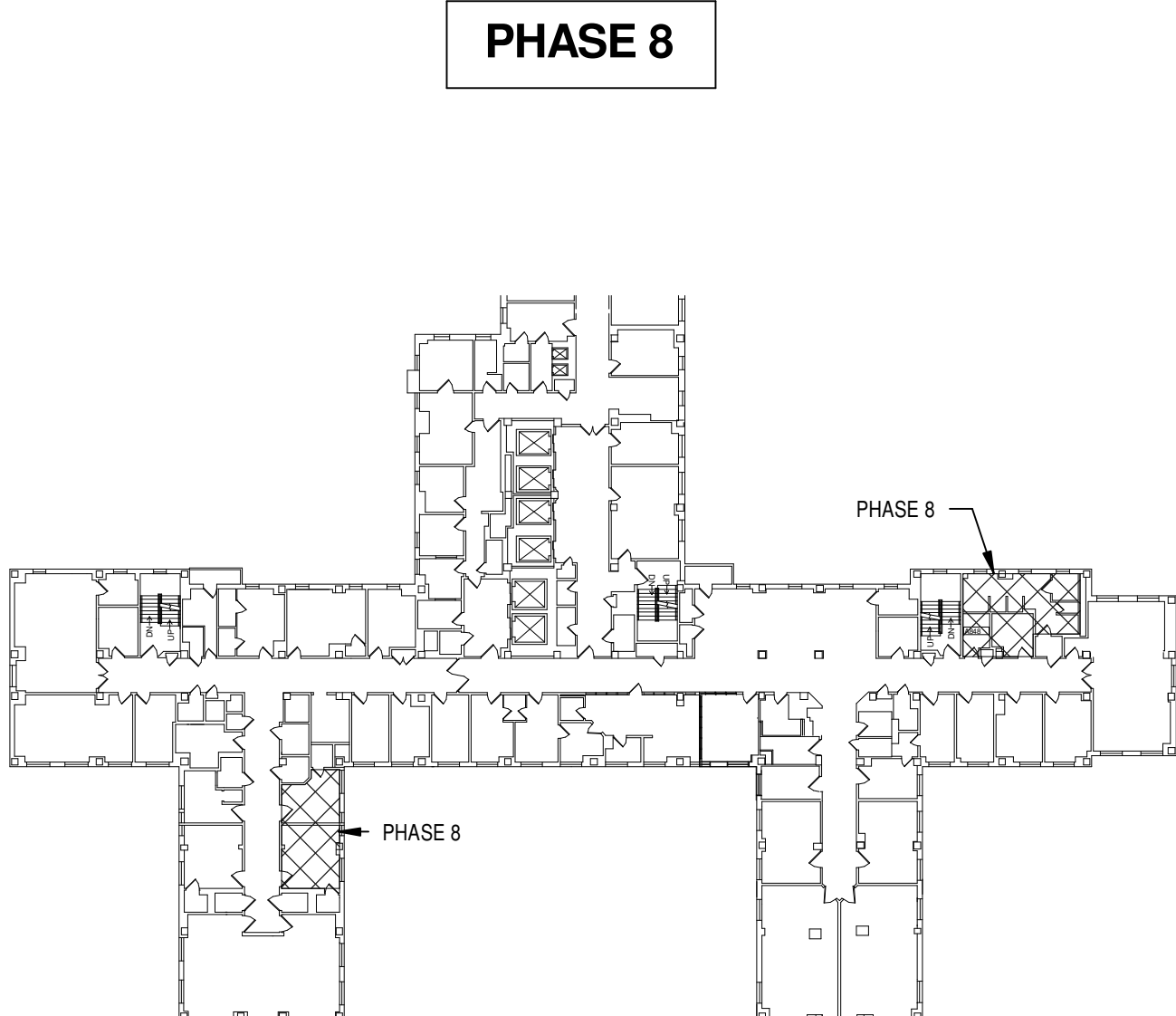
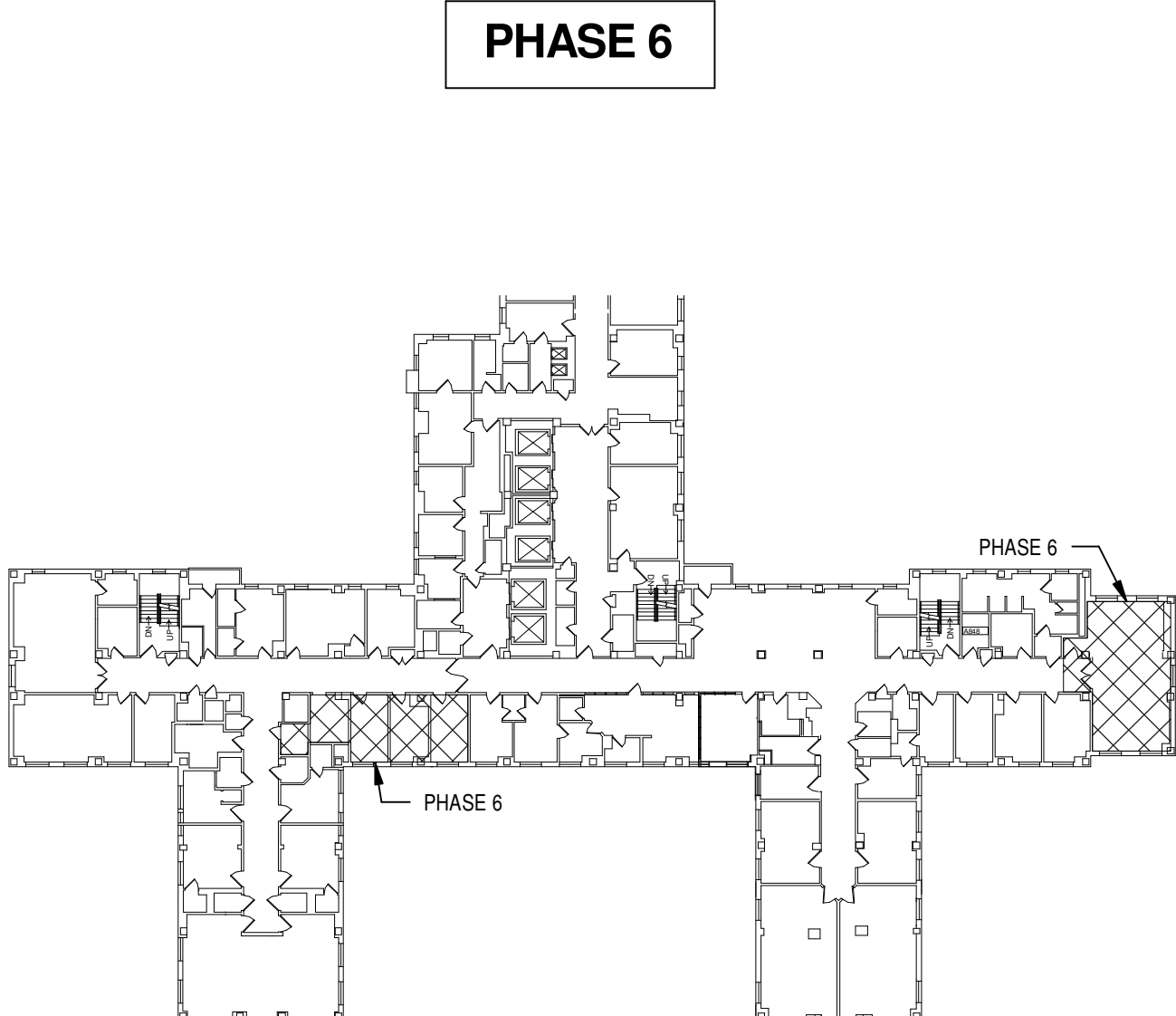
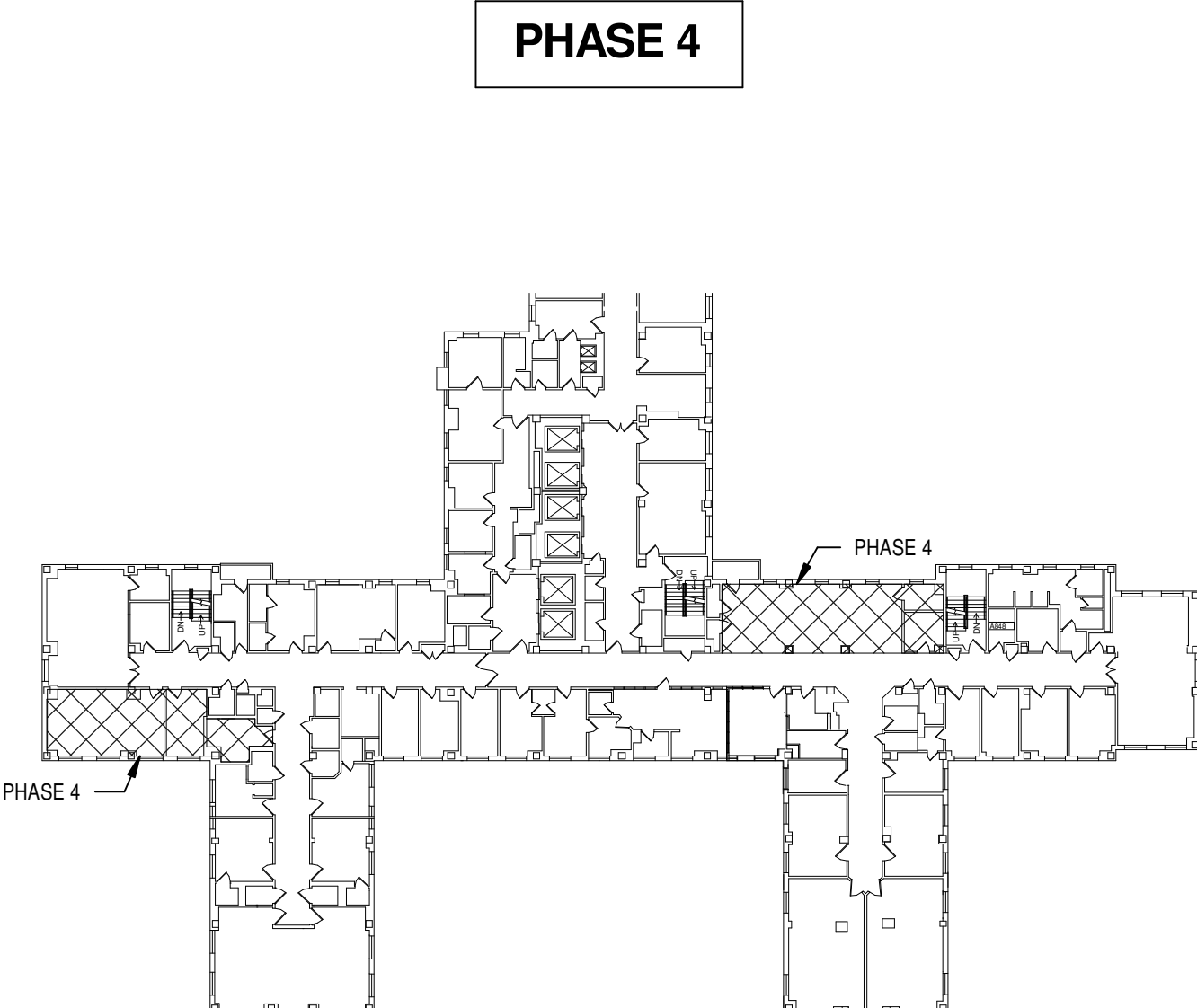
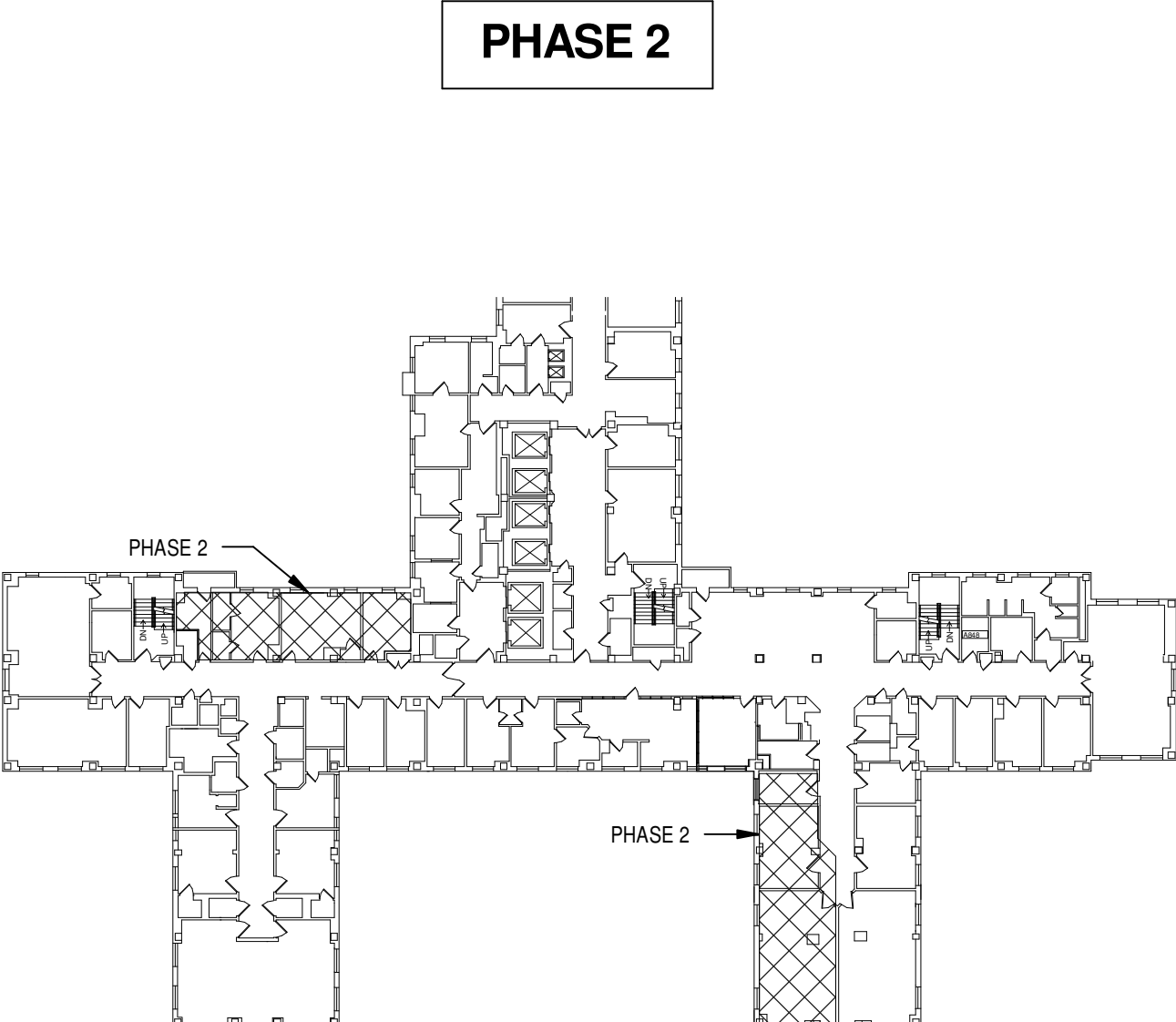
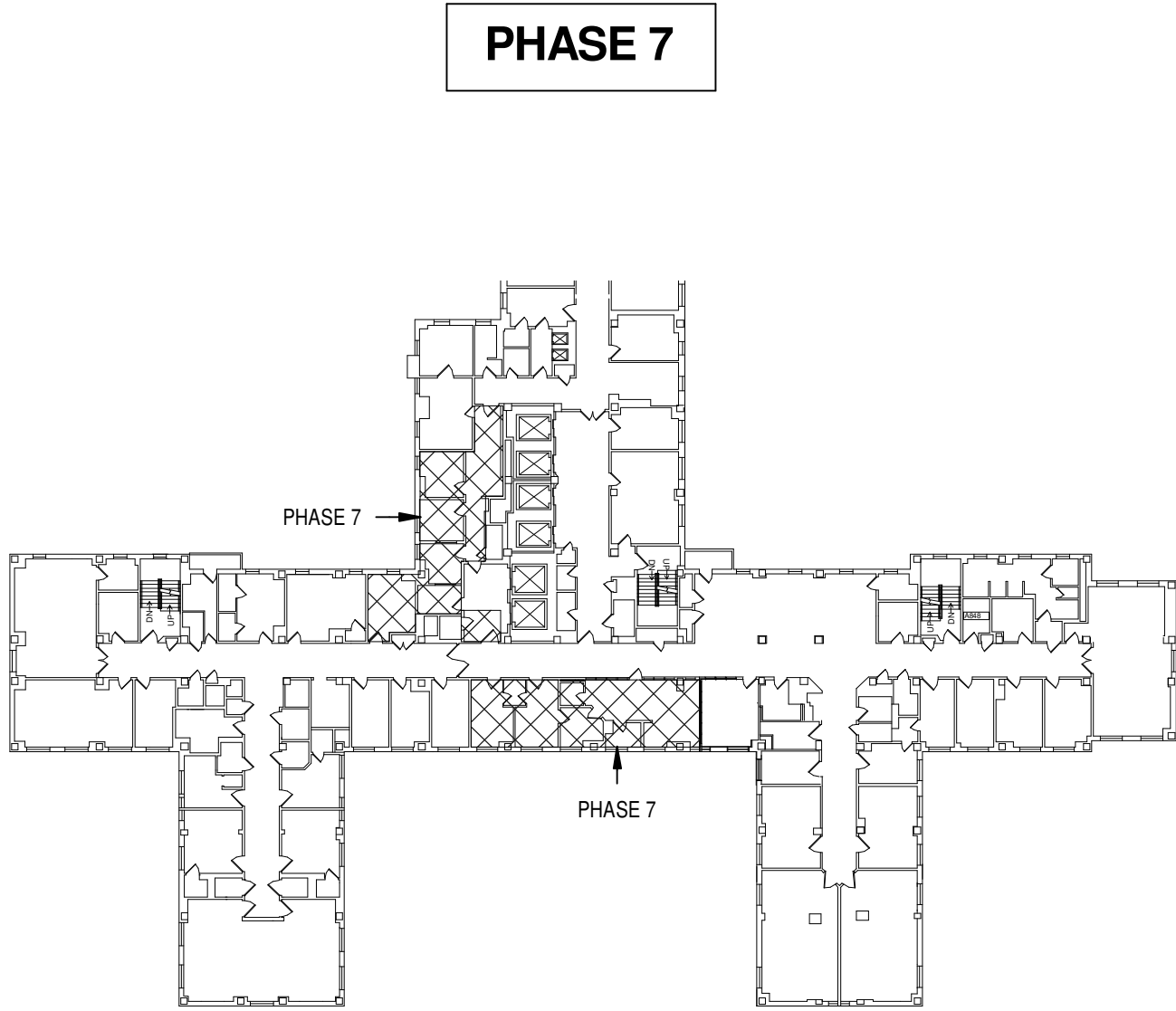
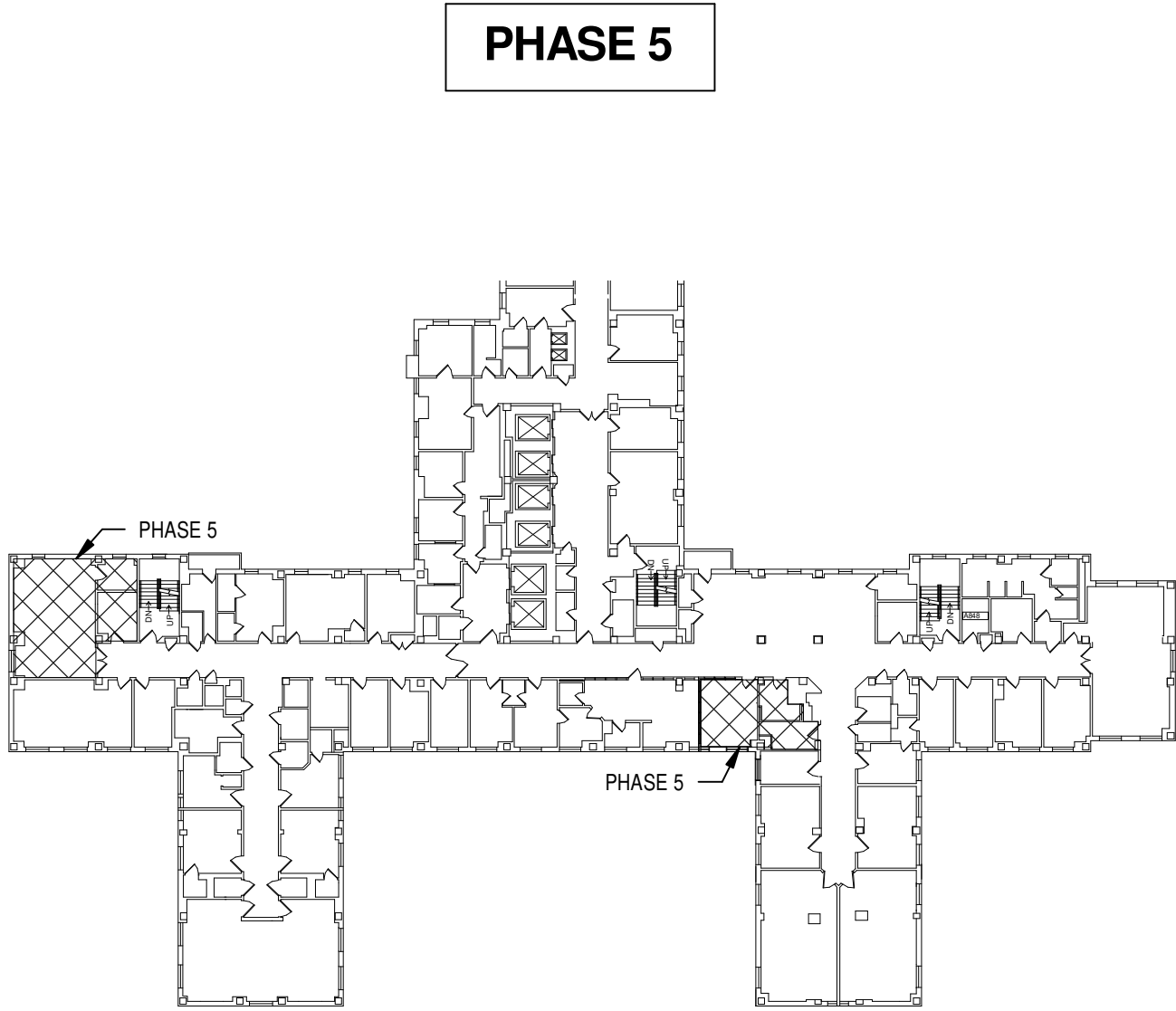
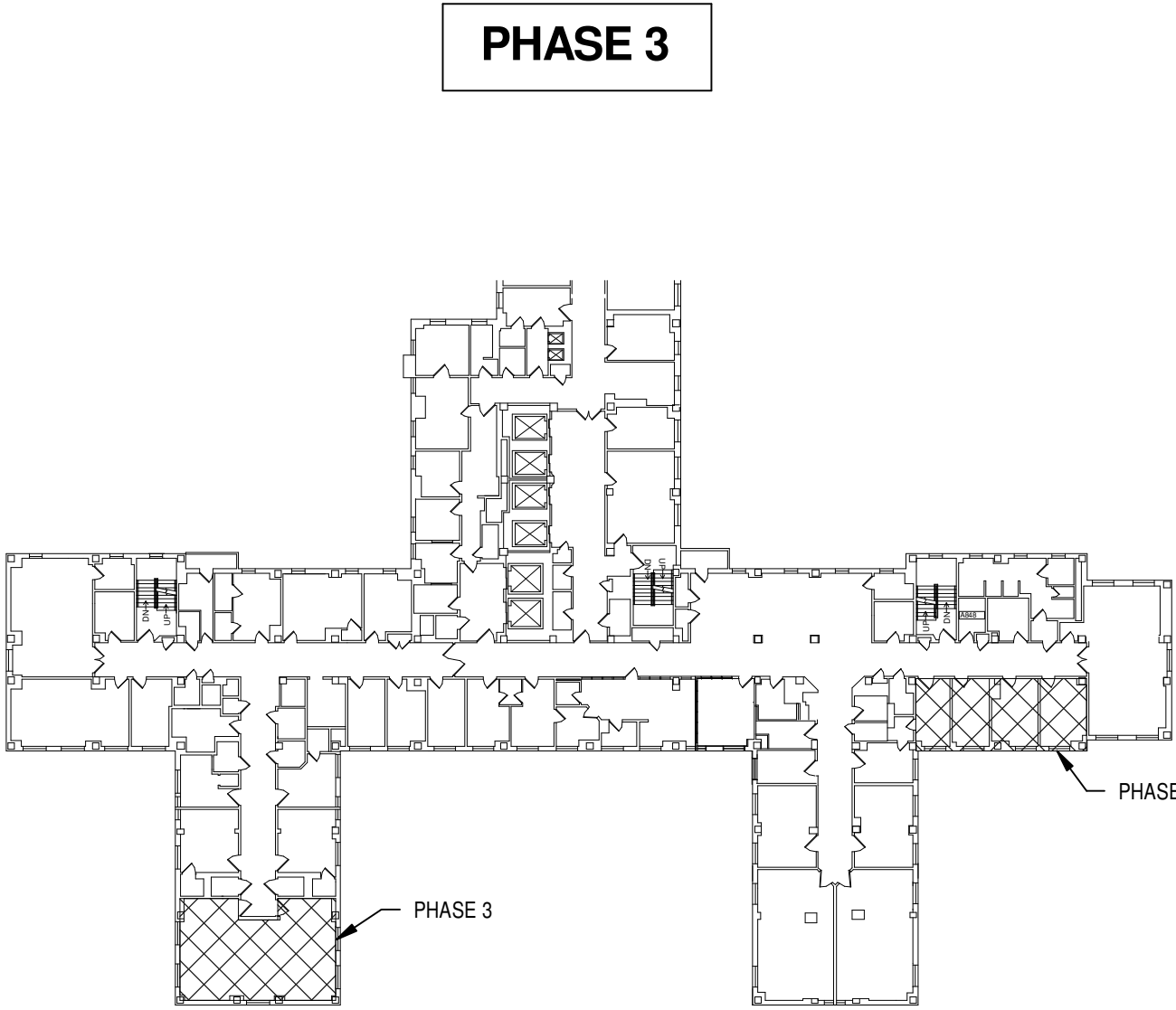
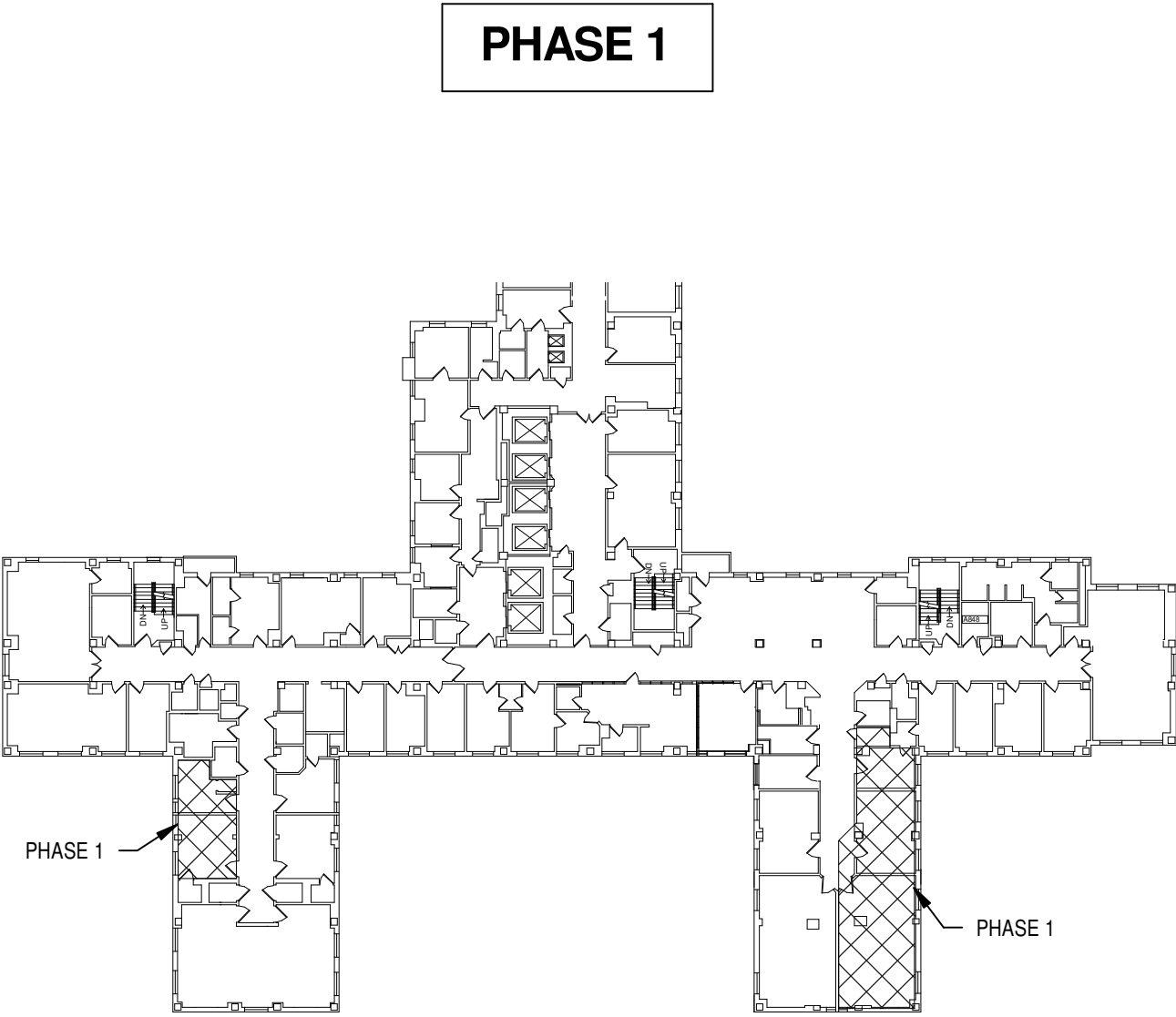

1	Amendment 1	07-24-2014
Revisions		Date

CONSULTANTS:

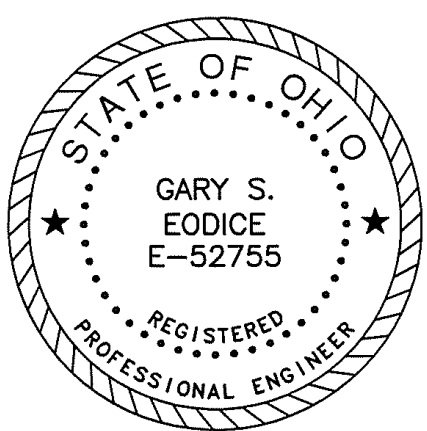

ARCHITECT/ENGINEERS:

Heapy Engineering
MEP Design Technology Planning Commissioning Energy
Nationally Recognized Leader in Sustainability
1400 W Dorothy Lane, Dayton, OH 45409-1310
Ph 937-224-0861 Fax 937-224-5777 www.heapy.com
HEAPY PROJECT No.: 2013-04025 FIRM LICENSE No.: 01528

Drawing Title

PHASING PLANS

Approved: Project Director

Project Title

REPLACE PNEUMATIC BOXES
ON 8TH FLOOR

Location

Cincinnati, Ohio

Date

05/22/2014

Checked

JAC

Drawn

DRV

Project No.

VA Project No. 539-15-203

Building Number
1

Drawing Number

M002

Dwg. 3 of 8

Office of
Construction
and Facilities
Management

