

three inches = one foot
one and one half inches = one foot
one inch = one foot
three quarters inch = one foot
one half inch = one foot
three eighths inch = one foot
one quarter inch = one foot
one eighth inch = one foot

SSMH TOP=884.25
OUT=871.33
SSMH TOP=883.53
SUMP=880.13
(FILLED TO SUMP)
SSMH TOP=880.81
INV IN(A)=871.73
INV IN(B)=871.70
INV OUT=871.60
SSMH TOP=880.92
FULL OF SEWAGE
INV IN(A)=871.43
INV IN(B)=872.52
INV OUT=871.92

1 SITE GRADING AND DRAINAGE PLAN
SCALE: 1"=10'-0"

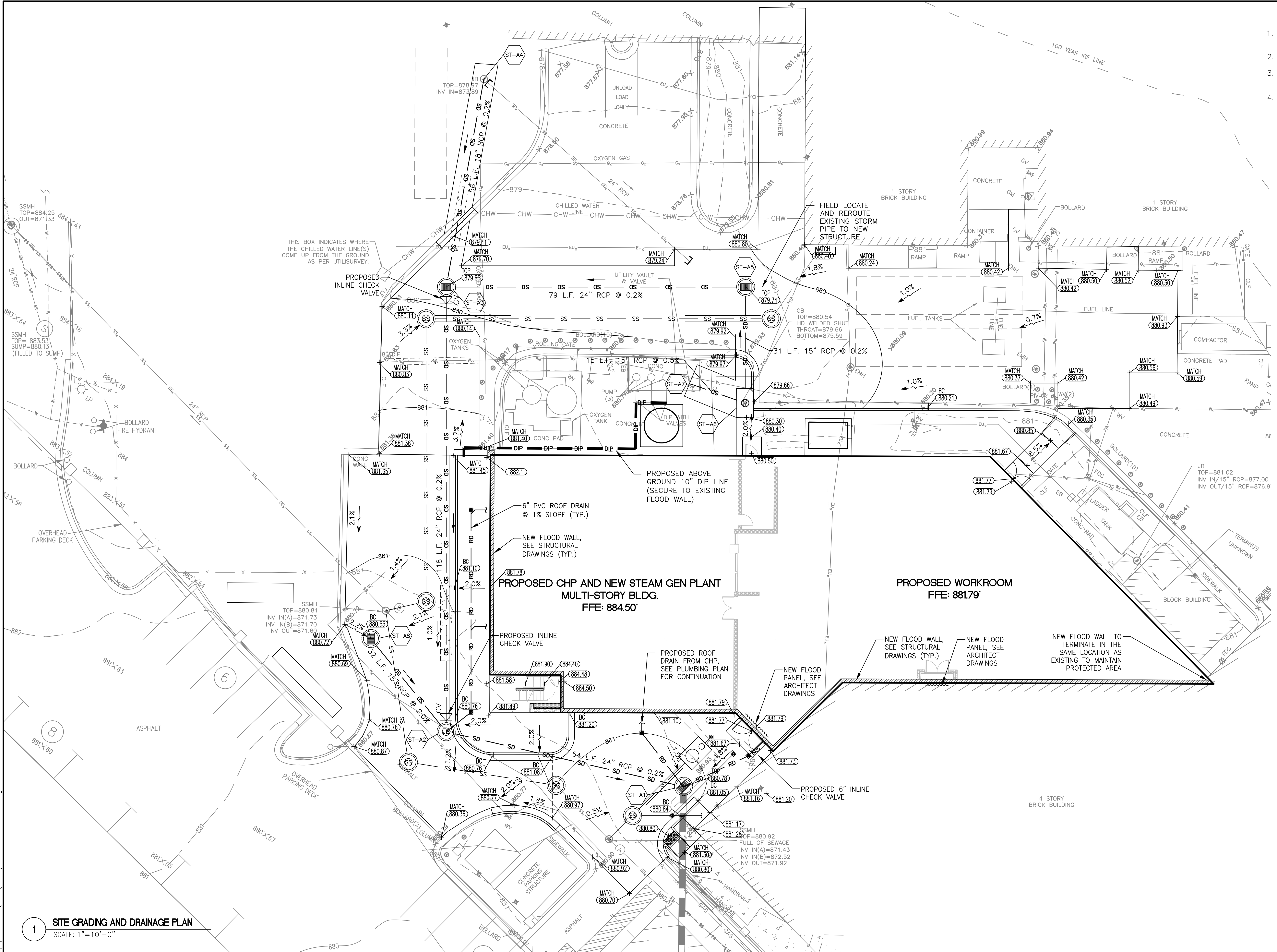

- GRADING AND DRAINAGE PLAN NOTES:**
- SEE SHEETS C001 AND C002 FOR DRAINAGE NOTES, ABBREVIATIONS, LINETYPE AND PLAN SYMBOLS.
 - CUT AND FILL SLOPES SHALL NOT EXCEED 3:1 H:V.
 - ALL REINFORCED CONCRETE PIPE (RCP) SHALL BE MINIMUM CLASS III.
 - GRADING/SPOT ELEVATION SYMBOLS & ABBREVIATIONS:
+ (880.00) PROPOSED SPOT ELEVATION
TOP = TOP OF STRUCTURE
BC = BOTTOM OF CURB
TW = TOP OF WALL
BW = BOTTOM OF WALL

STRUCTURE TABLE	
STRUCTURE NAME:	DETAILS:
ST-A1	PROPOSED STRUCTURAL WATER QUALITY UNIT OVER EXISTING DRAIN LINE TOP = 880.78 BOTTOM=874.08 24" RCP, INV IN = 874.10 24" CMP, INV OUT = 874.08
ST-A2	PROPOSED JUNCTION BOX TOP = 880.68 BOTTOM=874.23 24" RCP, INV IN = 874.23 15" RCP, INV IN = 875.04 24" RCP, INV OUT = 874.23
ST-A3	PROPOSED DROP INLET TOP = 879.85 BOTTOM=874.23 24" RCP, INV IN = 874.23 18" RCP, INV IN = 874.46 24" RCP, INV OUT = 874.46
ST-A4	EXISTING JUNCTION BOX TOP = 878.97 BOTTOM=873.89 18" RCP, INV OUT = 874.58
ST-A5	PROPOSED DROP INLET TOP = 879.74 BOTTOM=874.37 15" RCP, INV IN = 874.37 8" CMP, INV IN = 877.24 24" RCP, INV OUT = 874.37
ST-A6	REPLACE EXISTING CATCH BASIN TOP = 880.30 BOTTOM=874.43 15" RCP, INV IN = 875.59 15" RCP, INV OUT = 874.43
ST-A7	EXISTING PUMP STATION TOP = 881.18 BOTTOM=874.99 15" RCP, INV OUT = 875.67
ST-A8	PROPOSED DROP INLET TOP = 880.55 BOTTOM=875.68 15" RCP, INV OUT = 875.68

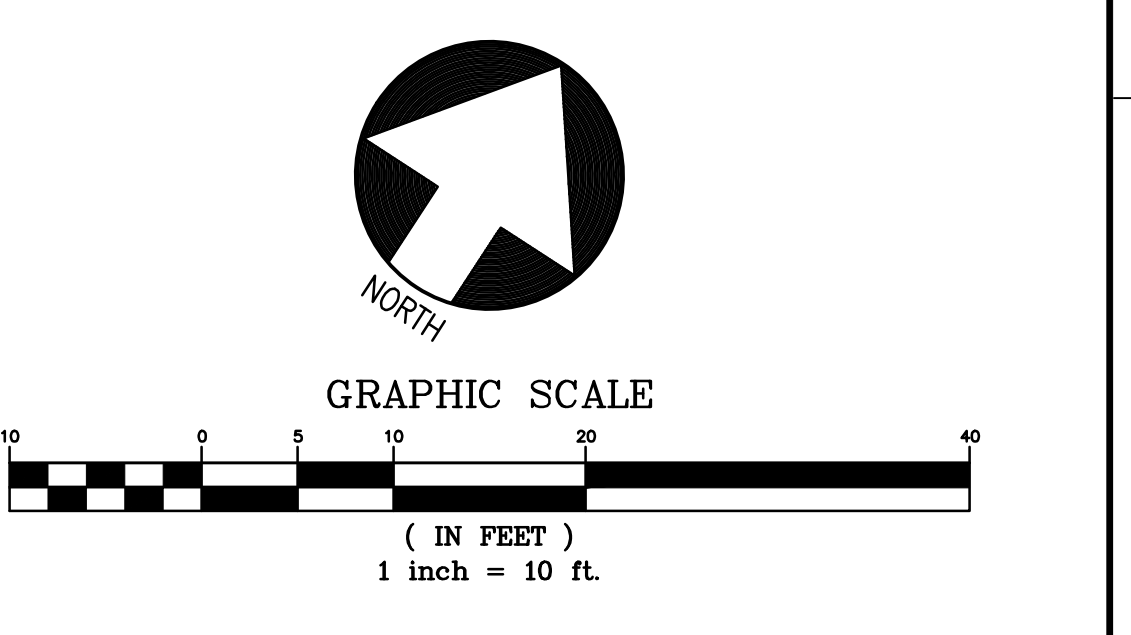

ISSUED FOR BID UPDATED 4/18/14 6/6/14	CONSULTANTS:	ARCHITECT/ENGINEERS: URS architects • engineers • planners 1000 Abernathy Road N.E., Suite 900 400 Northpark Town Center Atlanta, Georgia 30328 Tel: (678) 808-8800 URS Project: 15290200	Drawing Title SITE GRADING AND DRAINAGE PLAN Approved Project Director .	Project Title COMBINED HEAT AND POWER (CHP) PLANT AND NEW STEAM GENERATION SYSTEM Location ATLANTA VA MEDICAL CENTER DECATUR, GA Date APRIL 18, 2014 Checked AF Drawn CLM	Project Number 508-13-400 VA701-R-R-0054 Building Number 14 Drawing Number CIVIL CG-100 Dwg. 15 of 170	Office of Construction and Facilities Management Department of Veterans Affairs
--	--------------	---	---	--	--	--