

three inches = one foot
one and one half inches = one foot
one inch = one foot
three quarters inch = one foot
one half inch = one foot
three eighths inch = one foot
one quarter inch = one foot
one eighth inch = one foot
one eighth inch = one foot

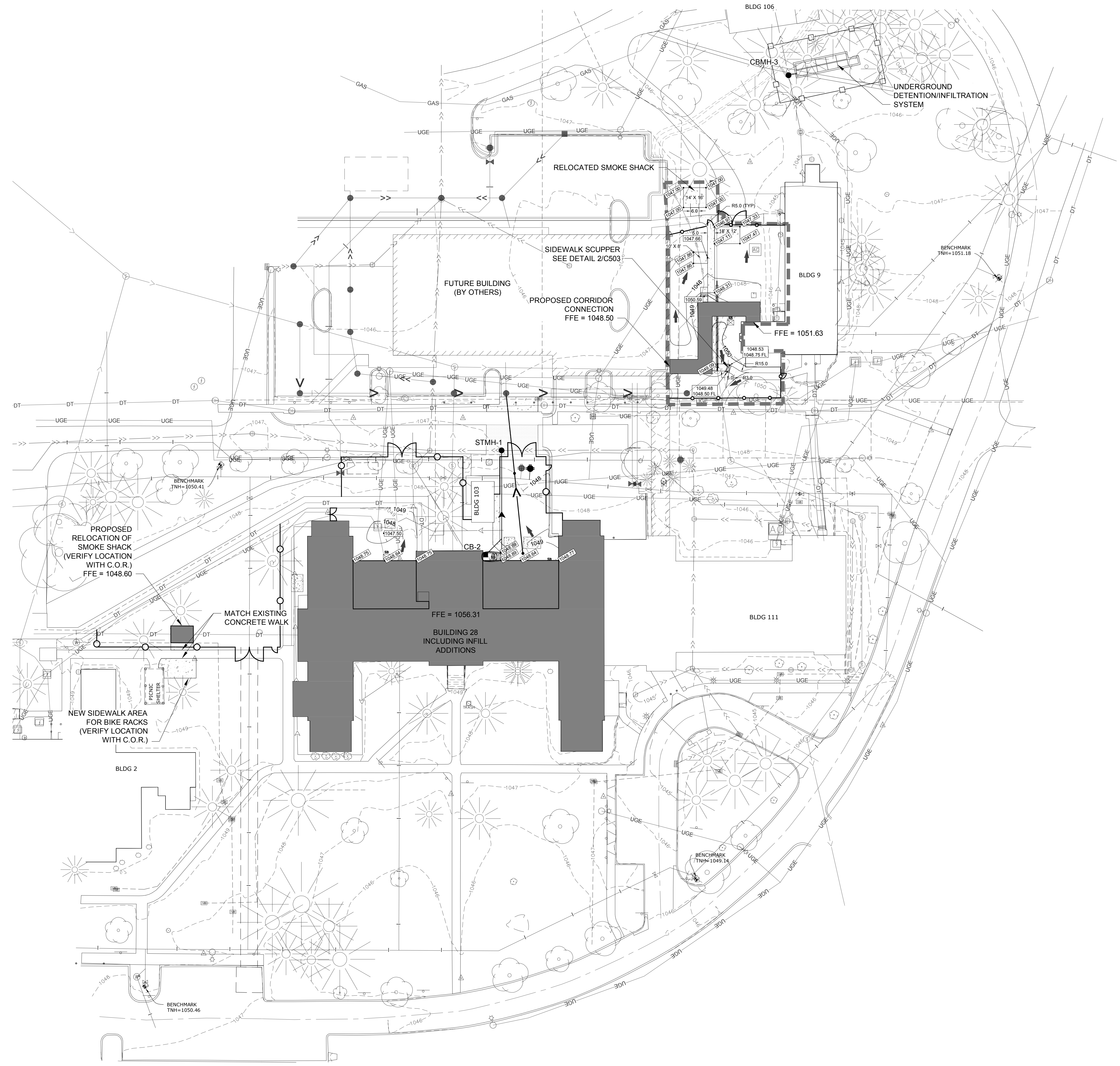

- NOTES:
- CONTRACTOR SHALL FIELD VERIFY LOCATION AND ELEVATION OF ALL UNDERGROUND UTILITIES PRIOR TO ANY CONSTRUCTION, INCLUDING INSTALLATION OF CONSTRUCTION FENCE. CALL GOPHER STATE ONE CALL: 1-800-252-1166.
 - TEMPORARY CHAIN LINK CONSTRUCTION FENCE (8' TALL) SHALL BE PROVIDED AROUND ENTIRE PERIMETER OF CONSTRUCTION AREA. CONTRACTOR SHALL COORDINATE ACCESS THROUGH CONSTRUCTION FENCE WITH DAILY CONSTRUCTION ACTIVITY. ALL ENTRANCES/OPENINGS SHALL BE ENCLOSED AT ALL TIMES AND MONITORED FOR PASSAGE OF EQUIPMENT.
 - EQUIPMENT AND MATERIALS MAY NOT BE LEFT OVERNIGHT BEHIND ORANGE CONSTRUCTION FENCE.
 - COORDINATE WITH THE VA FOR WORK TO TAKE PLACE OUTSIDE THE LIMITS OF THE TEMPORARY CONSTRUCTION FENCE.
 - CONSTRUCTION LIMITS ARE TO ENCOMPASS PROJECT AREA, EQUIPMENT AND MATERIALS STORAGE/STAGING AND CONTRACTOR PARKING. NO OTHER AREA WILL BE MADE AVAILABLE TO THE CONTRACTOR FOR THESE PURPOSES DURING THE COMPLETION OF THE PROJECT. SEE ARCHITECTURAL SITE PLAN, SHEET AS001 FOR ADDITIONAL INFORMATION REGARDING CONSTRUCTION LIMITS AND STAGING.
 - CONTRACTOR PARKING: 10 PARKING STALLS WILL BE ALLOWED AT THE EAST CONTRACTOR PARKING LOT (PERMIT REQUIRED)
 - CONTRACTOR STORAGE TRAILER: 1 STORAGE TRAILER WILL BE ALLOWED AT THE EAST CONTRACTOR PARKING LOT
 - THE VA IS NOT RESPONSIBLE FOR ITEMS LOST OR STOLEN FROM CONTRACTOR VEHICLES OR STORAGE TRAILER
 - CONSTRUCTION STAGING AREA WEST OF BUILDING 28 IS TO BE REMOVED FOLLOWING COMPLETION OF PHASE 2 SHELL. RESTORE AND REESTABLISH TURF PER PROJECT GENERAL NOTES AND SPECIFICATIONS.
 - ALL OPEN TRENCHES SHALL BE BACKFILLED AT THE END OF EACH WORKING DAY. NO OPEN TRENCHES ALLOWED OVERNIGHT.
 - ALL EXCESS SOILS SHALL BE REMOVED FROM SITE.
 - COORDINATE REMOVALS WITH ARCHITECTURAL PLANS.
 - PROTECT EXISTING TREES NOT DESIGNATED TO BE REMOVED.

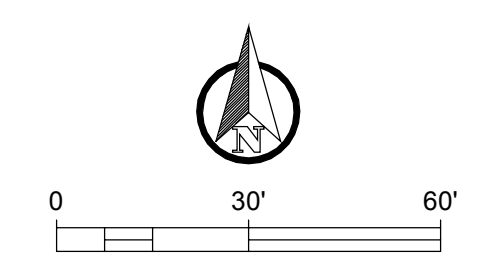

100% CD SET

3	AMENDMENT NO. 3	07.31.14
No	REVISION	DATE



Alexandria Office
120 17th Avenue W.
Alexandria, MN 56308
(509) 762-1290

St. Cloud Office
3339 West St. Germain, Suite 250
St. Cloud, MN 56301
(509) 217-5557



Alexandria
525 Broadway Street
Alexandria, MN 56308
phone 320.759.9030
facsimile 320.759.9062
www.jlcarchitects.com
copyright © 2013

DTE 02212001

STAMPED:
I HEREBY CERTIFY THAT THIS IS AN ORIGINATOR
OR DESIGNER AND I AM A REGISTERED
PROFESSIONAL ENGINEER UNDER THE
LAWS OF THE STATE OF MINNESOTA.

Daniel J. Folsom, PE
DANIEL J. FOLSCOM, PE
DATE: 07-31-2014

DRAWING TITLE
SITE: GRADING AND DRAINAGE PLAN

APPROVED PROJECT DIRECTOR
DATE:

PROJECT TITLE
RECONFIGURE/EXPAND BUILDINGS 28 & 9 RESIDENTIAL REHABILITATION TREATMENT PROGRAM

BUILDING No 28
CHECKED BY DJF
DRAWN BY GMD
CNO FILE

LOCATION
ST. CLOUD VA MEDICAL CENTER
ST. CLOUD, MN 56303

DATE
12.20.2013
PROJECT SCALE
AS NOTED
PROJECT NO.
656-12-339
DRAWING NO.
CG101

