

three inches = one foot
one and one half inches = one foot
one inch = one foot
three quarters inch = one foot
one half inch = one foot
three eighths inch = one foot
one quarter inch = one foot
one eighth inch = one foot

15:01:17-17-001 SPS Addition - Des Moines VA Med Ctr DRAWINGS\333-658-121_AD121.dwg 8-05-14 03:37:44 PM Neal

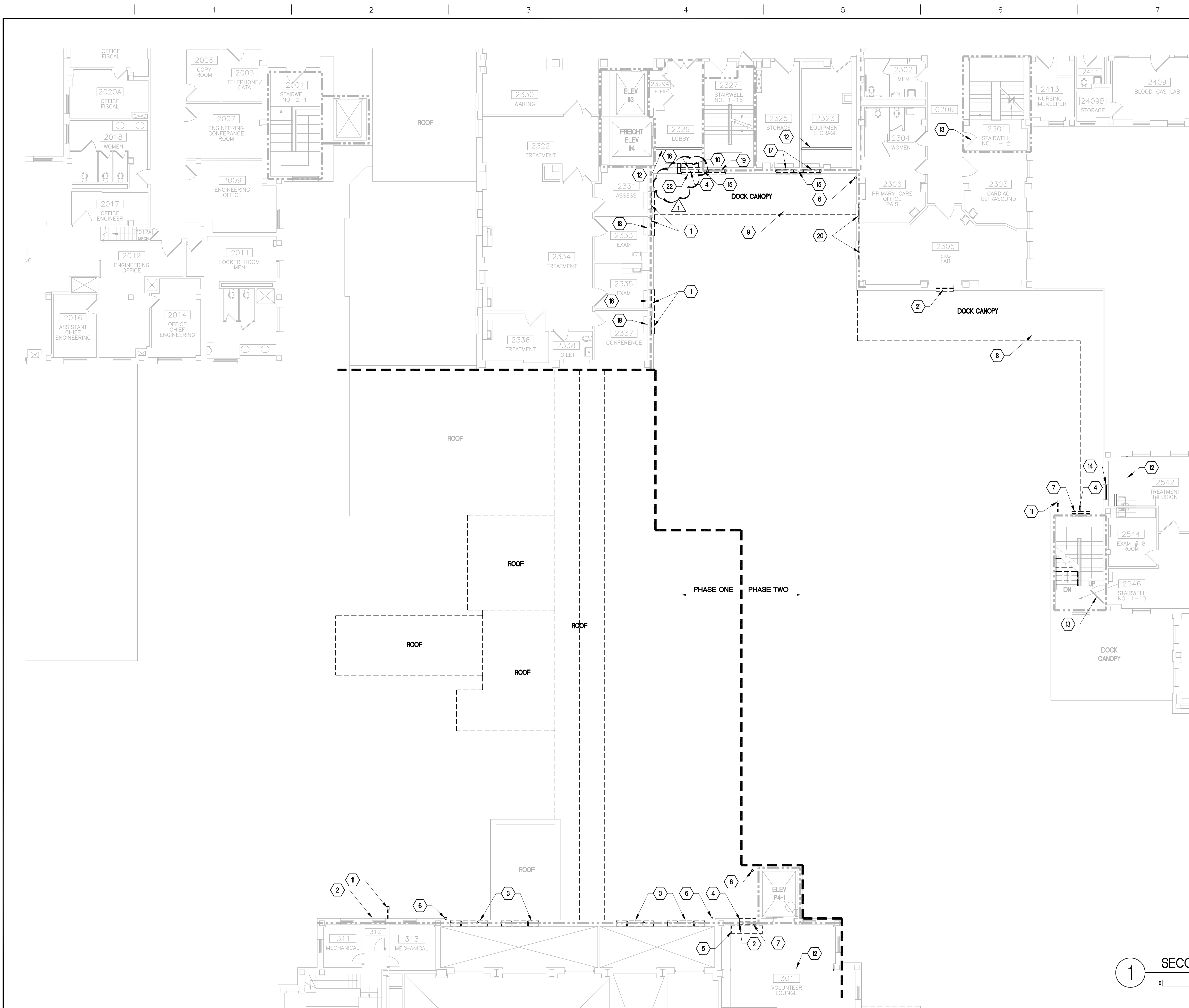

DEMOLITION FLOOR PLAN GENERAL NOTES

- ALL ITEMS SHOWN DASHED BOLD TO BE REMOVED COMPLETE UNLESS OTHERWISE NOTED.
- ALL ASSOCIATED ACCESS CARD CONTROL SYSTEMS SERVING EXISTING DOORS TO BE REMOVED, TO BE RETURNED TO THE GOVERNMENT.
- OMIT THE REQUIREMENT FOR PHASING UNDER ALTERNATE DEDUCT #1

DEMOLITION FLOOR PLAN KEYNOTES

- INFILL WINDOW OPENING ON EXISTING BUILDING SIDE WITH SHAFT WALL AND PAINT ENTIRE WALL TO MATCH ADJACENT FINISHES - SEE PLAN FOR WALL TYPE. ONCE SHAFT WALL IS INSTALLED, REMOVE WINDOW FRAME, SILL AND GLAZING COMPLETE FROM OPENING.
- AT B4 FIRST FLOOR BELOW, INFILL WINDOW OPENING ON EXISTING BUILDING SIDE WITH WALL TYPE 2B AND PAINT ENTIRE WALL TO MATCH ADJACENT FINISHES. ONCE SHAFT WALL IS INSTALLED, REMOVE WINDOW FRAME, SILL AND GLAZING COMPLETE FROM OPENING AND INFILL OPENING WITH FACE BRICK. SEE DETAIL 6/A-515.
- INFILL WINDOW OPENING ON INTERIOR BUILDING SIDE WITH WALL TYPE 2B AND PAINT ENTIRE WALL TO MATCH ADJACENT FINISHES. ONCE SHAFT WALL IS INSTALLED, REMOVE WINDOW FRAME, SILL AND GLAZING COMPLETE FROM OPENING AND INFILL OPENING WITH FACE BRICK. SEE DETAIL 6/A-515.
- REMOVE EXISTING WINDOW FRAME, SILL, AND GLAZING COMPLETE
- REMOVE AND RELOCATE EXISTING FAN COIL UNIT COMPLETE, SEE MECHANICAL
- REMOVE EXISTING STORM DRAIN AS REQUIRED, SEE PLUMBING FOR RELOCATION AND EXTENTS
- REMOVE WALL AS REQUIRED FOR NEW DOOR/OPENING. PATCH/REPAIR WAINSCOT WALL PROTECTION AS REQUIRED.
- REMOVE EXISTING CANOPY AND DOCK STRUCTURE BELOW COMPLETE
- REMOVE CANOPY STRUCTURE COMPLETE, EXISTING DOCK BELOW TO REMAIN
- REMOVE EXISTING FAN COIL UNIT COMPLETE, SEE MECHANICAL
- REMOVE EXISTING EXTERIOR WALL, MOUNTED LIGHT COMPLETE
- INSTALL TEMPORARY WALL DURING CONSTRUCTION - WALL TYPE 1C
- AUTHORITY HAVING JURISDICTION TO PROVIDE ALTERNATE MEANS OF EGRESS DURING CONSTRUCTION
- REMOVE WINDOW FRAME, SILL, AND GLAZING COMPLETE FROM OPENING AND INFILL PER DETAIL 1/A-512. PAINT ENTIRE WALL CORNER TO CORNER TO MATCH ADJACENT FINISHES.
- REMOVE INFILL BETWEEN WINDOWS AFTER SHAFT WALL INSTALLED ON INTERIOR.
- PATCH/REPAIR OR INFILL EXISTING VCT FLOORING FOR MECHANICAL DEMO AND DOOR/OPENING INSTALLATION.
- INFILL WINDOW OPENING ON EXISTING BUILDING SIDE WITH SHAFT WALL AND PROVIDE NEW WVC TO MATCH EXISTING FROM CORNER TO CORNER - SEE PLAN FOR WALL TYPE. ONCE SHAFT WALL IS INSTALLED, REMOVE WINDOW FRAME, SILL AND GLAZING COMPLETE FROM OPENING.
- REMOVE CEILING AS REQUIRED FOR INSTALLATION OF WINDOW INFILL AND REINSTALL CEILING.
- REMOVE WINDOW FRAME AND GLAZING COMPLETE AND IMMEDIATELY INFILL TO MINIMIZE DISRUPTION TO STAIR TOWER. PAINT ENTIRE WALL TO MATCH ADJACENT FINISHES - SEE PLAN FOR WALL TYPE. COORDINATE TIMING OF WORK WITH AUTHORITY HAVING JURISDICTION.
- REMOVE WINDOW FRAME AND GLAZING COMPLETE AND IMMEDIATELY INFILL. PAINT ENTIRE WALL TO MATCH ADJACENT FINISHES - SEE PLAN FOR WALL TYPE. WORK NEEDS TO BE DONE DURING NON-BUSINESS HOURS TO MINIMIZE DISRUPTION. SEE SHEET G002 FOR GENERAL NOTES.
- REMOVE WINDOW FRAME, SILL, AND GLAZING COMPLETE FROM OPENING AND INFILL PER DETAIL 1/A-512. PAINT ENTIRE WALL CORNER TO CORNER TO MATCH ADJACENT FINISHES. WORK NEEDS TO BE DONE DURING NON-BUSINESS HOURS TO MINIMIZE DISRUPTION. SEE SHEET G002 FOR GENERAL NOTES.
- REMOVE WALL AND CONCRETE FLOOR BASE AS REQUIRED FOR NEW OPENING. PATCH/REPAIR WAINSCOT WALL PROTECTION AS REQUIRED.

1 SECOND FLOOR DEMOLITION PLAN (PHASE ONE AND TWO)

0' 8' 16' 24' 1/8'

				ARCHITECT/ENGINEERS:		Drawing Title SECOND FLOOR DEMOLITION PLAN		Project Title BUILD SUPPLY, PROCESSING AND DISTRIBUTION		Project Number 636-121		Office of Construction and Facilities Management			
				 Kenneth Hahn Architects 1343 South 75th Street Omaha, NE 68124-1610 402.391.2111 www.kharch.com		Approved Project Director		Location VAMC DES MOINES IOWA		Building Number BUILDING 1W					
										Drawing Number AD121					
#1 AMENDMENT 002		08-07-14				AE Project # 171-001		Date 13 FEBRUARY 2014		Checked NAS		Drawn MTS		Dwg. 19 of 235	
Revisions		Date												Department of Veterans Affairs	