

three inches = one foot
one and one half inches = one foot
one inch = one foot
three quarters inch = one foot
one half inch = one foot
three eighths inch = one foot
one quarter inch = one foot
one eighth inch = one foot

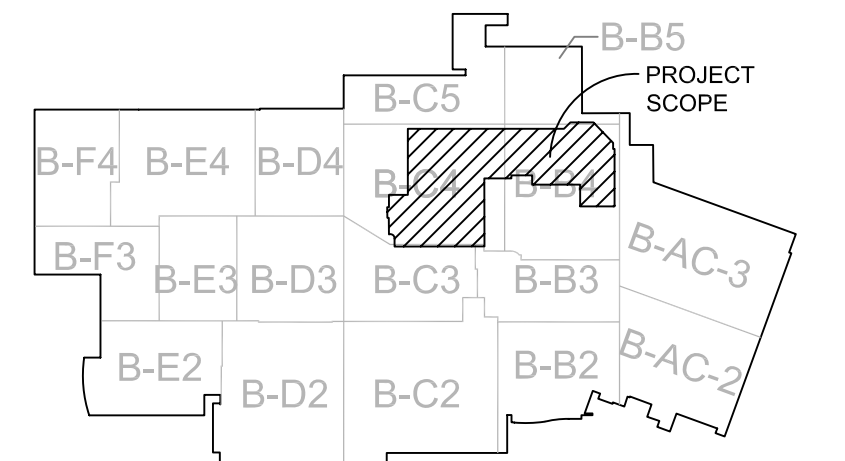
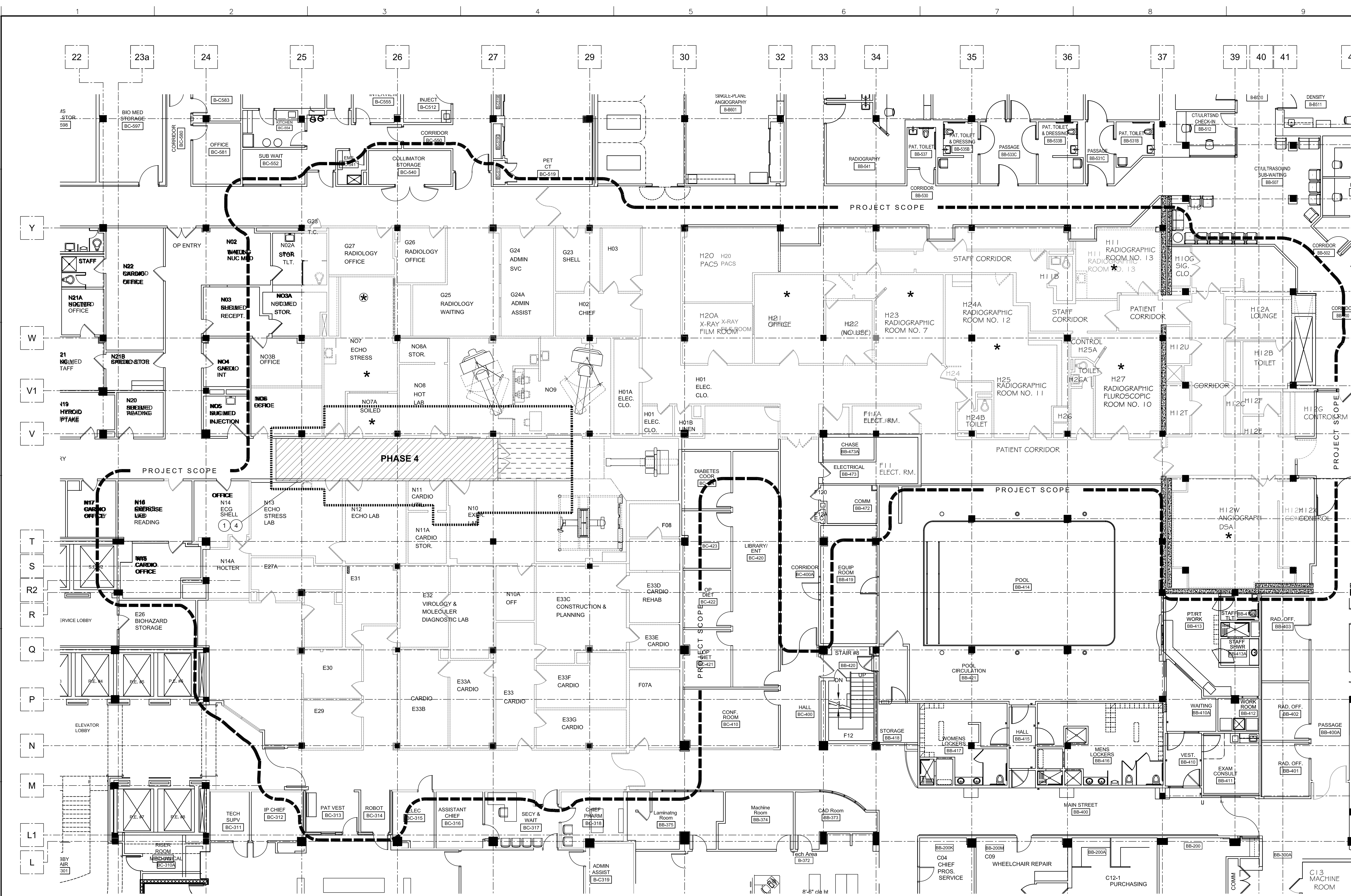

KEY PLAN - BASEMENT

Scale = None

NOTES

1. Install critical barriers and warning signs at entrances to each work area within the construction barrier entrances (see detail sheet 1-AA2.1)
2. Install 6 mil polyethylene drop cloth below pipe insulation joints to at least 6 ft horizontal distance from each pipe insulation joint to be removed.
3. Install negative air machines for local exhaust ventilation sufficient to maintain a pressure differential of at least 0.02 inches of water across every barrier separating the work area from the balance of the building or the outside and route exhaust to outside of building through secured outside door (see detail sheet 1-AA2.1)
4. Install three stage decontamination unit within the construction barrier entrances (see detail sheet 1-AA2.1)
5. Contractor shall reference Drawing 1-01.4 for sequencing of work in Phase 4.
6. Phase 4
Remove and dispose of approximately 45 each pipe insulation joints and 0 sq ft of asbestos-containing 9"x9" floor tile and mastic, 370 sq ft of asbestos-containing mastic below 12"x12" floor tiles and 120 sq ft of mastic below linoleum.
7. Remove and dispose of approximately 4,100 sq ft of lead lining presumed inside walls and windows as indicated.

- LEGEND:
- ACM MASTIC BELOW LINOLEUM
 - ASBESTOS-CONTAINING MASTIC BELOW 12"x12" FLOOR TILE
 - LEAD LINED WALLS
 - LEAD LINED CEILINGS
 - LIMIT OF ABATEMENT DURING THIS PHASE

Partial Basement Asbestos Abatement Plan - Phase 4

SCALE: 1/8"=1'-0"

| | |
|------------|----------|
| Bld Issue | 01/17/14 |
| Revisions: | Date |
| 1 | |
| 2 | |
| 3 | |
| 4 | |
| 5 | |
| 6 | |
| 7 | |
| 8 | |
| 9 | |
| 10 | |

CONSULTANTS:

STEPHEN J. SEBESTA & ASSOCIATES, INC.

CONSULTING ENVIRONMENTAL HEALTH ENGINEERS

17830 ENGLEWOOD DRIVE, SUITE 16, CLEVELAND, OHIO 44130 (216) 781-0060

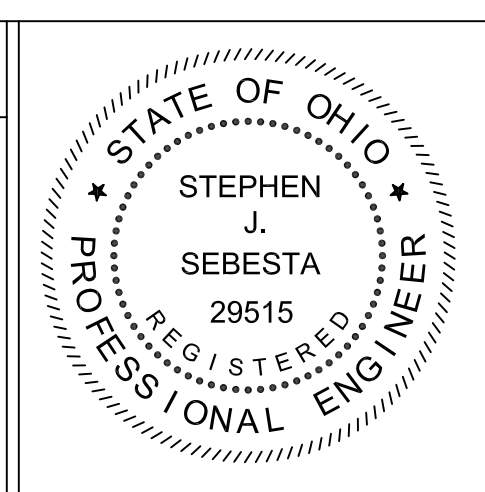

ARCHITECT:

Perspectus

13212 Shaker Square Suite 204 Cleveland, Ohio 44120
P. 216.752.1800 F. 216.752.3833

Drawing Title

PARTIAL BASEMENT ASBESTOS ABATEMENT PLAN - PHASE 4

Approved: Project Director

Project Title

EXPAND AND RENOVATE NUCLEAR MEDICINE AND RADIOLOGY

Location

VAMC - WADE PARK

Date

1-17-2014

Checked

EMO

Drawn

CAJ

Project Number

541-14-101

Building Number

1

Drawing Number

1-AA1.4

Dwg. 4 of 5

Office of Facilities Management

Department of Veterans Affairs

