

GENERAL NOTES:
1. THIS SHEET IS PROVIDED FOR INFORMATIONAL PURPOSES ONLY. THERE IS NO WORK ON THIS LEVEL.

The seal appearing on this document was authorized by Robert M. Dawns, 20878 on 5/28/2013. Alteration of a sealed document without proper notification to the responsible engineer is an offense under the Oklahoma Engineering Practice Act.

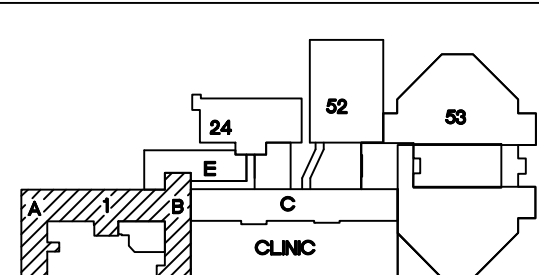

KEY PLAN
SCALE: NO SCALE
PROJECT NORTH

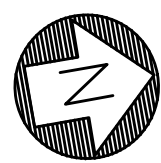

1 ATTIC, A-B WING: HVAC PLAN
1/8"=1'-0"

ASBESTOS NOTE:
IF THE EXECUTION OF THIS WORK REQUIRES THE DISTURBING OF ANY SUBSTANCE WHICH APPEARS TO BE ASBESTOS OR WHICH MAY CONTAIN ASBESTOS FIBER, NOTIFY THE OWNER BEFORE CONTINUING WORK AT THE SUSPECT LOCATION. ANY MATERIAL TESTING POSITIVE SHALL BE REMOVED BY THE OWNER BEFORE WORK CONTINUES.

NOTE: EXISTING CONDITIONS SHOWN WERE DERIVED FROM OWNER FURNISHED DRAWINGS AND FIELD OBSERVATIONS. SOME BUILDING FEATURES AND MEP SYSTEMS ARE NOT SHOWN FOR CLARITY. FIELD VERIFY BUILDING CONSTRUCTION. FIELD VERIFY THE LOCATION, SIZE AND QUANTITY OF ALL EQUIPMENT.

NOTE: REFER TO DETAILS AND SCHEMATICS FOR PIPING, VALVES, FITTINGS AND OTHER APPURTENANCES REQUIRED, BUT NOT SHOWN FOR CLARITY.

REVISIONS	DESCRIPTION	DATE



Dept. of Veterans Affairs
Jack C. Montgomery
Medical Center
1011 Honor Heights Drive
Muskogee, Oklahoma 74401

ENGINEER:
RMD CONSULTING, LLC
2815 VALLEY VIEW LANE, STE. 214
DALLAS, TX 75234
P: 972-488-8077 F: 972-488-8174
PROJECT NUMBER: 11-5801
OK REG. ENGINEERING FIRM: 5183

CONSULTANTS:
ARCHITECT:
ARCHITECTURAL CONCEPTS, INC.
669 AIRPORT FREEWAY, STE. 300
HURST, TX 76053
P: 817-285-8885 F: 817-285-8021

APPROVED:
APPROVED:
APPROVED:
APPROVED:

APPROVED: Interior Designer
APPROVED:
APPROVED:
APPROVED:

APPROVED: Safety Manager
APPROVED: Infection Control Nurse
APPROVED: Industrial Hygienist
APPROVED: President A.F.G.E. 2250

APPROVED: Medical Center Director
APPROVED: Associate Director
APPROVED: Chief of Staff
APPROVED: Chief of Engineering Service

DRAWING TITLE
ATTIC, A-B WING:
HVAC PLAN
PROJECT NO. 623-10-104
BUILDING NO. 01
CONTRACT NO. VA256-P-1355
AUTOCAD FILE NAME:

PROJECT TITLE
REPLACE INDUCTION
UNITS IN BLDG. #1
DESIGNED BY:
DRAWN BY:
CHECKED BY:
LOCATION
Jack C. Montgomery VA Medical Center

DATE
5/28/2013
SCALE
AS NOTED
DRAWING NO.
1-MH6.0
DWG. 43 OF 97

DEPARTMENT OF
VETERANS AFFAIRS

FAN COIL UNITS (2 PIPE SYSTEM)						COOLING										<div><div><div>X</div><div>XXXX</div></div>DESIGNATION AIR FLOW: SUPPLY/OA</div> <div><div><div>X</div><div>XXXX</div></div>DESIGNATION GPM</div>					
DESIGNATION	REFERENCE PRODUCT	TYPE	AIR FLOW RATE	EXT. STATIC PRESSURE	FILTER	SENSIBLE HEAT	TOTAL HEAT	AIR TEMP. EDB/EWB	AIR TEMP. LOB/LWB	WATER FLOW RATE	WATER PRESSURE DROP	WATER TEMP. EWT/LWT	ROWS/CIRC.	ELECTRICAL DATA			REMARKS:				
			CFM	IN. OF H ₂ O		MBH	MBH	°F	°F	GPC	FT. OF H ₂ O	°F		VOLTS	PHASE	FLA					
FCU-1 (1)	ENVIRO-TEC MODEL "HLE-20"	HOR. CAB.	230	0.0	1"	4.80	5.31	76/63	56.1/55	1.0	0.71	45/55.6	4/2	120	1	0.80	DBL DEFLECTION ALUM. SUPPLY GRILLE , SS DRAIN PAN, SS AUX. DRAIN PAN, SERVICE SWITCH, COND. SWITCH, HINGED RETURN GRILLE, AIR VENT. 2-WAY MOD. CONTROL VALVE, O/HM/L FAN SWITCH, CONTROL VALVES BY CONT. CONTRACTOR. PROVIDE UNIT HAND TO MAXIMIZE ACCESSIBILITY, REFER TO DRAWINGS.				
FCU-2 (1)	MODEL "HLE-20"	HOR. CAB.	230	0.0	1"	5.38	6.64	76/63	53.7/52.8	1.0	4.47	45/58.2	4/1	120	1	0.80	DBL DEFLECTION ALUM. SUPPLY GRILLE , SS DRAIN PAN, SS AUX. DRAIN PAN, SERVICE SWITCH, COND. SWITCH, HINGED RETURN GRILLE, AIR VENT. 2-WAY MOD. CONTROL VALVE, O/HM/L FAN SWITCH, CONTROL VALVES BY CONT. CONTRACTOR. PROVIDE UNIT HAND TO MAXIMIZE ACCESSIBILITY, REFER TO DRAWINGS.				
FCU-3 (1)	MODEL "HLE-20"	HOR. CAB.	230	0.0	1"	5.97	7.97	76/63	51.3/50.5	1.7	8.78	45/54.3	4/2	120	1	0.80	DBL DEFLECTION ALUM. SUPPLY GRILLE , SS DRAIN PAN, SS AUX. DRAIN PAN, SERVICE SWITCH, COND. SWITCH, HINGED RETURN GRILLE, AIR VENT. 2-WAY MOD. CONTROL VALVE, O/HM/L FAN SWITCH, CONTROL VALVES BY CONT. CONTRACTOR. PROVIDE UNIT HAND TO MAXIMIZE ACCESSIBILITY, REFER TO DRAWINGS.				
FCU-4 (1)	MODEL "HLE-30"	HOR. CAB.	470	0.0	1"	9.08	10.51	76/63	57.5/55.2	2.0	2.08	45/55.5	3/2	120	1	1.90	DBL DEFLECTION ALUM. SUPPLY GRILLE , SS DRAIN PAN, SS AUX. DRAIN PAN, SERVICE SWITCH, COND. SWITCH, HINGED RETURN GRILLE, AIR VENT. 2-WAY MOD. CONTROL VALVE, O/HM/L FAN SWITCH, CONTROL VALVES BY CONT. CONTRACTOR. PROVIDE UNIT HAND TO MAXIMIZE ACCESSIBILITY, REFER TO DRAWINGS.				
FCU-5 (1)	MODEL "HLE-40"	HOR. CAB.	515	0.0	1"	11.03	12.91	76/63	55.5/54.2	1.7	2.48	45/60.1	4/2	120	1	2.50	DBL DEFLECTION ALUM. SUPPLY GRILLE , SS DRAIN PAN, SS AUX. DRAIN PAN, SERVICE SWITCH, COND. SWITCH, HINGED RETURN GRILLE, AIR VENT. 2-WAY MOD. CONTROL VALVE, O/HM/L FAN SWITCH, CONTROL VALVES BY CONT. CONTRACTOR. PROVIDE UNIT HAND TO MAXIMIZE ACCESSIBILITY, REFER TO DRAWINGS.				
FCU-6 (1)	MODEL "HLE-40"	HOR. CAB.	515	0.0	1"	13.33	17.97	76/63	51.3/50.3	4.4	12.52	45/53.0	4/2	120	1	2.50	DBL DEFLECTION ALUM. SUPPLY GRILLE , SS DRAIN PAN, SS AUX. DRAIN PAN, SERVICE SWITCH, COND. SWITCH, HINGED RETURN GRILLE, AIR VENT. 2-WAY MOD. CONTROL VALVE, O/HM/L FAN SWITCH, CONTROL VALVES BY CONT. CONTRACTOR. PROVIDE UNIT HAND TO MAXIMIZE ACCESSIBILITY, REFER TO DRAWINGS.				
FCU-7 (1)	MODEL "HLP-20"	HOR. PLEN.	163	0.15	1"	3.91	4.97	76/63	53.1/52.1	1.0	3.3	45/55.0	3/1	120	1	0.80	SS DRAIN PAN, SS AUX. DRAIN PAN, SERVICE SWITCH, COND. SWITCH, AIR VENT. 2-WAY MOD. CONTROL VALVE, O/HM/L FAN SWITCH, CONTROL VALVE BY CONT. CONTRACTOR. PROVIDE UNIT HAND TO MAXIMIZE ACCESSIBILITY, REFER TO DRAWINGS.				

(1) UNITS ARE SCHEDULED AT MEDIUM FAN SPEED, 1000 FEET ELEVATION.

FAN COIL UNITS (4 PIPE SYSTEM, HOT WATER)						COOLING										HEATING										<div><div><div>X</div><div>XXXX</div></div>DESIGNATION AIR FLOW: SUPPLY/OA</div> <div><div><div>X</div><div>XXXX</div></div>DESIGNATION GPM</div>					
DESIGNATION	REFERENCE PRODUCT	TYPE	AIR FLOW RATE	EXT. STATIC PRESSURE	FILTER	SENSIBLE HEAT	TOTAL HEAT	AIR TEMP. EDB/EWB	AIR TEMP. LOB/LWB	WATER FLOW RATE	WATER PRESSURE DROP	WATER TEMP. EWT/LWT	ROWS/CIRC.	TOTAL HEAT	AIR TEMP. EDB/OB	WATER FLOW RATE	WATER PRESSURE DROP	WATER TEMP. EWT/LWT	ROWS/CIRC.	ELECTRICAL DATA			REMARKS:								
			CFM	IN. OF H ₂ O		MBH	MBH	°F	°F	GPC	FT. OF H ₂ O	°F		MBH	°F	GPC	FT. OF H ₂ O	°F		VOLTS	PHASE	FLA									
FCU-8 (1)	ENVIRO-TEC MODEL "HLP-40"	HOR. PLEN.	440	0.15	1"	11.21	14.79	76/63	51.6/50.8	2.9	6.03	45/55.1	4/2	7.18	68/96.7	0.5	0.35	180/125.6	1/1	120	1	2.50	SS DRAIN PAN, SS AUX. DRAIN PAN, SERVICE SWITCH, COND. SWITCH, AIR VENT. 2-WAY MOD. CONTROL VALVE, O/HM/L FAN SWITCH, CONTROL VALVES BY CONT. CONTRACTOR. PROVIDE UNIT HAND TO MAXIMIZE ACCESSIBILITY, REFER TO DRAWINGS.								
FCU-9 (1)	MODEL "HLP-50"	HOR. PLEN.	780	0.15	1"	16.70	20.96	76/63	55.9/53.7	4.2	10.26	45/55	3/2	12.80	68/93.6	1.0	0.22	180/136.2	1/1	120	1	4.20	SS DRAIN PAN, SS AUX. DRAIN PAN, SERVICE SWITCH, COND. SWITCH, AIR VENT. 2-WAY MOD. CONTROL VALVE, O/HM/L FAN SWITCH, CONTROL VALVES BY CONT. CONTRACTOR. PROVIDE UNIT HAND TO MAXIMIZE ACCESSIBILITY, REFER TO DRAWINGS.								
FCU-10 (1)	MODEL "HLE-20"	HOR. CAB.	230	0.0	1"	5.18	6.51	76/63	54.6/53	1.3	4.84	45/55	3/1	8.08	68/100	0.5	0.2	180/147.8	1/1	120	1	0.80	(2)								
FCU-11 (1)	MODEL "HLE-20"	HOR. CAB.	220	0.0	1"	5.74	7.60	76/63	51.5/50.7	1.5	7.61	45/54.9	4/1	8.23	68/101	0.5	0.2	180/148.2	1/1	120	1	0.80	(2)								
FCU-12 (1)	MODEL "HLP-25"	HOR. TELE.	230	0.15	1"	5.85	7.63	76/63	51.5/50.9	1.2	6.67	45/57.7	4/1	9.05	68/104	0.5	0.25	180/144.4	1/1	120	1	1.10	(3)								
FCU-13 (1)	MODEL "VFSC-03"	VERT. FLR.	270	0.0	1"	6.18	7.96	76/63	53.8/52.3	1.6	7.40	45/55.0	3/1	8.05	68/100	0.5	0.25	180/143.1	1/1	120	1	0.50	SLOPED TOP, DBL DEFLECTION STEEL SUPPLY GRILLE, SS DRAIN PAN, SERVICE SWITCH, COND. SWITCH, AIR VENT, O/HM/L FAN SWITCH, CONTROL VALVES BY CONTROL CONTRACTOR. REFER TO DRAWINGS FOR UNIT HAND.								
FCU-14 (1)	MODEL "VFSC-10"	VERT. FLR.	710	0.0	1"	16.20	20.61	76/63	54.2/52.7	3.4	9.44	45/57.0	3/2	16.20	68/100	1.0	1.93	180/130.4	1/1	120	1	1.10	SLOPED TOP, DBL DEFLECTION STEEL SUPPLY GRILLE, SS DRAIN PAN, SERVICE SWITCH, COND. SWITCH, AIR VENT, O/HM/L FAN SWITCH, CONTROL VALVES BY CONTROL CONTRACTOR. REFER TO DRAWINGS FOR UNIT HAND.								
FCU-16 (1)	MODEL "HLP-20"	HOR. PLEN.	157	0.15	1"	3.79	4.81	76/63	53/52	1.0	3.15	45/55.0	3/2	9.95	68/108	0.5	0.2	180/153.0	1/1	120	1	0.8	SS DRAIN PAN, SS AUX. DRAIN PAN, SERVICE SWITCH, COND. SWITCH, AIR VENT. 2-WAY MOD. CONTROL VALVE, O/HM/L FAN SWITCH, CONTROL VALVES BY CONT. CONTRACTOR. PROVIDE UNIT HAND TO MAXIMIZE ACCESSIBILITY, REFER TO DRAWINGS.								

(1) UNITS ARE SCHEDULED AT MEDIUM FAN SPEED, 1000 FEET ELEVATION.
(2) DBL DEFLECTION ALUM. SUPPLY GRILLE , SS DRAIN PAN, SS AUX. DRAIN PAN, SERVICE SWITCH, COND. SWITCH, HINGED RETURN GRILLE, AIR VENT. 2-WAY MOD. CONTROL VALVE, O/HM/L FAN SWITCH, CONTROL VALVES BY CONT. CONTRACTOR. PROVIDE UNIT HAND TO MAXIMIZE ACCESSIBILITY, REFER TO DRAWINGS.
(3) SS DRAIN PAN, SS AUX. DRAIN PAN, SERVICE SWITCH, COND. SWITCH, AIR VENT, RET. AIR PNL. W/ TELE. DUCT, 2-WAY MOD. CONTROL VALVE, O/HM/L FAN SWITCH, CONTROL VALVES BY CONT. CONTRACTOR. PROVIDE UNIT HAND TO MAXIMIZE ACCESSIBILITY, REFER TO DRAWINGS.

FAN COIL UNITS (4 PIPE SYSTEM, STEAM)						COOLING										HEATING										<div><div><div>X</div><div>XXXX</div></div>DESIGNATION AIR FLOW: SUPPLY/OA</div> <div><div><div>X</div><div>XXXX</div></div>DESIGNATION CAPACITY: GPM OR MBH/CONDENSATE</div>					
DESIGNATION	REFERENCE PRODUCT	TYPE	AIR FLOW RATE	EXT. STATIC PRESSURE	FILTER	SENSIBLE HEAT	TOTAL HEAT	AIR TEMP. EDB/DWB	AIR TEMP. LOB/LWB	WATER FLOW RATE	WATER PRESSURE DROP	WATER TEMP. EWT/LWT	ROWS/CIRC.	TOTAL HEAT	AIR TEMP. EDB/DWB	CONDENSATE	STEAM PRESSURE	ROWS/CIRC.	ELECTRICAL DATA			REMARKS:									
			CFM	IN. OF H ₂ O		MBH	MBH	°F	°F	GPC	FT. OF H ₂ O	°F		MBH	°F	LB/HR	PSI		VOLTS	PHASE	FLA										
FCU-15 (1)	ENVIRO-TEC MODEL "HLP-30"	HOR. PLEN.	370/460	0.15	1"	8.96	11.43	76/63	52.9/52.0	2.3	3.42	45/55	4/2	24.70	68/119.0	25.54	2.0	1/3	120	1	1.90	SS DRAIN PAN, SS AUX. DRAIN PAN, SERVICE SWITCH, COND. SWITCH, AIR VENT. 2-WAY MOD. CONTROL VALVE, O/HM/L FAN SWITCH & SERVICE VALVES BY CONT. CONTRACTOR. OPPOSITE HAND, REFER TO DRAWINGS.									

(1) UNIT COOLING IS SCHEDULED AT MEDIUM FAN SPEED, UNIT HEATING IS SCHEDULED AT HIGH FAN SPEED, 1000 FEET ELEVATION.

AIR HANDLING UNITS																	
DESIGNATION	REFERENCE PRODUCT	SERVES	TYPE	AIR FLOW RATE	TOT. STAT. PRESSURE (1)	ROTATION	MOTOR POWER		ELECTRICAL DATA		PRE-HEAT COIL	COOLING COIL	HUMIDIFIER	PRE-FILTER	FINAL FILTER	HUMIDIFIER	REMARKS :
				CFM	IN. OF H ₂ O		REV. MIN.	BHP	HP	VOLTS							
AHU-AB	TEMPROL MODEL "WF-RDH36"	BLDG. 1, WINGS A&B	HDT	15,110/18,100	7.58/3.50	3,500	6.3/25.22	10/40	460	3	PHC-AB	CC-AB	H-AB	PF-AB	PFF-AB/FF-AB	H-AB	ROOFTOP UNIT, 18"INSULATED ROOF CURB, 2X2 FAN WALL - 36HX36W - DESIGN CFM/SP W/ 1 FAILED FAN, VFD - ABB MODEL ACH550 WITH BYPASS AND LONWORKS.

(1) TOTAL/EXTERNAL AT 15,110 CFM, 9.8/25.06 AT 18,100 CFM, FILTERS AT MDLIFE PRESSURE DROP, 1000 FEET ELEVATION.

COOLING COILS (CHILLED WATER)													<div><div><div>X</div><div>XXXX</div></div>DESIGNATION CAPACITY: MBH/GPM</div>	
DESIGNATION	REFERENCE PRODUCT	SERVES	CAPACITY TOTAL	CAPACITY SENSIBLE	AIR FLOW RATE	AIR PRESS. DROP	AIR TEMP. EDB/DWB	AIR TEMP. LOB/LWB	WATER FLOW RATE	WATER PRESS. DROP	WATER TEMP. EWT/LWT	ROWS/FPI	REMARKS :	
			MBH	MBH	CFM	IN. OF H ₂ O	°F	°F	GPC	FT. OF H ₂ O	°F			
CC-AB (DESIGN)	TEMPROL MODEL "SWC-6-x-8-6AL"	AHU-AB	1,244	701	15,110	0.48	101/79	53.9/53.3	248	6.93	44/54	8/6	(2) 39H X 66L INTERTWINED COILS, 2 CONTROLS VALVES, COIL SIZED FOR FUTURE CAPACITY , 1000 FEET ELEVATION.	
CC-AB (FUTURE)	TEMPROL MODEL "SWC-6-x-8-6AL"	AHU-AB	1,442	839	18,100	0.64	101/79	55.7/54.8	287	12.44	44/54	8/6		

PRE-HEAT COILS (STEAM)			<div><div><div>X</div><div>XXXX</div></div>DESIGNATION CAPACITY: MBH/CONDENSATE</div>								
DESIGNATION	REFERENCE PRODUCT	SERVES	CAPACITY	AIR FLOW RATE	AIR PRESS. DROP	AIR TEMP. EDB/DWB	STEAM FLOW RATE	STM PRESS. SUP/PRES.	ROWS /FPI	NOM. SIZE	REMARKS :
			MBH	CFM	IN. OF H ₂ O	°F	LBSPH	PSI			
PHC-AB (DESIGN)	LJ WING MODEL "VC-8TX"	AHU-AB	1,378	15,110	0.33	10/97.3	1,435	15/5	3/10	90Lx68H	1000 FEET ELEVATION, ANTI-STRATIFICATION BAFFLES, 3" FLEXIBLE CONNECTORS W/ THREADED FITTINGS, CONFIGURED FOR FACE MOUNTED ACTUATOR BY CONT. CONTRACTOR. CONTROL VALVE BY CONTROL CONT. SIZE FOR FUTURE LOAD.
PHC-AB (FUTURE)	LJ WING MODEL "VC-8TX"	AHU-AB	1,591	18,100	0.43	10/94.0	1,656	15/5	3/10	90Lx68H	

AIR FILTERS											
DESIGNATION	REFERENCE PRODUCT	SERVES	TYPE	MAX AIR FLOW	UNIT SIZE	OVERALL DIMENSIONS	MAX. FACE VELOCITY	EFFICIENCY	AIR PRESS. DROP	ACCESS	REMARKS :
				CFM	INCHES		FTM	MEV u/s	IN. OF WATER		
PF-AB	FARR MODEL "30/30"	AHU-AB	PNL	18,100	-	72H x 108W	350	8	0.08/0.50	FACE	DWYER MODEL 2001 FILTER GAUGE
PFF-AB	FARR MODEL "30/30"	AHU-AB	PNL	18,100	-	72H x 72W	510	8	0.08/0.50	FACE	DWYER MODEL 2003 FILTER GAUGE
FF-AB	FARR MODEL "DURAFIL ESB"	AHU-AB	PNL	18,100	-	72H x 72W	510	14	0.34/1.50	FACE	

BASEBOARD HEATING UNIT (STEAM)											
DESIGNATION	REFERENCE PRODUCT	TYPE	HEIGHT	CAPACITY	STEAM FLOW RATE	STEAM PRESS.	TUBE DIA./LENGTH	FIN SIZE	FINS PER INCH	COLOR	REMARKS :
				MBH	LB/Hr	PSI					
SR-A	STERLING MODEL "JVB-S14"	CONV.	14"	6.6	6.8	2	3/4" x 4' CPR	4.25" x 3.625"	40	BY VA	SLOPED TOP, PENCIL PROOF, KNOB DAMPER, 14 GA CRS. BAKED ENAMEL, END PLATES W/ ACCESS PNL, FULL HT BACKPLATE, BRACKETS.
SR-B	STERLING MODEL "JVB-S14"	CONV.	14"	4.9	5.2	2	3/4" x 3' CPR	4.25" x 3.625"	40	BY VA	SLOPED TOP, PENCIL PROOF, KNOB DAMPER, 14 GA CRS. BAKED ENAMEL, END PLATES W/ ACCESS PNL, FULL HT BACKPLATE, BRACKETS.

HUMIDIFIERS													
DESIGNATION	REFERENCE PRODUCT	SERVES	STEAM FLOW RATE	SUPPLY STEAM PRESS	ROOM CONDITIONS		DUCT TEMP.	MAX. DISP. DIST.	DUCT SIZE	AIR FLOW RATE	OUTSIDE AIR FLOW RATE	VELOCITY	REMARKS :
			GDPH	PSIG	DESIGN TEMP	DESIGN RH	°F	°C	IN	IN	CFM	CFM	
H-AB	NORTEC MODEL "LIVESTEAM"	AHU-AB	500.37	15	72	50	80	0.4	86x54W	15,110	15,110	*	REFER TO DETAIL, STEAM SEPARATOR MODEL 200, MODULATING ACTUATOR, SAM-E 48" HEADER ON 3" CENTERS, 304SS TUBES, MOUNTING FRAME, INLET ADAPTER, TRAP, STRAINER

REFER TO ARCHITECTURAL PLANS FOR CEILING TYPES AND MOUNTING REQUIRED.

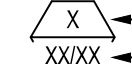
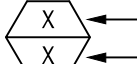
TERMINAL AIR BOXES					DESIGNATION AIR FLOW: MAX/MIN		DESIGNATION GPM					
DESIGNATION	REFERENCE PRODUCT	TYPE	INLET SIZE	MAX. AIR FLOW	MIN. INLET S.P.	AIR PRESSURE DROP	HEATING COIL					REMARKS:
			IN.	CFM	IN. WG	IN. WG	CFM	INCH	GPM	BHP/FT.	# OF ROWS	
AA	TITUS	VAV	5	300	0.41	0.11	100	5.4	0.50	0.20	1	W/ CROSS FLOW SENSOR, DDC CONTROLS
BB	MODEL "DES"Y		6	400	0.55	0.25	150	6.20	0.50	0.20	1	
CC			6	400	0.65	0.35	200	11.7	0.70	0.10	2	
DD			7	540	0.52	0.22	200	8.3	0.60	0.30	1	
EE			7	540	0.63	0.33	240	14.3	0.70	0.20	2	
FF			8	600	0.68	0.16	200	8.0	0.50	0.20	1	
GG			8	600	0.59	0.29	240	14.3	0.70	0.20	2	
HH			10	900	0.46	0.16	240	9.5	0.50	0.10	1	
JJ			10	900	0.60	0.30	330	20.1	1.00	0.20	2	
KK			12	1200	0.45	0.15	400	15.6	0.90	0.20	1	
LL			12	1200	0.58	0.28	400	23.9	0.90	0.20	2	
MM			14	1700	0.46	0.16	500	20.7	1.10	0.20	1	
NN			14	1700	0.58	0.28	600	35.6	1.30	0.30	2	
PP			16	2200	0.47	0.17	660	26.5	1.40	0.30	1	
RR			16	2200	0.61	0.31	720	42.7	1.70	0.20	2	

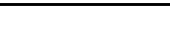

Dept. of Veterans Affairs
Jack C. Montgomery
Medical Center
1011 Honor Heights Drive
Muskogee, Oklahoma 74401

CONSULTANTS:
ARCHITECT: ARCHITECTURAL CONCEPTS, INC. 669 AIRPORT FREEWAY, STE. 300 HURST, TX 76053 P: 817-285-8885 F: 817-285-8021

DATE
5/28/2013
SCALE
AS NOTED
DRAWING NO.
1-MH7.1
DWG. 45 OF 97

DEPARTMENT OF
VETERANS AFFAIRS[illegible]

AS-1: BELL & GOSSETT SEDIMENT REMOVAL SEPARATOR, MODEL "SRS-4F", 4" INLET/OUTLET, FLANGED, 300 GPM, 1.7 FT WPD. PROVIDE MODEL "107A" AIR VENT & MODEL "MBV-1" MANUAL BLOWDOWN VALVE.