

1 LEVEL 4, WING C: PENTHOUSE & ROOF ELECTRICAL DEMOLITION PLAN

SCALE: 1/8" = 1' - 0"

KEYED DEMOLITION NOTES:

- EXISTING EXHAUST FAN TO BE REMOVED BY MECHANICAL CONTRACTOR. ELECTRICAL CONTRACTOR SHALL DISCONNECT AND REMOVE ALL RELATED BRANCH CIRCUIT WIRE AND CONDUIT IN ITS ENTIRETY. INACCESSIBLE CONDUIT CONCEALED IN WALLS AND/OR IN CONCRETE SLAB MAY BE ABANDONED IN PLACE. REMOVE ANY ASSOCIATED DISCONNECT SWITCHES, STARTERS, ETC., WHERE SUCH EXIST. STORE OR DISPOSE OF DEMOLISHED MATERIALS AS DIRECTED BY VA CONTRACTING OFFICER. UPDATE DIRECTORY AND/OR RE-LABEL CIRCUIT BREAKER IN EXISTING SERVING PANEL AS "SPARE".
- EXISTING EXHAUST FAN TO BE REMOVED AND REPLACED WITH NEW BY MECHANICAL CONTRACTOR. ELECTRICAL CONTRACTOR SHALL OPEN SERVING CIRCUIT BREAKER AND SHALL LOCK OUT/TAG OUT THIS DEVICE FOR THE DURATION OF THIS FAN REPLACEMENT. E.C. SHALL DISCONNECT EXISTING BRANCH CIRCUIT AT EXHAUST FAN LOCATION AND SHALL MAKE SAFE DISCONNECTED CONDUCTORS. E.C. SHALL MAKE ALL REQUIRED ELECTRICAL CONNECTIONS TO NEW FAN ONCE INSTALLED AND ASSURE PROPER OPERATION AS BEFORE.
- EXISTING AIR HANDLING UNIT TO BE REMOVED BY MECHANICAL CONTRACTOR. ELECTRICAL CONTRACTOR SHALL DISCONNECT AND REMOVE ALL RELATED BRANCH CIRCUIT AND CONTROLS WIRE AND CONDUIT IN ITS ENTIRETY. INACCESSIBLE CONDUIT CONCEALED IN WALLS AND/OR IN CONCRETE SLAB MAY BE ABANDONED IN PLACE. REMOVE ANY ASSOCIATED DISCONNECT SWITCHES, STARTERS, ETC., WHERE SUCH EXIST. STORE OR DISPOSE OF DEMOLISHED MATERIALS AS DIRECTED BY VA CONTRACTING OFFICER. UPDATE DIRECTORY AND/OR RE-LABEL CIRCUIT BREAKER IN EXISTING SERVING PANEL AS "SPARE".

ASBESTOS NOTE:
IF THE EXECUTION OF THIS WORK REQUIRES THE DISTURBING OF ANY SUBSTANCE WHICH APPEARS TO BE ASBESTOS OR WHICH MAY CONTAIN ASBESTOS FIBER, NOTIFY THE OWNER BEFORE CONTINUING WORK AT THE SUSPECT LOCATION. ANY MATERIAL TESTING POSITIVE SHALL BE REMOVED BY THE OWNER BEFORE WORK CONTINUES.

NOTE: EXISTING CONDITIONS SHOWN WERE DERIVED FROM OWNER FURNISHED DRAWINGS AND FIELD OBSERVATIONS. SOME BUILDING FEATURES AND MEP SYSTEMS ARE NOT SHOWN FOR CLARITY. FIELD VERIFY BUILDING CONSTRUCTION. FIELD VERIFY THE LOCATION, SIZE AND QUANTITY OF ALL EQUIPMENT.

The seal appearing on this document was authorized by Stanley A. Curtis, 201789 on 04/10/2013. Alteration of a sealed document without proper notification to the responsible engineer is an offense under the Oklahoma Engineering Practice Act.

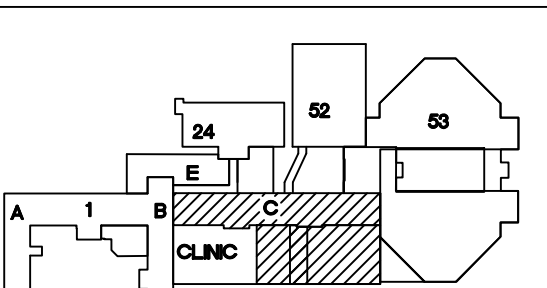

KEY PLAN
SCALE: NO SCALE



REVISIONS	DESCRIPTION	DATE



Dept. of Veterans Affairs
Jack C. Montgomery
Medical Center
1011 Honor Height Drive
Muskogee, Oklahoma 74401

ENGINEER:

RMD CONSULTING, LLC
2815 VALLEY VIEW LANE, STE. 214
DALLAS, TX 75234
P: 972-488-8077 F: 972-488-8174
OK REG. ENGINEERING FIRM: 5183

CONSULTANTS:

ARCHITECT:
ARCHITECTURAL CONCEPTS, INC.
669 AIRPORT FREEWAY, STE. 300
HURST, TX 76053
P: 817-285-8885 F: 817-285-8021

APPROVED:	APPROVED: Interior Designer	APPROVED: Safety Manager	APPROVED: Medical Center Director
APPROVED:	APPROVED:	APPROVED: Infection Control Nurse	APPROVED: Associate Director
APPROVED:	APPROVED:	APPROVED: Industrial Hygienist	APPROVED: Chief of Staff
APPROVED:	APPROVED:	APPROVED: President A.F.G.E. 2250	APPROVED: Chief of Engineering Service

DRAWING TITLE: LEVEL 4, WING C: PENTHOUSE & ROOF ELEC. DEMOLITION PLAN	
PROJECT NO. 623-11-107	CONTRACT NO. VA256-12-C-0295
BUILDING NO. CLINICAL	AUTOCAD FILE NAME:

PROJECT TITLE: REPLACE LABORATORY AIR HANDLING UNITS		
DESIGNED BY: TGB	DRAWN BY: TGB	CHECKED BY: SRC
LOCATION Jack C. Montgomery VA Medical Center		

DATE 8/19/2013
SCALE AS SHOWN
DRAWING NO. ED3.0
DWG. 31 OF 40

DEPARTMENT OF
VETERANS AFFAIRS