

1 LEVEL 4, WING C: PENTHOUSE & ROOF ELECTRICAL RENOVATION PLAN

SCALE: 1/8" = 1' - 0"

KEYED RENOVATION NOTES:

- SINGLE-POINT POWER CONNECTION FOR MOTORS - DISCONNECT IS FACTORY INSTALLED AND INTEGRAL TO UNIT. FIELD-VERIFY EXACT PHYSICAL LOCATION ON UNIT.
- SINGLE-POINT POWER CONNECTION FOR LIGHTS/RECEPTACLES - CONNECTION POINT/JUNCTION BOX IS FACTORY INSTALLED AND INTEGRAL TO UNIT. FIELD-VERIFY EXACT PHYSICAL LOCATION ON UNIT.
- CONNECT TO SPARE 20A/1P CIRCUIT BREAKER IN EXISTING PANELBOARD INDICATED. IF NO SUCH SPARE EXISTS, FURNISH AND INSTALL A NEW 20A/1P CIRCUIT BREAKER. THE NEW CIRCUIT BREAKER SHALL BE OF THE SAME MANUFACTURER AS THE PANELBOARD, AND SHALL BE THE SAME TYPE AND HAVE THE SAME INTERRUPTING RATING AS EXISTING CIRCUIT BREAKERS ALREADY INSTALLED IN THE PANELBOARD.
- CONNECT NEW EXHAUST FAN TO EXISTING BRANCH CIRCUIT LEFT AVAILABLE BY THE REMOVAL OF THE PREVIOUS EXHAUST FAN AND CONFIRM PROPER OPERATION.

- FURNISH & INSTALL NEW DUCT SMOKE DETECTOR IN NEW EXHAUST AIR DUCT OF NEW "HRU-5" (LOCATED BELOW SUPPLY AIR DUCT) AND CONNECT TO EXISTING FIRE ALARM SLC ADDRESSABLE LOOP CIRCUIT. THE NEW DETECTOR SHALL BE OF THE SAME MANUFACTURER AS THE EXISTING FIRE ALARM SYSTEM, SHALL BE THE SAME TYPE AND MODEL AS OTHER EXISTING DUCT SMOKE DETECTORS ON THIS SYSTEM, AND SHALL BE EQUIPPED WITH NUMBER OF CONTACTS AS REQUIRED FOR BOTH FIRE ALARM SYSTEM OPERATIONS AND MECHANICAL SHUTDOWN FUNCTIONS. MOUNT DETECTOR IN A NEW 4" WEATHERPROOF ENCLOSURE. NEW SAMPLING TUBES SHALL BE INSTALLED AS REQUIRED TO CONFORM TO THE NEW DUCT DIMENSIONS - COORDINATE INSTALLATION WITH MECHANICAL CONTRACTOR. UPON COMPLETION OF INSTALLATION, RUN FIRE ALARM SYSTEM DIAGNOSTIC CHECK TO CONFIRM PROPER OPERATION.
- CONNECT TO EXISTING 15A/3P CIRCUIT BREAKER INDICATED IN EXISTING "MCC2". REFER TO "MCC2" SCHEDULE ON SHEET EP4.0 FOR ADDITIONAL INFORMATION.

ASBESTOS NOTE:
IF THE EXECUTION OF THIS WORK REQUIRES THE DISTURBING OF ANY SUBSTANCE WHICH APPEARS TO BE ASBESTOS OR WHICH MAY CONTAIN ASBESTOS FIBER, NOTIFY THE OWNER BEFORE CONTINUING WORK AT THE SUSPECT LOCATION. ANY MATERIAL TESTING POSITIVE SHALL BE REMOVED BY THE OWNER BEFORE WORK CONTINUES.

NOTE: EXISTING CONDITIONS SHOWN WERE DERIVED FROM OWNER FURNISHED DRAWINGS AND FIELD OBSERVATIONS. SOME BUILDING FEATURES AND MEP SYSTEMS ARE NOT SHOWN FOR CLARITY. FIELD VERIFY BUILDING CONSTRUCTION. FIELD VERIFY THE LOCATION, SIZE AND QUANTITY OF ALL EQUIPMENT.

The seal appearing on this document was authorized by Stanley A. Curtis, 201789 on 04/10/2013. Attention: If a sealed document without proper notification to the responsible engineer is not otherwise under the Oklahoma Engineering Practice Act.



8/19/2013

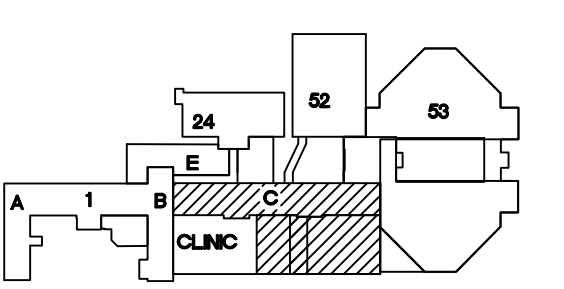

KEY PLAN
SCALE: NO SCALE



REVISIONS	DESCRIPTION	DATE



Dept. of Veterans Affairs
Jack C. Montgomery
Medical Center
1011 Honor Height Drive
Muskogee, Oklahoma 74401

ENGINEER:

RMD CONSULTING, LLC
2815 VALLEY VIEW LANE, STE. 214
DALLAS, TX 75234
P: 972-488-8077 F: 972-488-8174
OK REG. ENGINEERING FIRM: 5183

CONSULTANTS:

ARCHITECT:
ARCHITECTURAL CONCEPTS, INC.
669 AIRPORT FREEWAY, STE. 300
HURST, TX 76053
P: 817-285-8885 F: 817-285-8021

APPROVED:	APPROVED: Interior Designer
APPROVED:	APPROVED:
APPROVED:	APPROVED:
APPROVED:	APPROVED:

APPROVED: Safety Manager
APPROVED: Infection Control Nurse
APPROVED: Industrial Hygienist
APPROVED: President A.F.G.E. 2250

APPROVED: Medical Center Director
APPROVED: Associate Director
APPROVED: Chief of Staff
APPROVED: Chief of Engineering Service

DRAWING TITLE: LEVEL 4, WING C: PENTHOUSE & ROOF ELEC. RENOVATION PLAN
PROJECT NO. 623-11-107
BUILDING NO. CLINICAL

CONTRACT NO. VA256-12-C-0295
AUTOCAD FILE NAME:

PROJECT TITLE: REPLACE LABORATORY AIR HANDLING UNITS
DESIGNED BY: TGB
DRAWN BY: TGB
CHECKED BY: SRC

LOCATION Jack C. Montgomery VA Medical Center
--

DATE 8/19/2013
SCALE AS SHOWN
DRAWING NO. EP3.0
DWG. 34 OF 40

DEPARTMENT OF
VETERANS AFFAIRS