

GENERAL NOTES:

1. MPS IS SET TO 75-80 PSI (LPRV).
2. LPS IS SET TO 6 PSI (LPRV).
3. PRIVAB IS SET TO 19 PSI.

KEYED NOTES:

1. REMOVE ABANDONED GLYCOL FEED PUMP, IN LINE PUMP, EXP. TANK, GLYCOL TANK, COMPLETE. REMOVE 1-1/2" GLYCOL PIPING INSIDE MECH. RM. BACK TO HEADER IN INTERSTITIAL SPACE. PATCH MECH. RM. WALL TO MATCH EXISTING.
2. REMOVE HISTOLOGY AHU COMPLETE. REMOVE CHSR, HWHSR, LPC AND LPS BACK TO MAIN. PROVIDE ISOLATION VALVE AT MAIN TAP. CAP PIPING AT NEW VALVE. REMOVE DRAIN LINES.
3. REMOVE AHU-5, COMPLETE. REMOVE CHSR, HWHSR, LPC AND LPS BACK TO TAPS SERVING AHU-5. PROVIDE ISOLATION VALVE AT TAP. CAP CHSR, HWHSR PIPING AT NEW VALVE. REMOVE DRAIN LINES.
4. REMOVE SECTION OF EXISTING ROOF DRAIN PIPING ROUTED ABOVE EXISTING AHU-5. REROUTE PIPING AS REQ'D TO INSTALL NEW AHU-5.
5. REMOVE SECTION OF LPC SERVING AHU-5. REWORK LPC AS INDICATED ON HVAC PIPING PLAN.
6. CAP AND ABANDON GLYCOL ENERGY RECOVERY LOOP. PIPING IS LOCATED NEAR ROOF OF INTERSTITIAL SPACE.

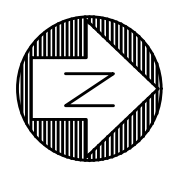

1 LEVEL 3, WING C: INTERSTITIAL HVAC PIPING DEMO PLAN

1/8"=1'-0"

The seal appearing on this document was authorized by Robert M. Dawns, 20879 on 07/19/2013. Alteration of a sealed document without proper notation to the responsible engineer is an offense under the Oklahoma Engineering Practice Act.

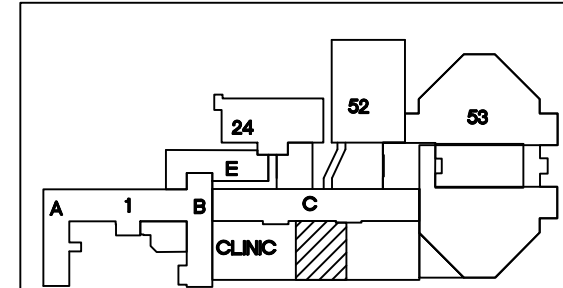

KEY PLAN

SCALE: NO SCALE



ASBESTOS NOTE:
IF THE EXECUTION OF THIS WORK REQUIRES THE DISTURBING OF ANY SUBSTANCE WHICH APPEARS TO BE ASBESTOS OR WHICH MAY CONTAIN ASBESTOS FIBER, NOTIFY THE OWNER BEFORE CONTINUING WORK AT THE SUSPECT LOCATION. ANY MATERIAL TESTING POSITIVE SHALL BE REMOVED BY THE OWNER BEFORE WORK CONTINUES.

NOTE: EXISTING CONDITIONS SHOWN WERE DERIVED FROM OWNER FURNISHED DRAWINGS AND FIELD OBSERVATIONS. SOME BUILDING FEATURES AND MEP SYSTEMS ARE NOT SHOWN FOR CLARITY. FIELD VERIFY BUILDING CONSTRUCTION. FIELD VERIFY THE LOCATION, SIZE AND QUANTITY OF ALL EQUIPMENT.

NOTE: REFER TO DETAILS AND SCHEMATICS FOR PIPING, VALVES, FITTINGS AND OTHER APPURTENANCES REQUIRED, BUT NOT SHOWN FOR CLARITY.

REVISIONS	DESCRIPTION	DATE



Dept. of Veterans Affairs
Jack C. Montgomery
Medical Center
1011 Honor Height Drive
Muskogee, Oklahoma 74401

ENGINEER:

RMD CONSULTING, LLC
2815 VALLEY VIEW LANE, STE. 214
DALLAS, TX 75234
P: 972-488-8077 F: 972-488-8174
OK REG. ENGINEERING FIRM: 5183

CONSULTANTS:

ARCHITECT:
ARCHITECTURAL CONCEPTS, INC.
669 AIRPORT FREEWAY, STE. 300
HURST, TX 76053
P: 817-285-8885 F: 817-285-8021

APPROVED:	APPROVED: Interior Designer	APPROVED: Safety Manager	APPROVED: Medical Center Director
APPROVED:	APPROVED:	APPROVED: Infection Control Nurse	APPROVED: Associate Director
APPROVED:	APPROVED:	APPROVED: Industrial Hygienist	APPROVED: Chief of Staff
APPROVED:	APPROVED:	APPROVED: President A.F.C.E. 2250	APPROVED: Chief of Engineering Service

DRAWING TITLE	LEVEL 3, WING C: INTERSTITIAL HVAC PIPING DEMO PLAN
PROJECT NO.	623-11-107
CONTRACT NO.	VA256-12-C-0295
BUILDING NO.	CLINICAL
AUTOCAD FILE NAME	

PROJECT TITLE		
REPLACE LABORATORY AIR HANDLING UNITS		
DESIGNED BY:	DRAWN BY:	CHECKED BY:
LOCATION		
Jack C. Montgomery VA Medical Center		

DEPARTMENT OF
VETERANS AFFAIRS