

1 LEVEL 2, WING C, PARTIAL FLOOR PLAN: PHASING PLAN
18-11-10

- KEYED NOTES:**
- 1 EQUIPMENT MAY REQUIRE ACCESS FOR A SHORT DURATION.
 - 2 EQUIPMENT MAY REQUIRE ACCESS.
 - 3 PATH OF EGRESS MAY BE REQUIRED DURING PHASE 11. COORDINATE REQUIREMENTS AND SCHEDULE WITH COR.
 - 4 EQUIPMENT REQUIRING TEMPORARY ENCLOSURE AND PRESSURIZED FILTRATION DURING PHASE 12 AND 13. REFER TO DETAIL 2, THIS SHEET.

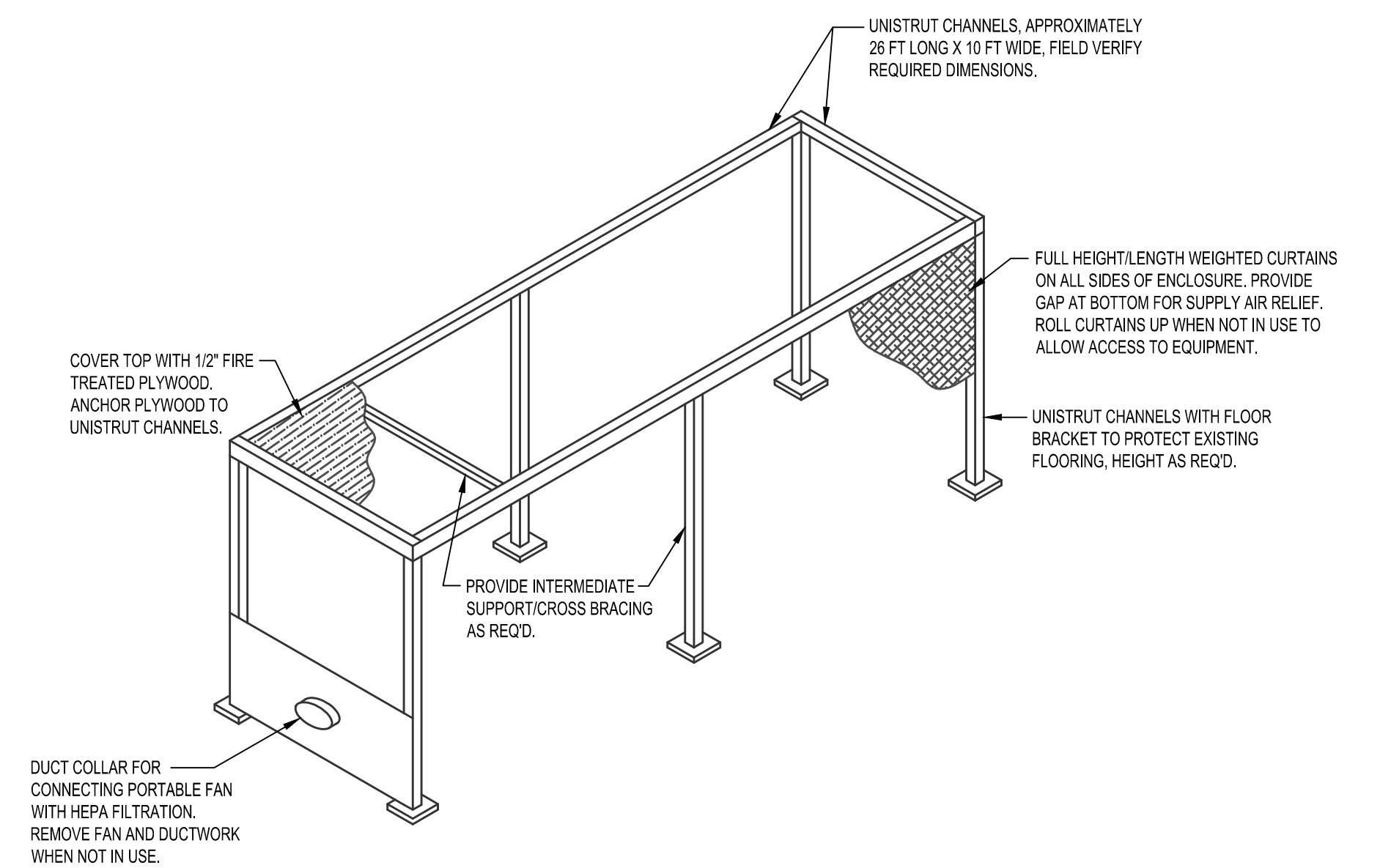

2 TEMPORARY EQUIPMENT ENCLOSURE
N.T.S.

The seal appearing on this document was authorized by Robert M. Dawns, 20879 on 01/16/2013. Alteration of a sealed document without proper notation to the responsible engineer is an offense under the Oklahoma Engineering Practice Act.

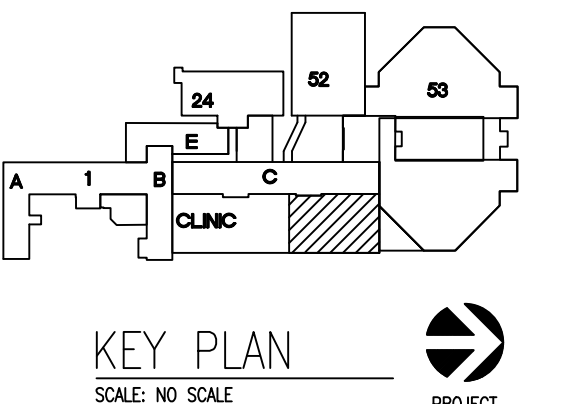

REVISIONS	DESCRIPTION	DATE



Dept. of Veterans Affairs
Jack C. Montgomery
Medical Center
1011 Honor Height Drive
Muskogee, Oklahoma 74401

ENGINEER:
RMD CONSULTING, LLC
2815 VALLEY VIEW LANE, STE. 214
DALLAS, TX 75234
P: 972-488-8077 F: 972-488-8174
OK REG. ENGINEERING FIRM: 5183

CONSULTANTS:
ARCHITECT:
ARCHITECTURAL CONCEPTS, INC.
669 AIRPORT FREEWAY, STE. 300
HURST, TX 76053
P: 817-285-8885 F: 817-285-8021

APPROVED:	APPROVED: Interior Designer
APPROVED:	APPROVED:
APPROVED:	APPROVED:
APPROVED:	APPROVED:

APPROVED: Safety Manager	APPROVED: Medical Center Director
APPROVED: Infection Control Nurse	APPROVED: Associate Director
APPROVED: Industrial Hygienist	APPROVED: Chief of Staff
APPROVED: President A.F.G.E. 2250	APPROVED: Chief of Engineering Service

DRAWING TITLE PHASING PLAN	
PROJECT NO. 623-11-107	CONTRACT NO. VA256-12-C-0295
BUILDING NO. CLINICAL	AUTOCAD FILE NAME

PROJECT TITLE REPLACE LABORATORY AIR HANDLING UNITS		
DESIGNED BY:	DRAWN BY:	CHECKED BY:
LOCATION Jack C. Montgomery VA Medical Center		

DATE 8/19/2013
SCALE AS SHOWN
DRAWING NO. PP2.0
DWG. 5 OF 40

DEPARTMENT OF
VETERANS AFFAIRS