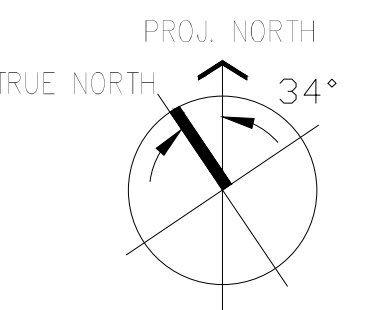
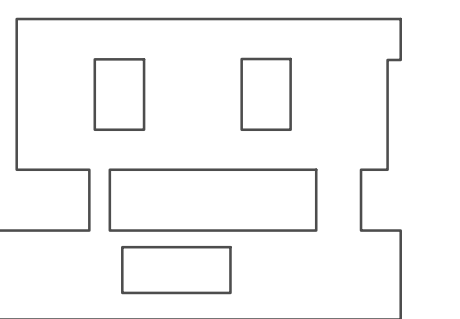

1. SEE SIGN SCHEDULE FOR SIGN TYPES, MESSAGES AND QUANTITIES.
2. SEE CONSTRUCTION DRAWINGS FOR SIGN DETAILS.

LEGEND

C1234 CODE SIGN LOCATION

 WAYFINDING SIGN LOCATION

FULLY SPRINKLERED CONSTRUCTION DOCUMENTS

Office of
Construction
and Facilities
Management

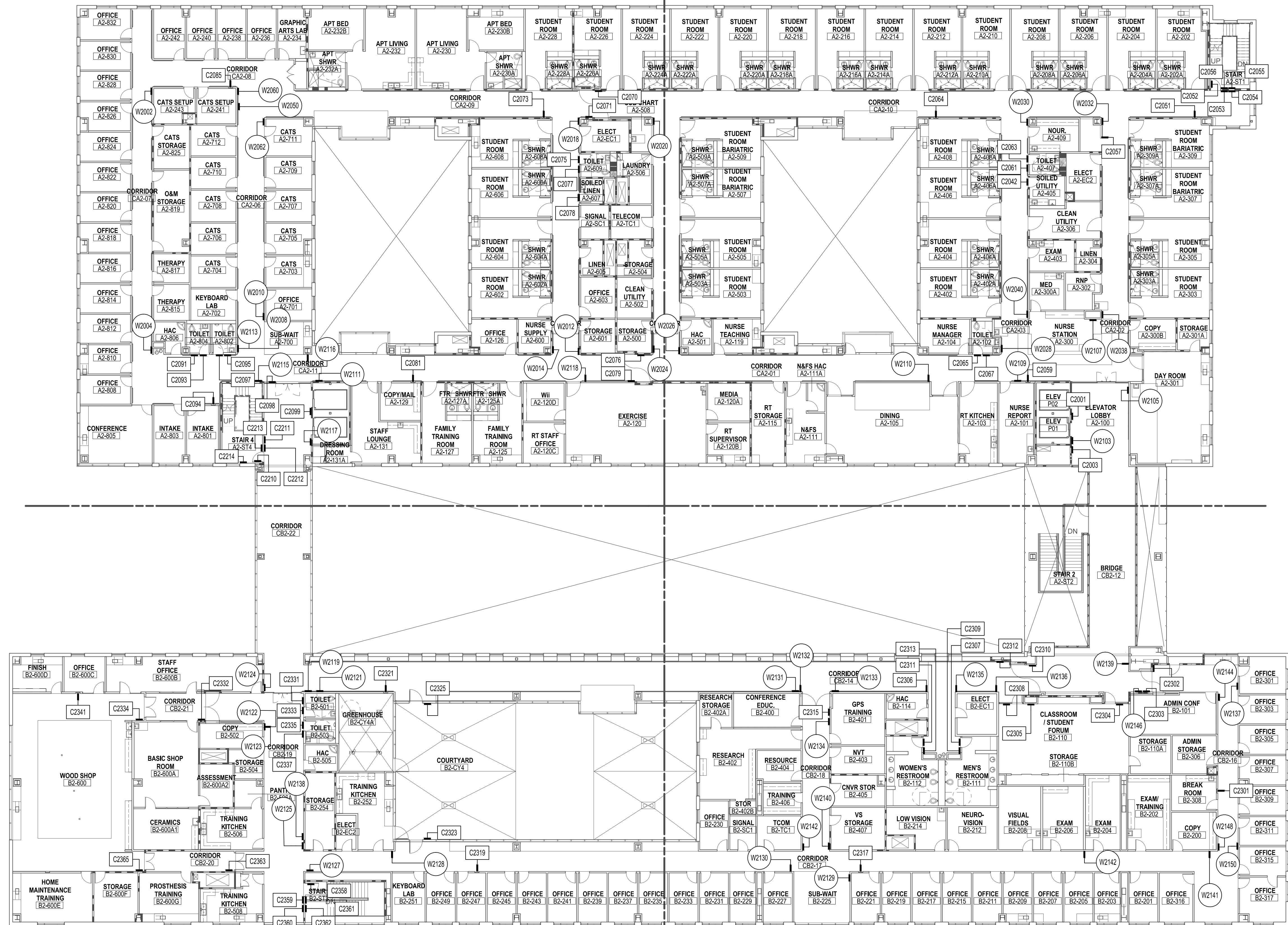

CONSULTANTS:



Kate Keating Associates, Inc.
1045 Sansome Street, Suite 202
San Francisco, CA 94111
415.773.1000 Fax 773.1008
city@kka-inc.com

Seals and Signatures

ARCHITECT/ENGINEERS:

Drawing Title	SIGN LOCATION PLAN LEVEL 2
---------------	-------------------------------

Approved: Project Director

Milan Aršić

Project Title	CENTERS FOR AMBULATORY CARE, POLYTRAUMA AND BLIND REHABILITATION Polytrauma and Blind Rehabilitation Center
---------------	---

Location	3801 Miranda Ave., Palo Alto CA
----------	---------------------------------

Date
30 APRIL, 2010

☐ Checked

Drawn

Project Number	
----------------	--

Building Number

Drawing Number

AG2.1.2