

KEY NOTES:

SHEET NOTES:

LIGHT GAUGE STEEL JOISTS		
MARK	JOIST SIZE & SPACING	REMARK
J1	1000S162-43 @ 16" o.c.	4
J2	1000S200-54 @ 16" o.c.	
J3	1000S250-97 @ 16" o.c.	
J4	1000S162-43 @ 32" o.c.	5
J5	1000S250-54 @ 32" o.c.	6

LIGHT GAUGE BUILT-UP BEAMS			
MARK	BEAM COMPONENTS	REMARK	
B1	3-600S200-54	REF. 9/S-512	<input checked="" type="checkbox"/>
B2	3-1000S200-54	REF. 9/S-512	<input checked="" type="checkbox"/>
B3	3-1200S200-97	REF. 9/S-512	<input checked="" type="checkbox"/>
B4	2-1000S200-54	REF. 9/S-512	<input checked="" type="checkbox"/>
*	INDICATES T.O. BEAM FLUSH W/ WALL TRACK. REF. 3/S-512 FOR BEAM TO WALL CONNECTION.		

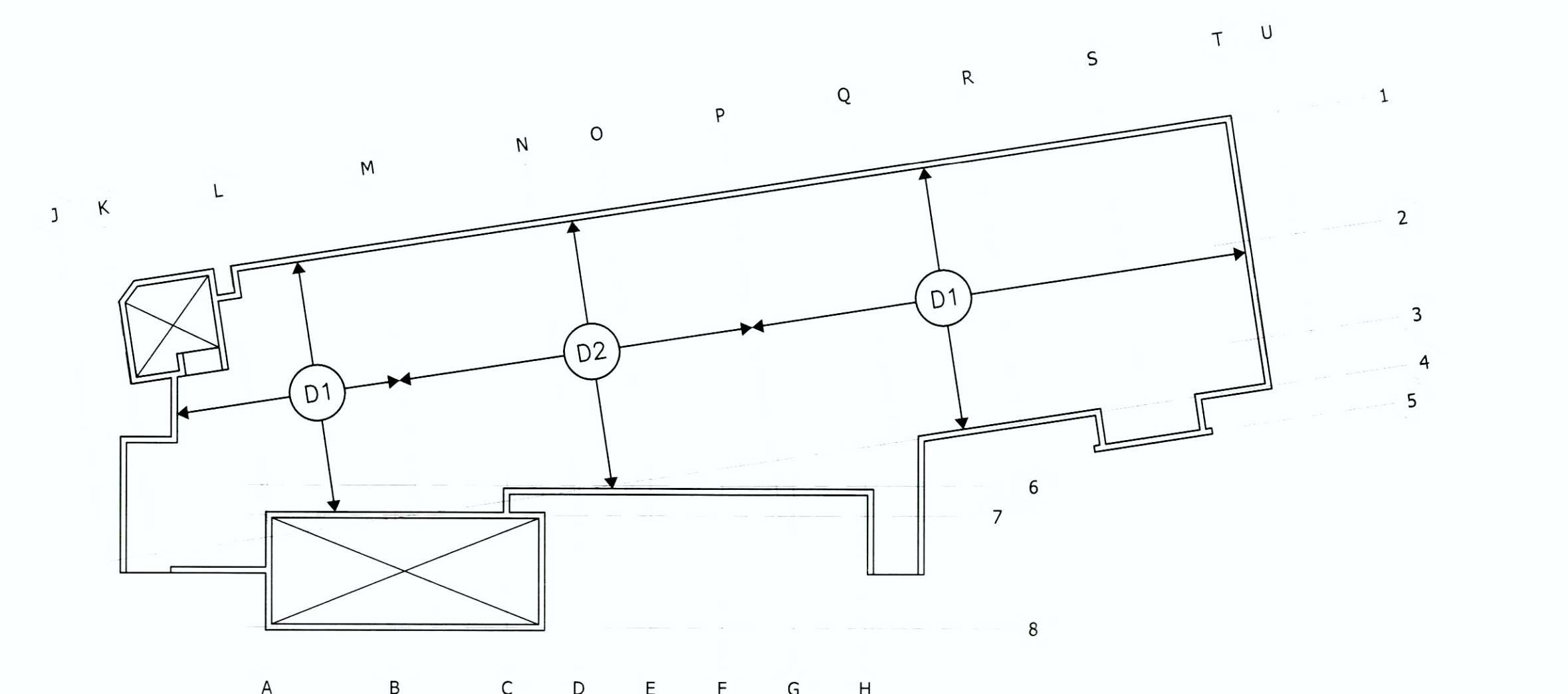

**CONSULTANTS:**

**ARCHITECT/ENGINEERS:**

Drawing Title

**SECOND FLOOR FRAMING PLAN**

Approved: Project Director

Project Title	<b>VA Medical Center Seismic Replacement And Retrofit</b>
---------------	---

Date  
**10 / 22 / 2012**

Checked
---------

Drawn
-------

Project Number  
**2941-001-00**

Drawing Number

**SE-102A**

**Office of  
Facilities  
Management**

 Department of  
Veterans Affairs