

1 FLOOR SHEATHING
N.T.S.

| WOOD DIAPHRAGM SCHEDULE | | | | | |
|-------------------------|---|-------------------------------|---------------------------|----------------------------|-------|
| MARK | FLOOR SCREW REQUIREMENTS | | | | NOTES |
| | WOOD STRUCTURAL PANEL | BOUNDARY SCREW SPACING (B.S.) | EDGE SCREW SPACING (E.S.) | FIELD SCREW SPACING (F.S.) | |
| D1 | 3/4" STRUCTURAL I APA SPAN RATED 32/16 | #8 @ 6" O.C. | #8 @ 6" O.C. | #8 @ 12" O.C. | |
| D2 | 3/4" STRUCTURAL I APA SPAN RATED 32/16 | #8 @ 4" O.C. | #8 @ 4" O.C. | #8 @ 12" O.C. | |

NOTES:

1. ALL PANEL EDGES TO BE ATTACHED TO FRAMING MEMBERS OR DIAPHRAGM BLOCKING, SEE 3/S-541 FOR DIAPHRAGM BLOCKING.

2 FLOOR SHEATHING
ATTACHMENT SCHEDULE
N.T.S.

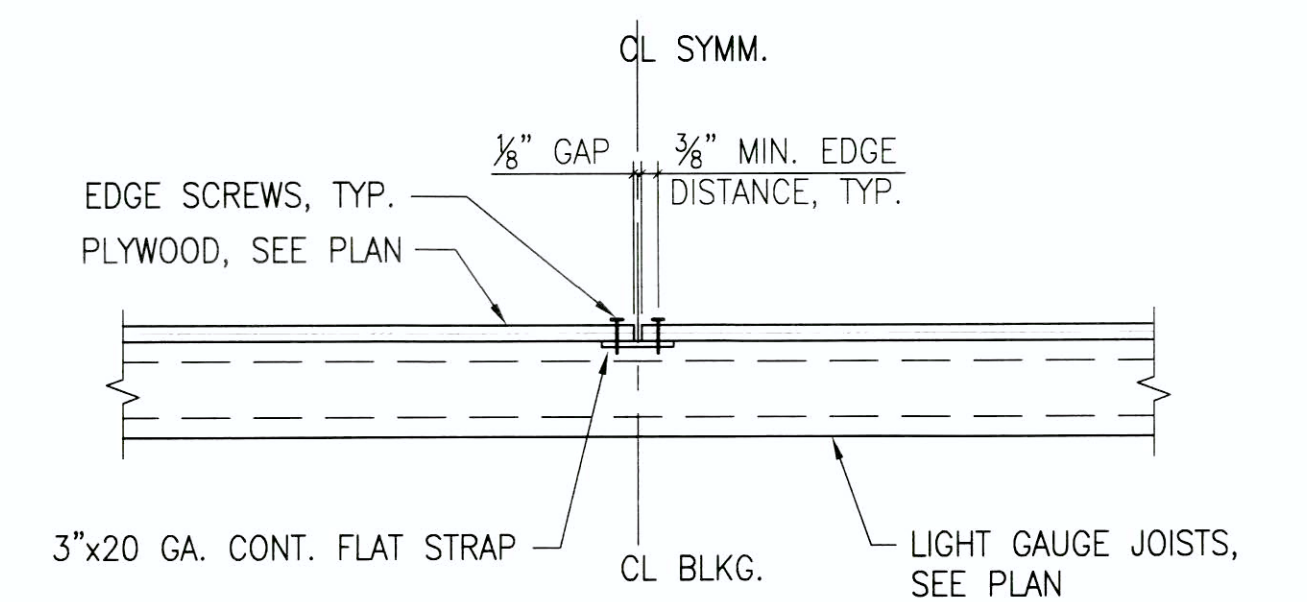

(A) JOIST PERPENDICULAR TO FRAMING

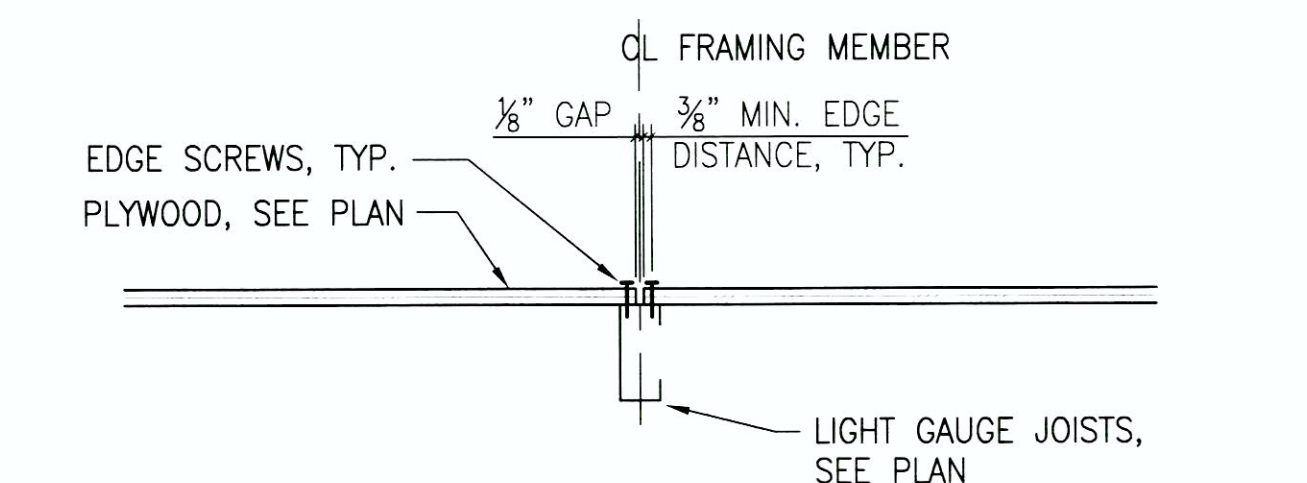

(B) JOIST PARALLEL TO FRAMING

3 PLYWOOD DIAPHRAGM BLOCKING
N.T.S.

[illegible]