

1 BUILDING 9 – BASEMENT FLOOR PLUMBING PLAN – EXISTING

1/4" = 1' - 0"

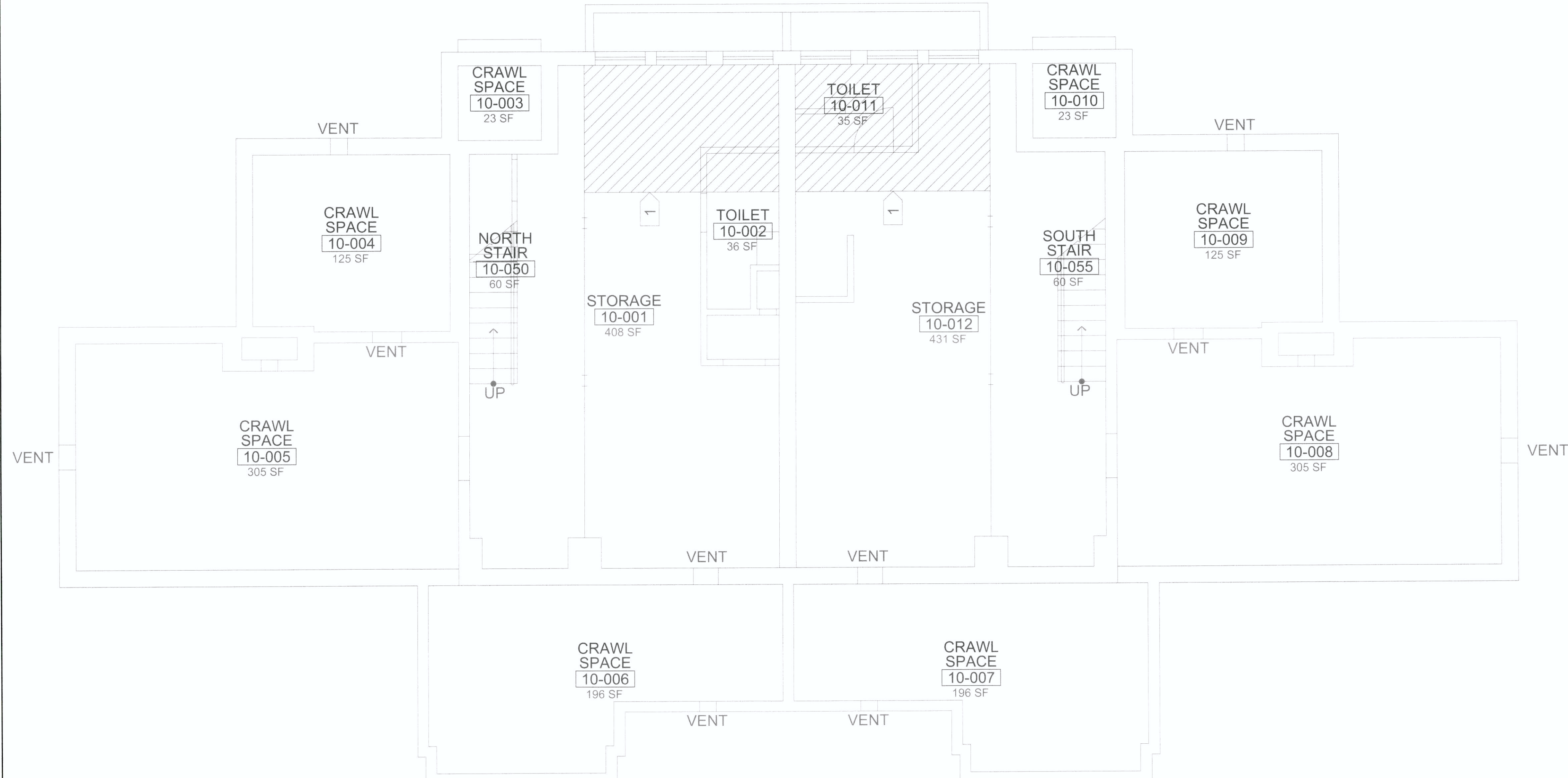

1 BUILDING 10 – BASEMENT FLOOR PLUMBING PLAN – EXISTING





1/4" = 1' - 0"

PHASING AND SHUTDOWN SCHEDULE
UNDER NO CIRCUMSTANCES SHALL EXISTING SERVICES BE INTERRUPTED WITHOUT PRIOR WRITTEN APPROVAL BY THE FACILITY. THE REQUEST FOR THE APPROVAL SHALL BE SUBMITTED TO THE FACILITY AND SHALL ALSO STATE THE MAXIMUM DURATION OF THE SHUTDOWN. ALL INTERRUPTION OF UTILITY TIE-IN WORK SHALL BE SCHEDULED WELL IN ADVANCE AND WRITTEN NOTICE SHALL BE GIVEN TO THE FACILITY AT LEAST FOURTEEN DAYS BEFORE THE DESIRED SHUTDOWN.

LEGEND:
 AREA OF WORK

- GENERAL PLUMBING NOTES:**
1. PRIOR TO START OF SEISMIC WORK IN THE CRAWL SPACE FIELD IDENTIFY AND REPORT TO ARCHITECT ANY PLUMBING COMPONENTS INCLUDING BUT NOT LIMITED TO GAS, SS, DOMESTIC WATER, AND SUPPORTS THAT ARE IN THE WAY OF NEW SEISMIC WORK.
 2. INFORM THE FACILITY OF ANY PLUMBING COMPONENTS THAT ARE REQUIRED TO BE RELOCATED TO ALLOW CONSTRUCTION OF NEW SEISMIC WORK.
 3. PROTECT ALL PLUMBING COMPONENTS THAT ARE NEAR CONSTRUCTION OF NEW SEISMIC WORK TO PRESERVE ITS INTEGRITY AND FUNCTION.
 4. ALL PLUMBING SERVICES IN THE CRAWL SPACE ARE ACTIVE AND IN SERVICE. AFTER COMPLETION OF NEW SEISMIC WORK VERIFY THAT ALL ELECTRICAL AND OTHER SERVICES ARE FUNCTIONING TO THEIR ORIGINAL CONDITIONS BEFORE THE CONSTRUCTION OF NEW SEISMIC WORK.
 5. REFER TO ARCHITECTURAL AND STRUCTURAL DRAWINGS FOR ADDITIONAL INFORMATION.

KEYED NOTES:
 REMOVE AND REINSTALL EXISTING PLUMBING PIPING, PLUMBING FIXTURES, FIRE PROTECTION SYSTEM, AND ALL OTHER PLUMBING AND FIRE PROTECTION EQUIPMENT AFFECTED BY ARCHITECTURAL AND STRUCTURAL SEISMIC WORK. FIELD VERIFY BEFORE STARTING SEISMIC WORK.

						ARCHITECT/ENGINEERS:		Drawing Title BLDG 9&10 – BASEMENT FLOOR PLUMBING PLANS – EXISTING		Project Title VA Medical Center Seismic Replacement And Retrofit		Project Number 2941-001-00		Office of Facilities Management			
								Scale:		Building Number 9, 10 & 22		Drawing Number P101					
								 Architecture Engineering Planning Hammel, Green and Abrahamson, Inc. 445 Bush Street - Fourth Floor San Francisco, California USA 94108 Telephone 415.962.2592 Facsimile 415.962.2598		 N  TRUE		Approved: Project Director		Location San Francisco, CA			
										Date 10 / 22 / 2012		Checked WHA		Drawn MR		 Department of Veterans Affairs	