

three inches = one foot
one and one half inches = one foot
one inch = one foot
three quarters inch = one foot
one half inch = one foot
three eighths inch = one foot
one quarter inch = one foot
one eighth inch = one foot
one sixteenth inch = one foot

A
B
C
D
E
F

- KEY NOTES
- 1

CIVIL POC.
- 2

FIRE SPRINKLER RISER.
- 3

MECHANICAL EQUIPMENT CLEARANCE AREA, COORDINATE WITH MECH. CONTRACTOR.
- 4

COLD WATER SOV. AND RISER.
- 5

SOV WITH ACCESS AT EACH REST ROOM BANK.
- 6

CLEARANCE NOT LESS THAN 18" IN FRONT OF CLEANOUT.
- 7

SLOPE SANITARY SEWER PIPING 1/4" PER FOOT IN DIRECTION INDICATED. (TYPICAL).
- 8

STORM DRAIN DROP FROM SECOND FLOOR. SEE PP220 FOR CONTINUATION.
- 9

SLOPE CONDENSATE DRAIN PIPING 1/8" PER FOOT IN DIRECTION SHOWN.
- 10

CONNECT 3/4" CONDENSATE TO FANCOIL UNIT EQUIPPED WITH CONDENSATE DRAIN LIFT PUMP SPECIFIED ON MECHANICAL PLANS.
- 11

ROUTE 1" CONDENSATE DRAIN DOWN IN WALL, ELBOW OUT. CONNECT TO LAVATORY/SINK DRAIN TAILPIECE.
- 12

ROUTE 3/4" CONDENSATE DRAIN DOWN IN WALL, ELBOW OUT AND TERMINATE AT MOP SINK WITH AIR GAP.
- 13

FAN COIL SUSPENDED FROM CEILING. SEE MECHANICAL DRAWINGS.
- 14

FAN COIL IN ATTIC. SEE MECHANICAL DRAWINGS.
- 15

SANITARY SEWER DROP FROM SECOND FLOOR. SEE PP220 FOR CONTINUATION.
- 16

WATER SUPPLY RISER TO SECOND FLOOR. SEE PP320 FOR CONTINUATION.
- 17

NEW GAS REGULATOR/METER. PENETRATE EXTERIOR WALL AND RISE TO ATTIC IN WALL. GAS PIPING SIZING BASED ON 2015 U.P.C. TABLE 12-8 USING 150 FT COLUMN AND MAXIMUM GAS LOAD OF 1932 MBH/1500 CFH.
- 18

EXISTING MEDIUM PRESSURE GAS LINE. VERIFY LOCATION AND SIZE.
- 19

2-1/2" VENT TO SECOND FLOOR ATTIC. SEE PP220 FOR CONTINUATION.
- 20

GAS RISER TO SECOND FLOOR. SEE PP220 FOR CONTINUATION.
- 21

1-HOUR FIRE RATED WALL. SEE ARCHITECTURAL DRAWINGS.
- 22

ACOUSTICAL SOUND WALL. SEE ARCHITECTURAL DRAWINGS.
- 23

FOR EXTENT OF ALTERNATE DEDUCTIVE SEE ARCHITECTURAL DRAWINGS.
- 24

CAP PIPING FOR FUTURE CONNECTION.
- 25

NEW MEDIUM PRESSURE GAS LINE. CONNECT TO EXISTING MEDIUM PRESSURE GAS LINE AS SHOWN.
- 26

PROVIDE WATER METER.
- 27

SANITARY SEWER DROP FROM SECOND FLOOR. SEE PP220 FOR CONTINUATION.
- 28

WATER SUPPLY RISER TO SECOND FLOOR. SEE PP220 FOR CONTINUATION.

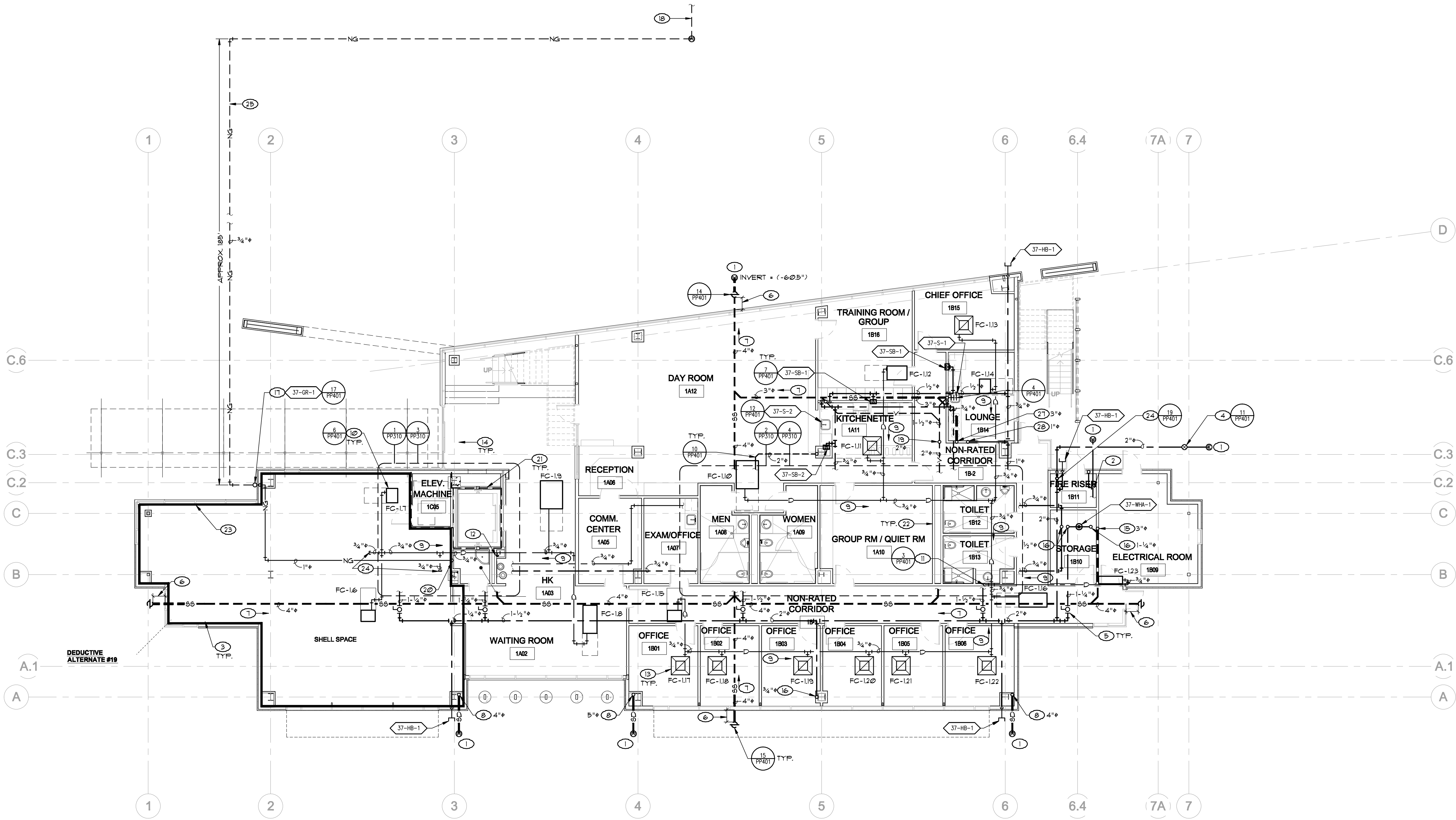

1 FIRST FLOOR PLUMBING PLAN
SCALE: 1/8" = 1'-0"

CONSULTANTS:



LP Consulting Engineers, Inc.
895 W. Ashlan Ave., Suite 101 Clovis, CA 93612
p 559-348-2130 - f 559-348-2131
www.lpeengineers.com
Job #: 11-1000.1

ARCHITECT/ENGINEERS:

HMC Architects
1827 E. Fir Avenue / Studio 103 / Fresno, CA 93720
T 559 322 2444 / www.hmcarchitects.com
HMC PROJECT #1383002-000

Drawing Title
**FIRST FLOOR PLUMBING PLAN
(DEDUCTIVE ALTERNATE #19)**

Approved: Project Director

Project Title
**Mental Health Psychosocial
Rehab Recovery and Health Care
for Homeless Veteran Center**

Location
2615 E. CLINTON AVE, FRESNO, CA 93703

Date
8/ 11/ 2014

Checked
KK, GL

Drawn
DN

Project Number
570-217
Building Number
37

Drawing Number
PP211
Dwg. of

Office of
Construction
and Facilities
Management:

