

three eighths inch = one foot  
one quarter inch = one foot  
one eighth inch = one foot  
one half inch = one foot  
three quarters inch = one foot  
one inch = one foot  
one and one half inches = one foot  
two inches = one foot  
three inches = one foot

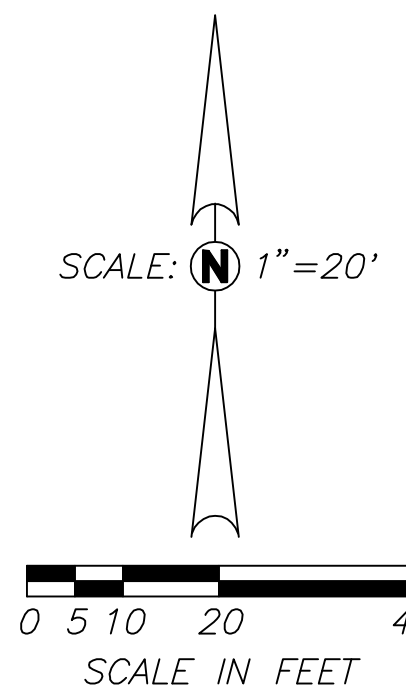
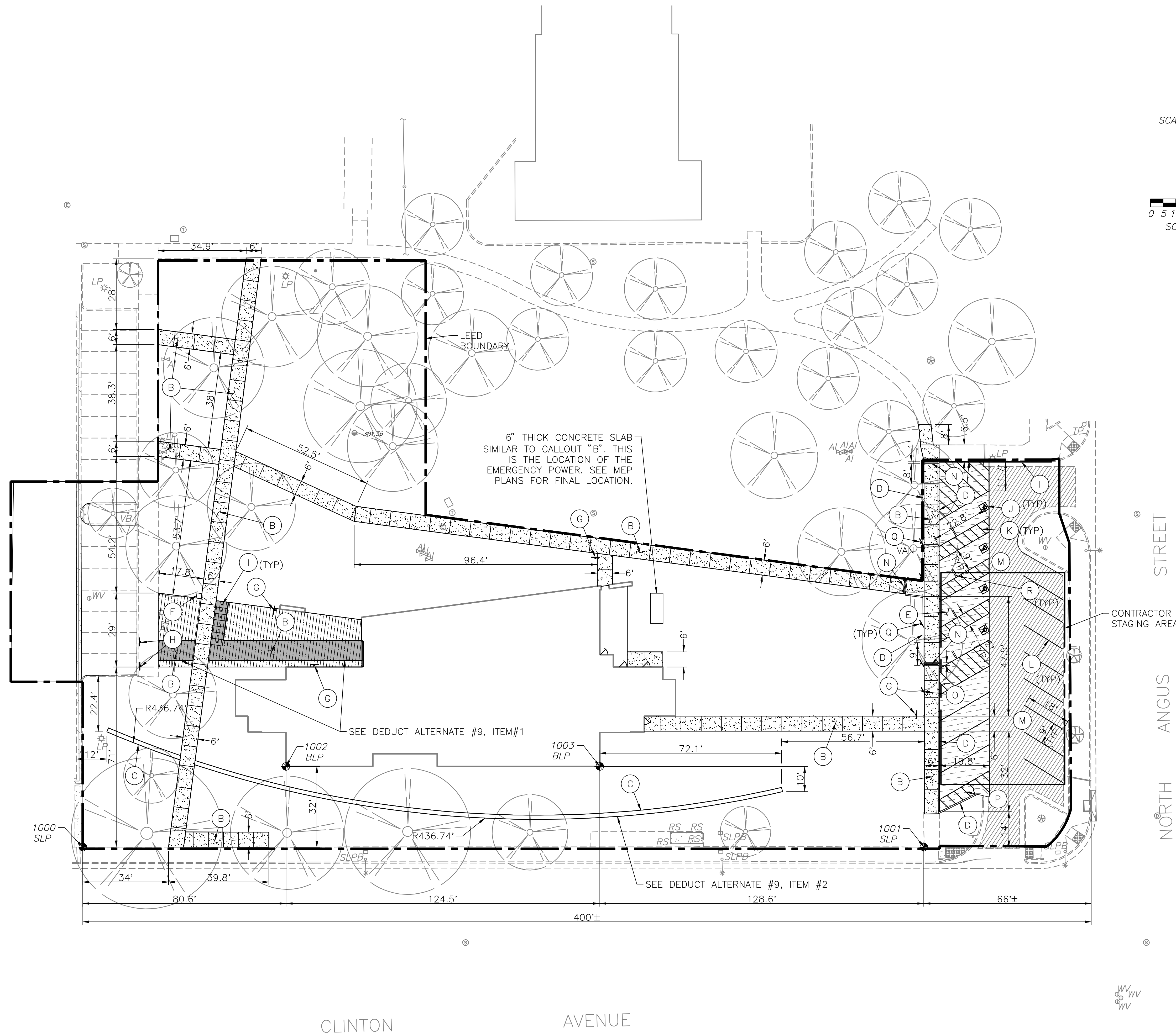

**LEGEND:**

- (A) CONCRETE SEAT WALL PER DETAIL CS400
- (B) CONCRETE SIDEWALK PER DETAIL CS401
- (C) CMU WALL PER DETAIL CS401
- (D) CONCRETE CURB PER DETAIL CS400
- (E) ASPHALT CONCRETE STRUCTURAL SECTION PER DETAIL CS400
- (F) SALVAGED MEMORIAL MONUMENT PROVIDED BY VA
- (G) NO SMOKING SIGN PANEL, POST AND FOOTING PER DETAIL CS401
- (H) SIGN READING "MENTAL HEALTH BUILDING #37 LOW EMITTING VEHICLE RESERVED PARKING" ON WHITE SIGN WITH 1" TALL GREEN CAPITAL LETTERS AND GREEN BORDER. POST AND FOOTING PER DETAIL CS401
- (I) BIKE RACK (MIN. OF 13 BIKE STALLS), PER SITE FURNISHING - BIKE RACKS SPECIFICATIONS OR APPROVED EQUAL
- (J) ACCESSIBLE PARKING SYMBOL PER DETAIL CS400
- (K) 4" WIDE BLUE PERIMETER LINES WITH 4" WIDE WHITE DIAGONAL LINES AT 3" ON CENTER.
- (L) 4" WIDE WHITE PARKING STALL STRIPE
- (M) TOPGUARD ASPHALT SEAL COAT PER MANUFACTURER SPECIFICATIONS OR APPROVED EQUAL.
- (N) SURFACE GROOVES PER DETAIL CS400
- (O) SIGN READING "MENTAL HEALTH BUILDING #37 CARPOOL PARKING ONLY" ON WHITE SIGN WITH 1" TALL GREEN CAPITAL LETTERS AND GREEN BORDER. POST AND FOOTING PER DETAIL CS401
- (P) 4" WIDE WHITE PERIMETER LINES WITH 4" WIDE WHITE DIAGONAL LINES AT 3" ON CENTER.
- (Q) ACCESSIBLE PARKING SIGN PER DETAIL CS401
- (R) CONCRETE WHEELSTOP PER DETAIL CS400
- (S) CONCRETE MOWSTRIP PER DETAIL CS400
- (T) PAINT TOP OF CURB AND FACE RED

- LIMITS OF ASPHALT CONCRETE STRUCTURAL SECTION
- LIMITS OF CONCRETE IMPROVEMENT
- LIMITS OF CONCRETE IMPROVEMENTS (DEDUCTIVE ALT. #9, ITEM #1)
- LIMITS OF PERMEABLE 3-1/4"x18"x4" PAVERS PER HANOVER ARCHITECTURAL PRODUCTS SPECIFICATIONS OR APPROVED EQUAL, PER DETAIL CS400. SEE DEDUCT ALTERNATE #9, ITEM #1.
- LIMITS OF ASPHALT SEAL COAT
- LIMITS OF DETECTABLE WARNINGS
- 1004 X LAYOUT COORDINATE POINT NUMBER AND ABBREVIATION
- (TYP) TYPICAL
- FH, DC FIRE IMPROVEMENTS, SEE SHEET CS300

**NOTES:**

1. ALL CONCRETE MOWSTRIPS, RAMP AND SIDEWALKS SHALL HAVE CONTRACTION JOINTS AT 10 FEET MAXIMUM ON CENTER AND ONE HALF INCH EXPANSION JOINTS AT 40 FEET MAXIMUM ON CENTER PER DETAIL CS401
2. NO CONCRETE MAY BE POURED UNTIL THE FORMS HAVE BEEN REVIEWED AND APPROVED BY THE VA COR.

**SITE LAYOUT:**

ALIGNMENT OF THE SITE LAYOUT GRID IS NOT TRUE NORTH-SOUTH ORIENTATION, BUT RATHER IS BASED ON AN ASSUMED COORDINATE SYSTEM AND BASIS OF BEARINGS. THE SITE LAYOUT POINT #1000 IS LOCATED APPROXIMATELY 400' WEST OF THE FACE OF CURB ON THE WEST SIDE OF ANGUS AVENUE WHERE THE EAST SIDE OF THE MOWSTRIP INTERSECTS THE CLINTON AVENUE BACK OF WALK. THE BASIS OF BEARING IS DEFINED BY A LINE FROM SITE LAYOUT POINT #1000 TO SITE LAYOUT POINT #1001 LOCATED APPROXIMATELY 66' WEST OF THE FACE OF CURB ON THE WEST SIDE OF ANGUS AVENUE WHERE THE WEST SIDE OF THE PARKING LOT WALK INTERSECTS THE CLINTON AVENUE BACK OF WALK.

DIMENSION AND POINTS ARE TO FACE OF CURB UNLESS SHOWN OTHERWISE.

**DEDUCT ALTERNATE #9:**

DEDUCT ALTERNATE #9 -

1. THE SITE PERMEABLE PAVERS IS A DEDUCT. CONCRETE SIDEWALK PER CALLOUT "B" SHALL REPLACE THE PERMEABLE PAVERS. THE LIMITS OF THE CONCRETE SIDEWALK IS SHOWN WITHIN THE PAVES AREA.
2. THE SITE WALL CALLOUT "C" IS A DEDUCT.

NORTHING EASTING TABLE				
POINT	NORTHING	EASTING	ABV	DESCRIPTION
1000	1000.00	1000.00	SLP	SITE LAYOUT POINT
1001	1000.00	1333.62	SLP	SITE LAYOUT POINT
1002	1031.99	1080.61	BLP	BUILDING LAYOUT POINT
1003	1031.99	1205.07	BLP	BUILDING LAYOUT POINT

<b>CONSULTANTS:</b> <b>Blair, Church &amp; Flynn</b> CONSULTING ENGINEERS 461 Davis Avenue, Suite 200 Davis, California 95612 Tel: (559) 526-5400 Fax: (559) 526-5300		<b>ARCHITECT/ENGINEERS:</b> <b>HMC Architects</b> 1827 E Fir Ave, Fresno, CA 93720 T: 559 522 2444 / www.hmcarchitects.com HMC PROJECT #1393002-000		<b>Drawing Title</b> SITE AND DIMENSION PLAN	<b>Project Title</b> Mental Health Psychosocial Rehab Recovery and Health Care for Homeless Veteran Center	<b>Project Number</b> 570-217	<b>Office of Construction and Facilities Management:</b> <b>Department of Veterans Affairs</b>
				<b>Approved:</b> Project Director	<b>Location</b> 2615 E. CLINTON AVE, FRESNO, CA 93703	<b>Building Number</b> 37	
				<b>Date</b> 08/11/2014	<b>Checked</b> RFA	<b>Drawn</b> JSD	

**CS100**  
Dwg. 14 of 197