

SIGN BRACKET STORE (888-919-7446) PART #310B-C-WM-AL-38
3" DIAMETER ALUMINUM 38" LONG
W/ WELDED CLOSED END &
3/8"x8"x8" GUSSETED ALUMINUM
PLATE OR APPD EQ.

S.A.F. OVER QUICKFLASH OVER
SIGN BRACKET MOUNTING PLATE

PROVIDE BACKER ROD & SEALANT

QUICKFLASH FLASHING

WRAP S.ST. MESH OVER
BRACKET & FASTEN BOTH SIDES
W/ S. ST. 3/16" DIA. SELF
TAPPING FASTENERS 4" O.C.
THRU 1/2" X 1/2" X 1/4" X LENGTH
OF MESH S.ST. ANGLE, COVER
FASTENERS W/ CLEAR SEALANT

WALL, PER PLAN

PROVIDE
BACKING, S.S.D.

STAINLESS STEEL
MESH 1/2" MESH
WELDED STAINLESS
T304.063" WIRE DIA.
MEETING ASTM E
2016-06 TWP
<http://www.twpinc.com>
510.548.4434
OR APPD EQUAL

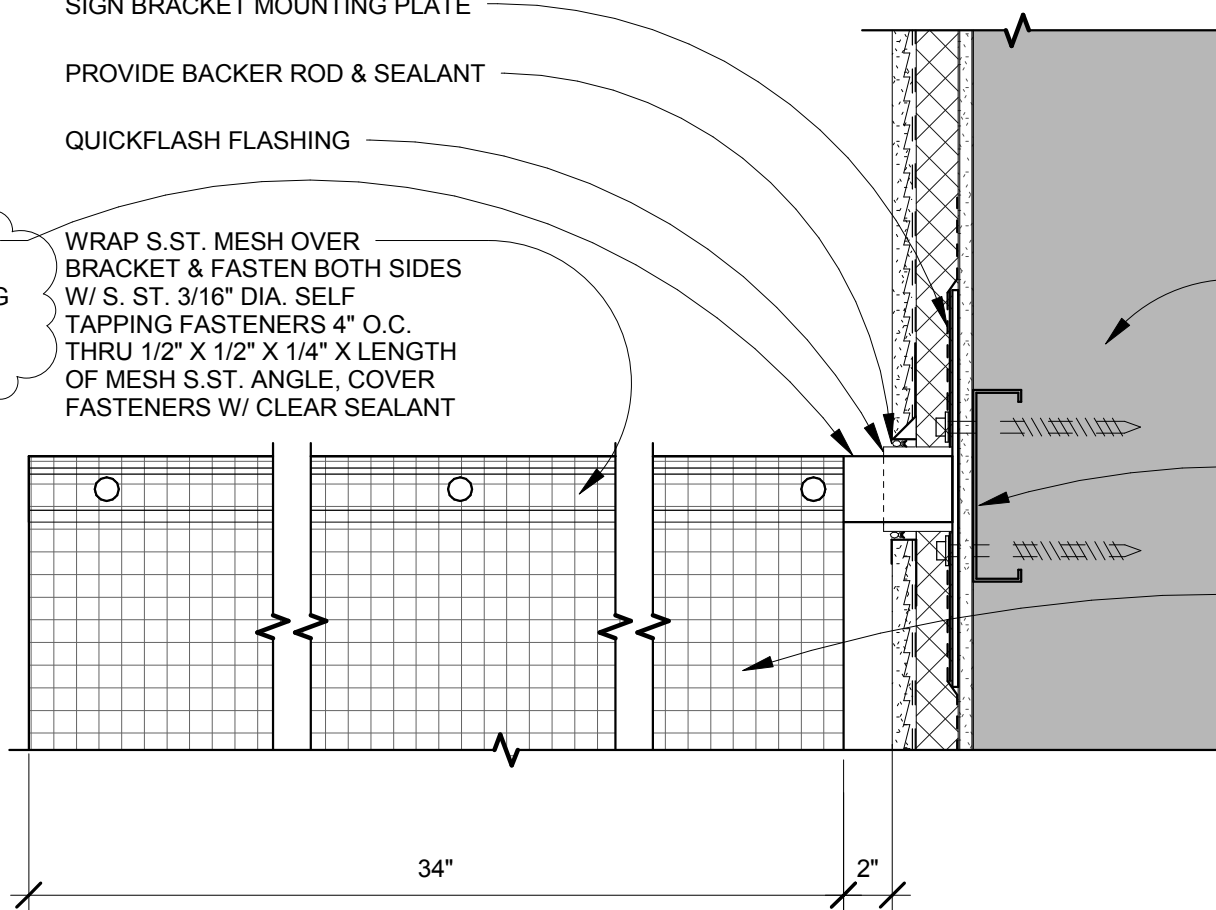

SIGN BRACKET DETAIL

Project Title MEDICAL SPECIALTIES BUILDING 648		
Location VA MATHER		
Date 09/12/2014	Checked M.H.	Drawn HA

Project Number 612-122
Building Number 648
Drawing Number A8.11
Dwg. 35 of